

CONFERENCE CENTRE

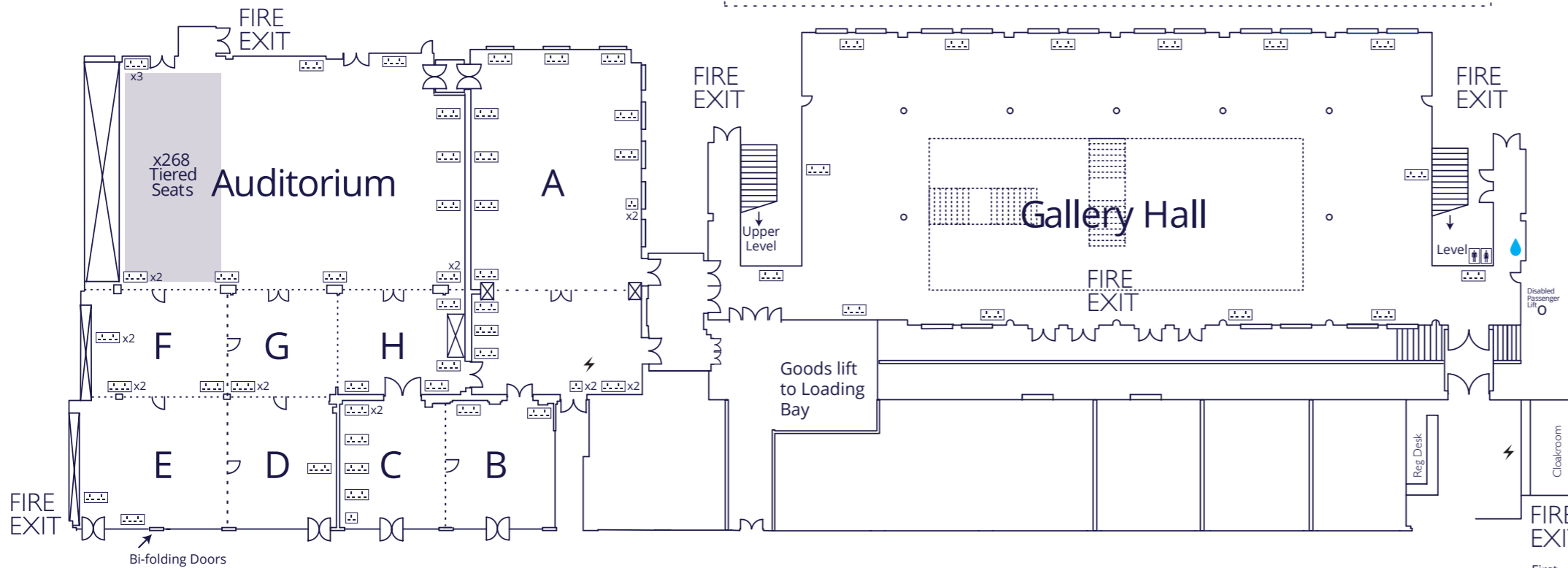
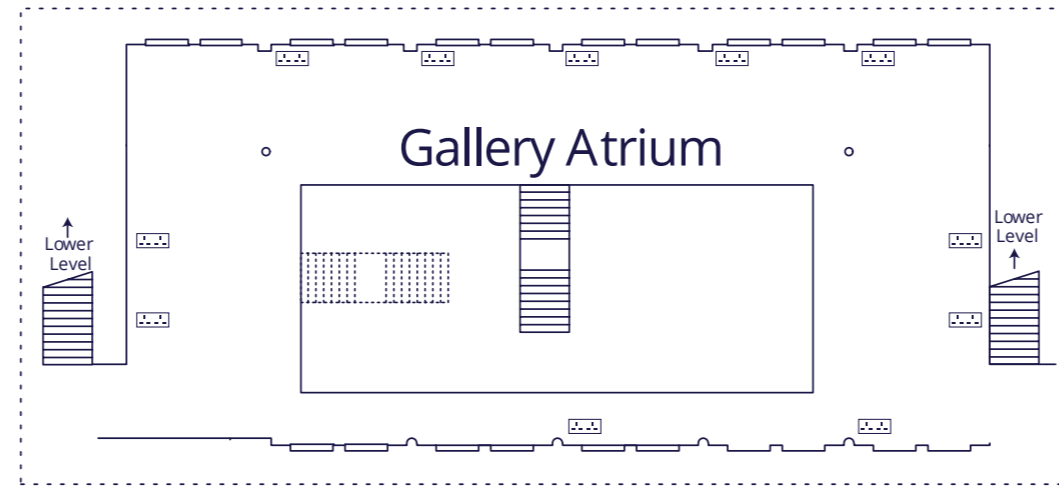

Gallery Hall and Gallery Atrium

- Adjacent to Conference Rooms
- Registration and Catering Area or Conference Room for 650 delegates theatre/400 cabaret
- Access for goods direct to hall
- Staircase installation available at £1,500.00 + VAT
- Natural Daylight
- Full blackout facilities
- Air-conditioning
- Hall heating and general lighting
- 13 amp wall power (higher power available)
- Organiser Car Parking for event duration
- Free WiFi Open Zone (Higher bandwidth upgrade available)
- Water refill stations
- Charging stations

Gallery Hall registration Desk

- Tannoy system to the Gallery Hall
- Wired Internet Connection
- Dedicated phone line
- Photocopier
- Power sockets
- Purpose built cloakroom facilities
- Digital signage screens
- Aircon and Heating

Auditorium

- Fully DDA compliant (step free access across one level)
- Conference Room for up to 500 theatre/220 cabaret
- Tiered seating for up to 268 delegates
- Air-conditioning
- Hall heating and general lighting
- 13 amp wall power (higher power available)
- Free WiFi Open Zone (Higher bandwidth upgrade available)
- Truss + Lighting can be hired with in-house AV company

Rooms A – H

- Capacity from 50 – 250 delegates
- Natural Daylight
- Full blackout facilities
- Air-conditioning
- Hall heating and general lighting
- 13 amp wall power (higher power available)
- Free WiFi Open Zone (Higher bandwidth upgrade available)
- Fresh air flow system

Notes:

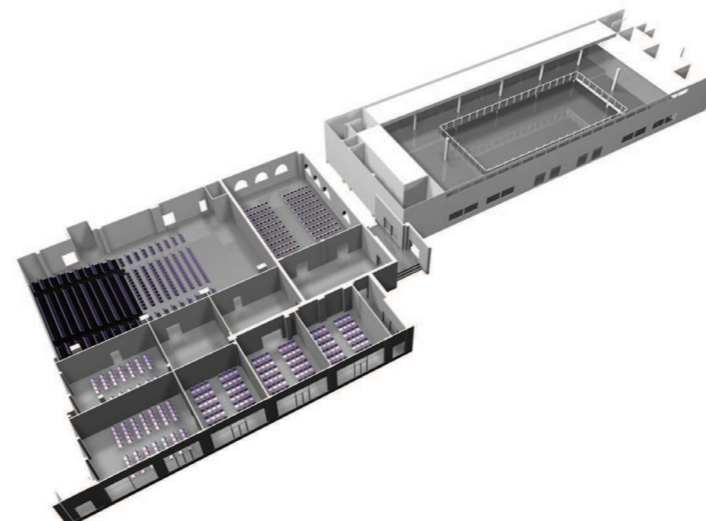

Capacity

	Theatre Capacity	Cabaret Capacity	Classroom Capacity	Length (M)	Width (M)	Height (M)
Mezzanine	1500	900	672	70.37	30.70	16.5
Ground	-	-	-	15.49	32	-
Gallery Bays	-	-	-	7.02	4.67	-
Gallery Hall	650	350	298	42.7	19.75	2.7
Gallery Hall Atrium	-	-	-	42.7	19.75	2.7
Auditorium	500	224	144	23.5	16.66	2.7
Room A	Wall in 180 Wall out 220	Wall in 110 Wall out 144	Wall in 78 Wall out 102	11.45	23.02	2.7
Room B	60	32	24	7.30	8.65	2.7
Room C	60	32	24	7.40	8.65	2.7
Room D	60	32	20	7.11	7.96	2.7
Room E	80	40	40	10.81	7.96	2.7
Room F	60	32	30	10.13	7.20	2.7
Room G	35-40	24	16	7.16	7.20	2.7
Room H	35-40	24	12	10.13	7.20	2.7
Executive Centre	70	56	40	12.60	10.75	2.5

*Please note room capacities are dependent on stage designs and sizes.



Mezzanine and Ground

- Fully DDA Compliant
- Fully carpeted exhibition and conference halls
- In house floor plan design service
- Manned service desk during build up and breakdown
- Access for goods direct to hall
- Hall heating and general lighting
- Secure exhibitor storage area available throughout tenancy
- Complimentary Cleaning Services to venue areas
- Digital Directional Signage
- Organiser Car Parking for event duration
- Free WiFi Open Zone (Higher bandwidth upgrade available)
- 💧 Water refill stations
- ⚡ Charging stations

Registration Desk in the foyer

- Wired Internet Connection
- Dedicated phone line
- Power sockets
- Purpose built cloakroom facilities
- Digital signage screens

Organiser's Office space

- Reception Area
- Private Office
- Personal Kitchen
- Photocopier
- Phones
- Free Wi-Fi Available
- Television
- Tannoy to main hall for announcements

Digital Signage Locations

- Graphics to be provided by organiser (1080W x 1920L)
- For PowerPoint templates contact your Project Manager
- All graphics to be provided no later than 5 working days prior to your event for approval by your Project Manager.
- ★ These screens are for Mezzanine events
- ☆ These screens are for Gallery Hall and Atrium events

Stairwells

There are 2 goods lifts in the Loading Bay for the delivery of stand materials and exhibits.

Main Hall / SWG

- Goods lift Size - 3900mm Long x 1900mm Wide x 1900 High
 - Goods lift Capacity – 3000kg
- | Door 1 | Door 2 | Door 3 |
|---------------------|---------------------|---------------------|
| • 1.8m (w) x 2m (h) | • 1.8m (w) x 2m (h) | • 1.8m (w) x 2m (h) |

Gallery Hall / SWF

- Goods lift Size – 5500mm Long x 2550mm Wide x 1900mm High
- | Door 1 | Door 2 | Door 3 |
|------------------------|------------------------|------------------------|
| • 1.53m (w) x 1.9m (h) | • 1.37m (w) x 1.9m (h) | • 1.35m (w) x 1.9m (h) |

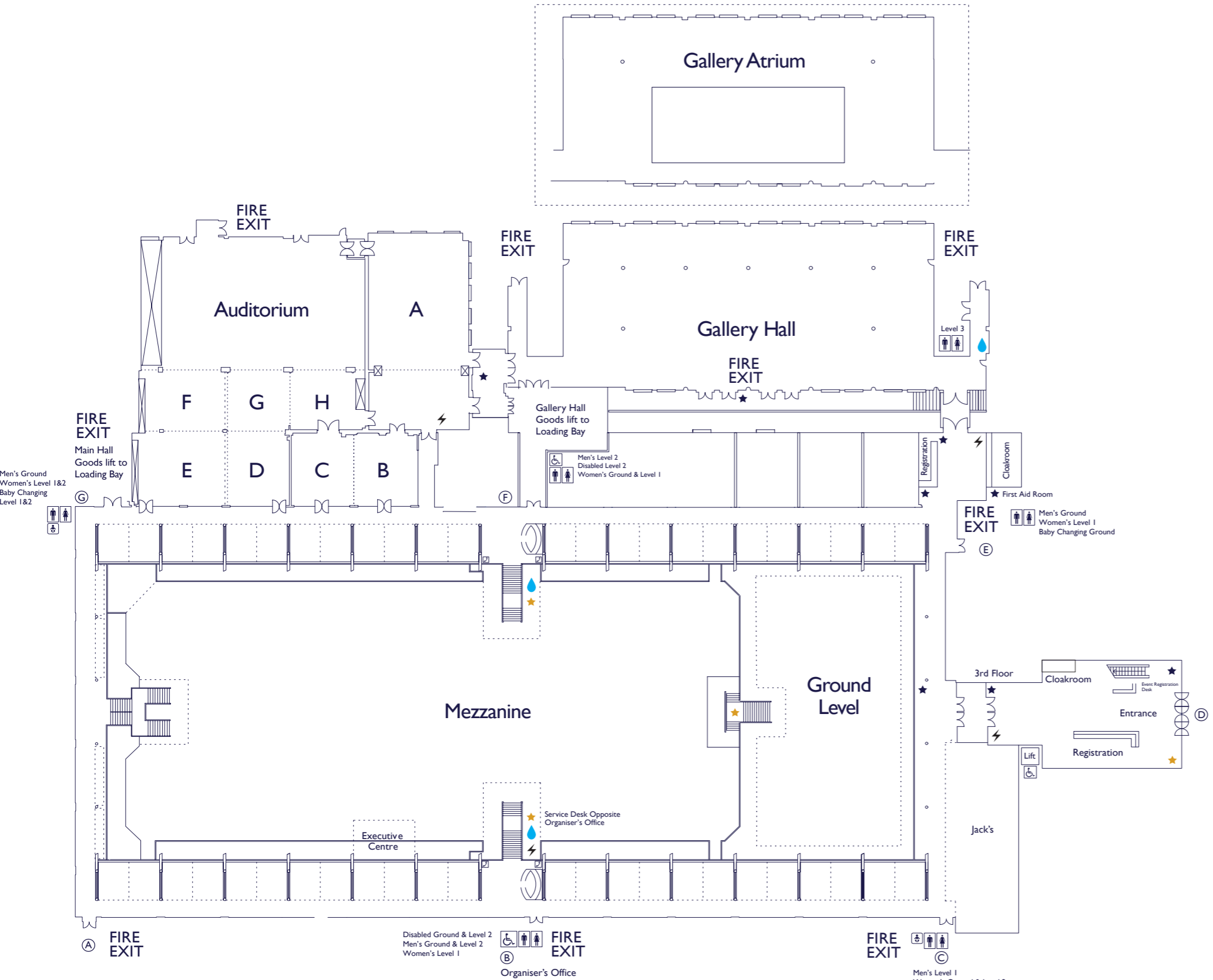

Dimensions

	Gross Space	Net Space	Length (M)	Width (M)	Height (M)
Mezzanine	2088m ²	1338 m ²	70.37	30.70	16.5
Ground Level	471.5m ²	352.5m ²	15.49	32.0	-
Gallery Bays	1468m ²	1010m ²	7.02	4.67	3.0
Gallery Hall	837m ²	507m ²	42.7	19.75	6.85
Gallery Atrium	558m ²	363m ²	42.69	19.75	2.75
Conference Centre	1140m ²	840m ²			
Total	6565.5m²	4430.5m²			

Notes:

.....

.....

.....

.....

.....

.....