



LIGHTING

## Guide Solar Bollard Heavy duty Galvanised steel Root mounted base

### Solar LED Bollard - Commercial Grade



#### Solar Bollard for pathway and amenity lighting

- ⇒ Heavy Duty Bollard
- ⇒ IK 10—Vandal Resistant
- ⇒ Galvanised steel base (3.6mm thick)
- ⇒ Powder coated base in any RAL colour
- ⇒ Root mounted for fast installation
- ⇒ Stainless Steel Fasteners
- ⇒ 6.2 Watt Solar Panel
- ⇒ 220lm Output
- ⇒ CCT Adjustable 3000K to 4500K
- ⇒ 12Ahr Li Fe PO4 Battery
- ⇒ Sensor controlled 30% to 100% output
- ⇒ Available in 3 mounting heights  
400.0mm - 800.0mm - 1000.0mm

Order Code - CBD6-2 (*mounting height*)

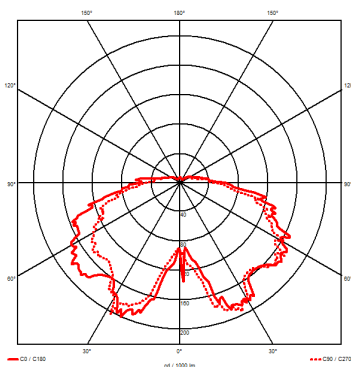

OG² Lighting Ltd  
Unit 12 , Yeomanry Road  
Battlefield Enterprise Park  
Shrewsbury SY1 3EH  
Info@og2lighting.com  
www.ogtwo.com

Please contact us for photometric files, ies or ldt



## LIGHTING

Monocrystalline Solar Panel - IK10 Vandal Resistant Polycarbonate top

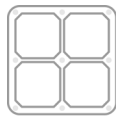

LED's 220 lumen output Colour Temperature adjustable,

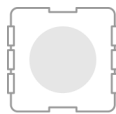

Heavy Duty bollard base 3.6mm steel and PPC in Black as standard

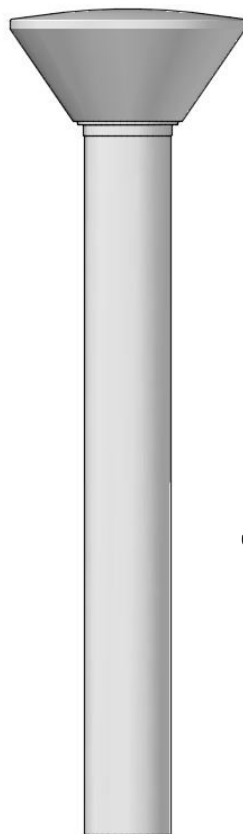

400.0mm 800.0mm 1000.0mm to ground level 300.0mm root depth

Height



Solar Controller incorporates sensors CCT, Lumen Output, Battery management

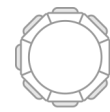

360° LED and Sensor On trigger output increases from 30% to 100%



Battery Li Fe PO<sup>4</sup> 12Ahr , 5 day autonomy through sensor management

### Specification:

- ⊗ LED Output 1.5Watts 220 Lumen CCT variable from 3000K to 4500K
- ⊗ Solar Panel Monocrystalline 6.2Watts with IK10 Polycarbonate cover
- ⊗ 360° Motion sensors switching from 30% to 100%
- ⊗ Head Diameter 255.0mm Shaft Diameter 98.0mm IP65
- ⊗ Heavy duty galvanised steel base PPC in black or RAL colour to order
- ⊗ 12 Ahr Li Fe PO<sup>4</sup> Battery charge time 5hrs.