



GROWING WITH YOU



PRODUCT GUIDE



GROWING
WITH YOU

WHY SUMO?

We help farmers and growers lower input costs, improve yields & protect the environment using our range of efficient, British-built cultivation and seeding farm machinery.

Sumo is changing with the times and has a focus on Conservation Agriculture which is a farming system that puts soil at the centre of your farm universe. It can protect the soil from erosion and degradation, improve its biodiversity and protect our most precious natural resources; water and air.

This method of farming can lower crop establishment input costs and increase yields - so by looking after your soil, you're looking after your bottom line too.

MAIN OFFICE:

Sumo UK Ltd, Redgates, Melbourne, York YO42 4RG

T: +44 (0) 1759 319900

E: sales@sumo1.com

W: www.sumo1.com



CONTENTS

DEEP TILLAGE

SHALLOW TILLAGE

DRILLING TECHNOLOGY

GRASSLAND MACHINERY

ACCESSORIES

DEEP TILLAGE

TRIO MOUNTED - Combination Cultivator	4
TRIO TRAILED - Combination Cultivator	6
QUATRO - Combination Cultivator	8
SUBSOILER MOUNTED - Compaction Relief	10
SUBSOILER TRAILED - Compaction Relief	12
RIPPA MOUNTED - Deep Aeration	14

SHALLOW TILLAGE

LDS MOUNTED - Low-disturbance Compaction Relief	16
LDS TRAILED - Low-disturbance Compaction Relief	18
MULTIPACKA FRONT - Front Mounted Press	20
MULTIPRESS MOUNTED - High-speed Tine Cultivator	22
MULTIPRESS TRAILED - High-speed Tine Cultivator	24
MIXIDISC - High-speed Disc Cultivator	26
VAXIO - High-speed Combination Cultivator	28
STRAKE - Straw Rake	30

DRILLING TECHNOLOGY

DTS MOUNTED - Strip-till Technology	32
DTS TRAILED - Strip-till Technology	34
DD MOUNTED - Direct-drilling Technology	36
DD TRAILED - Direct-drilling Technology	38
FRONT HOPPER - Drilling Accessories	40
CRIMPER FRONT - Green Crop Crimper	42

GRASSLAND MACHINERY

GLS MOUNTED - Grassland Sub-soiler	44
GLA FRONT - Grassland Aeration	46

ACCESSORIES

FRONT WEIGHT BLOCK	48
SDO COULTER	50
SEEDING UNIT	51

DEEP TILLAGE



The TRIO mounted combination cultivator works the whole soil profile in one pass and can be used in most instances instead of the plough.

Leading legs lift the soil, relieving compaction, whilst following serrated discs mix the top soil and incorporate trash, before the MULTIPACKA consolidates the surface.

TRIO - MOUNTED

Specification

- Tractor attachment Cat 3, three-point linkage
- Hydraulics Auto-reset
- Road lights Standard
- Adjustment Leg & roller = pin adjustment
- Running gear N/A

Legs & Points (red = standard)

- TRIO - SW1046 leg, SW1050 point
- TRIO - SW1046 leg, SWB441LD point
- GLS - SW1151 leg, SW1087 point
- Combi - SW777 leg, SW1100 point

Model	Working Width	Transport Width	Number of Legs	Leg Spacing	Max Leg Depth	Number of Discs	Weight
TR2.5SP - Rigid	2.4m	2.55m	5	500mm	400mm	18	2,468kg
TR2.5AR - Rigid	2.4m	2.55m	5	500mm	400mm	18	2,515kg
TR3.0SP - Rigid	2.9m	3.00m	6	500mm	400mm	22	2,795kg
TR3.0AR - Rigid	2.9m	3.00m	6	500mm	400mm	22	2,855kg
TR3.5AR - Rigid	3.4m	3.50m	7	500mm	400mm	24	3,070kg

TRIO | COMBINATION CULTIVATOR

- + Staggered legs reduce draft
- + Leg protection from impact
- + Serrated discs cut through trash
- + Removable disc unit for sub-soiling
- + MULTIPACKA consolidating roller
- + Replaceable rings on Multipacka

MODELS

Code	Description
TR2.5SP	MOUNTED TRIO 2.5 - 2.5m one-pass cultivator c/w 1 x row of staggered legs, with shear-pin protection. 2 x rows of serrated discs and a MULTIPACKA.
TR2.5AR	MOUNTED TRIO 2.5 - 2.5m one-pass cultivator c/w 1 x row of staggered legs, with auto-reset protection. 2 x rows of serrated discs and a MULTIPACKA.
TR3.0SP	MOUNTED TRIO 3.0 - 3.0m one-pass cultivator c/w 1 x row of staggered legs, with shear-pin protection. 2 x rows of serrated discs and a MULTIPACKA.
TR3.0AR	MOUNTED TRIO 3.0 - 3.0m one-pass cultivator c/w 1 x row of staggered legs, with auto-reset protection. 2 x rows of serrated discs and a MULTIPACKA.
TR3.5AR	MOUNTED TRIO 3.5 - 3.5m one-pass cultivator c/w 1 x row of staggered legs, with auto-reset protection. 2 x rows of serrated discs and a MULTIPACKA.

OPTIONS

Code	Description
TR.SFK	Seeder fitting kit with steps
TR.SWA 2618	Seeder mount only
Turbo-jet8-icon	Turbojet8-icon
Turbo-jet10-icon	Turbojet10-icon
TR.MSDO	SDO fitting kit for rigid frame machines
TR.SDO	SDO coulter (1 per leg)

DEEP TILLAGE

SHALLOW TILLAGE

DRILLING TECHNOLOGY

GRASSLAND MACHINERY

ACCESSORIES

DEEP TILLAGE



The TRIO trailed combination cultivator works the whole soil profile in one pass and can be used in most instances instead of the plough.

Leading legs lift the soil, relieving compaction, whilst following serrated discs mix the top soil and incorporate trash, before the MULTIPACKA consolidates the surface.

TRIO - Trailed

Specification

- Tractor attachment
- Hydraulics
- Hydraulics
- Road lights
- Adjustment
- Running gear

TTR3 / TTR3.5 = LMD
TRF4.5/TRF5.5/TRF6.5 = Cat 3
Auto-reset & folding

Standard

Legs & roller = pin adjustment

TTR3 / TTR3.5 = 480/45-17 | TRF4.5 / TRF5.5 / TRF6.5 = 600/50-22.5

Legs & Points (red = standard)

- TRIO - SW1046 leg, SW1050 point
- TRIO - SW1046 leg, SWB441LD point
- GLS - SW1151 leg, SW1087 point
- Combi - SW777 leg, SW1100 point

Model	Working Width	Transport Width	Number of Legs	Leg Spacing	Max Leg Depth	Number of Discs	Weight
TTR3.0AR - Rigid	3.0m	3.25m	6	500mm	400mm	23	4,220kg
TTR3.5AR - Rigid	3.5m	3.75m	6	583mm	400mm	28	4,706kg
TTR4.5AR - Folding	4.5m	2.9m	9	500mm	400mm	34	8,631kg
TTR5.5AR - Folding	5.5m	2.9m	11	500mm	400mm	42	9,101kg
TTR6.5AR - Folding	6.5m	2.9m	13	500mm	400mm	52	10,025kg

TRIO

COMBINATION CULTIVATOR

- + Staggered legs reduce draft
- + Leg protection from impact
- + Serrated discs cut through trash
- + Adjustable leg working depth
- + MULTIPACKA consolidating roller
- + Replaceable rings on Multipacka

MODELS

Code	Description
TTR3.0AR	TRAILED TRIO 3.0 - 3.0m one-pass cultivator c/w 1 x row of staggered legs, with auto-reset protection. 2 x rows of serrated discs and a MULTIPACKA.
TTR3.5AR	TRAILED TRIO 3.5 - 3.5m one-pass cultivator c/w 1 x row of staggered legs, with auto-reset protection. 2 x rows of serrated discs and a MULTIPACKA.
TTF4.5AR	TRAILED TRIO 4.5 - 4.5m one-pass cultivator c/w 1 x row of staggered legs, with auto-reset protection. 2 x rows of serrated discs and a MULTIPACKA.
TTF5.5AR	TRAILED TRIO 5.5 - 5.5m one-pass cultivator c/w 1 x row of staggered legs, with auto-reset protection. 2 x rows of serrated discs and a MULTIPACKA.
TTF6.5AR	TRAILED TRIO 6.5 - 6.5m one-pass cultivator c/w 1 x row of staggered legs, with auto-reset protection. 2 x rows of serrated discs and a MULTIPACKA.

OPTIONS

Code	Description
TTR/TTF. SFK	Seeder fitting kit with steps
TTR/TTF. SWA2618	Seeder mount only
Turbo- jet8-icon	Turbojet8-icon
Turbo- jet10-icon	Turbojet10-icon
TTF.MSDO	SDO fitting kit for rigid frame machines
TTF.TSDO	SDO fitting kit for folding frame machines
TTF.SDO	SDO Coulter (1 per leg)
TTR.FD3 / TTR.FD3.5	TRIO front discs TTR 3 / 3.5
TTF.FD4.5S	TRIO front discs TTF 4.5
TTF.FD5.5S	TRIO front discs TTF 5.5
TTF.FD6.5S	TRIO front discs TTF 6.5

Code	Description
TTF.RD	Rear drawbar TTF 4.5 / 5.5 / 6.5
TTF.3SK	3rd service kit TTF 4.5 / 5.5 / 6.5
TTF.ABK	Air brake kit
TTR/TTF. SWB1267	Cat 3 ring hitch
TTR/TTF. SWB1368	Cat 4 ring hitch
TTR/TTF. SWB1248	Cat 4 swivel ball hitch
TTR/TTF. SWB1258	Cat 5 swivel ball hitch
TTR/TTF. SWB1280	K80 spoon hitch
TTR/TTF. TMLMD	Linkage mounted drawbar (Standard on rigid frames)
TTR/TTF. SWB1283	Cat 3 lower link arms

DEEP TILLAGE

SHALLOW TILLAGE

DRILLING TECHNOLOGY

GRASSLAND MACHINERY

ACCESSORIES

DEEP TILLAGE



The QUATRO trailed combination cultivator works the whole soil profile in one pass, ideally suited to trashy conditions.

Leading discs chop surface trash ahead of the compaction busting legs. Following serrated discs mix the top soil, before the MULTIPACKA consolidates the surface.

QUATRO - TRAILED

Specification

- Tractor attachment Q3 = LMD
Q4 / Q5 / Q6 = Cat 3 ring
Auto-reset & folding
Standard
- Hydraulics
- Road lights
- Adjustment Legs & roller = pin | Disc = hydraulic
- Running gear Q3 = 480/45-17 | Q4 = 600/50-22.5 | Q5 / Q6 = 710/45-26.5

Legs & Points (red = standard)

- TRIO - SW1046 leg, SW1050 point
- TRIO - SW1046 leg, SWB441LD point
- GLS - SW1151 leg, SW1087 point
- Combi - SW777 leg, SW1100 point

Model	Working Width	Transport Width	Number of Legs	Leg Spacing	Max Leg Depth	Number of Discs	Weight
Q3 - Rigid	3.0m	3.25m	6	500mm	400mm	48	5,930kg
Q4 - Folding	4.0m	3.00m	8	583mm	400mm	64	10,210kg
Q5 - Folding	5.0m	3.00m	10	500mm	400mm	80	11,965kg
Q6 - Folding	6.0m	3.00m	12	500mm	400mm	96	12,958kg

QUATRO

COMBINATION CULTIVATOR

- + Two double rows of discs
- + Cuts through trash and cultivates soil
- + Staggered legs reduce draft
- + Legs relieve soil compaction
- + MULTIPACKA consolidating roller
- + Parallel drawbar

MODELS

Code	Description
Q3	TRAILED QUATRO 3.0 - 3.0m one-pass cultivator c/w 1 x row of staggered legs, with auto-reset protection. 2 x double rows of serrated discs and a MULTIPACKA.
Q4	TRAILED QUATRO 4.0 - 4.0m one-pass cultivator c/w 1 x row of staggered legs, with auto-reset protection. 2 x double rows of serrated discs and a MULTIPACKA.
Q5	TRAILED QUATRO 5.0 - 5.0m one-pass cultivator c/w 1 x row of staggered legs, with auto-reset protection. 2 x double rows of serrated discs and a MULTIPACKA.
Q6	TRAILED QUATRO 6.0 - 6.0m one-pass cultivator c/w 1 x row of staggered legs, with auto-reset protection. 2 x double rows of serrated discs and a MULTIPACKA.

OPTIONS

Code	Description
Q.SFK	Seeder fitting kit with steps
Q.SWA 2618	Seeder mount only
Turbo-jet8-icon	Turbojet8-icon
Turbo-jet10-icon	Turbojet10-icon
Q.MSDO	SDO fitting kit for rigid frame machines
Q.TSDO	SDO fitting kit for folding frame machines
Q.SDO	SDO coulter (1 per leg)
Q.RD	Rear drawbar
Q.3SK	3rd service kit
Q.ABK	Air brake Kit

Code	Description
Q.SWB1267	Cat 3 ring hitch
Q.SWB1368	Cat 4 ring hitch
Q.SWB1248	Cat 4 swivel ball hitch
Q.SWB1258	Cat 5 swivel ball hitch
Q.SWB1280	K80 spoon hitch
Q.TMLMD	Linkage mounted drawbar (Standard on rigid frames)
Q.SWB1283	Cat 3 lower link arms

DEEP TILLAGE

SHALLOW TILLAGE

DRILLING TECHNOLOGY

GRASSLAND MACHINERY

ACCESSORIES

DEEP TILLAGE



The heavy-duty SUBSOILER can work deep to lift the deepest of compaction layers caused by heavy traffic, wet season or poor cultivation techniques.

A V-shaped leg arrangement lifts the soil in one wave and lets trash flow more freely. A following MULTIPACKA firms the surface and helps break down clods.

SUBSOILER - MOUNTED

Specification

- Tractor attachment Cat 3 or Cat 4 - Three-point linkage
- Hydraulics Auto-reset
- Road lights Standard
- Adjustment Leg & roller = pin adjustment
- Running gear N/A

Model	Working Width	Transport Width	Number of Legs	Leg Spacing	Max Leg Depth	Protection	Weight
S3SP - Rigid	2.7m	3.00m	3	900mm	500mm	Shear-pin	2,200kg
S3AR - Rigid	2.7m	3.00m	3	900mm	500mm	Auto-reset	2,480kg
S4SP - Rigid	2.8m	3.00m	4	650mm	500mm	Shear-pin	2,360kg
S4AR - Rigid	2.8m	3.00m	4	650mm	500mm	Auto-reset	2,575kg
S5SP - Rigid	3.4m	3.60m	5	650mm	500mm	Shear-pin	3,000kg
S5AR - Rigid	3.4m	3.60m	5	650mm	500mm	Auto-reset	3,250kg

SUBSOILER | COMPACTION RELIEF

- + V-Formation lifts soil in a wave
- + Leg protection from impact
- + Easy-change points
- + 500mm max depth for deep pans
- + MULTIPACKA consolidating roller
- + Replaceable rings on MULTIPACKA

MODELS

Code	Description
S3SP	MOUNTED SUBSOILER 3 - 3 leg sub-soiler with shear-pin protection and MULTIPACKA.
S3AR	MOUNTED SUBSOILER 3 - 3 leg sub-soiler with auto-reset protection and MULTIPACKA.
S4SP	MOUNTED SUBSOILER 4 - 4 leg sub-soiler with shear-pin protection and MULTIPACKA.
S4AR	MOUNTED SUBSOILER 4 - 4 leg sub-soiler with auto-reset protection and MULTIPACKA.
S5SP	MOUNTED SUBSOILER 5 - 5 leg sub-soiler with shear-pin protection and MULTIPACKA.
S5AR	MOUNTED SUBSOILER 5 - 5 leg sub-soiler with auto-reset protection and MULTIPACKA.

OPTIONS

Code	Description
S.SFK	Seeder fitting kit with steps
S.SWA 2618	Seeder mount only
Turbo-jet8-icon	Turbojet8-icon
Turbo-jet10-icon	Turbojet10-icon
S.MSDO	SDO fitting kit for rigid frame machines
S.SDO	SDO coulter (1 per leg)
S.SLD	SUBSOILER Straight Leading disc (1 per leg)

DEEP TILLAGE

SHALLOW TILLAGE

DRILLING TECHNOLOGY

GRASSLAND MACHINERY

ACCESSORIES

DEEP TILLAGE



The heavy-duty SUBSOILER can work deep to lift the deepest of compaction layers caused by heavy traffic, wet season or poor cultivation techniques.

A V-shaped leg arrangement lifts the soil in one wave and lets trash flow more freely. A following MULTIPACKA firms the surface and helps break down clods.

SUBSOILER - TRAILED

Specification

- Tractor attachment Cat 3 ring hitch
- Hydraulics Auto-reset & folding
- Road lights Standard
- Adjustment Roller = pin
- Running gear SF7 / SF9 = 600/50-22.5

Model	Working Width	Transport Width	Number of Legs	Leg Spacing	Max Leg Depth	Protection	Weight
SF7SP - Folding	4.7m	2.90m	7	650mm	500mm	Shear-pin	7,204kg
SF7AR - Folding	4.7m	2.90m	7	650mm	500mm	Auto-reset	8,014kg
SF9SP - Folding	5.9m	2.90m	9	650mm	500mm	Shear-pin	8,248kg
SF9AR - Folding	5.9m	2.90m	9	650mm	500mm	Auto-reset	8,818kg

SUBSOILER

COMPACTION RELIEF

- + V-Formation lifts soil in a wave
- + Leg protection from impact
- + Easy-change points
- + 500mm max depth for deep pans
- + MULTIPACKA consolidating roller
- + Replaceable rings on MULTIPACKA

MODELS

Code	Description
SF7SP	TRAILED SUBSOILER 7 - 7 leg sub-soiler with shear-pin protection and MULTIPACKA. Hydraulically folding.
SF7AR	TRAILED SUBSOILER 7 - 7 leg sub-soiler with auto-reset protection and MULTIPACKA. Hydraulically folding.
SF9SP	TRAILED SUBSOILER 9 - 9 leg sub-soiler with shear-pin protection and MULTIPACKA. Hydraulically folding.
SF9AR	TRAILED SUBSOILER 9 - 9 legged sub-soiler with auto-reset protection and MULTIPACKA. Hydraulically folding.

OPTIONS

Code	Description	Code	Description
SF.SFK	Seeder fitting kit with steps	SF .SWB1267	Cat 3 ring hitch
SF.SWA 2618	Seeder mount only	SF .SWB1368	Cat 4 ring hitch
Turbo-jet8-icon	Turbojet8-icon	SF .SWB1248	Cat 4 swivel ball hitch
Turbo-jet10-icon	Turbojet10-icon	SF .SWB1258	Cat 5 swivel ball hitch
SF.TSDO	SDO fitting kit for folding frame machines	SF .SWB1280	K80 spoon hitch
SF.SDO	SDO coulters (1 per leg)	SF .TMLMD	Linkage mounted drawbar
SF.SLD	SUBSOILER straight leading disc (1 per leg)	SF .SWB1283	Cat 3 lower link arms
SF.RD	Rear drawbar		
SF.3SK	3rd service kit		
SF.ABK	Air brake Kit		

DEEP TILLAGE

SHALLOW TILLAGE

DRILLING TECHNOLOGY

GRASSLAND MACHINERY

ACCESSORIES

DEEP TILLAGE



The Rippa effectively revives saddened or slumped soils via an arrangement of aggressive tines. Aerating the soil prior to planting can encourage root growth, improving the flow of oxygen and nutrients through the soil and help prevent future runoff.

RIPPA - MOUNTED

Specification

- Tractor attachment Cat 3, three-point linkage
- Hydraulics N/A
- Road lights Standard
- Adjustment Depth wheels = pin
- Running gear N/A

Model	Working Width	Transport Width	Number of Legs	Leg Spacing	Max Leg Depth	Protection	Weight
R3 - Rigid	3.0m	3.00m	11	270mm	400mm	Shear-pin	1,425kg
R4F - Folding	4.0m	3.00m	15	270mm	400mm	Shear-pin	2,280kg
R6F - Folding	6.0m	3.00m	23	270mm	400mm	Shea- pin	3,240kg

RIPPA

DEEP AERATION

- + Deep working cultivation tines
- + Leg protection from impact
- + Reversible 80mm wide point
- + 400mm max depth for deep pans
- + Puncture proof depth wheels
- + Improves soil health

MODELS

Code	Description
R3	MOUNTED RIPPA 3 - 11 leg deep tine cultivator, c/w depth wheels and rigid frame.
R4F	MOUNTED RIPPA 4F - 15 leg deep tine cultivator, c/w depth wheels and folding frame.
R6F	MOUNTED RIPPA 5F - 23 leg deep tine cultivator, c/w depth wheels and folding frame.

DEEP TILLAGE

SHALLOW TILLAGE

DRILLING TECHNOLOGY

GRASSLAND MACHINERY

ACCESSORIES

SHALLOW TILLAGE



The LDS alleviates subsurface compaction with minimal surface disturbance, creating a well structured, aerated and free-draining soil.

Serrated rubber mounted discs open the ground ahead of the low-disturbance leg, which lifts the soil relieving any compaction. A choice of following roller firms the ground.

LDS - MOUNTED

Specification

- Tractor attachment Cat 3 & Cat 4, three-point linkage
- Hydraulics Auto-reset
- Road lights Standard
- Adjustment Legs & roller = pin adjustment
- Running gear N/A

Model	Working Width	Transport Width	Number of Legs	Leg Spacing	Number of Discs	Packer Type	Weight
LDS3F/R/M - Rigid	3.0m	3.10m	6	500mm	6	Flat / Rings / MULTIPACKA	2,450kg
LDS4F/R/M - Folding	4.0m	2.90m	8	500mm	8	Flat / Rings / MULTIPACKA	3,315kg
LDS5F/R/M - Folding	5.0m	2.90m	10	500mm	10	Flat / Rings / MULTIPACKA	3,990kg

LDS LOW-DISTURBANCE COMPACTION RELIEF

- + Serrated discs to cut through the surface
- + Rubber mounted discs
- + Low profile leg & foot
- + Auto-reset legs
- + Easy 1-pin depth adjustment
- + Choice of roller to suit conditions

MODELS

Code	Description
LDS3.FAR	MOUNTED LDS 3R - 3.0m low-disturbance sub-soiler c/w 6 x serrated discs, 6 x auto-reset low-disturbance legs, rigid frame and flat roller.
LDS3.RAR	MOUNTED LDS 3R - 3.0m low-disturbance sub-soiler c/w 6 x serrated discs, 6 x auto-reset low-disturbance legs, rigid frame and ring packer.
LDS3.MAR	MOUNTED LDS 3M - 3.0m low-disturbance sub-soiler c/w 6 x serrated discs, 6 x auto-reset low-disturbance legs, rigid frame and Multipacka.
LDS4.FAR	MOUNTED LDS 4R - 4.0m low-disturbance sub-soiler c/w 8 x serrated discs, 8 x auto-reset low-disturbance legs, folding frame and flat roller.
LDS4.RAR	MOUNTED LDS 4R - 4.0m low-disturbance sub-soiler c/w 8 x serrated discs, 8 x auto-reset low-disturbance legs, folding frame and ring packer.
LDS4.MAR	MOUNTED LDS 4M - 4.0m low-disturbance sub-soiler c/w 8 x serrated discs, 8 x auto-reset low-disturbance legs, folding frame and Multipacka.
LDS5.FAR	MOUNTED LDS 5R - 5.0m low-disturbance sub-soiler c/w 10 x serrated discs, 10 x auto-reset low-disturbance legs, folding frame and flat roller.
LDS5.RAR	MOUNTED LDS 5R - 5.0m low-disturbance sub-soiler c/w 10 x serrated discs, 10 x auto-reset low-disturbance legs, folding frame and ring packer.
LDS5.MAR	MOUNTED LDS 5M - 5.0m low-disturbance sub-soiler c/w 10 x serrated discs, 10 x auto-reset low-disturbance legs, folding frame and Multipacka.

OPTIONS

Code	Description	Code	Description
LDS.SFK	Seeder fitting kit with steps	LDS.MSDO	SDO fitting kit for rigid frame machines
LDS.SWA 2618	Seeder mount only	LDS.TSDO	SDO fitting kit for folding frame machines
Turbo-jet8-icon	Turbojet8-icon	LDS.SDO	SDO coulter (1 per leg)
Turbo-jet10-icon	Turbojet10-icon		

DEEP TILLAGE

SHALLOW TILLAGE

DRILLING TECHNOLOGY

GRASSLAND MACHINERY

ACCESSORIES

SHALLOW TILLAGE



The LDS alleviates subsurface compaction with minimal surface disturbance, creating a well structured, aerated and free-draining soil.

Serrated rubber mounted discs open the ground ahead of the low-disturbance leg, which lifts the soil relieving any compaction. A choice of following roller firms the ground.

LDS - TRAILED

Specification

- Tractor attachment Cat 3 ring hitch
- Hydraulics Auto-reset, drawbar adjustment & folding
- Road lights Standard
- Adjustment Drawbar = hydraulic / Legs & roller = pin adjustment
- Running gear 600/50-22.5

Model	Working Width	Transport Width	Number of Legs	Leg Spacing	Number of Discs	Packer Type	Weight
LDS5 R/M - Trailing Trailed	5.0m	2.9m	10	500mm	10	Rings / MULTIPACKA	10,300kg
LDS6 R/M - Trailing Trailed	6.0m	2.9m	12	500mm	12	Rings / MULTIPACKA	11,150kg

LDS | LOW-DISTURBANCE COMPACTION RELIEF

- + Serrated discs cut through the surface
- + Shock-absorbing rubber mounted discs
- + Low profile leg & foot
- + Auto-reset legs
- + Easy 1-pin depth adjustment
- + Choice of roller to suit conditions

MODELS

Code	Description
LDS5TF.RP	TRAILED LDS 5R - 5.0m low-disturbance sub-soiler c/w 10x serrated discs, 10 x auto-reset low-disturbance legs, folding frame and ring packer.
LDS5TF.MP	TRAILED LDS 5M - 5.0m low-disturbance sub-soiler c/w 10 x serrated discs, 10 x auto-reset low-disturbance legs, folding frame and MULTIPACKA.
LDS6TF.RP	TRAILED LDS 6R - 6.0m low-disturbance sub-soiler c/w 12 x serrated discs, 12 x auto-reset low-disturbance legs, folding frame and ring packer.
LDS6TF.MP	TRAILED LDS 6M - 6.0m low-disturbance sub-soiler c/w 12 x serrated discs, 12 x auto-reset low-disturbance legs, folding frame and MULTIPACKA.

OPTIONS

Code	Description	Code	Description
LDSTF.SFK	Seeder fitting kit with steps	LDSTF.SWB1267	Cat 3 ring hitch
LDSTF.SWA 2618	Seeder mount only	LDSTF.SWB1368	Cat 4 ring hitch
Turbo-jet8-icon	Turbojet8-icon	LDSTF.SWB1248	Cat 4 swivel ball hitch
Turbo-jet10-icon	Turbojet10-icon	LDSTF.SWB1258	Cat 5 swivel ball hitch
LDSTF.TSDO	SDO fitting kit for folding frame machines	LDSTF.SWB1280	K80 spoon hitch
LDSTF.SDO	SDO coulter (1 per leg)	LDSTF.TMLMD	Linkage mounted drawbar
LDSTF.RD	Rear drawbar	LDSTF.SWB1283	Cat 3 lower link arms
LDSTF.3SK	3rd service kit		
LDSTF.ABK	Air brake Kit		

DEEP TILLAGE

SHALLOW TILLAGE

DRILLING TECHNOLOGY

GRASSLAND MACHINERY

ACCESSORIES

SHALLOW TILLAGE



The Front MULTIPACKA press works ahead of the tractor to cultivate and consolidate the ground, ahead of cultivation or drilling.

The steering headstock's clever design allows the tractor to steer along the field when lowered and lock the press into position when raised for transport.

MULTIPACKA - FRONT

Specification

- Tractor attachment Cat 2, front linkage
- Hydraulics Levelling paddles
- Road lights Standard
- Adjustment Levelling paddles = hydraulic / rigid tines = pin
- Running gear N/A

Model	Working Width	Transport Width	Packer diameter	Packer Type	Paddle Tines	Rigid Tines	Weight
FP3.MP - Rigid	3.0m	3.00m	609mm	MULTIPACKA	Optional	Optional	1,350kg
FP4.MP - Folding	4.0m	2.90m	609mm	MULTIPACKA	Optional	Optional	2,150kg

MULTIPACKA

FRONT-MOUNTED PRESS

- + Steering headstock
- + Automatic transport lock
- + MULTIPACKA cultivates & consolidates
- + Works with various cultivators or drills
- + Firms the ground ahead of tractor
- + Tine options available

MODELS

Code	Description
FP3.MP	FRONT MULTIPACKA FP 3 - 3.0m front mounted press c/w steering headstock, rigid frame and MULTIPACKA roller.
FP4F.MP	FRONT MULTIPACKA FP 4R - 4.0m front mounted press c/w steering headstock, folding frame and MULTIPACKA roller.

OPTIONS

Code	Description
FP.FMPA	Levelling paddles
FP.SWA421	Rigid tine assembly (per tine)

DEEP TILLAGE

SHALLOW TILLAGE

DRILLING TECHNOLOGY

GRASSLAND MACHINERY

ACCESSORIES

SHALLOW TILLAGE



This MULTIPRESS cultivator is designed to till, level, and press on ploughed, cultivated soil or stubble before the drill, leaving a weatherproof surface.

Heavy duty sprung loaded tines break the ground, incorporate trash and create fissures. Hydraulic paddle tines follow, levelling the ground ready for pressing with the MULTIPACKA.

MULTIPRESS - MOUNTED

Specification

- Tractor attachment Cat 3, three-point linkage
- Hydraulics Levelling paddles
- Road lights Standard
- Adjustment roller = pin adjustment / leg = spring adjustment / Paddles = hydraulic
- Running gear N/A

Model	Working Width	Transport Width	Number of Tines	Tine Spacing	Max Tine Depth	Packer	Weight
MUL3 - Mounted	3.0m	3.00m	10	300mm	250mm	Sharp	2,440kg
MUL3 - Mounted	3.0m	3.00m	10	300mm	250mm	Channel	6,950kg
MUL3 - Mounted	3.0m	3.00m	10	300mm	250mm	Roller	6,950kg
MUL3 - Mounted	3.0m	3.00m	10	300mm	250mm	MULTIPACKA	6,950kg

MULTIPRESS

HIGH-SPEED TINE CULTIVATOR

- + Heavy-duty spring loaded tines
- + 310mm wide points for stubble
- + Narrow chisel points for ploughing
- + Hydraulically adjustable levelling paddles
- + Choice of packers to suit conditions
- + Tractor mounted

MODELS

Code	Description
MUL3.SP	MOUNTED MULTIPRESS 3 - 3.0m cultivator c/w 10 x spring loaded tines, levelling tines and sharp packer mounted in a rigid frame.
MUL3.CP	MOUNTED MULTIPRESS 3 - 3.0m cultivator c/w 10 x spring loaded tines, levelling tines and channel packer mounted in a rigid frame.
MUL3.RP	MOUNTED MULTIPRESS 3 - 3.0m cultivator c/w 10 x spring loaded tines, levelling tines and roller packer mounted in a rigid frame.
MUL3.MP	MOUNTED MULTIPRESS 3 - 3.0m cultivator c/w 10 x spring loaded tines, levelling tines and roller packer mounted in a rigid frame.

OPTIONS

Code	Description
MUL.SFK	Seeder fitting kit with steps
MUL.SWA2618	Seeder mount only
Turbo-jet8-icon	Turbojet8-icon
Turbo-jet10-icon	Turbojet10-icon

DEEP TILLAGE

SHALLOW TILLAGE

DRILLING TECHNOLOGY

GRASSLAND MACHINERY

ACCESSORIES

SHALLOW TILLAGE



This MULTIPRESS cultivator is designed to till, level, and press on ploughing, cultivated soil or stubble before the drill, leaving a weatherproof surface.

Heavy duty sprung loaded tines break the ground, incorporate trash and create fissures. Hydraulic paddle tines follow, levelling the ground ready for pressing with the MULTIPACKA.

MULTIPRESS - TRAILED

Specification

- Tractor attachment Cat 3 ring hitch
- Hydraulics Levelling paddles & folding
- Road lights Standard
- Adjustment Roller = pin adjustment / leg = spring adjustment / Paddles = hydraulic
- Running gear 600/50-22.5

Model	Working Width	Transport Width	Number of Tines	Tine Spacing	Max Tine Depth	Packer	Weight
MUL5 - Trailed	5.0m	2.80m	16	300mm	250mm	Sharp	6,950kg
MUL5 - Trailed	5.0m	2.80m	16	300mm	250mm	Channel	6,950kg
MUL5 - Trailed	5.0m	2.80m	16	300mm	250mm	Roller	6,950kg
MUL5 - Trailed	5.0m	2.80m	16	300mm	250mm	MULTIPACKA	6,950kg
MUL6 - Trailed	6.0m	2.80m	20	300mm	250mm	Sharp	7,770kg
MUL6 - Trailed	6.0m	2.80m	20	300mm	250mm	Channel	7,770kg
MUL6 - Trailed	6.0m	2.80m	20	300mm	250mm	Roller	7,770kg
MUL6 - Trailed	6.0m	2.80m	20	300mm	250mm	MULTIPACKA	7,770kg

MULTIPRESS

HIGH-SPEED TINE CULTIVATOR

- + Heavy-duty spring loaded tines
- + 310mm wide points for stubble
- + Narrow chisel points for ploughing
- + Hydraulically adjustable levelling paddles
- + Choice of packers to suit conditions
- + Parallel drawbar for trailed machines

MODELS

Code	Description
MUL5.SP	TRAILED MULTIPRESS 5 - 5.0m cultivator c/w 16 x spring loaded tines, levelling tines and sharp packer mounted in a rigid frame.
MUL5.CP	TRAILED MULTIPRESS 5 - 5.0m cultivator c/w 16 x spring loaded tines, levelling tines and channel packer mounted in a rigid frame.
MUL5.RP	TRAILED MULTIPRESS 5 - 5.0m cultivator c/w 16 x spring loaded tines, levelling tines and roller packer mounted in a rigid frame.
MUL5.MP	TRAILED MULTIPRESS 5 - 5.0m cultivator c/w 16 x spring loaded tines, levelling tines and MULTIPACKA mounted in a rigid frame.
MUL6.SP	TRAILED MULTIPRESS 6 - 6.0m cultivator c/w 20 x spring loaded tines, levelling tines and sharp packer mounted in a rigid frame.
MUL6.CP	TRAILED MULTIPRESS 6 - 6.0m cultivator c/w 20 x spring loaded tines, levelling tines and channel packer mounted in a rigid frame.
MUL6.RP	TRAILED MULTIPRESS 6 - 6.0m cultivator c/w 20 x spring loaded tines, levelling tines and roller packer mounted in a rigid frame.
MUL6.MP	TRAILED MULTIPRESS 6 - 6.0m cultivator c/w 20 x spring loaded tines, levelling tines and roller packer mounted in a rigid frame.

OPTIONS

Code	Description	Code	Description
MUL.SFK	Seeder fitting kit with steps	MUL. SWB1267	Cat 3 ring hitch
MUL. SWA2618	Seeder mount only	MUL. SWB1368	Cat 4 ring hitch
Turbo- jet8-icon	Turbojet8-icon	MUL. SWB1248	Cat 4 swivel ball hitch
Turbo- jet10-icon	Turbojet10-icon	MUL. SWB1258	Cat 5 swivel ball hitch
MUL.RD	Rear drawbar	MUL. WB1280	K80 spoon hitch
MUL.3SK	3rd service kit	MUL.LMD	Linkage mounted drawbar
MUL.ABK	Air brake Kit	MUL. SWB1283	Cat 3 lower link arms

DEEP TILLAGE

SHALLOW TILLAGE

DRILLING TECHNOLOGY

GRASSLAND MACHINERY

ACCESSORIES

SHALLOW TILLAGE



Heavy duty shallow disc cultivator that stays in work while travelling at high speeds - perfect for tilling and levelling in primary and secondary cultivations.

Discs are mounted on independently suspended arms for extra durability. The disc formation creates a vigorous snake-like churn resulting in intensive trash mix mixing at speed.

MIXIDISC S - MOUNTED & TRAILED

Specification

- Tractor attachment S3 / S4 = Cat 3, three-point linkage, S5 / S6 / S7 = Cat 3 ring hitch
- Hydraulics S5 / S6 / S7 = drawbar, paddles & folding
- Road lights Standard
- Adjustment Roller = pin adjustment / S5 / S6/ S7 = drawbar & paddles = hydraulic
- Running gear S5 / S6 / S7 = 600/50-22.5

Model	Working Width	Transport Width	Number of Discs	Disc Diameter	Max Disc Depth	Packer	Weight
MIX3 - Mounted	3.0m	3.00m	24	500mm	100mm	MULTIPACKA	2,010kg
MIX4 - Mounted	4.0m	2.80m	32	500mm	100mm	MULTIPACKA	3,220kg
TMIX6 - Trailed	5.0m	3.00m	40	500mm	100mm	MULTIPACKA	6,860kg
TMIX6 - Trailed	6.0m	3.00m	48	500mm	100mm	MULTIPACKA	7,985kg
TMIX7 - Trailed	7.0m	3.00m	56	500mm	100mm	MULTIPACKA	9,005kg

MIXIDISC S | HIGH-SPEED TINE CULTIVATOR

- + Double row of 500mm dia disc
- + Discs chop trash and break the surface
- + Hydraulically adjustable levelling paddles
- + Paddles fill in and level furrows
- + MULTIPACKA consolidates the ground
- + Locks in moisture and helps drainage

MODELS

Code	Description
MIX3	MOUNTED MIXIDISC S3 - 3.0m cultivator c/w 24 x 500mm dia concave discs, levelling tines and MULTIPACKA mounted in a rigid frame.
MIX4	MOUNTED MIXIDISC S4 - 4.0m cultivator c/w 32 x 500mm dia concave discs, levelling tines and MULTIPACKA mounted in a hydraulic folding frame.
TMIX5	TRAILED MIXIDISC S5 - 5.0m cultivator c/w 40 x 500mm dia concave discs, levelling tines and MULTIPACKA mounted in a hydraulic folding frame.
TMIX6	TRAILED MIXIDISC S6 - 6.0m cultivator c/w 48 x 500mm dia concave discs, levelling tines and MULTIPACKA mounted in a hydraulic folding frame.
TMIX7	TRAILED MIXIDISC S7 - 7.0m cultivator c/w 56 x 500mm dia concave discs, levelling tines and MULTIPACKA mounted in a hydraulic folding frame.

OPTIONS

Code	Description	Code	Description
MIX/TMIX. SFK	Seeder fitting kit with steps	TMIX. SWB1267	Cat 3 ring hitch
MIX/TMIX. SWA2618	Seeder mount only	TMIX. SWB1368	Cat 4 ring hitch
Turbo- jet8-icon	Turbojet8-icon	TMIX. SWB1248	Cat 4 swivel ball hitch
Turbo- jet10-icon	Turbojet10-icon	TMIX. SWB1258	Cat 5 swivel ball hitch
TMIX.WE	Wheel eradicators	TMIX. WB1280	K80 spoon hitch
TMIX.RD	Rear drawbar	TMIX.LMD	Linkage mounted drawbar
TMIX.3SK	3rd service kit	TMIX. SWB1283	Cat 3 lower link arms
TMIX.ABK	Air brake Kit		

DEEP TILLAGE

SHALLOW TILLAGE

DRILLING TECHNOLOGY

GRASSLAND MACHINERY

ACCESSORIES

SHALLOW TILLAGE



The VAXIO is a high-speed and versatile cultivator which combines both surface cultivation and loosening at depth, with levelling and consolidation all in one pass.

Capable of creating a seedbed, retaining soil moisture, alleviating soil compaction, all at high-speed. Encompassed in a minimal maintenance design.

VAXIO - TRAILED

Specification

- Tractor attachment Lower link arms hitch
- Hydraulics Drawbar, paddles, discs & folding
- Road lights Standard
- Adjustment Roller = pin adjustment / leg = spring adjustment / drawbar, paddles, discs = hydraulic
- Running gear 600/50-22.5

Model	Working Width	Transport Width	Number of Tines	Number of Discs	Max Disc Depth	Packer	Weight
V4 - Trailed	4.0m	3.00m	13	32	100mm	MULTIPACKA	7,380kg
V6- Trailed	6.0m	3.00m	20	48	100mm	MULTIPACKA	9,224kg

VAXIO

HIGH-SPEED COMBINATION CULTIVATOR

- + Hydraulic double row of scalloped discs
- + 230mm disc spacing
- + Spring loaded HD tines
- + 310mm wide cultivation point
- + Hydraulic Paddles fill in and level furrows
- + Diamond pack or MULTIPACKA

MODELS

Code	Description
V4.MP	TRAILED VAXIO 4 - 4.0m cultivator c/w 32 x concave discs, 13 x spring loaded tines, hydraulic levelling tines and MULTIPACKA. Mounted in a folding frame.
V6.MP	TRAILED VAXIO 6 - 6.0m cultivator c/w 48 x concave discs, 20 x spring loaded tines, hydraulic levelling tines and MULTIPACKA. Mounted in a folding frame.

OPTIONS

Code	Description
V.SFK	Seeder fitting kit with steps
V. SWA2618	Seeder mount only
Turbo- jet8-icon	Turbojet8-icon
Turbo- jet10-icon	Turbojet10-icon
V.RD	Rear drawbar
V.3SK	3rd service kit
V.ABK	Air brake Kit

DEEP TILLAGE

SHALLOW TILLAGE

DRILLING TECHNOLOGY

GRASSLAND MACHINERY

ACCESSORIES

SHALLOW TILLAGE



The STRAKE is a high-speed straw rake that produces an unparalleled even-distribution of harvest residues, the creation of tilth and a stale seed bed.

Rows of tungsten tipped tines cover the ground, eliminating clumps of straw whilst cultivating the surface to chit rogue seeds. It's an essential cultivator for both strip-till and direct drilling.

STRAKE - MOUNTED

Specification

- Tractor attachment S6 / S8 = Cat 3, three point linkage, S12 = Cat 3, ring hitch
- Hydraulics All = tines & folding, S12 = drawbar
- Road lights Standard
- Adjustment Alternative tine rows = hydraulic
- Running gear S6 / S8 = N/A | S12 = 560/45 22.5

Model	Working Width	Transport Width	Number of Tines	Tine Spacing	Weight
S6 - Mounted	6.1m	2.50m	80	75mm or 150mm	2,435kg
S8 - Mounted	8.1m	3.00m	107	75mm or 150mm	3,100kg
S12 - Trailed	12.1m	3.00m	160	75mm or 150mm	7,950kg

STRAKE | STRAW RAKE

- + 15mm tungsten tipped tines
- + Retractable alternate rows
- + Spring tines
- + 75mm or 150mm tine spacing
- + Chits rogue seeds and removes straw
- + Hydraulic folding

MODELS

Code	Description
S6	MOUNTED STRAKE 6 - 6.0m high-speed straw rake c/w 80 x spring tines, retractable alternate rows and folding frame.
S8	MOUNTED STRAKE 8 - 8.0m high-speed straw rake c/w 80 x spring tines, retractable alternate rows and folding frame.
S12	TRAILED STRAKE 12 - 12.0m high-speed straw rake c/w 80 x spring tine, retractable alternate rows and folding frame.

OPTIONS

Code	Description
S.SWB1267	Cat 3 ring hitch
S.SWB1368	Cat 4 ring hitch
S.SWB1248	Cat 4 swivel ball hitch
S.SWB1258	Cat 5 swivel ball hitch
S.SWB1280	K80 spoon hitch
S.LMD	Linkage mounted drawbar
S.SWB1283	Cat 3 lower link arms

DEEP TILLAGE

SHALLOW TILLAGE

DRILLING TECHNOLOGY

GRASSLAND MACHINERY

ACCESSORIES

DRILLING TECHNOLOGY



The SUMO Deep Tillage Seeder (DTS) is an exceptionally versatile drilling system, giving the user the option to direct drill into stubble, minimum tillage or plough-based systems.

The SUMO DTS Strip-till coulters system cultivates a strip of soil ahead of the coulter, wide enough and deep enough for crop establishment, without cultivating the whole field.

DTS - MOUNTED

Specification

- Tractor attachment Cat 3, three-point linkage
- Hydraulics Fan, drill markers, coulter pressure
- Road lights Standard
- Coulter pressure 40 bar max
- Running gear N/A

Model	Working Width	Hopper Capacity	Row Spacing	N° Rows	Double Seed Row	Seed Row Width	Weight
DTS 3 - MOUNTED	3.0m	1,900l	333mm	9	Std	120mm	3,280kg
DTS 3T - MOUNTED	3.0m	n/a	333mm	9	Std	120mm	2,890kg
DTS 4TF - MOUNTED	4.0m	n/a	333mm	12	Std	120mm	3,995kg

DTS | STRIP-TILL TECHNOLOGY

- + SUMO DTS Strip-till couler
- + Tungsten carbide tipped HD tines
- + Covering Discs & press wheels
- + SUMO ORGA metering system
- + Variable seed rate drilling
- + Grain & fertiliser options

MODELS

Code	Description
DTS3	MOUNTED DTS 3 - 3.0m strip-till drill, c/w 9 x DTS Strip-till double row coulters and a hydraulic driven fan.
DTS3T	DTS 3 TOOLBAR - 3.0m mounted strip-till couler bar, c/w 9 x DTS Strip-till double row coulters.
DTS4TF	DTS 4 TOOLBAR - 4.0m mounted & hydraulically folding strip-till couler bar, c/w 12 x DTS Strip-till double row coulters.



1 - 18" STRAIGHT SERRATED DISC

2 - CULTIVATING TINE

3 - SEED & FERTILISER COULTER

4. COVERING DISCS

5. FIRING WHEEL FOR CONSOLIDATION

DEEP TILLAGE

SHALLOW TILLAGE

DRILLING TECHNOLOGY

GRASSLAND MACHINERY

ACCESSORIES

DRILLING TECHNOLOGY



The SUMO Deep Tillage Seeder (DTS) is an exceptionally versatile drilling system, giving the user the option to direct drill into stubble, minimum tillage or plough-based systems.

The SUMO DTS Strip-till coulters system cultivates a strip of soil ahead of the coulter, wide enough and deep enough for crop establishment, without cultivating the whole field.

DTS - TRAILED

Specification

- Tractor attachment Cat 3 ring hitch
- Hydraulics Fan, drill markers, folding, coulter pressure
- Road lights Standard
- Coulter pressure 40 bar max
- Running gear DTS4 DTS5 = 560/45-22.5 DTS6 = 600/50-22.5 DTS8/DTS9 = 710/35-22.5

Model	Working Width	Hopper Capacity	Row Spacing	N° Rows	Double Seed Row	Seed Row Width	Weight
DTS 4 - TRAILED	4.0m	3,600l	333mm	12	Std	120mm	6,600kg
DTS 5 - TRAILED	5.0m	3,600l	333mm	15	Std	120mm	8,060kg
DTS 6 - TRAILED	6.0m	3,600l	333mm	18	Std	120mm	9,550kg
DTS 8 - TRAILED	8.0m	3,600l	333mm	24	Std	120mm	11,130kg
DTS 9 - TRAILED	9.0m	3,600l	333mm	26	Std	120mm	12,670kg

DTS | STRIP-TILL TECHNOLOGY

- + SUMO DTS Strip-till couler
- + Tungsten carbide tipped HD tines
- + Covering Discs & press wheels
- + SUMO ORGA metering system
- + Variable seed rate drilling
- + Grain & fertiliser options

MODELS

Code	Description
DTS4	TRAILED DTS 4 - 4.0m strip-till drill, c/w 12 x DTS Strip-till double row coulters, hydraulic driven fan, 560/45-22.5 tyres and hydraulic brakes.
DTS5	TRAILED DTS 5 - 5.0m strip-till drill, c/w 15 x DTS Strip-till double row coulters, hydraulic driven fan, 560/45-22.5 tyres and hydraulic brakes.
DTS6	TRAILED DTS 6 - 6.0m strip-till drill, c/w 18 x DTS Strip-till double row coulters, hydraulic driven fan, 620/40-22.5 tyres and hydraulic brakes.
DTS8	TRAILED DTS 8 - 8.0m strip-till drill, c/w 22 x DTS Strip-till double row coulters, hydraulic driven fan, 710/35-22.5 tyres and hydraulic brakes.
DTS9	TRAILED DTS 9 - 9.0m strip-till drill, c/w 24 x DTS Strip-till double row coulters, hydraulic driven fan, 710/35-22.5 tyres and hydraulic brakes.



1 - 18" STRAIGHT SERRATED DISC

2 - CULTIVATING TINE

3 - SEED & FERTILISER COULER

4. COVERING DISCS

5. FIRING WHEEL FOR CONSOLIDATION

DEEP TILLAGE

SHALLOW TILLAGE

DRILLING TECHNOLOGY

GRASSLAND MACHINERY

ACCESSORIES

DRILLING TECHNOLOGY



The DD system is a zero-till system, crop residues left in the field are incorporated into the soil by the DD coulters as it places seed in the ground.

The DD coulters loosen only the minimum amount of soil needed for seed germination, the narrow row width is wide enough for seed establishment.

DD - MOUNTED

Specification

- Tractor attachment Cat 3, three-point linkage
- Hydraulics Fan, drill markers, coulters pressure
- Road lights Standard
- Coulters pressure 40 bar max
- Running gear N/A

Model	Working Width	Hopper Capacity	Row Spacing	N° Rows	Double Seed Row	Seed Row Width	Weight
DD 3 - MOUNTED	3.0m	1,900l	187mm	16	Std	187mm	3,280kg
DD 3T - MOUNTED	3.0m	n/a	200mm	16	Std	187mm	2,890kg
DD 4T - MOUNTED	4.0m	n/a	200mm	20	Std	200mm	3,995kg

DD | DIRECT-DRILLING TECHNOLOGY

- + SUMO DD Direct-drill coulters
- + Adjustable seed coulters leg
- + Optimum seed placement
- + SUMO ORGA metering system
- + Variable seed rate drilling
- + Grain & fertiliser options

MODELS

Code	Description
DD3	MOUNTED DD 3 drill - 3.0m mounted direct-drill, c/w 16 x DD direct-drill double row coulters and a hydraulic driven fan.
DD3T	DD 3T TOOLBAR - 3.0m mounted direct-drill coulters bar, c/w 16 x DD direct-drill double row coulters.
DD4TF	DD 4TF TOOLBAR - 4.0m mounted & hydraulically folding strip-till coulters bar, c/w 20 DD direct-drill double row coulters.



1 - SERRATED DISC

2 - SEED & FERTILISER COULTER

3 - SEED BOUNCE TAB

4. DEPTH CONTROL WHEEL

5. FIRING WHEEL FOR CONSOLIDATION

DEEP TILLAGE

SHALLOW TILLAGE

DRILLING TECHNOLOGY

GRASSLAND MACHINERY

ACCESSORIES

DRILLING TECHNOLOGY



The DD system is a zero-till system, crop residues left in the field are incorporated into the soil by the DD coulters as it places seed in the ground.

The DD coulters loosen only the minimum amount of soil needed for seed germination, the narrow row width is wide enough for seed establishment.

DD - TRAILED

Specification

- Tractor attachment Cat 3 ring hitch
- Hydraulics Fan, drill markers, folding, coulters pressure
- Road lights Standard
- Coulters pressure 40 bar max
- Running gear DD4/DD5 = 560/45-22.5 DD6 = 600/50-22.5 DD8/DD9 = 710/35-22.5

Model	Working Width	Hopper Capacity	Row Spacing	N° Rows	Double Seed Row	Seed Row Width	Weight
DD 4 - TRAILED	4.0m	3,600l	200mm	20	Yes	200mm	6,785kg
DD 5 - TRAILED	5.0m	3,600l	208mm	24	Yes	208mm	7,797kg
DD 6 - TRAILED	6.0m	3,600l	200mm	30	Yes	200mm	9,050kg
DD 8 - TRAILED	8.0m	3,600l	200mm	40	Yes	200mm	10,330kg
DD 9 - TRAILED	9.0m	3,600l	200mm	45	Yes	200mm	11,448kg

DD | DIRECT-DRILLING TECHNOLOGY

- + SUMO DD Direct-drill coulters
- + Adjustable seed coulters leg
- + Optimum seed placement
- + SUMO ORGA metering system
- + Variable seed rate drilling
- + Grain & fertiliser options

MODELS

Code	Description
DD4	TRAILED DD 4 - 4.0m direct-drill, c/w 20 x DD Direct-drill double row coulters, hydraulic driven fan, 560/45-22.5 tyres and hydraulic brakes.
DD5	TRAILED DD 5 - 5.0m direct-drill, c/w 24 x DD Direct-drill double row coulters, hydraulic driven fan, 560/45-22.5 tyres and hydraulic brakes.
DD6	TRAILED DD 6 - 6.0m direct-drill, c/w 30 x DD Direct-drill double row coulters, hydraulic driven fan, 620/40-22.5 tyres and hydraulic brakes.
DD8	TRAILED DD 8 - 8.0m direct-drill, c/w 40 x DD Direct-drill double row coulters, hydraulic driven fan, 710/35-22.5 tyres and hydraulic brakes.
DD9	TRAILED DD 9 - 9.0m direct-drill, c/w 45 x DD Direct-drill double row coulters, hydraulic driven fan, 710/35-22.5 tyres and hydraulic brakes.

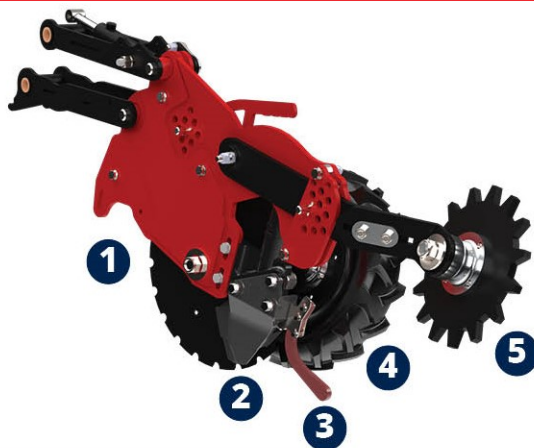

1 - SERRATED DISC

2 - SEED & FERTILISER COULTER

3 - SEED BOUNCE TAB

4. DEPTH CONTROL WHEEL

5. FIRING WHEEL FOR CONSOLIDATION

DEEP TILLAGE

SHALLOW TILLAGE

DRILLING TECHNOLOGY

GRASSLAND MACHINERY

ACCESSORIES

DRILLING TECHNOLOGY



Seeding with the Sumo Front Hopper, complete with hydraulic fan, together with a Sumo DTS, DD or your own toolbar means you'll benefit from a balanced rig, ideal for smaller HP tractors.

The Front Hopper is designed to complement any rear-mounted implement and enables up to 1,000kg of grain or fertiliser to be accurately dispensed via the Sumo ORGA metering system.

FRONT TANK - MOUNTED

Specification

- Tractor attachment Cat 2, front linkage
- Hydraulics Fan
- Road lights Standard
- Seed rate 1-350kg/ha
- Controller RDS Artemis

Model	Seed Rate	Hopper Capacity	Lights	Weight
FH - MOUNTED	1-350kg/ha	1,900l	Yes	850kg

FRONT TANK | DRILLING ACCESSORIES

- + SUMO ORGA metering system
- + Works with DD or DTS toolbars
- + Compatible with other toolbars
- + Handle grain or fertiliser
- + GPS compatible
- + One-touch calibration

MODELS

Code	Description
FH	MOUNTED FRONT TANK FH - Front mounted seed hopper, 1,900 litres and c/w lights.

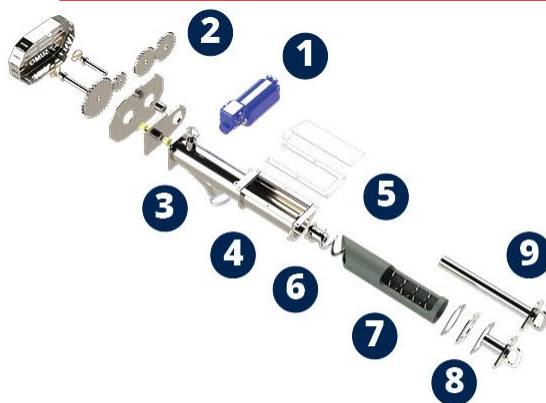

1 - ELECTRIC DRIVE

2 - INTERCHANGEABLE GEARS

3 - CALIBRATION TUBE

4. HOUSING

5. SHUT OFF SLIDE

6 - ORGA FLIGHT

7 - NYLON INTERNAL INSERT

8 - SHORT INTERNAL INSERT

9 - LONG INTERNAL INSERT

DEEP TILLAGE

SHALLOW TILLAGE

DRILLING TECHNOLOGY

GRASSLAND MACHINERY

ACCESSORIES

DRILLING TECHNOLOGY



The Crimper rolls and breaks cover crops, preparing the field ahead of drilling, reducing reliance of herbicides.

The crimping blades are fixed to a 508mm packer. Manufactured with Hardox steel to ensure a long working lifetime and the unique bolt on blades mean wear-and-tear isn't an issue.

CRIMPER - FRONT

Specification

- Tractor attachment Cat 2, front linkage
- Hydraulics N/A
- Road lights Standard
- Adjustment None
- Running gear N/A

Model	Working Width	Transport Width	Packer diameter	Packer Type	Head-stock	Weight
FP3.CRI - Rigid	3.0m	3.00m	508mm	CRIMPER	Steering	1,350kg
FP4.CRI - Folding	4.0m	2.90m	508mm	CRIMPER	Steering	1,590kg
FP6.CRI - Folding	6.0m	2.90m	508mm	CRIMPER	Steering	2,150kg

CRIMPER

FRONT CROP-CRIMPER

- + Steering headstock with transport lock
- + Water ballast possible
- + Front & rear lights
- + Personalised nameplate
- + Lockable toolbox
- + Hi-vis stickers

MODELS

Code	Description
FP3.CRI	FRONT CRIMPER CRI 3 - 3.0m front mounted crop crimper c/w steering headstock, rigid frame and CRIMPER roller.
FP4F.CRI	FRONT CRIMPER CRI 4R - 4.0m front mounted crop crimper c/w steering headstock, folding frame and CRIMPER roller.
FP6.CRI	FRONT CRIMPER CRI 6 - 6.0m front mounted crop crimper c/w steering headstock, folding frame and CRIMPER roller.

DEEP TILLAGE

SHALLOW TILLAGE

DRILLING TECHNOLOGY

GRASSLAND MACHINERY

ACCESSORIES

GRASSLAND MACHINERY



The GLS grassland sub-soiler is designed to alleviate subsoil compaction by opening the sward and lifting the soil to improve drainage and airflow.

Serrated rubber mounted discs open the ground ahead of the low-disturbance leg, which lifts the soil relieving any compaction. A flat roller firms the ground, whilst its teeth aerate the sward.

GLS - MOUNTED

Specification

- Tractor attachment Cat 3, three-point linkage
- Hydraulics Auto-reset
- Road lights Standard
- Adjustment Legs & roller = pin adjustment
- Running gear N/A

Model	Working Width	Transport Width	Number of Legs	Leg Spacing	Number of Discs	Packer Type	Weight
GLS3.AR - Rigid	2.3m	2.50m	3	833mm	3	Flat	1,490kg
GLS4.AR - Rigid	2.3m	2.50m	4	580mm	4	Flat	1,625kg
GLS5.AR - Rigid	2.8m	2.90m	5	580mm	5	Flat	1,875kg

- + Serrated discs to cut through the surface
- + Rubber mounted discs
- + Low profile leg & foot
- + Auto-reset legs
- + Easy 1-pin depth adjustment
- + Flat packer with teeth firms and aerates

MODELS

Code	Description
GLS3.AR	MOUNTED GLS 3AR - 2.3m low-disturbance sub-soiler c/w 3 x serrated discs, 3 x auto-reset low-disturbance legs, rigid frame and flat roller.
GLS4.AR	MOUNTED GLS 4AR - 2.3m low-disturbance sub-soiler c/w 4 x serrated discs, 4 x auto-reset low-disturbance legs, folding frame and flat roller.
GLS5.AR	MOUNTED GLS 5AR - 2.8m low-disturbance sub-soiler c/w 5 x serrated discs, 5 x auto-reset low-disturbance legs, folding frame and flat roller.

OPTIONS

Code	Description
GLS.SFK	Seeder fitting kit with steps
GLS.SWA 2618	Seeder fitting kit
Turbo-jet8-icon	Turbojet8-icon
Turbo-jet10-icon	Turbojet10-icon
GLS.MSDO	SDO fitting kit for rigid frame machines
GLS.SDO	SDO coulter (1 per leg)
GLS.FHA	Following harrow

DEEP TILLAGE

SHALLOW TILLAGE

DRILLING TECHNOLOGY

GRASSLAND MACHINERY

ACCESSORIES

GRASSLAND MACHINERY



The Sumo Front Grassland Aerator opens up the grassland sward to alleviate compaction, allowing air to flow through the grass roots, letting nutrients enter the soil and aid drainage.

The Sumo Grassland Aerator punctures the soil and shatter the hard pan resulting in more nutritious, thicker and better rooted grass.

AERATOR - FRONT

Specification

- Tractor attachment Cat 2, front linkage
- Hydraulics N/A
- Road lights Standard
- Adjustment None
- Running gear N/A

Model	Working Width	Transport Width	Packer diameter	Packer Type	Head-stock	Weight
FP3.GLA - Rigid	3.0m	3.00m	508mm	Aerator	Steering	1,350kg
FP4.GLA - Folding	4.0m	2.90m	508mm	Aerator	Steering	1,590kg
FP6.GLA - Folding	6.0m	2.90m	508mm	Aerator	Steering	2,150kg

- + 175mm perforators
- + Replaceable bolt-on spikes
- + Steering headstock with transport lock
- + Water ballast possible
- + Front & rear lights
- + Lockable toolbox

MODELS

Code	Description
FP3.GLA	FRONT AERATOR GLA 3 - 3.0m front mounted grassland aerator c/w steering headstock, rigid frame and AERATOR roller.
FP4F.GLA	FRONT AERATOR GLA 4 - 4.0m front mounted grassland aerator c/w steering headstock, folding frame and AERATOR roller.
FP6.GLA	FRONT AERATOR GLA 6 - 6.0m front mounted grassland aerator c/w steering headstock, folding frame and AERATOR roller.

DEEP TILLAGE

SHALLOW TILLAGE

DRILLING TECHNOLOGY

GRASSLAND MACHINERY

ACCESSORIES

ACCESSORIES



The Weight block provides useful ballast for the tractor, the integral toolbox can carry many anything from tools to wearing parts, providing a much-needed place to store cab-floor clutter.

Weight blocks are finished in red & black and feature an internal toolbox, tool tray, high visibility stickers, LED lights and personalised front plate as standard. Bespoke colours are available.

FRONT WEIGHT

Specification

- Tractor attachment Cat 2, front linkage
- Hydraulics N/A
- Road lights Standard
- Adjustment N/A
- Running gear N/A

Model	Weight
FW1	1,000kg
FW1.5	1,500kg
FW2	2,000kg
FW2.5	2,500kg

FRONT WEIGHT | TRACTOR BALLAST

- + Tractor ballast to aid traction
- + Internal storage for tools or parts
- + Lockable lid
- + LED lights
- + Hi-vis tickers
- + Personalised nameplate

MODELS

Code	Description
FW1	FRONT WEIGHT FW1 - 1,000kg tractor mounted weight block with internal storage and lockable lid. Finished in red & black.
FW1.5	FRONT WEIGHT FW1.5 - 1,500kg tractor mounted weight block with internal storage and lockable lid. Finished in red & black.
FW2	FRONT WEIGHT FW2 - 2,000kg tractor mounted weight block with internal storage and lockable lid. Finished in red & black.
FW2.5	FRONT WEIGHT FW2.5 - 2,500kg tractor mounted weight block with internal storage and lockable lid. Finished in red & black.

OPTIONS

Code	Description
FWAC	Alternative colour (Subject to availability)

DEEP TILLAGE

SHALLOW TILLAGE

DRILLING TECHNOLOGY

GRASSLAND MACHINERY

ACCESSORIES

ACCESSORIES

SDO COULTER



The SDO coulters enables a regular cultivator to become a true one-pass crop establishment machine. The SDO / cultivator set up will till the soil, place the seed, and close the furrow for good soil to seed contact, suiting those who seek a more precise and consistent seed placement than simple broadcasting.

Sumo's SDOs can be fitted to any cultivator but are designed specifically to go behind Sumo's deep and shallow cultivators. Growers can choose the number of coulters required based on the cultivator and crop requirements.

Code	Description
MSDO	SDO fitting kit for rigid frame machines
TSDO	SDO fitting kit for folding frame machines
SDO	SDO coulters (cost per leg/coulter)

- + Slim-line, tungsten edged opener
- + Rubber suspension mounts
- + 450mm hardened discs
- + Folds for transport on trailed machines
- + Pin adjustment for depth and pressure
- + Can be fitted to many SUMO machines

SDO & SEEDER

SEEDING ACCESSORIES

SEEDER



The Turbo Jet is a versatile and accurate pneumatic applicator to meter and spread most small products, an ideal machine to establish or rejuvenate pasture, apply low-cost cover crops, or OSR seeding.

This 12v applicator has been designed solely to apply small seed and granular products for use in the agricultural, horticultural and amenity sector. It can spread up to 8-10m dependent on the number of outlets needed.

Code	Description
Turbojet8-icon	Turbojet8-icon
Turbojet10-icon	Turbojet10-icon

- + 1-30kg/ha (based on 3m, 6 row machine)
- + GPS based ICON touch-screen control
- + Stainless steel & plastic internals
- + 12v applicator
- + Robust applicator motor
- + Can be fitted to many SUMO machines

DEEP TILLAGE

SHALLOW TILLAGE

DRILLING TECHNOLOGY

GRASSLAND MACHINERY

ACCESSORIES

Sumo UK Ltd
Redgates, Melbourne, York, YO42 4RG
United Kingdom

www.sumo1.com



| GROWING
WITH YOU