

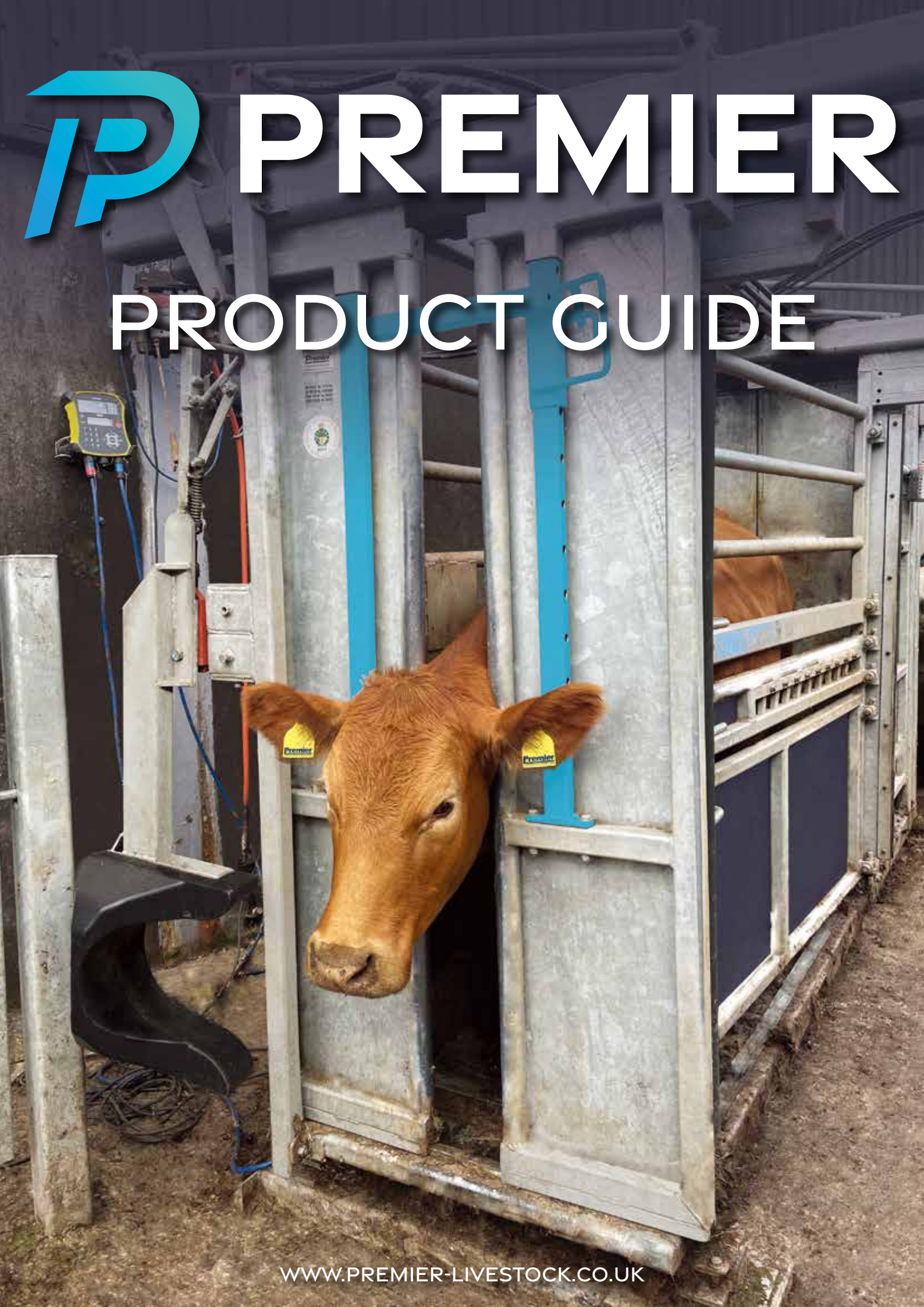

PREMIER

PRODUCT GUIDE



AWARD WINNING LIVESTOCK HANDLING EQUIPMENT

George Clark created Premier Livestock Handling in response to the need for reliable cattle handling systems which would provide greater safety and control when working alone.

George experimented with the handling systems to make his own job easier, and neighbouring farmers took notice as the idea of a safer system was very enticing. As such, George Clark began Premier Livestock Handling and created the Unistock range.

Thorburn Group, newly branded in 2021, has been creating bespoke cattle handling systems since 1977. However, it only recently turned into a full-time aspect of the business in 2016 with its own dedicated manufacturing and installation squad. This new focus made Thorburn Group perfect for taking over the legacy of Premier Livestock. Thorburn Group purchased Premier Livestock in March 2022 and will carry on the vision that George Clark started.

Thorburn Group, based in Duns, looks to continually improve its products as new technology becomes available. At the same time, we are offering a full range of unique cattle handling systems bespoke to your individual needs.

To discuss individual enquiries, please contact our sales team and find out how Thorburn Group can make your farm safer.



GET A QUOTE

CALL

01556 612240

EMAIL

info@premier-livestock.co.uk

ONLINE

www.premier-livestock.co.uk

VISIT

Duns Industrial Estate,
Station Road, Duns,
TD11 3HS



CONTENTS

HEADGATES

- Cattle Headgate
- Forward Catch Cattle Headgate

04

CATTLE CRATES

- Cattle Crate MK1
- Cattle Crate MK2
- Hydraulic Cattle Squeeze Crate
- Extended Manual Squeeze Crate
- Manual Parallel Cattle Squeeze Crate
- Multi-Angular Manual Cattle Squeeze Crate
- Mobile Cattle Crate

08

FEEDING EQUIPMENT

- Cattle Feed Saver Trailer
- Cattle Feed Trailer
- Cattle Ring Feed Saver
- Sheep Ring Feed Saver
- Cattle Feed Saver Bunker

22

ACCESSORIES

- Foot Trimming Attachments
- Cattle Head Scoop
- Tru Test Collection
 - Electronic Weighing Load Bar
 - Electronic Weighing Indicator
 - XRS Cattle Panel Reader
 - XRS Stick Reader

32

GRAIN EQUIPMENT

- Grain Pusher
- Grain Hopper

36

CATTLE HEADGATE



HOW IT WORKS

The Unistock Cattle Crate Headgate design can be operated by one person working alone. This headgate design helps to keep stockmen and animals safe. It can be supplied and fitted to the Unistock Cattle Crate MK1, Unistock Cattle Crate MK2 or the Unistock Mobile Cattle Crate, Manual Squeeze, and Hydraulic Crush. It can also be provided on its own for use in a race system.

The unique safety latch incorporates auto catch and auto re-set facilities enabling the stockman to walk away from the headgate after releasing the animal. The gate will re-lock behind the stockman and hold the next animal in line. Incredibly useful for one person working alone with cattle in a race or auction marts needing to pass high numbers of cattle through a headgate in the shortest possible time.

Neck bar adjustment means that the headgate can cater to various sizes, from calves to cows, without needing tools or add-on accessories.

KEY FEATURES

- Auto catch and auto re-set facility – allows cattle to move quickly through crate or race section.
- Special arrangement enables manual operation if required – useful in the case of a horned cattle or bull with a neck wider than the head.
- Adjustable spring-loaded neck bars – Most sizes of cattle can be catered to - safely and instantly - without the need for add-on accessories or tools.
- Poll bar lowers to restrict upward thrashing of the animal's head – good head control settles the animal, making it easier to tend to them.
 - o The poll bar also slides easily up and down on the box section frame and can be locked in the desired position by a simple trigger mechanism.
- The gate handle is located on the outside of the frame – this allows for safe operation.
 - o The gate handle can also be used to lock the headgate open when there is a requirement to run through a number of animals.
- The Unistock Cattle Headgate is fully sheeted – this ensures that the animal's legs and feet do not become trapped.
- Complete with hot dip galvanised finish to prevent rust.
- There is the option to make the headgate manual.

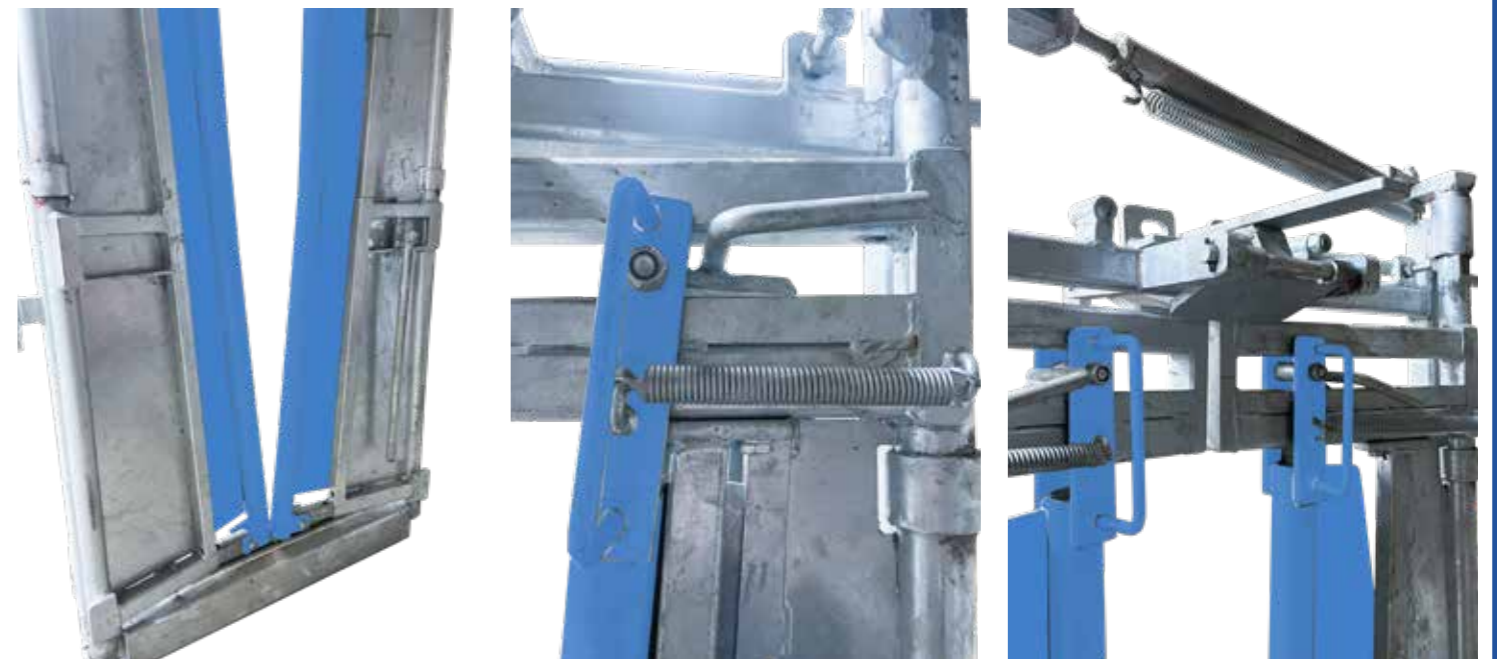

FORWARD CATCH CATTLE HEADGATE



CALL US
FOR A
QUOTE
01556 612240

HOW IT WORKS

The unique patented Unistock Forward Catch Cattle Headgate is robustly built and can be fitted to any Unistock Cattle Crate or used in a race. Furthermore, it is fitted as standard on the new Unistock Cattle Squeeze Crate.

The Unistock Forward Cattle Catch Headgate has all the features of the Unistock Cattle Headgate. In addition, it has been designed to meet the needs of farmers who have stubborn cattle, which will not push the traditional auto-catch headgate into the locked position.

Many systems available in the market depend on the animal's movement to drive the headgate into the latch position. However, the new Forward Catch Headgate allows the headgate doors to lie in a forward catch position encouraging the animal to enter the headgate more readily. The uniquely designed latch then takes advantage of the animal's natural reaction to back away from the headgate - this backwards movement completes the capture process.

KEY FEATURES

- Improved first-time capture rate.
- Reduction in animal and stockman stress level.
- Catches animals in either a forward or backwards movement.
- Special arrangement enables manual operation- useful in the case of a horned cattle or bull with a neck wider than the head.
- Adjustable spring-loaded neck bars – Most sizes of cattle can be catered to - safely and instantly - without the need for add-on accessories or tools.
- Poll bar lowers to restrict upward thrashing of the animal's head – good head control settles the animal, making it easier to tend to them.
 - o The poll bar also slides easily up and down on the box section frame and can be locked in the desired position by a simple trigger mechanism.
- The gate handle is located on the outside of the frame – this allows for safe operation.
 - o The gate handle can also be used to lock the head gate open when there is a requirement to run through a number of animals.
- The Unistock Forward Catch Cattle Headgate is fully sheeted – this ensures that the animal's legs and feet do not become trapped.
- Complete with hot dip galvanised finish to prevent rust.



CATTLE CRATE MK1



HOW IT WORKS

The Unistock Cattle Crate MK1 is substantially built with simple and practical lines, eliminating the clutter and obstructions of other basic crushes. The MK1 can be fitted with either the standard Unistock Cattle Headgate, the Unistock Forward Catch Cattle headgate or even the Unistock Manual Cattle Headgate. This cattle crush offers an ideal solution to daily farmers or beef farmers with suckler cows.

It can be used by one person working alone, providing greater safety and control. When fitted with the optional Unistock Veterinary Area, Unistock Calf Squeeze, Unistock Foot Trim Attachments, Unistock Clipping Arm, or even Electronic Weighing or EID - it can be built into a complete farm management system.

Please note pictures were taken on a working farm.



KEY FEATURES

- The revolving rump bar is a unique revolving bar operated by an external wheel fitted with a strong ratchet lock. This robust bar cannot be displaced and eliminates the need for dangerous loose bars. - Provides safer control at the rear end of the animal even when the side doors are open.
- Shaped doors - ensures that there is enough space for the appropriate shape to accommodate each animal without permitting undue movement.
- Pairs of steel doors extend the entire length of both sides with easy-opening spring catches centrally located. - when the doors open, they give full unrestricted access to the lower half of the animal.
- No vertical loop or obstruction - this provides easy access to the top line, which allows for a continuous sweep with clippers or pour-on while the animal cannot step out of the crate.
- Complete with hot dip galvanised finish to prevent rust.
- There is the option to extend the crate or add a veterinary area.

CONTACT US FOR A QUOTE
INFO@PREMIER-LIVESTOCK.CO.UK

CATTLE CRATE MK2



CALL US
FOR A
QUOTE
01556 612240



HOW IT WORKS

The Unistock Cattle Crate MK2 was designed to give even more access and control than the MK1 whilst maintaining maximum safety. Able to be fitted with the standard Unistock Cattle Headgate, the Unistock Forward Catch Cattle Headgate or even the Unistock Manual Cattle Headgate.

Every effort has been made to maintain the features and benefits of the original MK1 Cattle Crate with the addition of greater access and the inclusion of the unique anti-kick bars as standard.

Again, this cattle crate can be fitted with the optional Unistock Veterinary Area – Sliding/Access Doors, Unistock Calf Squeeze, Unistock Foot Trim Attachments or Unistock Clipping Arm or even electronic weighing or EID to create a complete farm management system.

KEY FEATURES

- Up and over side panels – provide safe, unobstructed access to the upper half of the animal, leaving the lower doors to create an effective shield against injury.
- Anti-kick bars fitted as standard – offers reliable protection during belly clipping of fat cattle.
- The revolving rump bar is a unique revolving bar operated by an external wheel fitted with a strong ratchet lock. This robust bar cannot be displaced and eliminates the need for dangerous loose bars, providing safer control at the rear end of the animal even when the side doors are open.
- Pairs of steel doors extend the entire length of both sides with centrally located easy opening, foot-operated spring catches – when the doors open, they give full unrestricted access to the lower half of the animal.
- Shaped doors - ensures that there is enough space for the appropriate shape to accommodate each animal without permitting undue movement.
- Complete with hot dip galvanised finish to prevent rust.

HYDRAULIC CATTLE SQUEEZE CRATE

HOW IT WORKS

In recent years many customers have expressed their interest in the concept of a squeeze crush but they had been disappointed by the fact that the various limitations of previously available squeeze crushes meant that they did not fulfil their expectations. In reply to this, the Unistock Cattle Squeeze Crate represents natural progression and expansion of the Unistock range of products. It has been developed with the same attention to detail and maintains the same robust construction for which the Unistock Range is widely recognised.

Although it is not a new idea to limit the amount of space available to an animal within the cattle crush, it is now thought to be of particular benefit to apply slight squeeze pressure in order to help calm and reassure the animal whilst the necessary, and often difficult, tasks, like belly clipping, are carried out.

As with other Unistock Cattle Crates, this latest addition to the Range can be combined with Electronic Weighing to create a complete farm management system.

The Unistock Cattle Squeeze Crate with the Unistock Forward Catch Cattle Headgate fitted as standard, has had particular attention given to ease of operation, simplicity of access and, most significantly, overall quietness during use.



Please note pictures were taken on a working farm.

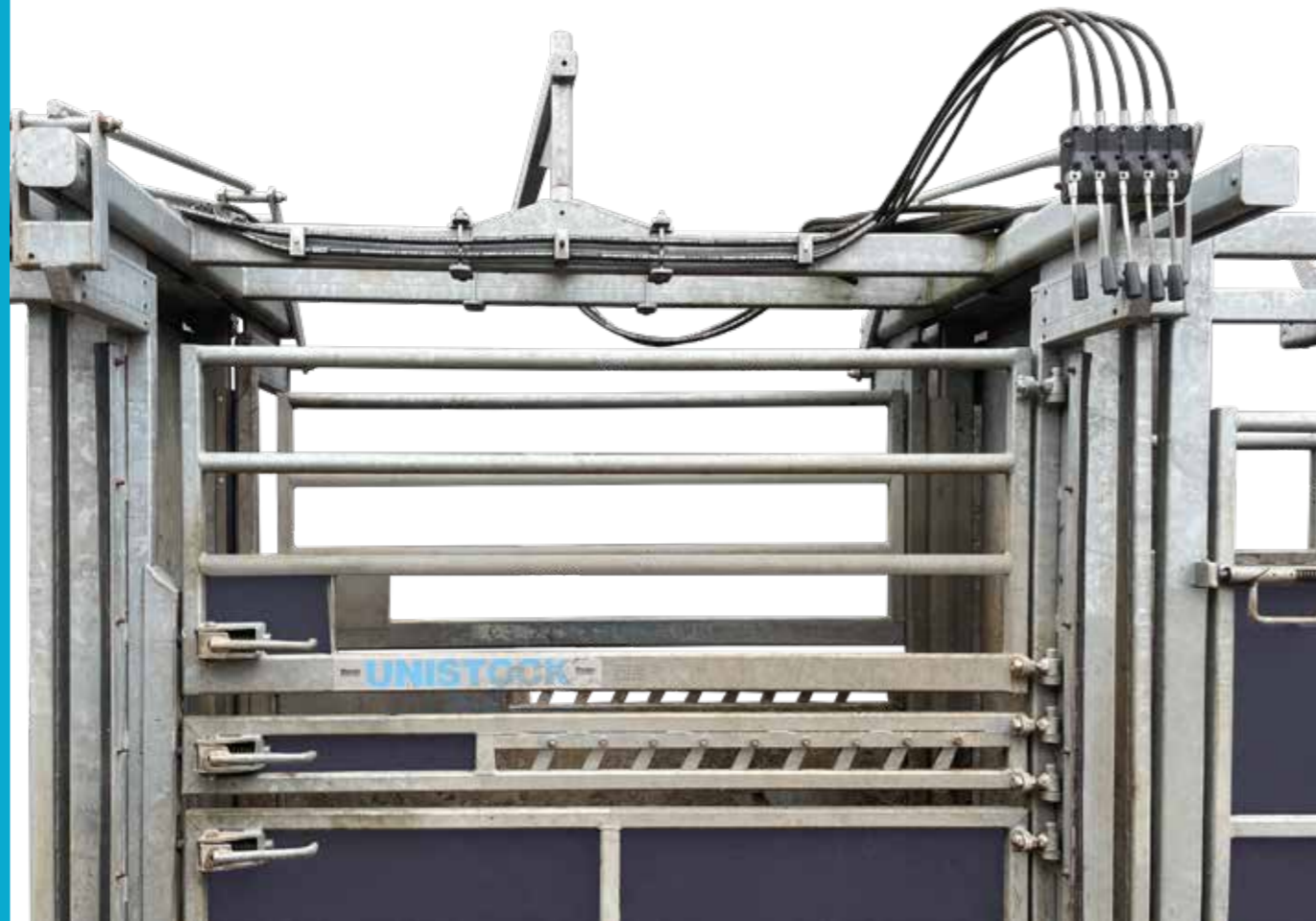

KEY FEATURES

- Unique Unistock Forward Catch Cattle Headgate fitted as standard.
- Greatly increased first-time capture rate, particularly with quiet or stubborn cattle.
- Total access to the lower half of the animal.
- Unrestricted access to the upper half of the animal.
- Unique multi-angular squeeze action allowing the front and back of each side panel to move independently.
- Multi-angular squeeze action allows the rear section to be narrowed to minimise the risk of animals backing out of the crate.
- Rubber mat on floor minimises noise level and helps keep the animal calm.
- EID panels can be fitted to give fast, accurate electronic recording of weights and tag numbers
- Squeezes from 760mm maximum width down to 250mm.
- Complete with hot dip galvanised finish to prevent rust.

EXTENDED CATTLE CRATE



CALL US
FOR A
QUOTE
01556 612240

HOW IT WORKS

Unistock Extended Cattle Crushes have been combined with the Unistock Veterinary Area to create a self-contained, versatile mini system that stockmen can easily move around the farm. The crush and the veterinary area are welded together as one unit with one rubber-matted floor that runs the entire machine length.

The Unistock Cattle Crate MK1, Unistock Cattle Crate MK2 and the Unistock Manual and Hydraulic Cattle Squeeze Crates are all available as extended units.

KEY FEATURES

- Welded together as one unit to create a self-contained handling system with a safe area for the vet and stockmen to work.
- Rear sliding door with easy operation from the outside of the crate – provides safe and effective control of the flow of cattle through the cattle crate or race section.
- Quick and easy access for any work to be carried out on the rear of the animal.
- The unit is easily and quickly moved from one location to another.
- Electronic weighing and EID can be added to the machine with the added benefit that the animal can be weighed without the need to capture it in the head yoke.
- Complete with hot dip galvanised finish, to prevent rust.
- Silent, slam catch handles on side doors.



MANUAL PARALLEL CATTLE SQUEEZE CRATE

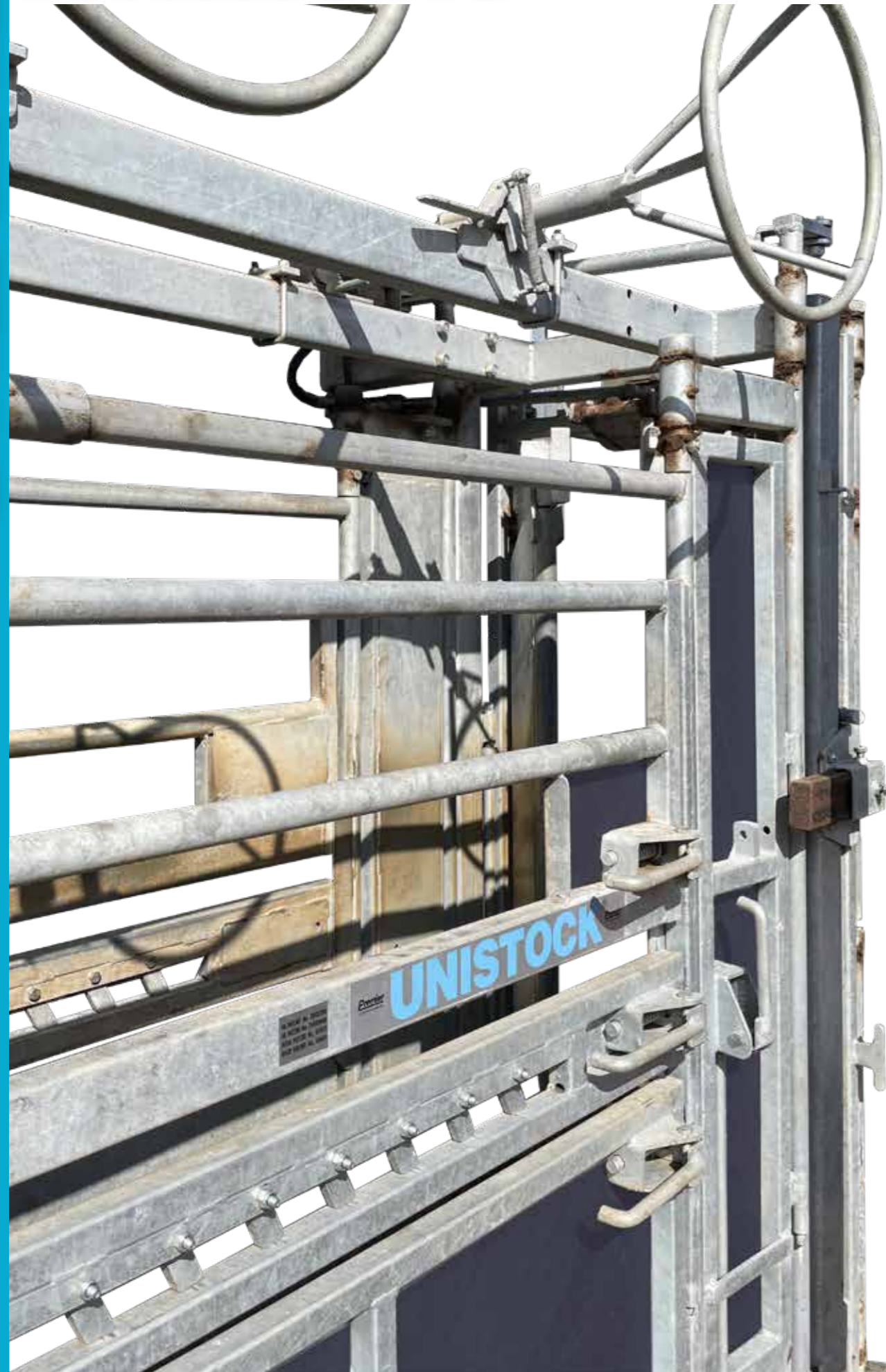

HOW IT WORKS

The Unistock Manual Cattle Squeeze Crates offer unparalleled versatility and control at an affordable price. The hydraulic rams combine with simple controls to give quiet and easy operation making this machine a valuable asset to any farmer.

It is available in standard length or extended to include the Unistock Veterinary Area. It can also be supplied with or without a sliding rear door on the crush.

GENTLE BUT
FIRM SQUEEZE



SQUEEZES
FROM 30" TO 8"

AVAILABLE
IN
EXTENDED
LENGTH

KEY FEATURES

- Gentle but firm squeeze offers calm and security for animals of all sizes and ages.
- Hydraulic rams assist for easy, smooth and quiet operation.
- Squeezes from 30" to 8"
- Simple controls and ease of use.
- Available in 3 options – Standard Length Crush, Extended Crush with Veterinary Area, Mobile System.
- Optional rear sliding door can be fitted to crush.
- Complete with hot dip galvanised finish, to prevent rust.

Please note pictures were taken on a working farm.

MULTI ANGULAR MANUAL CATTLE SQUEEZE CRATE



HOW IT WORKS

The Unistock Angular Cattle Squeeze Crate, has a unique multi-angular squeeze action, which offers unparalleled versatility and control at an affordable price. This patented design is the only one available on the market!

The front and rear sections narrow and widen independently to cater for animals of all sizes and create a 'funnel' effect that reassures and guides young stock. The front squeeze action holds the animals whilst the back is released, giving easy access to the rear.

The versatile method of operation, combined with simple controls and ease of use, makes this machine a valuable asset to any farmer. It is available in standard length, extended to include the Unistock Veterinary Area and built into the Unistock Mobile Cattle Crate.

AVAILABLE
IN
EXTENDED
LENGTH

KEY FEATURES

- Versatility and control at an affordable price.
- Unistock Forward Catch Cattle Headgate fitted as standard.
- Increased first-time capture rate, particularly with quiet or stubborn cattle.
- Total access to the lower half of the animal.
- Unrestricted access to the upper half of the animal.
- Unique multi-angular squeeze action allowing the front and back of each side panel to move independently.
- Multi-angular squeeze action allows the rear section to be narrowed to minimise the risk of animals backing out of the crate.
- Rubber mat on floor minimises noise level and helps keep the animal calm.
- EID panels can be fitted to give fast, accurate electronic recording of weights and tag numbers.
- Squeezes from 760mm maximum width down to 250mm.
- Complete with hot dip galvanised finish to prevent rust.
- Silent, slam catch handles.



MOBILE CATTLE HANDLING TRAILER



HOW IT WORKS

The Unistock Mobile Cattle Handling Crate is focused on being able to work with cattle in various locations. This work often needs to be done by a stockman working on his own; therefore, safety and time are paramount.

The Unistock Mobile Cattle Handling Crate can be used as a primary cattle handling system avoiding the need to move the stock to the permanent yarding system. Instead, it lets you take the machine to the stock, creating staff efficiencies and reducing the stress on the animals.

Available with the Unistock MK1, MK2 and Squeeze Crates. The Unistock Mobile Cattle Handling Crate can be fitted with either the Unistock Cattle Headgate, Unistock Forward Catch Cattle Headgate, or the Unistock Manual Cattle Headgate. It can also be fitted with Unistock Accessories, Electronic Weighing and EID. Available with or without penning hurdles.

CALL US
FOR A
QUOTE
01556 612240

01556 612240 | PREMIER-LIVESTOCK.CO.UK

KEY FEATURES

- Designed to allow safe and easy set-up by one person.
- Revolving rump bar – replaces dangerous loose bar.
- Anti-kick bars- provide protection during belly clipping.
- Protective poll bar on the headstock restricts upward movement of the animal's heads.
- Full opening side doors – safer access to carry out any work on the sides of the animal.
- Sliding door and access doors between crush and race section – create a safer access area for vet and stockman.
- 2.5 metre sheeted race section on the main frame behind sliding door - provides controlled flow of animals through the system.
 - o An optional Electronic Weigh platform can be fitted into this section.
- 10 galvanised 2.5-metre interlinked cattle hurdles are quickly and easily set up to create a holding pen for 30-35 adult cattle.
- Complete with hot dip galvanised finish to prevent rust.

SCAN THE QR CODE TO VIEW THE FULL RANGE



CATTLE FEED SAVER TRAILER



HOW IT WORKS

The Premier Cattle Feed Saver Trailer is about to be your most dependable asset when it comes to feeding your cattle. Designed with the farmer in mind, the Feed Saver Trailer does exactly what it says on the tin, saving you time and money. Our customers report saving 1 in every 7-10 bales, as the animal drops the feed back inside the feeder, due to the angled bars.

Featuring fully galvanised feed barriers, a timber slatted floor and stockboarding, all used to prevent rusting and ensuring that your trailer lasts for years to come. Heavy duty quality is guaranteed with the Premier collection of Feed Trailers, manufactured using premium materials and welded by our highly skilled fabrication team.

We are so confident with the quality and design, that we offer a 5 year guarantee!



FEATURES

- Heavy Duty Draw Bar.
- Withstand the elements and what your animals will throw at it.
- Saves 1 in every 7-10 bales.
- Tried and tested by farmers in the Scottish Borders.
- Fully galvanised to prevent rust.
- Suitable for cattle.
- Indoor or outdoor use.
- Not suitable for horned breeds of cattle.
- Can be custom made to accommodate any animal of any age.
- Angled Bars on front, rear and sides - to reduce wastage.
- Each side is bolted on, so can be easily removed for cleaning.



AVAILABLE AS A SHEEP TRAILER!

SCAN THE QR CODE FOR FULL DETAILS



SPECIFICATION

- 44 Feed Spaces
- Weight Capacity - 2.2 tonne at 40km/ph
- Axl - 60mm stub axl
- Tyre - 10.0/75 x 15.3 (per tyre)
- Speed - 40km/ph
- Stockboard - 9mm thickness
- Timber - 148mm x 38mm & pressure treated
- 6000mm long (7550mm including draw bar) x 2175mm wide (1650mm wide at top of bars)
- Loading Height - 1600mm
- Space in between Bars - 330mm

CATTLE FEED TRAILER

HOW IT WORKS

The Premier Feed Trailer was designed with the farmer in mind, featuring fully galvanised feed barriers, a timber slatted floor and stockboarding, all used to prevent rusting. Timber slatted floors are used so silage effluent drains away easily and diagonal bars to reduce feed wastage. All these design elements are included to ensure your Trailer lasts for many years to come.

Heavy duty quality is guaranteed with the Premier collection of Feed Trailers, manufactured using premium materials and welded by our highly trained fabrication team.

We are so confident with the quality and design, that we offer a 5 year guarantee!



CALL US
FOR A
QUOTE
01556 612240



FEATURES

- 32 Feed Spaces.
- Features Diagonal Bar Sides.
- Vertical Bars Front and Rear.
- All Steel Fully Galvanised to prevent rust.
- Each side is bolted on, so can be easily removed for cleaning.
- Heavy Duty Draw Bar.
- Indoor or outdoor use.
- Can be custom made to accommodate any animal of any age.

SPECIFICATION

- Weight Capacity - 2.2 tonne at 40km/ph
- Axl - 60mm stub axl
- Tyre - 10.0/75 x 15.3 (per tyre)
- Speed - 40km/ph
- Stockboard - 9mm thickness
- Timber - 148mm x 38mm pressure treated
- 6000mm long (7550mm including draw bar) x 1650mm wide
- Loading Height - 1600mm
- Space in between Bars - 385mm



CATTLE RING FEED SAVER



HOW IT WORKS

The Cattle Ring Feed Saver is one of Premier's most popular products, and was designed with the farmer in mind. Our customers report saving 1 in every 7 to 10 bales, as the animal drops the feed back inside the feeder, due to the angled bars. Has the ability to feed 18 cattle at once, and can hold a bale of 6ft size.

Another benefit of our ring feeders is their heavy duty nature, manufactured using premium quality materials and welded by our highly skilled fabrication team. Fully galvanized to prevent rust and protect against the weather, making them ideal for outdoor or indoor use.

We are so confident on the quality, that we are offering a 5 year guarantee.

CUSTOMERS REPORT SAVING
1 IN EVERY 7-10 BALES
SCAN THE QR CODE FOR A QUOTE



FEATURES

- Withstands the elements and what your animals will throw at it.
- Saves 1 in every 7 to 10 bales.
- Tried and tested by farmers all over Scotland.
- Manufactured in Scotland.
- Fully galvanized to prevent rust.
- Suitable for cattle.
- Features specially designed forklift holes, to easily relocate.
- Easily transported, as it comes in three parts.
- Self-Assembly, bolt together construction.
- Indoor or outdoor use.
- Not suitable for horned breeds of cattle.
- Can be custom made to accommodate any animal of any age.



SPECIFICATION

- 18 Feed Spaces
- 305mm between each bar
- 1920mm internal diameter x 1300mm height
- 33mm CHS o/d tube vertical rails at 305mm space

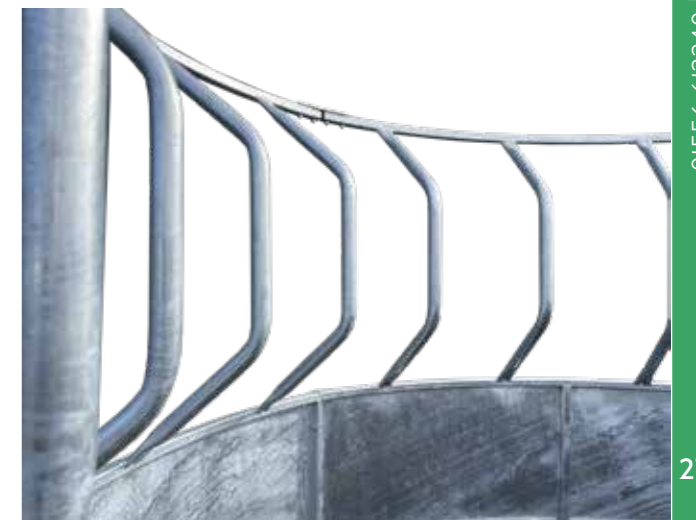

SHEEP RING FEED SAVER



HOW IT WORKS

Save money and time with the Premier Sheep Feed Ring Saver, designed with the farmer in mind. Tried and tested by farmers in Scotland, who have reported savings of 1 in every 7 to 10 bales. This also means your feed will last longer, ensuring efficient feeding of your flock.

Heavy duty quality guaranteed with the Premier collection of Ring Feeders, manufactured using premium quality materials and welded by our highly skilled fabrication team. Fully galvanized to prevent rust and protect against the weather, making them suitable for feeding your flock indoors or outdoors.

We are so confident on the quality, that we are offering a 5 year guarantee.

**SAVES 1
IN EVERY
7 - 10
BALES!**

FEATURES

- Secure Welded base.
- Withstands the elements and whatever your animals throw at it.
- Saves 1 in every 7 to 10 bales.
- Tried and tested by farmers in the Scottish Borders.
- Manufactured in Scotland.
- Fully galvanized to prevent rust.
- Easily transported, as it comes in two parts and just needs bolted together.
- Self-Assembly.
- Can be custom built to suit any animal of any age.
- SHS rails to keep bales off the ground.

SPECIFICATION

- Indoor or outdoor use
- 19 Feed Spaces
- 270mm space between bars
- 1510mm diameter x 1120mm height
- 25mm SHS o/d tube vertical rails at 210mm space



CATTLE FEED SAVER BUNKER



HOW IT WORKS

Keep your herd well fed with the Premier Cattle Feed Saver Bunker, designed for the farmers who are looking to save money and make their feeding process more efficient, as once the bales are loaded spoilage and wastage is reduced. This works as the animals drop the feed inside the feeder, and therefore continue to eat it. Whereas with a standard feeder the animal drops and tramples on the food.

The Feed Bunker can accommodate both types of bales, as well as having an additional number of feed spaces compared to the Ring Feeder, creating room for more animals. It has also been designed with an open bottom, meaning it is easily moved to a fresh site whenever needed. If you would prefer a bottom, please get in touch for a custom quote.

Heavy duty quality is guaranteed with the Premier collection of Feeders. They benefit from a fully galvanised structure, manufactured using premium materials and welded together by our highly skilled fabrication team, ensuring your feed saver lasts for years to come.

We are so confident on the quality, that we are offering a 5 year guarantee.

FEATURES

- No base - no need for cleaning and easily moved.
- Saves 1 in every 7-10 bales.
- Tried and tested by Farmers in the Scottish Borders.
- Open top to allow for round or square bales.
- Box section frame.
- Fully galvanised to prevent rust.
- Stockboarding along bottom to prevent rust.
- Accommodates both types of bales.
- Withstand the elements and what your animals will throw at it.
- Indoor or outdoor use.
- Can be custom made to accommodate any age of animal.

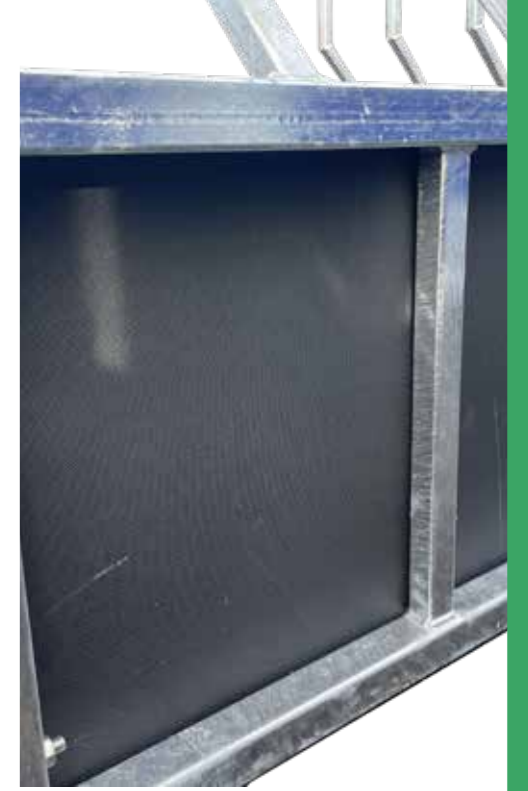

SPECIFICATION

- 3825mm length x 2000mm width x 1275mm height
- Stockboard - 9mm thickness
- 30 Feed Spaces
- Space in between Bars - 280mm

SCAN THE QR CODE
TO SEE THE FULL
FEEDING
EQUIPMENT RANGE



FOOT TRIMMING ATTACHMENT

HOW IT WORKS

It can be easily fitted to the Unistock Cattle Crate MK1, the Unistock Cattle Crate MK2, the Unistock Cattle Crate and the Unistock Cattle Squeeze Crate. This would provide a quick and efficient method of caring for the feet whilst the animal is in the cattle crate.

Any need for attention can be dealt with at the time, making it easier for the stockman and beneficial for the welfare of both dairy and beef cattle with no delay in treatment.

KEY FEATURES

- Support winch and band are easily fitted to the top rails of the crate to provide support for the animal during hoof trimming.
- A rear winch is easily fitted to the Cattle Crate providing controlled lifting and lowering of the rear legs.
- Large reversible recycled solid plastic blocks provide a good working surface. The blocks are easily fitted to the crate and are slightly angled outwards, giving access to the foot claw.
- The large opening doors on all Unistock Cattle Crates mean ample room for working with all foot trimming equipment as required.
- The anti-kick bars on the Unistock Cattle Crate MK2 provide valuable protection against kicking by the rear legs whilst the stockman is working on the front feet.
- Complete with hot dip galvanised finish to prevent rust.



CATTLE HEAD SCOOP



Please note pictures were taken on a working farm.

HOW IT WORKS

Designed to greatly reduce the animal's side to side head movement, the Cattle Head Scoop is easily fitted to any of our Cattle Crates. Created to make dosing and ear tagging more straightforward and efficient. They are also quick and easy to attach and remove as required, saving you extra time during busy seasons.

KEY FEATURES

- Helps restrict the side to side thrashing of the animal's head.
- Helps keep the animals head up so it will not go down on it's front legs.
- Makes dosing and ear tagging more straightforward and efficient.
- Easy and quick to fit.



TRU TEST COLLECTION

All the Premier Cattle Crates can be fitted with Electronic Weighing and EID. We supply a range of Tru Test Electronic Weighing Equipment to suit all needs. *Please get in touch or visit our website to enquire about a quote.*

ELECTRONIC WEIGHING LOAD BARS

We have two loadbars available, the Heavy Duty is designed for permanent fixture and the Multi-Purpose is designed for portable weighing.



HEAVY DUTY LOADBARS

- Designed for permanent installation.
- Unique footing absorbs potential side loading.
- Weighing capacity up to 3000kgs.
- Available in 2 lengths:
 - 800mm – up to 3000 kgs.
 - 1010mm – up to 3000 kgs.

MULTI PURPOSE LOADBARS

- Designed for crates that move from one location to another.
- Weighing capacity up to 3000kgs
- Available in 3 lengths:
 - 600mm – up to 2000 kgs.
 - 800mm – up to 3000 kgs.
 - 1010mm – up to 3000 kgs.

XRS CATTLE PANEL READER

HOW IT WORKS

The XRS Cattle Panel Reader can be easily fitted to any of our Cattle Crates for fast, automatic reading of ear tags. Fully automated, hands free identification / weighing system.

KEY FEATURES

- Reads all HDX and FDX-B Tags.
- Read range up to 1m.
- Unique auto tuning function to maximise the read performance and simplify set up.
- Simple plug and play setup.
- Beeper and bright LED show successful tag read and power.
- Dual antenna increases range up to 1.8m.
- Connects to all Tru Test indicators and other manufacturer's weigh scale indicators.
- Powered by 12V battery or mains adaptor.
- Supplied with mounting bracket to allow controller to be removed for storage and security.



ELECTRONIC WEIGHING INDICATORS

HOW IT WORKS

Electronic Weighing Indicators can be easily fitted to all our Cattle Crates and should be matched to individual needs. We stock three different styles of indicators, all including bluetooth to connect stick readers.

ID5000

- 5-way sorting by weight or weight gain.
- Can store 250,000 records over 250 sessions.
- 3 fixed data fields for recording animal data.
- EID compatible.

XR5000

- 10-way sorting by weight or weight gain.
- Uses Tru-Test's Superdamp III technology.
- Can store 1,000,000 records over 1000 sessions.
- 100 custom data fields for recording animal data.

JR5000

- Can store up to 1 million records over 1000 sessions.
- Use pre-defined set ups to switch between jobs.
- Easily transfer recorded information.
- 5 way drafting by weight.
- Track performance.



XRS STICK READER

HOW IT WORKS

The Tru Test XRS Stick Reader is a truly portable handheld EID reader that is comfortable to use. It is suitable for cattle and sheep, offering up to 19 hours reading from a single charge. Designed to interface easily with a weigh scale indicator together with the ability to also record EID tags for downloading later to a PC.



KEY FEATURES

- Reads all HDX and FDX-B tags.
- Read rate – Up to 1,100 reads per minute.
- 20,000 Scanned tag memory.
- 15,000 EID / VID pairs.
- 50 Sessions.
- Vibrating handle to alert when tag is read.
- Duplicate discard option.
- Wireless bluetooth roaming while connected to indicator or other device.
- Rugged water and dust proof.
- Customisable alerts for pre-chosen animals. (load up to 10,000 alerts – 254 unique messages).
- Software – Tru-Test EziLink.
- Size – 650mm.
- Weight – 700g including battery.
- Charge Time – 3 hours in normal conditions.
- Power adaptor supplied.



SCAN THE QR CODE
TO VIEW THE FULL
COLLECTION & PRICES

GRAIN PUSHER

HOW IT WORKS

A Grain Pusher is a product we have been fabricating and offering our customer base for over 20 years, meaning we know exactly what it takes to create a long lasting Grain Pusher. This is a product which is ideal for farmers looking to save some vital space in their Grain Stores during Harvest, we understand that there is nothing worse when you are half way through Harvest and you realise your floor space is filling up fast, our Grain Pusher allows you to surcharge the grain, essentially taking up vertical space, meaning you can store much more inside the building. In the long run, this clever tool will save you money, as it prevents you storing grain outside, therefore your grain is higher quality and will be sold for a higher price. A win-win!

Our Grain Pusher is fabricated by our experienced team of welders, using high quality materials, giving you peace of mind that it will last for years to come. A very worthwhile investment!

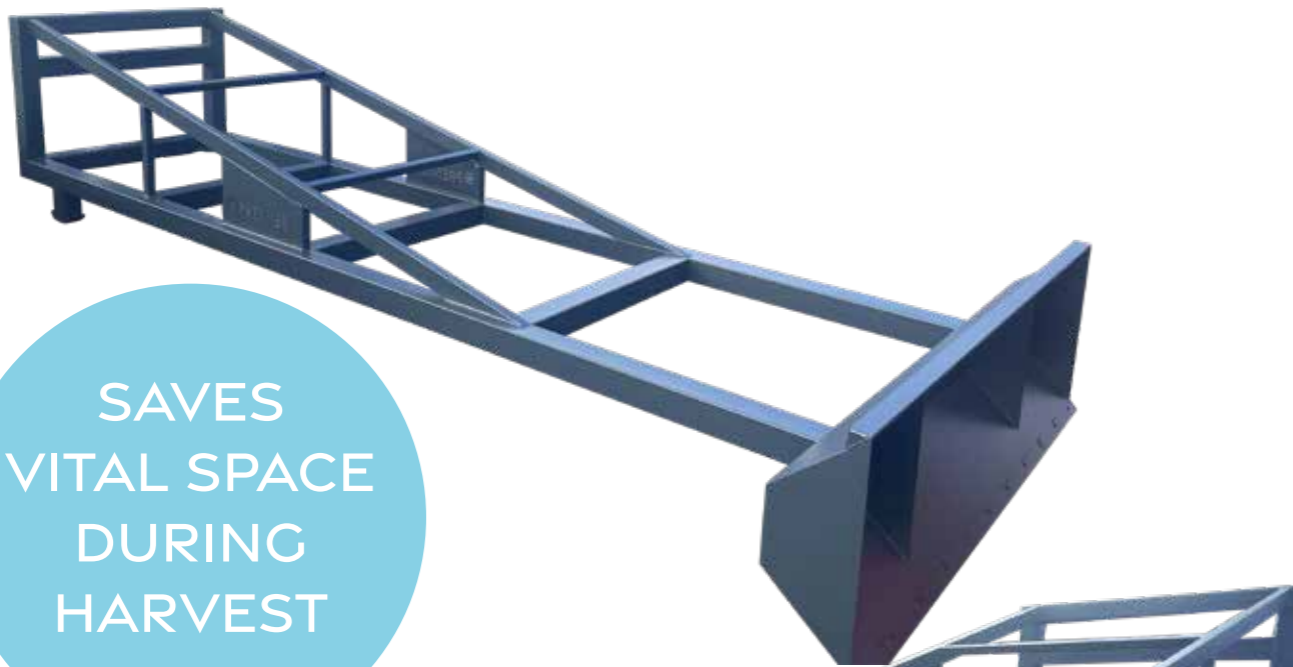

SAVES
VITAL SPACE
DURING
HARVEST

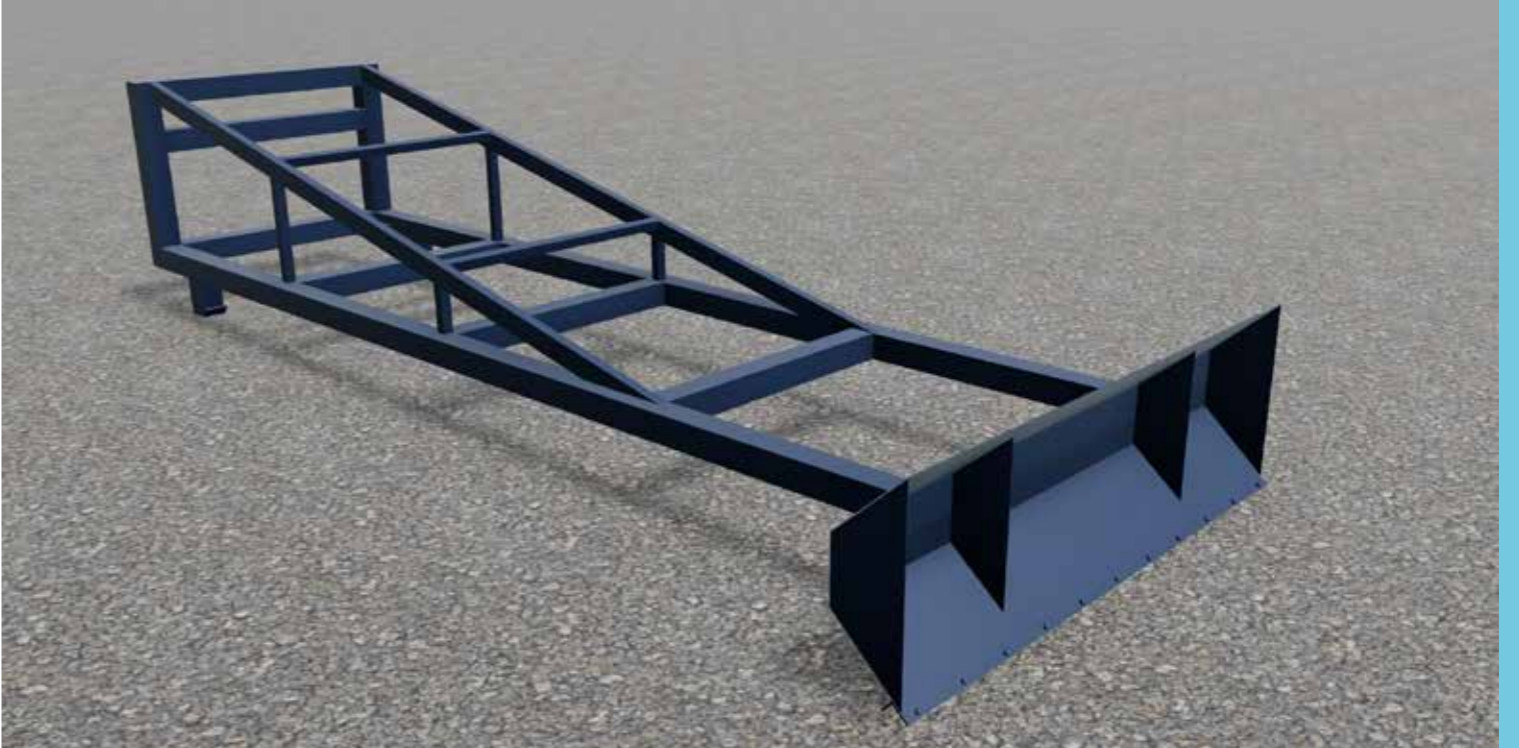

FEATURES

- Heavy Duty Design.
- Customised to a length that suits.
- Saves valuable space.
- Fabricated by our experienced team.
- Manufactured in square or round tubing (surcharge for round tubing).
- Shot blasted steel.
- Spray painted slate blue.
- Quick release backtray can be fitted to suit any forklift manufacturer.
- Heavy rubber scrapper blade, saves wear on grain store floor.

SPECIFICATION

- Based on standard stock size
- 4763mm length
- 1230mm wide x 1010mm tall x 4500mm deep base
- 2000mm wide x 600mm tall x 225mm deep pusher
- 1000kg weight

SCAN THE QR
CODE TO
VIEW MORE
PICTURES



GRAIN HOPPER

HOW IT WORKS

A Grain Hopper is the perfect tool to save time and labour costs during Harvest. Simply fill two loads at once, as the Hopper connects directly into your Grain Dryer, meaning you can get on with other tasks while your Dryer works through the loads. We can even join multiple hoppers together, if you need to leave your grain for longer periods of time. This is ideal for farmers working on their own, contract farmers who have multiple properties to manage or even just a stressed and busy farmer during Harvest! Our Grain Hopper can be designed and manufactured bespoke to your Grain Dryer, do you have a 25 Tonne Dryer? Then we'll make a Grain Hopper to suit.

Each Hopper is manufactured by our team of experienced welders using only the best high quality materials, giving you the confidence that your Hopper will last for years to come. An investment you can trust.

SAVES TIME
& LABOUR
DURING
HARVEST

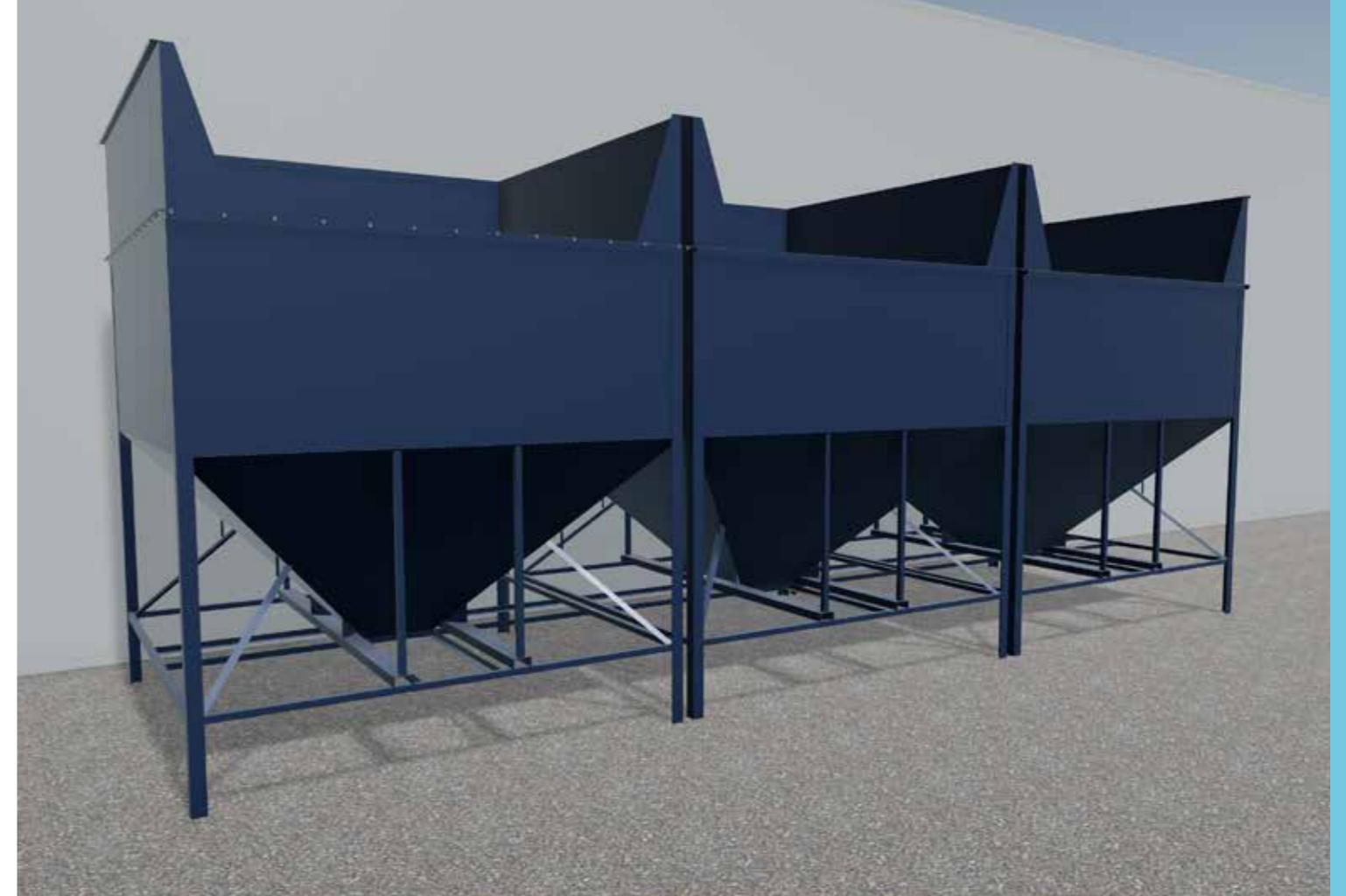

FEATURES

- Slate blue painted finish as standard (this can be customised to suit your farm).
- All steel is handcut in our workshop.
- Lifting channel built into design for easy movement. Compatible with standard pallet forks.
- Adjustable shoot to adjust the flow.
- Saves you time.
- Fabricated by our experienced team.
- Trusted design for over 30 years.
- Designed to your requirements, as we can make the hopper to match your grain dryer.
- Ready for use with minimal assembly upon delivery.
- Fully controllable grain door.
- Easily converted to larger sizes with greedy boards.
- Complete with rack and pinion adjustable door.

SPECIFICATION

- The following specifications are for our standard 25T Hopper.
- 25.000kg weight
- 0.499 funnell
- 3660mm wide x 3660mm deep x 3836mm tall
- 2330mm tall shoot
- 3mm steel



CALL

01556 612240

EMAIL

info@premier-livestock.co.uk

ONLINE

www.premier-livestock.co.uk

VISIT

Duns Industrial Estate,
Duns, TD11 3HS

FOLLOW

 [@premierlivestockhandling](#)

 [@thorburngroup](#)

 **PREMIER**

