



Host Ministry:



Supporting Agency:



Host Utilities:



9-11 September 2025 | BITEC, Bangkok, Thailand



Bringing together the key players in the end-to-end power & energy supply chain in the region

Venue Overview

Level 2: Meeting Rooms (MR211-225)

Sponsors' Workshops
Sponsors' Private Meeting Rooms
Nuclear Forum (9 Sept): MR222-223

Level 2: Summit

Opening Ceremony/Plenary (9 Sept morning): GH201-203
Stream 1: GH201
Stream 2/Day 2 & 3 Plenary: GH202
Stream 3: GH203
Power & Energy Awards Dinner (9 Sept evening): GH202

Level 2: Speaker Room
MR210

EH104 entrance:
Medical/First Aid
Room

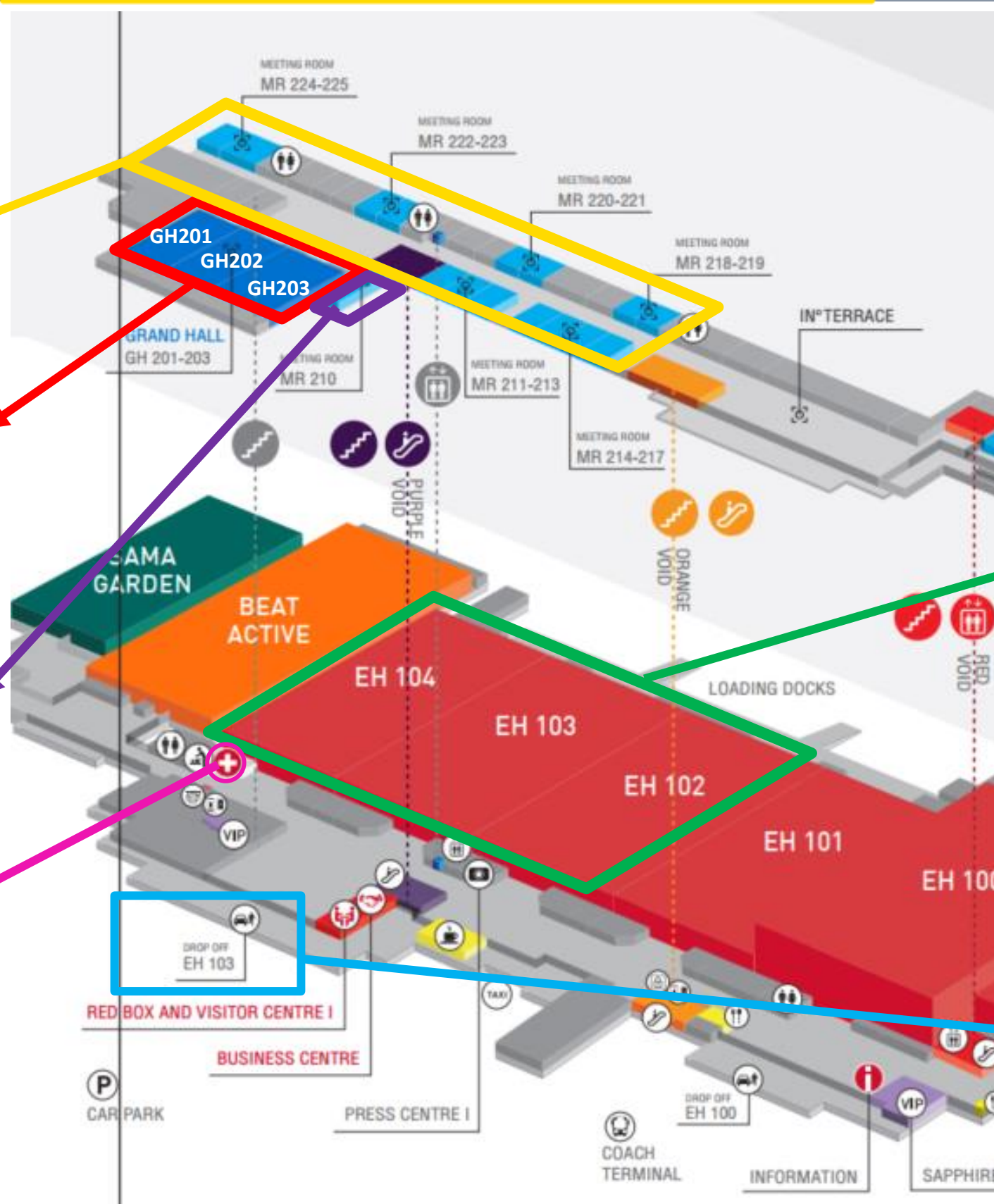

Badge Collection:

Registration counter at EH102-EH104 exhibition hall entrance, Ground Floor

Lunch and Coffee Breaks:

Served at Delegate Restaurant located at back of exhibition hall

Ground Floor: Exhibition and Knowledge Hubs

Exhibition Halls: EH102-EH104
Knowledge Hub 1 (Flexible & Cleaner Powergen): #235
Knowledge Hub 2 (Energy Transition & Technology): #739
Knowledge Hub 3 (Resilient Grid): #1527
MATCH! Lounge: #307
VIP Lounge: #1027
Networking Area: #527 & #1423
Prayer Room

Recommended taxi/car drop-off point:

In front of EH103, via Entrance 1 along Debaratna Road

Event Location Plan

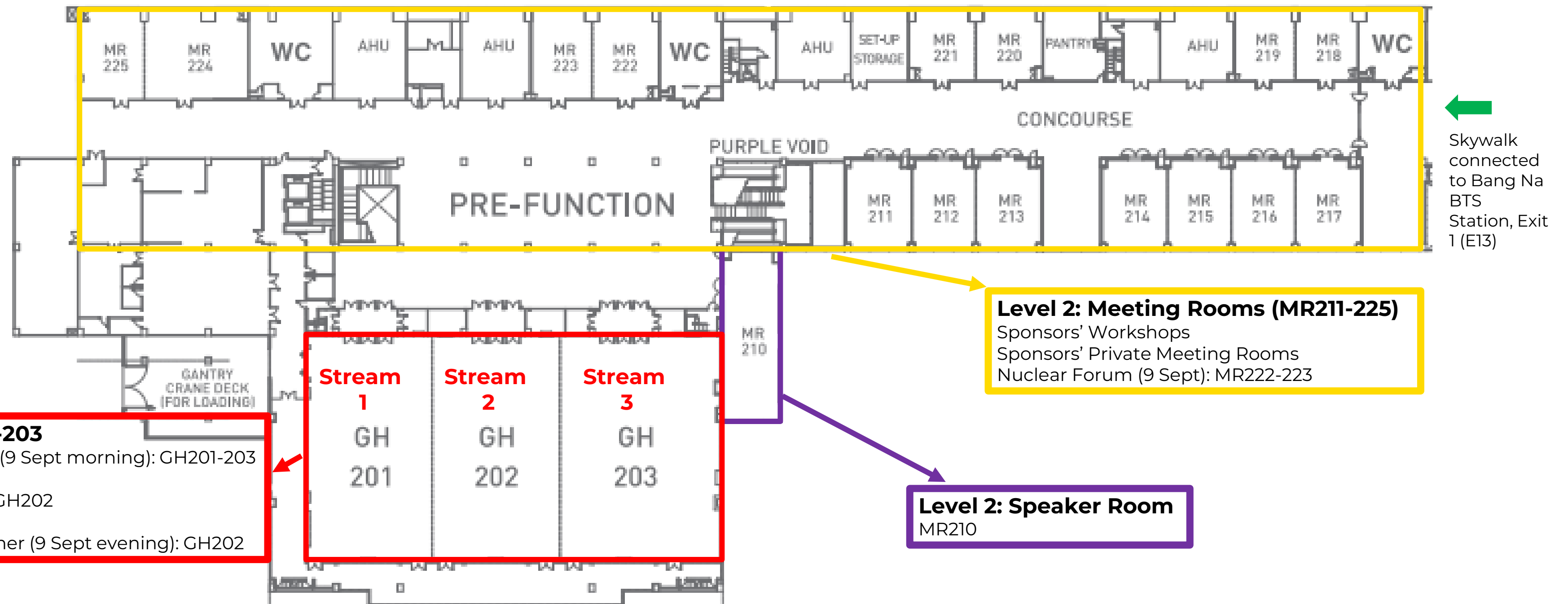



Host Ministry:



Supporting Agency:



Host Utilities:



Schedule of Events

Day 1: 9 September 2025

Time	Description	Location
08:00 – 17:00	Registration Opens	Ground Floor, EH102 – EH104 Foyer
08:00 – 09:15	Welcome Coffee/Tea	Level 2, GH201 – GH203 Foyer
08:30 – 09:15	VVIP Tour of the Exhibition	
09:15 – 12:10	Opening Ceremony & Plenary	Level 2, GH201 – GH203
10:00	Exhibition Opens	Ground Floor, EH102 – EH104
12:10 – 14:15	Delegate Networking Lunch	Delegate Restaurant: Ground Floor, EH102 – EH104
14:15 – 15:20	Summit Streams	Level 2: Stream 1, GH201 Stream 2, GH202 Stream 3, GH203
10:40 – 16:20	Knowledge Hub Sessions	Hub 1 (Flexible & Cleaner Powergen): Ground Floor, EH104 Hub 2 (Energy Transition & Technology): Ground Floor, EH103 Hub 3 (Resilient Grid): Ground Floor, EH102
15:20 – 15:50	Delegate Networking Break	Delegate Restaurant: Ground Floor, EH102 – EH104
15:50 – 16:50	Summit Streams	Level 2: Stream 1, GH201 Stream 2, GH202 Stream 3, GH203
16:00 – 17:00	Happy Hour	Ground Floor, EH102 – EH104, Networking Hubs (527 & 1423)
17:00	Exhibition Closes	
16:50 – 21:00	Power & Energy Awards Dinner* *Ticketed entry Pre-dinner networking reception at GH202 Foyer: 16:50 – 18:30	Level 2, GH202

**Schedule subject to changes.*

Day 2: 10 September 2025

Time	Description	Location
08:00 – 17:00	Registration Opens	Ground Floor, EH102 – EH104 Foyer
08:50 – 10:10	Opening Plenary	Level 2, GH202
10:00	Exhibition Opens	Ground Floor, EH102 – EH104
10:10 – 10:40	Delegate Networking Break	Delegate Restaurant: Ground Floor, EH102 – EH104
10:40 – 12:00	Summit Streams	Level 2: Stream 1, GH201 Stream 2, GH202 Stream 3, GH203
10:40 – 16:00	Knowledge Hub Sessions	Hub 1 (Flexible & Cleaner Powergen): Ground Floor, EH104 Hub 2 (Energy Transition & Technology): Ground Floor, EH103 Hub 3 (Resilient Grid): Ground Floor, EH102
12:00 – 13:30	Delegate Networking Lunch	Delegate Restaurant: Ground Floor, EH102 – EH104
13:30 – 15:00	Summit Streams	Level 2: Stream 1, GH201 Stream 2, GH202 Stream 3, GH203
15:00 – 15:40	Delegate Networking Break	Delegate Restaurant: Ground Floor, EH102 – EH104
15:40 – 17:00	Summit Streams	Level 2: Stream 1, GH201 Stream 2, GH202 Stream 3, GH203
15:00 – 16:00	US Pavilion Reception	Ground Floor, EH104 <i>Booths 615 – 618</i>
16:00 – 17:00	Happy Hour	Ground Floor, EH102 – EH104, Networking Hubs (527 & 1423)
17:00	Exhibition Closes	
17:00 – 18:30	Exhibitor Thank You Reception <i>Best Paper Awards</i>	Ground Floor, Enlit Asia Booth (627)

Day 3: 11 September 2025

Time	Description	Location
08:00 – 14:00	Registration Opens	Ground Floor, EH102 – EH104 Foyer
09:00 – 14:00	Opening Plenary	Level 2, GH202
10:00	Exhibition Opens	Ground Floor, EH102 – EH104
10:50 – 11:25	Delegate Networking Break	Delegate Restaurant: Ground Floor, EH102 – EH104
11:00 – 13:20	Knowledge Hub Sessions	Hub 1 (Flexible & Cleaner Powergen): Ground Floor, EH104 Hub 2 (Energy Transition & Technology): Ground Floor, EH103 Hub 3 (Resilient Grid): Ground Floor, EH102
12:50 – 14:00	Delegate Networking Lunch	Delegate Restaurant: Ground Floor, EH102 – EH104
13:00 – 14:00	US Pavilion Reception	Ground Floor, EH104 <i>Booths 615 – 618</i>
14:00 – 15:00	Happy Hour	Ground Floor, EH102 – EH104, Networking Hubs (527 & 1423)
15:00	Exhibition Closes	

**Schedule subject to changes.*

Build-up Schedule

Date	Time	Activity
6 September 2025, Saturday	2pm – 8pm	Non-Official Contractors move-in by schedule (Raw Space only)
7 September 2025, Sunday	8am – 8pm	Non-Official Contractors continue build-up (Raw Space only)
8 September 2025, Monday	8am – 12pm	Non-Official Contractors continue build up (Raw Space only)
	12pm-1pm	All structural work must be finished and tidy up aisle around booth
	2pm- 8pm	<ul style="list-style-type: none"> Exhibitors check-in Only booths decoration may continue Aisle carpet installation start <p><i>*Please email Organiser if you require early access before 8 Sep, 2pm</i></p>
	8pm	<ul style="list-style-type: none"> Complete booths set-up. Please note that ALL CONTRACTORS AND EXHIBITORS must exit the exhibition hall by 8pm.

Tear-down Schedule

Date	Time	Activity
11 September 2025, Thursday	3pm – 3.30pm	Exhibitors move-out and packing Contractors only allowed to remove AV, light fittings within 2.5mHt, assist exhibitors pack-up between 3pm – 3.30pm
11 September 2025, Thursday	3.30pm – 10pm	Exhibition tear-down

Exhibition Days Access Hours for Exhibitors and Contractors

Date	Time	Activity
9 September 2025, Tuesday	10am – 5pm	Exhibition Opening Hours <i>Exhibitors/Contractors Access: 8am - 6pm</i>
10 September 2025, Wednesday	10am – 5pm	Exhibition Opening Hours <i>Exhibitors/Contractors Access: 8.30am - 6pm</i>
11 September 2025, Thursday	10am – 3pm	Exhibition Opening Hours <i>Exhibitors/Contractors Access: 8.30am - 4pm</i>

Event Phases

Location	06-Sep	07-Sep	08-Sep	08-Sep (2pm onwards)	09-Sep	10-Sep	11-Sep	11-Sep (3pm – 3.30pm)	11-Sep (3.30pm onwards)
Hall EH102									
Hall EH103									
Hall EH104									
GH201-GH203									
Level 2 Meeting Rooms									

RED PHASE: Full Construction/Dismantling Phase	AMBER PHASE: Construction Phase under Review	GREEN PHASE: Dressing/Packing Phase
Activities: Heavy build, rigging, work at height, freight forwarding, loading & unloading movement, vehicle movement, main painting, compressors.	Activities: Light paint touch-up, graphics works, hammering/ screwing, using hand or battery-operated tools, low noise activity, cleaning of stands. No RED PHASE work allowed.	No RED PHASE work allowed. Low levels of AMBER PHASE tasks before the exhibition opens. Booth cleaning is allowed at all times.
Compulsory PPE: Safety vest, safety boots, hard hat, sleeved top, long pants.	Compulsory PPE: Workers: Safety vest, safety boots, hard hat, sleeved top, long pants. Exhibitors (2pm onwards): Sleeved top, long pants, covered shoes.	Attire: Covered footwear, sleeved top, long pants.

Emergency Exit and Assembly Point

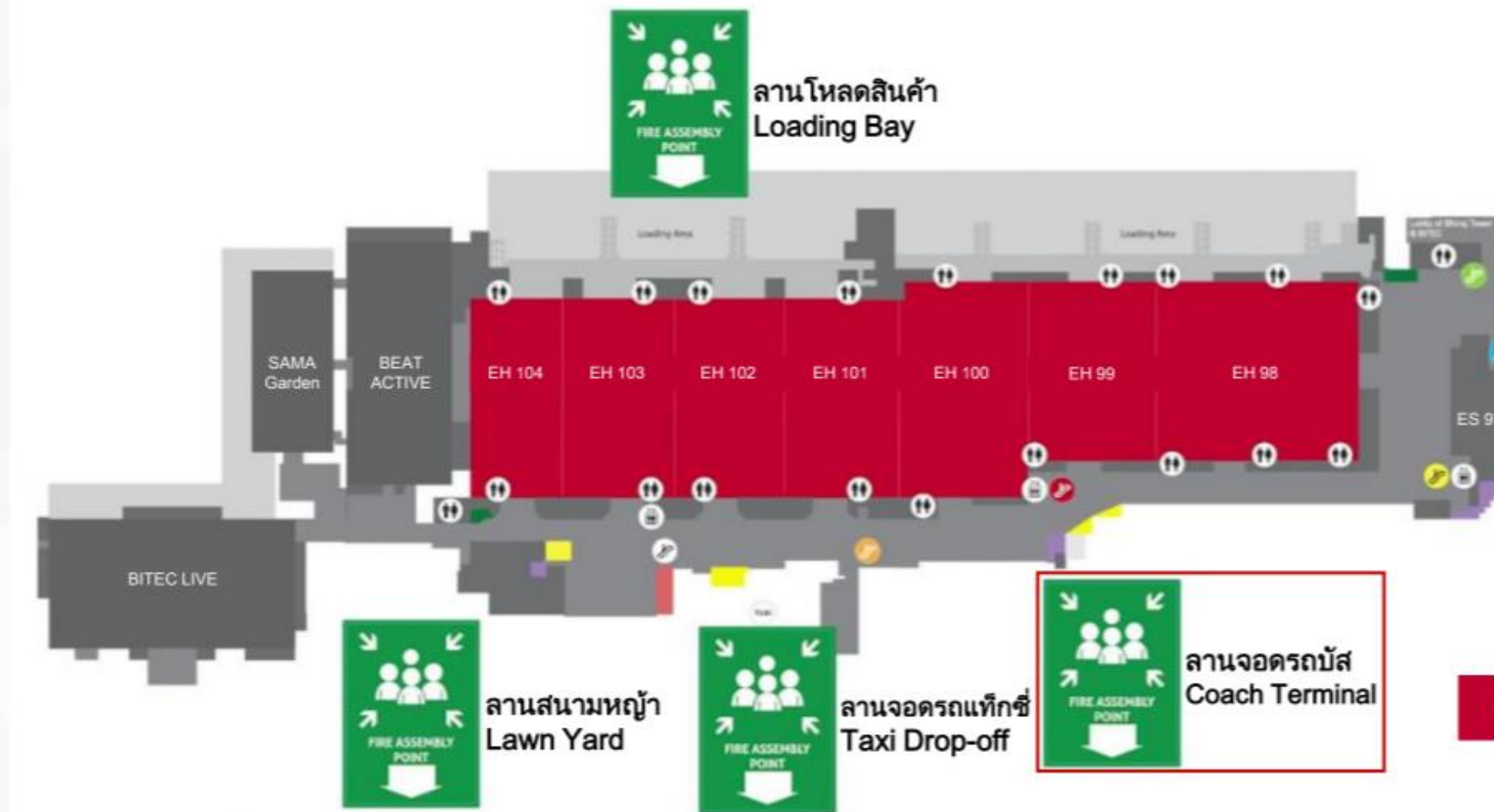

[CLICK HERE](#) to access detailed emergency evacuation procedures.



Host Ministry:



Supporting Agency:



Host Utilities:



VVIP Exhibition Tour & Official Opening Ceremony

From 8.30 AM

The VVIP Tour can only accommodate a certain number of stands, due to time constraints. If you are informed that your stand will be a part of the tour, please ensure you have staff on your stand to receive the tour.

While the VVIP Tour will follow a limited route, the **Opening Ceremony** is open to all attendees (excludes Visitor Pass holders). We encourage you to join us at GH202, Summit Stream 2 to hear the Ministerial Address, along with presentations and discussions from leading Thailand industry stakeholders.

DOWNLOAD & LOG INTO ENLIT ASIA 2025 APP

If you have not logged in, kindly check your inbox/junk folder for welcome email address from enlitasia@jublia.co

After logging in, you will receive an OTP in your email! If you have not received any emails, please reach out to our team to get your login details!

Scan to download mobile app →

IOS



ANDROID



APK FILE

(For users in regions where the Apple App Store or Google Play Store is not accessible)

Note: SWITCH ON VPN before opening the app)



Jublia – Your Business Matching App!

BOOK AS MANY MEETINGS YOU WANT! **UNLIMITED!!**

If you have not logged in, kindly check your inbox/junk folder for welcome email address from **enlitasia@jublia.co**

1. SCAN LEADS ON SITE

- **Real-Time Access** - Export your leads data anytime & anywhere

2. SCHEDULE MEETINGS

- **Personalise Your Own Match** - Set your preferences and let the app recommend the most relevant profiles for you.
- **Unlimited Bookings** – Arrange as many meetings as you like to maximise your chances of confirmed appointments.
- **Concierge Support** – Share your requests with us—our team will help reach out to contacts and secure your meetings on the app.

Your Jublia Cheat Sheet – Scan the QR Code to Get Started



English



Chinese

 **Ground Floor – MATCH! Meeting Lounge (Booth 307)**



Host Ministry:



Supporting Agency:



Host Utilities:



Power & Energy Awards

POWER ENERGY AWARDS

9th September: 7.00 PM

(Join us for pre-dinner networking reception at Level 2, GH202 foyer: 5pm to 6.30pm)

Celebrate the achievements of our industry!

A prime networking opportunity with senior industry leaders.

Ticketed entry only. Ticket collection at MATCH! Meeting Lounge (booth 307), 10am to 5pm.

Free-to-Attend Workshops

These sessions offer both learning and high-value networking opportunities.

- **Day 2 | MR211-213 | National Energy Plan Seminar: Opportunity or Crisis? – Hosted by Thai Renewable Energy (RE100) Association, Renewable Energy Industry Club of the Federation of Thai Industries, Clean Energy for People Foundation**
- **Day 2 | Knowledge Hub Theatre 3 | Enhancing solar energy development through data, standards and collaboration – In partnership with DEDE**
- **Date TBC | Role of Energy Efficiency (EE) for ASEAN Sustainability Energy Transition – Hosted by Thai ESCO Association**



Host Ministry:



Supporting Agency:



Host Utilities:



FAQ

REGISTRATION COUNTERS

They are located at Exhibition Halls Foyer; Ground Floor, EH102 – EH104. Please prepare your confirmation email QR code to scan and print event badge.

BAGGAGE STORAGE

The Baggage Storage counter is located on Ground Floor, EH104 entrance.

This service is available on 9 – 11 September, baggage needs to be collected daily by end of exhibition hours.

ENLIT ASIA BOOTH

The Enlit Asia Booth is located at 627 within the exhibition hall.

CONFERENCE SUMMIT SESSIONS (LEVEL 2)

Opening Ceremony/Plenary (9 Sept morning): GH201-203

Stream 1: GH201

Stream 2: GH202

Stream 3: GH203

Signs will be available to guide delegates and speakers. Summit sessions are open only to registered attendees.

DELEGATE LUNCH

The Delegate Restaurant is located at the back of EH102 – EH104 . Coffee breaks and Lunch will be served here for Summit attendees only.

If you are not a Summit attendee, snacks and meals can be purchased from various Food Courts located throughout the event space.

CARPARK

Parking options are available at BITEC basements & outdoor areas, parking fees range from 40 THB (3 hours) to 140 THB (8 hours), any additional hours after 8 hours is at 20 THB per hour.

INTERNET

Limited free Wi-Fi is available at BITEC (per pax up to 3 connections of 3 hours per day) connection is based on shared bandwidth and network stability subject to number of users connected at same time.

THAILAND DIGITAL ARRIVAL CARD (TDAC) - MANDATORY

All foreign travellers are required to complete and submit Thailand Digital Arrival Card (TDAC) three days in advance to arrival in Thailand. The TDAC must be submitted through the website [here](#). After the online submission, you will receive an acknowledgment email.

FAQ

CONTRACTOR VILLAGE

Pico Malaysia, Kuehne+Nagel and BITEC counter is located at the back of EH104, to assist with your orders.

PRAYER ROOM

Nearest Prayer Room is located near entrance within EH104.
Alternate Prayer Room is located behind the stairs of BITEC Basement 2

MATCH! Meeting Lounge

Located at EH104, Booth 307.

OTHER NETWORKING AREAS

Networking Hubs:

9 –11 September, all day coffee and tea

Happy Hour free-flow beer:

9 – 10 September, 4pm to 5pm

11 September, 2pm to 3pm

Exhibition Hall, Booth 527 and 1423

US Pavilion Reception:

10 September, 3pm - 4pm

11 September, 1pm - 2pm

Exhibition Hall, Booth 615 - 618



Exhibitor Reception

Our chance to thank you!

Join us for our **Exhibitor Networking Reception**
on **Day 2**

Featuring **Best Paper Awards** Come and
celebrate the best technical papers delivered
across the 3 days

Date: 10 September 2025

Time: 5pm to 6:30pm

Venue: Enlit Asia Booth 627



Enlit Asia 2026

2026 returns to Jakarta - 22-24 September, at ICE, BSD.

Your account managers will be in touch with you over the course of the next 2 weeks to discuss prebooking and rebooking your space.

We do have a number of benefits to booking before the end of the event!





Host Ministry:



Supporting Agency:



Host Utilities:



Enlit Asia 2025 Team

Accounts Servicing

Kelly Lim
Commercial Director
Email: Kelly.Lim@clarionevents.com

Nazwani Abu Bakar
Partnership Manager
Email: Nazwani.Abu@clarionevents.com

Content

Emily Chong
Head of Content & Strategy
Email: Emily.Chong@clarionevents.com

Marketing

Marilyn Yeow
Marketing Manager
Email: Marilyn.Yeow@clarionevents.com

Operations

Operations Team
Sonia Low, Christina Yeap
Email: Exhibitors-Asia@clarionevents.com



Host Ministry:



Supporting Agency:



Host Utilities:



THANK YOU & SEE YOU SOON!