

BDJ005-90A-009 product description

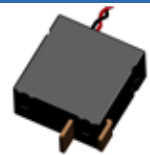

35.5X35X17mm

Contact DATA

- Contact Arrangement: 1 Form B
- Contact Capacity: 90A /250VAC
- Impact Current: In accordance with IEC62055-31 UC3 standard
- Max Switching Voltage: 440VAC

Coil DATA

- Rated Voltage: 9VDC
- Rated Power Consumption: 1.5W±10%
- Relay Coil Resistance: 19Ω ±10%

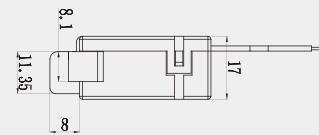
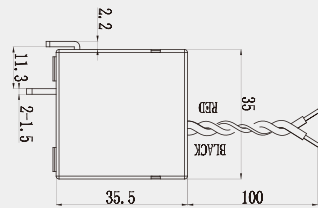

BDJ007-100A-012-3X product description

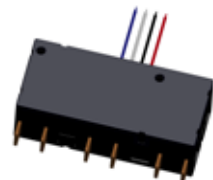

90.5x40x29.4mm

Contact DATA

- Contact Arrangement : 3 Form B
- Contact Capacity: 100A /250VAC
- Impact Current: In accordance with IEC62055-31 UC3 standard
- Max Switching Voltage: 440VAC
- Immune to strong magnetic field: 500mili-tesla (Working well,

latching well by over 500militesla magnets when 6 faces of the meters were interfered)

Coil DATA

- Rated Voltage: 12VDC
- Rated Power Consumption: 2.5W±10%
- Relay Coil Resistance: 8Ω ±10%

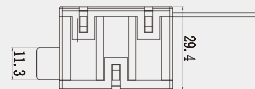
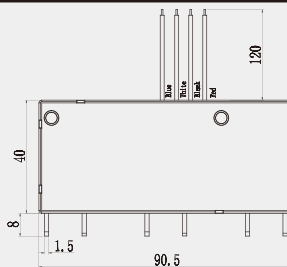

BOLTA ELECTRIC

MINI SIZE



MEGA POWER

About us

Based in Shenzhen, China, Bolta Electric (Shenzhen) Co.,Ltd, is a company focus on R&D of Latching Relay as well as production and sales of high-tech electronics components.

Intellectual Patent

Bolta has lots of valid patents which were approved SIPO in the motor driven latching relay.(INVENTION PATENT 201110118585.3 ,PATENT OF UTILITY MODELS ZL201120144564.4, ZL201120313634.4, ZL201120335145.9, 201220106558.4, 201420538068.0, 201520123933.X CN201721736674.3 CN201820565101.7 ZL201820994076.4 PCT/CN2018/094757

Characteristics

- | | |
|--|---|
| • Insulation resistance: 1000MΩ (at 500VDC) | • Ambient temperature: -40°C to 85°C |
| • Dielectric strength: Between open Contact 2000VAC 1min | • Contact Material: AgSnO ₂ |
| Between Coil &Contact 4000VAC 1min | • Contact ResistanceMaximum: 0.5mΩ at initial value |
| • Operate time: 100ms max | • Rated Width of Input Pulse: 100ms |
| • Release time: 100ms max | • Max Width of Input Pulse: 200ms |
| • Vibration resistance: 10Hz to 55Hz 1.5mm DA | • Max. Allowable Voltage: 20VDC |
| • Humidity: 5%~90% RH | • Construction Dust protected |

Bolta Electric (Shenzhen) Co., Ltd.

Tel: (+86)139 0298 5864 (+86)755-86599558

E-mail: 1582061205@qq.com

Web: www.berelay.com

Address: 6F, Bldg Huaxing, Dongfang Science and Technology Park, Qiaoshen Road, Nanshan District, Shenzhen, Guangdong, China

Zip code: 518053

BDJ015-60A-009 product description

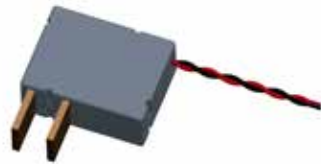

27x20.5x11mm

Contact DATA

- Contact Arrangement: 1 Form B
- Contact Capacity : 60A /250VAC
- Impact Current: In accordance with IEC62055-31 UC2 standard
- Max Switching Voltage: 440VAC

Coil DATA

- Rated Voltage: 9VDC
- Rated Power Consumption: 1.3W±10%
- Relay Coil DATA Resistance: 15Ω ±10%

Thickness 11mm only!

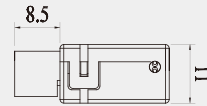
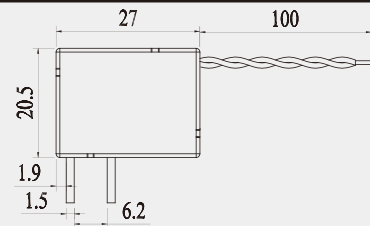

BDJ009-90A-009 product description

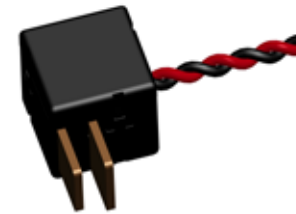

20X20X20mm

Contact DATA

- Contact Arrangement: 1 Form B
- Contact Capacity: 90A /250VAC
- Impact Current: In accordance with IEC62055-31 UC3 standard
- Max Switching Voltage: 440VAC

Coil DATA

- Rated Voltage: 9VDC
- Rated Power Consumption: 1.5W±10%
- Relay Coil Resistance: 13Ω ±10%

TÜV NO.: AK 50485665 0001

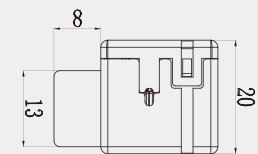
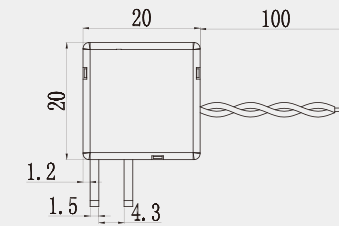

BDJ016-100A-012-3X product description

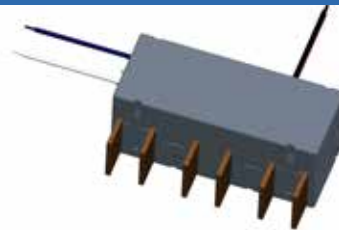

63x25.5x25.5mm

Contact DATA

- Contact Arrangement: 3 Form B
- Contact Capacity : 100A /250VAC
- Impact Current: In accordance with IEC62055-31 UC3 standard
- Max Switching Voltage: 440VAC

Coil DATA

- Rated Voltage: 12VDC
- Rated Power Consumption: 2.5W±10%
- Relay Coil Resistance: 8Ω ±10%

Length 63mm only!

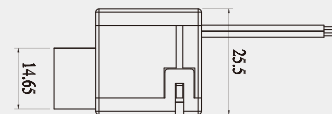
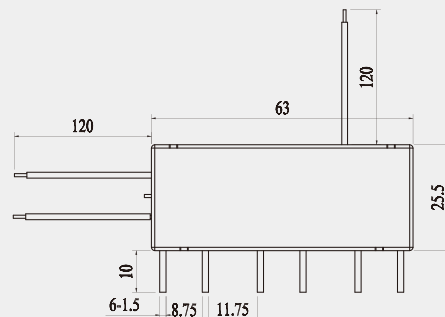

BDJ010-120A-012-3X product description

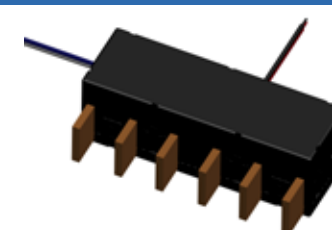

77x25x25mm

Contact DATA

- Contact Arrangement: 3 Form B
- Contact Capacity: 120A /250VAC
- Impact Current: In accordance with IEC62055-31 UC3 standard
- Max Switching Voltage: 440VAC

Coil DATA

- Rated Voltage: 12VDC
- Rated Power Consumption: 2.5W±10%
- Relay Coil Resistance: 8Ω ±10%

TÜV NO.: AK 50521292 0001

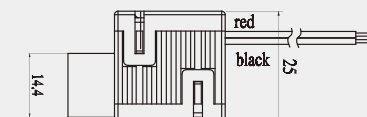
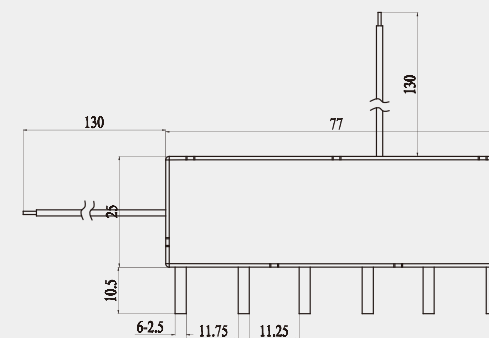

BDJ018-100A-009 product description



23.5x22x20mm

Contact DATA

- Contact Arrangement: 1 Form B
- Contact Capacity: 100A /250VAC
- Impact Current: In accordance with IEC62055-31 UC3 standard
- Max Switching Voltage: 440VAC

Coil DATA

- Rated Voltage: 9VDC
- Rated Power Consumption: 1.5W±10%
- Relay Coil Resistance: 13Ω ±10%

Cost effective 100A!

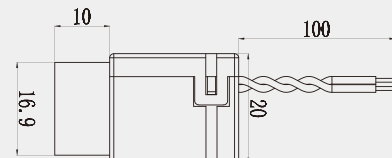
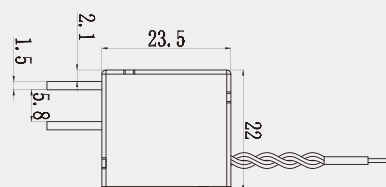

BDJ011-120A-009 product description



24x23.5x20mm

Contact DATA

- Contact Arrangement: 1 Form B
- Contact Capacity: 120A /250VAC
- Impact Current: In accordance with IEC62055-31 UC3 standard
- Max Switching Voltage: 440VAC

Coil DATA

- Rated Voltage: 9VDC
- Rated Power Consumption: 1.5W±10%
- Relay Coil Resistance: 13Ω ±10%

TÜV NO.: AK 50521701 0001

