

T: 01264 365550

E: Exhibitorsales@showlite.co.uk

www.showlite.co.uk

Invoice Details

Purchase Order No:

Invoice Company Name:

Invoice Contact name:

Invoice Address:

Post Code:

Tel No:

VAT Number:

Email Address for invoice:

Stand Details

Exhibiting Company Name:

Stand Number:

Please specify the position of each item using the grid on page 2.

	Early Bird	After 18/04/2025	Quantity	Total Cost
Wall Panel - 2.5m (h) x 1m to match shell scheme	£60.00	£72.00	<input type="text"/>	<input type="text"/>
Door Section 2.5m (h) x 1m to match shell scheme	£145.00	£174.00	<input type="text"/>	<input type="text"/>
Curtained Entrance 2.5m x 1m, please specify colour :Black or White	£80.00	£96.00	<input type="text"/>	<input type="text"/>
18mm MDF Infill panel, to allow for wall mounting of TV's or products. Max weight 35kg	£93.50	£112.20	<input type="text"/>	<input type="text"/>
Slat wall panel to replace standard wall panel <i>(please contact us if you require hooks)</i>	£105.00	£126.00	<input type="text"/>	<input type="text"/>
Flat shelf - 1m long x 300mm deep (an additional fee of £20 per shelf will be added if ordering with flush fitting graphics to notch graphics on site) maximum weight 12kg.	£35.00	£42.00	<input type="text"/>	<input type="text"/>
Sloping shelf - 1m long x 300mm deep maximum weight 7kg.	£40.00	£48.00	<input type="text"/>	<input type="text"/>
Hat & Coat hooks fixed to wall	£40.00	£48.00	<input type="text"/>	<input type="text"/>

SUB TOTAL

VAT 20%

TOTAL

Goods/Services will not be provided unless fully paid for in advance. If you wish to pay by Credit/Debit Card please call once in receipt of the invoice.

It is the exhibitor's responsibility to remove any polythene covering from their flooring.

*Showlite cannot guarantee the order will be processed if the order is not sent to the email address on the form. You will receive an invoice as order confirmation.

Please note all orders are subject to availability, and stock is not reserved until full payment is made.

Cheques made payable to **Showlite Ltd.** BACS details will be available on your invoice, alternatively please contact us for details. By completing this order form, you are agreeing to our Terms and Conditions. For a copy please contact us on 01264 365550.

T: 01264 365550

E: Exhibitorsales@showlite.co.uk

www.showlite.co.uk

■ Please indicate on the below grid the position of any items ordered and any height measurements for shelving or rails

Stand Number above:

Stand Number Right:

GRID OPTIONS

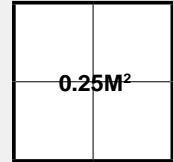

0.25M²

3X3 STAND

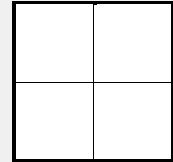

6X6 STAND

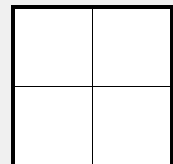

12X12 STAND

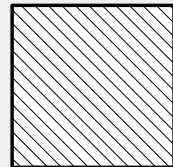

PLEASE HATCH
UNUSED SPACE

Stand Number Left:

FRONT OF STAND

PLAN
VIEW

STAND NUMBER

COMPANY NAME

ADDITIONAL NOTES

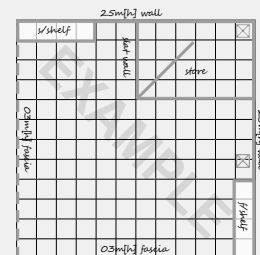

Please send your completed form to Exhibitorsales@showlite.co.uk

* Unless supplied with this drawing, the installation will be fitted at the stand builder's discretion.
Any complaints or faults must be reported in writing before the close of the exhibition