

TRIG POINT SERVICE BODY

LAND CRUISER 79 SERIES DUAL CAB



TO SUIT: Land Cruiser 79 Series dual cab. All years.



Made Tough

- Direct mounting to the chassis. No tray required.
- Rear bar protects canopy and under body boxes from damage.
- Fully sealed doors keep out water and dust.
- Under body boxes, tapered to improve departure angle.
- Aluminium and steel construction gives the perfect balance between light weight and durability.
- Fully lockable.



Made Smart

- Monocoque construction removes the need for an internal frame and increases storage areas while reducing weight.
- Integrated with vehicle central locking.
- Flat roof rack built into canopy roof. The lack of an external rack improves fuel economy and reduces overall vehicle height.
- 2 large doors give you easy access to the large internal space.
- Completely flush low floor with no external lips makes loading a breeze.
- Rear power distribution for additional accessories.



Made in Australia

- Fully ADR compliant.
- Recessed rear LED lights reduce chance of damage.
- Internal LED door switched lights
- 12V power outlet.
- Slam shut latches
- Filtered air vents to cool and circulate air though the service body.
- Fully recessed doors for smooth exterior.

OPTIONS AND MODEL VARIANTS

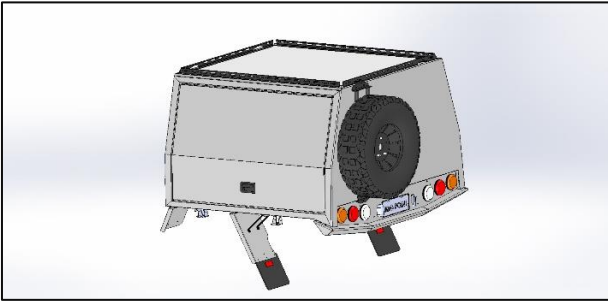

Required Part numbers

SBTL79DC, TC002, LPK005, WAK002, TK002

Service Body Series 1B.

- 2 large doors give you easy access to the large internal space
- Direct mounting to the chassis. No tray required
- Fully recessed doors for smooth exterior
- Integrated roof rack built into canopy roof
- Canopy roof rated to 300kg as per AS1235-2000. Subject to vehicle manufacturers COG limit while reducing weight
- Monocoque construction removes the need for an internal frame and increases storage areas
- Completely flush low floor with no external lips makes loading a breeze
- Fully sealed doors keep out water and dust
- Integrated with vehicle central locking
- Recessed rear LED lights reduce chance of damage
- Recessed doors with dual latch point offers fantastic security
- Internal Dual Colour LED door switched lights
- Trimmed carpet flooring
- Single tyre carrier included (contact us if -50 tyre carrier required)
- 12V power outlet
- Rear power distribution for additional accessories
- Door ajar buzzer integrated into canopy
- Fully ADR compliant
- Available standard in Grey or Mannex Black Powder coat
- 279kg, 1830mm wide, 1700mm long

Integrated Rear Bar (Included with canopy)

- Protects the service body and under body boxes from damage
- Securely mounted to service body frame and braced to chassis mounts
- Tapered for improved departure angle
- Designed specifically for Trig Point bodies, seamlessly integrating with surrounding components

Underbody Tool Boxes (Included with canopy)

- Tapered to improve departure angle
- Slam shut latches
- Fully lockable
- Downward opening door for easy access
- Door seals for water and dust resistance
- Rated to carry 20kg
- Durable cast hinges
- Designed specifically for Trig Point bodies to seamlessly integrate with surrounding components
- Suits most 3.5" single exhausts. Contact trig point for twin exhausts

Vehicle Specific Accessories

Black Chrome Tail Light Kit
Flared Wheel Arch Kit 35mm
Portal Axle Wheel Arch Kit

Portal Axle Tyre Carrier
Rear Winch Cradle Kit
Taller Canopy Mount Kit for 35"+ tyres

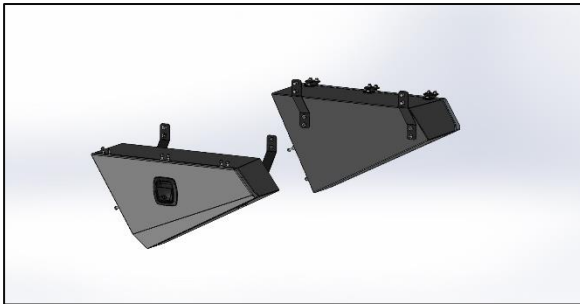

Warranty policy available at: www.trigpoint.com.au