



TRIG POINT SERVICE BODY

FORD RANGER, FORD RANGER RAPTOR & MAZDA BT-50 DUAL CAB



TO SUIT:

2011+ Ford Ranger Dual Cab

2011 - 2020 Mazda BT-50 Dual Cab

2018+ Ford Ranger Raptor



Made Tough

- Direct mounting to the chassis. No tray required.
- Rear bar protects canopy and under body boxes from damage.
- Fully sealed doors keep out water and dust.
- Under body boxes, tapered to improve departure angle.
- Aluminium and steel construction gives the perfect balance between light weight and durability.
- Fully lockable.
- 2 large doors give you easy access to the large internal space.

Made Smart

- Monocoque construction removes the need for an internal frame and increases storage areas while reducing weight.
- Fully Compatible with original parking sensors and cameras.
- Integrated with vehicle central locking.
- Flat roof rack built into canopy roof. The lack of an external rack improves fuel economy and reduces overall vehicle height.
- Completely flush low floor with no external lips makes loading a breeze.
- Rear power distribution for additional accessories.

Made in Australia

- Fully ADR compliant.
- Recessed rear LED lights reduce chance of damage.
- Internal LED door switched lights
- 12V power outlet.
- Slam shut latches
- Filtered air vents to cool and circulate air through the service body.
- Fully recessed doors for smooth exterior.



OPTIONS AND MODEL VARIANTS

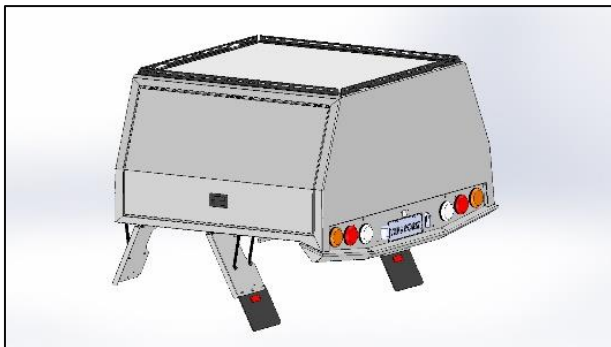

Required Part numbers

2011+ Ranger: SBFR15DC, LPK001, WAK001, TK001
2011 - 2020 BT50: SBMB11DC, LPK001, WAK001, TK001
If fitted with parking sensors substitute LPK001 with LPK002

2018+ Raptor SBFR18FR, LPK001, WAK013, TK001
If fitted with parking sensors substitute LPK001 with LPK002

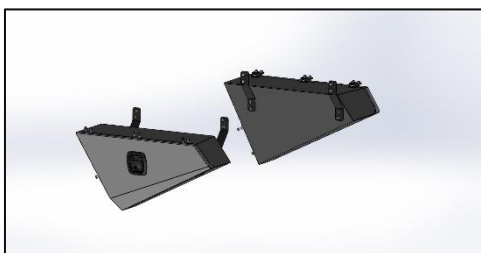

Service Body Series 1A.

- 2 large doors give you easy access to the large internal space
- Direct mounting to the chassis. No tray required
- Fully recessed doors for smooth exterior
- Integrated roof rack built into canopy roof
- Canopy roof rated to 300kg as per AS1235-2000. Subject to vehicle manufacturers COG limit
- Monocoque construction removes the need for an internal frame and increases storage areas while reducing weight
- Completely flush low floor with no external lips makes loading a breeze
- Fully sealed doors keep out water and dust
- Integrated with vehicle central locking
- Recessed rear LED lights reduce chance of damage
- Internal Dual Colour LED door switched lights
- Trimmed carpet flooring
- 12V power outlet
- Door ajar buzzer integrated into canopy
- Rear power distribution for additional accessories
- Fully ADR compliant
- Available standard in White, Grey or Mannex Black Powder coat
- 280kg, 1865mm wide, 1700mm long

Integrated Rear Bar (included with canopy)

- Protects the service body and under body boxes from damage
- Securely mounted to service body frame and braced to chassis mounts
- Tapered for improved departure angle
- Durable steel construction
- Designed specifically for Trig Point bodies, seamlessly integrating with surrounding components

Underbody Tool Boxes (included with canopy)

- Tapered to improve departure angle
- Slam shut latches
- Fully lockable
- Downward opening door for easy access
- Door seals for water and dust resistance
- Rated to carry 20kg
- Durable cast hinges
- Designed specifically for Trig Point bodies to seamlessly integrate with surrounding components

Vehicle Specific Accessories

Black Chrome Tail Light Kit No Sensors
Black Chrome Tail Light Kit with Sensors
Flared Wheel Arch Kit
Camera Relocation Kit
Rear Winch Cradle Kit (Ranger only)

Warranty policy available at: www.trigpoint.com.au