



Overview

Length (closed)	7100mm
Length (open)	8000mm
Width	2170mm
Height	2650mm
Ball Weight	241kg
Tare	2436kg
ATM	3000kg
Sleeping Capacity	2-3

* All measurements are approximate and should be used as a guide only.
 ** Weights are dependent on each individual product and subject to variation.



Standard Inclusions

- 200AH Lithium Battery
- REDARC** Manager30 + RedVision Monitor
- REDARC** RS3 Pure Sine Wave 2000W Inverter
- 600W Roof Mounted Solar Panels
- 2 x 120L Fresh Water Tanks + 1x 80L Grey Water Tank
- Truma Ultra Rapid 14L Gas/Electric Hot Water System
- Certified Gas Plumbing
- Dometic Roof Mounted Reverse Cycle Air Conditioning
- Diesel Heater with Digital Display
- Alloy Wheels With Mud Tyres
- Cruisemaster DO35 Off Road Coupling
- Ark XO Heavy Duty Jockey Wheel
- Alloy Front Mounted Tool Box
- Rear View Camera
- TV with Antenna and Internal/External Mounts
- 16oz Enclosed Annex With Walls & Vinyl Floor



VIPER 16 C

ESCAPE EDITION MKIII

1300 628 494
www.maverickcampers.com.au



Exterior

Chassis	Fully Galvanized
Brakes	12" Electric Brakes
Underbody	Anti-Chip Protection
Wheel Arch Flairs	Included
ADR Compliant Safety Chains	2
Gas Shock Absorbers	4
Full Size Spare Wheel	2
Jerry Can Holders	In Front Mounted Box with 4x Tie Down Points
Awning	Electric, 4m(w)
Annex	16oz Canvas Walls and Vinyl Floor + Outdoor Shower Tent
Trailer Breakaway System	Included
Rubber Seals	Automotive Grade Pinch Weld
Suspension	Adjustable Independent Trailing Arm Coil Spring
Tyres	265/75/R16 Off Road
Wheels	6 Stud 16" Alloy
9kg Gas Bottle Holder	2 In Front Mounted Box, adjustable to suit 4kg
Stabilizer Legs	4x Drop-Down Heavy-Duty
Fan in Fridge Slide	Included
Bike Rack Receiver	On Rear Bar

Camping Comforts

Fresh Water Tanks	2x 120L Poly with Bash Plate
Grey Water Tank	80L Poly
Kitchen & Drying Rack	Stainless Steel
Fold Over Prep Bench	Stainless Steel
Gas Plumbing	To External Gas Bayonet and Internal Kitchen
Plumbed Water	To Ensuite, Kitchens and Drawbar Tap
Temperature Control	Dometic Reverse-Cycle Air Con and Diesel Heater
Seating	Leatherette
Flooring	Premium Vinyl
Mattress	King size, Plush Inner Spring
TV	24"
Entertainment System	DVD/CD/BT/Radio with 4 Speakers
Ensuite	Dometic Cassette Toilet, Basin & Shower
Internal Storage	Cupboards, Bedside & Under Seat Compartments
External Storage	Lockable Hatches. Lift Up and Slide Drawer Pantry
Fridge Slide	1275mm x 550mm x 520mm (L x W x H)
Clothesline	Removable, positioned on Drawbar



Electrical

Battery	Lithium Battery 200AH
Battery Management	REDARC Manager30 with RedVision Monitor
Inverter	REDARC RS3 Pure Sine Wave 2000W Inverter
Solar Panels	600W Roof Mounted
Control Panel	Internal, with gauges and switches
Gauges	2x Water Level and 1x Grey Water Level
Fridge Slide	Anderson Plug, 12V Socket and 240V
Internal	12V Sockets and 12V USB Sockets
External	2x 3.5mm 12V Sockets
Lights	Kitchen LED, External Dual LED & Ensuite Courtesy Light
240V Power System	15 Amp Inlet and 10 Amp Outlet
TV & Antenna	Internal & External Mounts and Connections

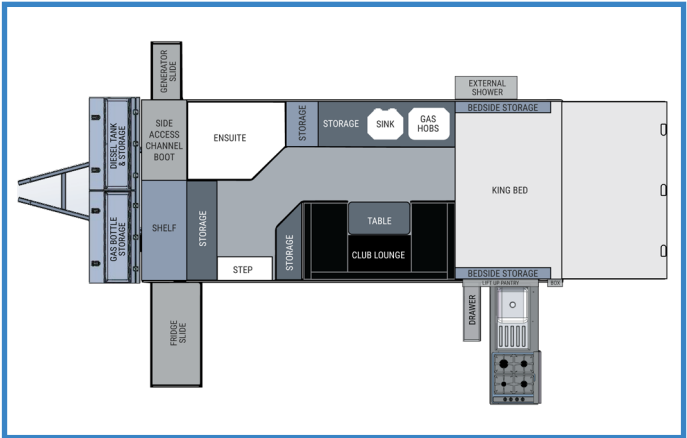



1300 628 494

www.maverickcampers.com.au

Showroom Locations
 142 Main North Road, Prospect SA
 37B Lear Jet Drive, Caboolture QLD
 1 Quartz Way, Wangara WA
 1920 Hume Highway, Campbellfield VIC

Finance Available
 Speak to our team for more details.

***All weights and specifications are correct at time of publication. However, they may be subject to change. Please confirm with our sales team at time of purchase.

