

## 东振机械

Xinxiang Dongzhen Machinery Co., Ltd

品质源于专业

匠心制造 让每一位顾客放心使用

地址: 新乡市开发区东振路6号

ADD: NO. 6 Dongzhen Rd. Xinxiang Henan

电话 (Tel): +86-373-3510800 3510801

+86-373-3510802 3510803

+86-373-3510827 (International department)

传真 (Fax): +86-373-3510806

Email: hndhzd@163.com (国内市场部)

xxdzjx@hotmail.com (International department)

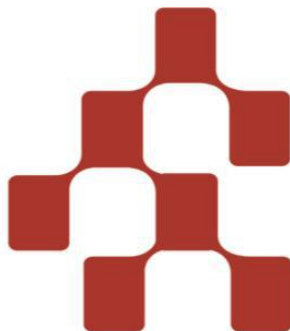

## 工匠精神

— 打造高精尖产品



新乡市东振机械制造有限公司  
XINXIANG DONGZHEN MACHINERY CO.,LTD.



# 东振机械

## Dongzhen Machinery

### Vibration Equipment

Xinxiang DongZhen Machinery, located in high tech Development Zone of Xinxiang city, which is an enterprise integrate scientific researching, device producing and product marketing. Our products are mainly for sieving, conveying, elevating and cruching. The company has strong technical force. Based on advanced production equipment and strict management system, With the stratgy aim to abtaining enterprise reputation, be bold in innovation technology and provide good service, the company has become a well-known enterprise in the industry, after more than 20 years of development.

Dong Zhen machinery mainly produces DZ series vibrating screen, three dimensional rotary vibration sieve, linear vibration sieve, ultrasonic vibration sieve, test sieve, air flow sieve, filter screen, test screen, screen, vibrating motor, vibration conveyor, vibration elevator, vibration feeder and other handling equipment for bulk material , widely used in food, chemical, pharmaceutical, resin, ceramic, metal powder metallurgy, papermaking, mining, coal and other industries.

新乡市东振机械制造有限公司是一家以生产筛分、输送、提升、粉碎设备为主，集科研、生产、售为一体的专业厂家。东振机械位于新乡市高新技术开发区，公司以技术力量雄厚、生产设备先进、管理体系严格为基础，以重视企业信誉、勇于创新技术、用心做好服务为宗旨，经过30多年的发展，已经成为行业内的知名企业。

东振机械主要生产有DZ系列振动筛、旋振筛、直线振动筛、超声波振动筛、试验筛、气流筛、过滤筛、检验筛、矿筛、拍击筛、振动电机、输送机、给料机等各种物料处理设备，广泛应用于食品、化工、树脂、医药、陶瓷、金属粉末矿冶、造纸、矿山、煤炭等行业。

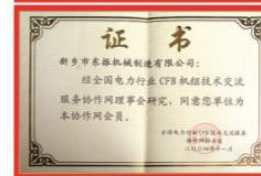



AR

## S49-B旋振筛

S49-B Vibrating Sifter



### 应用领域

Application field

食品行业：糖粉、淀粉、米粉、奶粉、豆浆、蛋粉、酱油、果汁、冲饮、乳品、糖果、调味品、蛋白、食品添加剂等  
医药行业：工业药品、中药粉、颗粒药丸、微丸等  
化工行业、冶金粉末行业、造纸行业、陶瓷行业、采矿行业等

**Food industry:** sugar powder, starch, rice flour, milk powder, soy milk, egg powder, soy sauce, fruit juice, brewed into tea, dairy products, candy, seasonings, protein, food additives, etc.

**Pharmaceutical industry:** industrial drugs, Chinese medicine powder, granule pills, pellets, etc.  
Chemical industry, metallurgy powder industry, paper industry, ceramics industry, mining industry, etc.

### 技术参数/Technical Parameter

型号 Model	公称直径(mm) Diameter	层数 Deck	有效筛分面积(m <sup>2</sup> ) Screen mesh area	筛网规格(目) Mesh size (mesh)	最大入颗粒度(mm) Max particle size	功率(kw) Power
S494-B	Φ 430	1-4	0.11	3-500	<20	0.25
S496-B	Φ 654	1-4	0.28	3-500	<20	0.6
S498-B	Φ 800	1-4	0.44	3-500	<30	0.6
S4910-B	Φ 950	1-5	0.64	3-500	<30	0.8
S4912-B	Φ 1160	1-5	0.95	3-500	<30	1.5
S4915-B	Φ 1500	1-4	1.65	3-500	<50	2.2
S4918-B	Φ 1768	1-3	2.40	3-500	<50	2.5
S4920-B	Φ 1950	1-3	2.85	3-500	<60	2.5

### 工作原理

Working principle

三次元旋振筛，由直立式电机作激振源，电机上、下两端安装有偏心重锤，将电机的旋转运动转变为水平、垂直、倾斜的三次元运动，再把这个运动传递给筛面，使物料在筛面上做外扩渐开线运动，故该系列振动筛称之为旋振筛。旋振筛具有物料运行的轨迹长，筛面利用率高等优点，调节上、下两端重锤的相位角，可改变物料在筛面上的运动轨迹。可以对物料进行精筛分、概率筛分等不同的筛分要求。

S49-B Vibrating Sifter is a kind of mature technology general and tend to be standardized classic inertia screening equipment. It can meet the requirement of most materials in grading granulated stuffs and screening out powder and liquid in different operation. High screening efficiency. It adopts whole sealing structure design, which can avoid polluting effectively. The convenience of installation and service. It can be equipped with screen cloth cleaning device to avoid clogging effectively. The vertical and horizontal movement of the machine speed and track of materials on the screen can be controlled by adjusting the angle of the two eccentric weights. It uses vertical motor as the source of vibration, equipped eccentric hammer on the both sides of motor, change circular rotate to level, upright and incline movement, then pass these three movement to surface of the screen. Adjust the phasic angle on the both sides of the top and bottom to change the movement track of the surface screen.

### 优势特点

Advantages and characteristics

- 1. 高效筛选** 筛分精度高、效率高，任何粉、粒、粘液类均可使用。
  - 2. 设计精巧** 体积小、重量轻移动方便、出料口方向可任意调整，粗、细料自动排出，可自动化或人工作业。
  - 3. 特质筛网** 筛网不阻塞、粉末不飞扬、筛分最细可达500目（28微米）过滤最细可达5微米。
  - 4. 结实耐用** 独特网架设计（子母式）、筛网使用寿命长、换网方便、仅需3—5分钟、操作简单、清洗方便。
- 1. Efficient screening** High screening accuracy and high efficiency. Any powder, grain, mucilage can be used.
  - 2. Compact design** Small size, light weight, easy to move. The direction of the discharge port can be arbitrarily adjusted. Coarse and fine materials automatically discharged. It can be automated or manual operations.
  - 3. Special quality screen** The screen does not block, the powder does not fly, the finest screen size up to 500 mesh (28 microns), the finest filter can reach 5 microns.
  - 4. Durable and unique** The unique design of the grid (Coarse-fine screen), long-term use of the screen, easy to change the net, only 3-5 minutes, simple operation, easy to clean.



法兰网架  
Flange type screen frame



子母网架  
Coarse screen/fine screen



胶粘网架  
Glue type screen frame

### 细节展示

Details display



## 超声波旋振筛 Ultrasonic vibrating screen



AR

### 应用领域 Application field



超声波振动筛适用于解决物料强吸附性、易团聚、高静电、高精度、高密度、轻比重等筛分难题。

Ultrasonic vibrating screen is suitable for solving the problem of strong material adsorption, easy reunion, high static electricity, high fineness, high density, light weight and other screening problems.

### 技术参数/Technical Parameter

型号 Model	公称直径 (mm) Diameter	层数 Deck	有效筛分面积 (m <sup>2</sup> ) Screen mesh area	筛网规格 (目) Mesh size (mesh)	功率 (kw) Power
S49U6-B	Φ 654	1-2	0.28	3-600	0.6
S49U8-B	Φ 800	1-2	0.44	3-600	0.6
S49U10-B	Φ 950	1-2	0.64	3-600	0.8
S49U12-B	Φ 1160	1-2	0.95	3-600	1.5
S49U15-B	Φ 1500	1-2	1.65	3-600	2.2

### 设备结构 Machine structure



### 工作原理 Working principle

超声波旋振筛是在原有旋振筛的基础上，在筛网上附加超声波振动仪，该仪器产生的高频机械波，使超微细粉体接受巨大的超声加速度，从而抑制粘附、摩擦、平降、楔入等堵网因素，提高筛分效率和清网效率。

该设备的特点是有效的改善低密度粉在重力沉降中的平降（粉末与网口轻接触）、滑移效应，改善高密度金属在网口滞留或楔入，改善带静电粉体的粘附效应，从而提高筛分效率和筛分质量。用筛分通过率表示，一般情况下比不加超声振动筛增加通过率50%-100%，个别情况下增加通过率400%。

Ultrasonic vibrating sieve is standard vibrating sieve machine added an extra ultrasonic equipment on it. The ultrasonic wave added on the sieve mesh makes the vibrating sieve able to screen/sieve fine powder/micro powder efficiently and precisely. The giant ultrasonic acceleration restrains blockage factors which includes adhesion, friction, wedging etc and improves sieving and cleaning efficiency.

It is able to improve the pancake and slip-effect of low-density powder in the gravity setting (light touch between powder and mesh), improving the occluding and wedging of high-density metal on the mesh, improving the adhesion effect of powder with the electrostatic, which improves the sieving efficiency and quality.



### 优势特点 Advantages and characteristics

- 1. 超声振动波** 使超微细粉体接受巨大的超声加速度，从而抑制粘附、摩擦、平降、楔入等堵网因素，提高筛分效率和清网效率。
- 2. 超声波电源** 超声波振动筛电源是超声波振动筛的技术核心，对解决筛网孔堵塞问题起到了至关重要的作用使振动筛能筛分的颗粒更精细，筛分的效率更高，适用范围更广。
- 3. 超声波网架** 用同一个超声电源，连接一个清网换能器，用超声换能器的辐射面与被堵塞的网面接触，产生相对位移，可清除网口的堵塞物。具有快速高效、不改变网口尺寸、不伤害丝网表面质量等优点。

**1.Ultrasonic vibration waves** Ultra-fine powders are subjected to huge ultrasonic acceleration, thereby suppressing blocking factors such as adhesion, friction, drop-down, wedging, etc., and improve screening efficiency and cleaning efficiency.

**2.Ultrasonic Power Supply** Ultrasonic shaker power supply is the core technology of ultrasonic vibrating screen. It plays a vital role in solving the mesh plugging problem of screen mesh. The vibrating screen can screen particles more finely, and the screening efficiency is higher. More extensive.

**3 Ultrasonic grids** The same ultrasonic power supply is used to connect a clean net transducer, and the radiation surface of the ultrasonic transducer is in contact with the blocked net surface to generate a relative displacement, which can remove the clogging of the net mouth. It is fast and efficient. It does not change the size of the net mouth, and does not harm the surface quality of the screen.



AR



## DZYS 摇摆筛

DZYS Tumbler sieve



### 应用领域

Application field



适用于医药、食品、矿业、铸造、磨料、建材、水泥、化工、化肥、轻工、造纸、粮业、盐业、粮食等颗粒、粉粒相关行业的干湿式筛分，液固分离废水筛滤回收等场合人。

Applicable to dry and wet screening, liquid-solid separation of waste water in pharmaceutical, food, mining, foundry, abrasive, building materials, cement, chemical, fertilizer, light industry, paper, grain, salt, food and other granular and powder related industries. Sieving recovery and other occasions.

### 技术参数/Technical Parameter

型号 Model	有效筛分面积(m <sup>2</sup> ) Screen mesh area	频率(r/min) Frequency	筛面倾角(°) screen slope	粒度(mm) Particle size	摆幅(mm) Amplitude	功率(kw) Power
DZYS-800	0.44	220-250	0-2	≤100	20-70	1.1
DZYS-1000	0.64	220-250	0-2	≤100	20-70	1.5
DZYS-1200	0.95	220-250	0-2	≤100	20-70	2.2
DZYS-1500	1.65	220-250	0-2	≤100	20-70	3.0
DZYS-1800	2.40	220-250	0-2	≤100	20-70	4.0
DZYS-2000	2.85	220-250	0-2	≤100	20-70	4.0
DZYS-2200	3.8	220-250	0-2	≤100	20-70	5.5

### 设备展示

Machines show



### 工作原理

Working principle

摇摆筛是目前为止最有效的模仿了人类手动动作和过程的筛机，其原理是：瞬时运动为沿径向的位移和以此位移为轴的圆周运动的合成（螺旋运动），即可调节偏心距的激振器产生了非线性三维运动，物料也产生同样的近似手动作业的运动，从而达到筛分之目的，再配合筛分附件可得到更加理想的筛分效果；适合于圆形、圆柱状、片状、精细粉末等易堵网且需要精密筛分的物料。

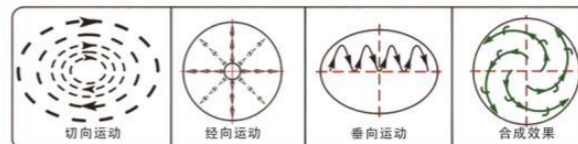

The swing sieve is the most effective sieve machine that mimics the manual movement and process of humans by far. The principle is: instantaneous movement is the synthesis of radial movement and circular movement with this displacement (spiral movement). The adjustable eccentricity exciter produces a non-linear three-dimensional movement, the material also produces the same approximate manual movement. So as to achieve the purpose of screening, with the screening attachment can get a more ideal screening effect; It is suitable for round shape, cylindrical, flake, fine powder and other materials that are easy to block and require precision screening

### 优势特点

Advantages and characteristics

- 1. 高效筛选** 高达5倍的单位面积产出；精确到6级分离，筛分效率高达90%-99%
- 2. 设计精巧** 优化重力均衡，密闭除尘，操作安全；噪音低<75分贝。
- 3. 易于清理** 使用硅橡胶球、超声波等高效清网装置系统，减少筛网堵塞。
- 4. 结实耐用** 加速度比振动筛低4-5倍，筛分零件寿命提高而维护减少。
  - 1. Efficient screening** Up to 5 times the output per unit area; Accurate to 6 separations, screening efficiency up to 90%-99%.
  - 2. Ingenious design** Optimize gravity balance, closed dust, safe operation; low noise <75 dB.
  - 3. Easy to clean** Use high efficiency cleaning devices such as silicone rubber balls and ultrasonics to reduce the screen clogging.
  - 4. Durable** Acceleration is 4-5 times slower than vibrating screens, and the life of screened parts is increased while maintenance is reduced.

AR



## 卧式气流筛 Centrifugal sifter

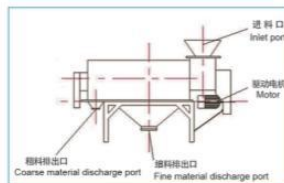

### 应用领域 Application field



广泛应用于各种难筛微细粉，如轻钙粉、活性钙粉、活性碳粉、淀粉、中药粉、粉煤灰、锌粉、石墨粉、石英砂粉、金粉、陶土粉、山楂粉、果疏粉、氢氧化钙粉、农药粉、魔芋粉、荧光粉、木粉、面粉、环氧树脂粉、二氧化锰、硫磺粉、氧化铝粉、胶木粉、氧化镁、珍珠岩粉、铁粉等。

Widely used in a variety of difficult to sieve fine powders, such as light calcium powder, active calcium powder, activated carbon powder, starch, Chinese medicine powder, fly ash, zinc powder, graphite powder, quartz sand powder, gold powder, clay powder, hawthorn powder, fruit powder, calcium hydroxide powder, pesticide powder, konjac powder, phosphor powder, wood powder, flour powder.

### 技术参数/Technical Parameter

型号 Model	材质 Material of construction	适用范围(目) Application (mesh)
BL18-65	不锈钢或碳钢可选 Stainless steel or carbon steel	≤150
BL30-100		≤150
BL40-120		≤150
BL65-185		≤150

### 设备展示 Machines show



### 工作原理 Working principle

卧式气流筛筛网为圆筒状，置于机体内，物料通过螺旋输送系统后与气流混合、雾化进入网筒内，通过网筒内风轮叶片使物料同时受离心力和旋风推进力，从而迫使物料喷射过网，由细料排出口排出，不能过网的物料沿筒壁从粗料排出口排出。

气流筛利用粉料微粒质量小而轻、易漂浮、流动性好的特点，将其充分扩散到气流中，粉料不再团聚，而是以单个微粒依次随气流透过筛网，因此气流筛的产量大、效率高、不粘网、不堵网孔、细度精确。

The horizontal airflow screen is cylindrical and placed in the body. After the material passes through the screw conveying system, it is mixed with air flow and atomized into the mesh cylinder. The wind wheel blades in the mesh cylinder simultaneously subject the material to centrifugal force and cyclonic propulsion. This forces the material to be sprayed through the net and discharged from the fine material discharge outlet. The materials that cannot pass through the net are discharged from the coarse material discharge outlet along the cylinder wall.

### 优势特点 Advantages and characteristics

- 1. 高效筛选** 以单个微粒依次随气流透过筛网气流筛的产量大效率高、不粘网不堵网孔、细度精确。
- 2. 科研革新** 能适应不同细度不同产量的各种难筛物料的筛分要求，有节能、高效和环保效果。
- 3. 结实耐用** 细筛网寿命延长10倍以上，产量稳定提高，功耗下降，过网的成品粉质量更好。
- 4. 完美结合** 通过螺旋喂料粉碎团块并使用气流促筛功能，增加筛分的精度以及透网率。

- 1.High-efficiency screening** The single-particles flow through the screen through the air flow screen in order to yield high efficiency, non-stick mesh does not block the mesh, precision fineness.
- 2.Research innovations** It can meet the screening requirements for various difficult screening materials with different fineness and different yields, with energy-saving, high-efficiency and environmental-friendly effects.
- 3.Sturdy and durable** The screen life is extended by more than 10 times, yield is steadily improved, power consumption is reduced, and the quality of finished powders passing through the net is better.
- 4.Perfect combination** Increase the accuracy of screening and penetration rate by crushing the agglomerate with spiral feed and using the air flow sieve function.



## ZS直线筛

ZS Linear Vibrating Screen

AR

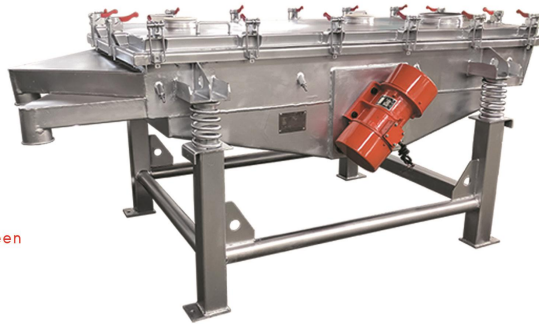

### 应用领域

Application field



广泛应用于化工、食品、塑料、医药、冶金、玻璃、建材、粮食、化肥、磨料、陶瓷等行业中干式粉状或颗粒状物料的筛分。

ZS linear vibrating screen is widely used in the screening of dry powder or granular materials in the chemical, food, plastic, pharmaceutical, metallurgy, glass, building materials, grain, fertilizer, abrasive, ceramic and other industries.

### 技术参数/Technical Parameter

型号 Model	有效筛分面积 Effective screening area	粒度 (mm) Particle size	层数 Deck	功率 (kw) Power	转速 (r/min) Rotate speed	振幅 (mm) Amplitude
ZS-520	500X2000	0.074-60	1-4	2X0.4	960	4-8
ZS-825	800X2500	0.074-60	1-4	2X0.75	960	4-8
ZS-1030	1000X3000	0.074-60	1-4	2X1.5	960	4-8
ZS-1236	1200X3600	0.074-60	1-4	2X2.2	960	4-8
ZS-1540	1500X4000	0.074-60	1-4	2x3.0	960	4-8

### 款型展示

Models show



### 工作原理

Working principle

ZS系列轻型直线振动筛是一种传统、经典、通用的筛分设备，其筛箱运动轨迹近似为直线。一般地，各种直线振动筛均由筛箱、支承或吊挂装置、驱动装置、隔振装置等几部分组成。ZS系列轻型直线振动筛利用振动电机的激振力作为振动源，其工作原理为，两台同一型号和规格的振动电机作同步反向转动，其所形成的、呈周期性交变的激振力驱动筛箱、带动筛面，进而使物料在筛网上被抛起，同时向前作跳跃式运动，通过多层筛网产生数种规格的筛上物、筛下物，最后分别从各自的排料口排出，完成筛分作业。

ZS series light linear vibrating screen is a traditional, classical and universal screening equipment. The movement track of its screen box is close to straight line. A linear vibrating screen is consisted of the screen box, supporting or hanging device, driving device, vibration isolation, etc.

ZS series light linear vibrating screen uses vibrating motor as vibration source. Its working principle is: Two vibrating motors rotate synchronously and backwardly, and the exciting force drives the screen box and the screen cloth, which makes the material throw up and linear movement forward on the screen deck. Finally, the undersize and oversize products are discharged through different screen to complete the screening operation.

### 优势特点

Advantages and characteristics

- 设计精巧** 筛机设计，精巧和容易装配，一人即可操作筛机。结构简单、维修方便、可用于流水线生产中的自动化作业。
- 高效筛选** 筛分精度高、处理量大、较大筛选面积和高效益之处理能力。耗能少、噪音低、密封性好、无粉尘溢散。
- 独特筛网** 独特筛网结构设计，方便和快速更换筛网（只需3到5分钟），此外此种设计允许使用各种筛网（尼龙、特种尼龙、PP网）。
- 结实耐用** 其母网完全支撑细网，因此使用寿命得以延长，而降低细网耗材使用，于长时间之生产过程可降低诸多成本。

**1. Ingenious Design** The machine design is exquisite, easy to assemble, one person can operate it. Simple structure, easy to maintenance, can be used for automated operation in assembly line production.

**2. High-efficiency screening** High screening accuracy and large processing capacity. Low energy consumption, low noise, good sealing, no dust pollution.

**3. Unique Screen** Unique screen structure design makes it easy and quick to change the screen (only 3 to 5 minutes). This design allows the use of various screens (nylon, special nylon, PP mesh).

**4. Strong and Durable** Coarse mesh supports the fine mesh, the service life of mesh is increased, which can reduce many costs during the long production process.

## DZPS直排筛

DZPS Rotary vibrating screen



DZPS系列直排筛是一种特殊新型，高效筛分机械，适于干式、湿式及各种几何形状物料的筛分作业。其通过安装于机器两侧的振动电机使物料产生3D运动，从而达到最大的筛分产量。主要用于食品医药行业成品包装工序之前的除杂，以及大吨位疏松原材料的筛分。

调整振动电机上部、下部重锤的相位角，可以改变物料在筛面上的运动轨迹，满足各种比重物料的最佳筛分效果。调节振动电机上部、下部重锤配重块的多少，可以达到不同的激振力，以达到不同的效果。

DZPS series flow-thru separator is a special and new-type screening machine with high-efficiency, it is suitable for the sieving all kinds of materials with dry, wet and various geometric shapes. It produces 3D movement of the material through a vibration motor mounted on both sides of the machine to achieve maximum screening capacity. It is mainly used for the impurity removal before the finished product packaging process in the food and pharmaceutical industry, as well as the screening of large-tonnage loose raw materials.

Adjusting the phase angles between upper and lower counter weights of the vibration motor can change the trajectory of the material on the screen surface and satisfy the optimal screening effect of various specific gravity materials. Adjusting the quantity of the upper and lower counter weights of the vibration motor can reach different excitation forces to achieve different effects.

### 款型展示

Models show



### 技术参数/Technical Parameter

型号 Model	公称直径(mm) Diameter	目数 Mesh	功率(kw) Power	转速(r/m) Rotate speed	振幅(mm) Amplitude
DZPS600	654	5-100	0.1X2	1450	3-5
DZPS800	800	5-100	0.25X2	1450	3-5
DZPS1000	950	5-100	0.25X2	1450	3-5
DZPS1200	1160	5-100	0.4X2	1450	3-5
DZPS1500	1500	5-100	0.4X2	1450	3-5
DZPS1800	1768	5-100	0.75X2	960	3-5

## 高频筛

High Frequency Sifter



### 应用领域

Application field



高频筛结构简单、体积小、重量轻、振幅小、频率高可达到每分钟3000次、效率高、能耗小。主要用于食品、医药、化工、磨料、陶瓷、冶金等行业的粉末、颗粒、粘液等原料的筛分过滤，特别是对于陶瓷泥浆的筛分，效果更为显著。

High frequency vibration sifter has characters as following: simple structure, small size, light weight, small amplitude and low energy consumption, its frequency can reach 3000 times per minute. Its application industries are: food, pharmaceutical, chemical, polishing media, ceramics, metallurgy and so on. It suits for sieving raw materials like powder, particles and liquid, especially for ceramics sieving with good effect.

### 技术参数/Technical Parameter

型号 Model	公称直径(mm) Diameter	激振力(kg) Exciting Force	功率(kw) Power	转速(r/m) Rotate speed	电机 Motor
DZ-600	654	500	0.4	2870	5-2
DZ-800	800	800	0.75	2870	8-2
DZ-1000	950	1000	0.9	2870	10-2
DZ-1200	1160	1500	1.3	2870	15-2



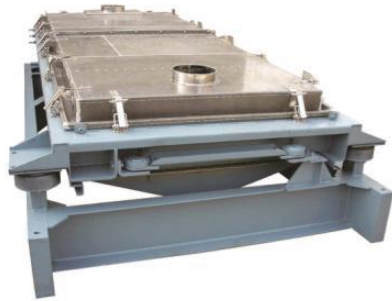

**回旋筛**  
Gyratory Sifter



### 优势特点

Advantages and characteristics

- 1. 先进科技** 引进国外先进技术, 具有结构简单, 运行平稳, 全封闭结构, 无尘埃, 防堵孔防粘网等优点。
- 2. 匠心设计** 采用了平面回转运动原理, 改善了物料的分布状态, 提高了筛面有效利用率和筛分效率。
- 3. 优质筛分** 针对吸湿性强粘性大、易堵孔和粘网的物料筛分效果更为明显。
- 4. 结实耐用** 回转运动延长了筛网使用寿命, 并有效地降低了设备的动静比和基础动载荷。

- 1. Advanced technology:** It is designed with imported advanced technology, with simple structure, smooth operation, fully enclosed structure, dust-free dyeing, anti blocking, anti stick network and so on.
- 2. Originality design:** The principle of plane rotary motion is adopted to improve the distribution status of material and improve the effective utilization ratio and screening efficiency.
- 3. Quality screening:** For the material with strong arthroscopic, large viscosity, easy plugging and sticky net, the screening effect is more obvious
- 4. Sturdy and durable:** The rotary motion prolongs the service life of the screen, and reduces the static and dynamic ratio of the equipment and the dynamic load of the foundation effectively.

### 款型展示

Models show



### 工作原理

Working principle

平面回旋筛是我公司在从事生产筛分机械的基础上引进国外先进技术, 又开发的一种新型的筛分设备。本机具有结构简单, 运行平稳, 全封闭结构, 无尘埃, 防堵孔, 防粘网等优点, 特别是对吸湿性强、粘性大、易堵孔和粘网的物料筛分效果更为明显。由于采用了平面回转运动原理, 不仅能够改善物料的分布状态提高筛面有效利用率和筛分效率, 且无垂直振动, 延长了筛网使用寿命, 并有效的降低了设备的动静比和基础动载荷。

The unique gyratory motion imparts a combination of actions to the material as it passes along the screen surface. It begins with a horizontal circular motion at the feed end, gradually diminishing along the length of the machine to an elliptical path, and finally to an approximate straight-line motion at the discharge end. There is no vertical component to this motion thus keeping the material in constant contact with the screen surface. Without vertical vibration, the mesh could gain a longer service life.

There are large application range of this machine. It is particularly effective when dealing with high absorbency, viscous, easy clogging material.

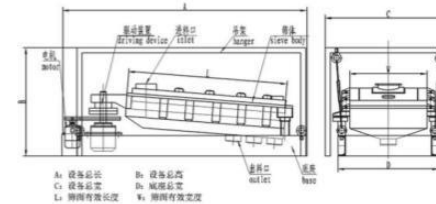

### 技术参数/Technical Parameter

层 Deck	型号 Model	尺寸 Screen size (mm)	Vibrating motor		A (mm)	B (mm)	C (mm)	D (mm)	重量 (kg)
			功率 Power (kw)	转速 speed (rpm)					
1	DZHS1014	1000x1400	1.5		2731	962	1168	1200	715
	DZHS1021	1000x2100	1.5		3285	962	1156	1200	980
	DZHS1030	1000x3000	1.5		4232	1035	1194	1251	1200
	DZHS1236	1200x3600	2.2	960	5098	1003	1708	1759	1380
	DZHS1521	1500x2100	1.5		3460	1362	1778	1892	1340
	DZHS1530	1500x3000	5.5		4484	1352	1956	2048	2020
2	DZHS1536	1500x3600	5.5		5263	1327	2464	2556	2410
	2DZHS1021	1000x2100	1.5		3743	1121	1308	1308	1400
	2DZHS1030	1000x3000	4		4575	1317	1270	1270	1840
	2DZHS1521	1500x2100	4	960	3728	1330	1781	1781	1710
	2DZHS1530	1500x3000	7.5		4765	1397	1956	1958	2780
	2DZHS1536	1500x3600	7.5		5365	1368	2032	2032	3180
3	2DZHS1836	1800x3600	7.5		5305	1500	2256	2256	3880
	3DZHS1021	1000x2100	5.5		4854	1422	1435	1549	2150
	3DZHS1630	1600x3000	5.5	960	4765	1391	1956	2159	3200
	3DZHS1836	1800x3600	7.5		5200	1500	2400	2500	4170
	3DZHS2050	2000x5000	11		5400	2000	2750	2810	5500



**方形摇摆筛**  
Square swing screen

**工作原理**  
Working principle

方形摇摆筛是一种具有高精度大产量的高效筛分设备，它广泛用于化工、冶金、有色金属、非有色金属、食品、磨料等行业。

从筛机摇动体即筛箱运动轨迹来看，方形摇摆筛又称往复筛。筛机运行时，筛箱在惯性力的作用作前后往复运动筛箱带动筛面作周期性摆动，从而使筛面上的物料随筛箱一同作定向跳跃式运动。其驱动装置所产生的振动力是一绕定轴、方向呈一定规律变化的惯性力，其本质是由偏心轮绕定轴转动所形成的往复惯性力。方形摇摆筛筛面一般为水平或微倾斜布置（倾斜角度 $0^{\circ} \sim 5^{\circ}$ ）。

Square swing screen is a high-efficiency screening equipment with high precision and large output. It is widely used in chemical, metallurgy, non-ferrous metals, food, abrasives and other industries.

Judging from the motion trail of the sieve box, that is, the sieve box movement, the square swing sieve is also called reciprocating screen. When the sieve machine is running, the motor rotates the screen box back and forth by the action of the inertial force to drive the screen surface to do periodically swing, so that the material on the screen surface is jumping motion together with the screen box. The vibration force generated by the motor is an inertial force that changes in a certain direction around the axis. The direction is essentially the reciprocating inertial force formed by the rotation of the eccentric wheel around the fixed axis. The square swing screen is generally horizontal or slightly inclined (inclination angle  $0^{\circ} \sim 5^{\circ}$ ).

**技术参数/Technical Parameter**

型号 Model	有效筛分面积(m <sup>2</sup> ) Screen mesh area	功率(kw) Power	筛面倾角(°) screen slope	层数 Deck	频率(r/min) Frequency	筛箱行程(mm) Sieve box movement
DZBS1030	3	3	5-8	1-5	180-260	25-60
DZBS1036	3.6	3	5-8	1-5	180-260	25-60
DZBS1230	3.6	4	5-8	1-5	180-260	25-60
DZBS1236	4.32	4	5-8	1-5	180-260	25-60
DZBS1530	4.5	5.5	5-8	1-5	180-260	25-60
DZBS1536	5.4	5.5	5-8	1-5	180-260	25-60
DZBS1830	5.4	7.5	5-8	1-5	180-260	25-60
DZBS1836	6.48	7.5	5-8	1-5	180-260	25-60
DZBS2030	6	7.5	5-8	1-5	180-260	25-60
DZBS2030	7.2	7.5	5-8	1-5	180-260	25-60



**TS-200标准试验筛**  
TS-200 Standard test sieve

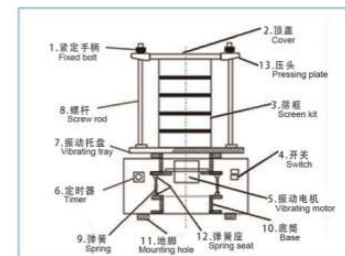

**优势特点**

Advantages and characteristics

TS-200试验筛广泛应用于实验室、质检室等检验部门。产品结构紧凑、噪音低、效率高、极度准确等特点突出，采用优质新型动力发生器，产生多元高频振动，对物料进行高效筛选、测定。同时可根据不同物料来通过电子延时器实现不同的工作时间，把检验误差降到最低程度，保证样品分析数据的一致性，对产品品质做出精确判断。主要用于检测颗粒状物料的粒度分布，或者产品杂质的含有量，以及液体物料中固形物的含量。

TS-200 test sieve is widely used in laboratories, quality inspection and other inspection departments. The product has the advantages of compact structure, low noise, high efficiency, highly accurate. High quality new power generator produces multiple high frequency vibration by which makes efficient screening and determination to raw material. At the same time, different working hours can be settled through electronic delayer. The test error rate is reduced to the lowest level, to ensure the consistency analysis of data samples, making accurate judgments on the quality of the products. Mainly used for detection of particle size distribution of granular materials, products or content of impurities, and the content of solid materials in liquid.

**技术参数/Technical Parameter**

型号 Model	层数(s) N Deck	直径(mm) Diameter	粒度(mm) Particle size	振幅(mm) Amplitude	电压(v) Voltage	转速 (r/min) Speed	功率 (kw) Power	噪音 (dB) Noise	一次性 投料(g) Batch capacity	外形尺寸 (mm) Dimension	重量(kg) Total Weight
TS-200	1-8	φ 200	0.038-20	≤5	220	1450	0.125	≤50	≤200	400x300x (300+Nx50)	30
TS-300	1-8	φ 300	0.038-20	≤5	220	1450	0.125	≤50	≤300	500x400x (350+Nx65)	40





## 450过滤机

450 type vibration filter

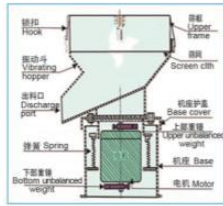

450型高效振动过滤机采用新型振动机构、振动稳、效率高，筛框操作简单。清洗方便，换网容易，外观新颖，结构合理，使用方便，220V单相或者380V三相可选，适合家庭或者变更工作地点的场合使用。

450 filter use new type vibrating structure, which is stable in vibration, high efficiency and easy to operate the sieve frame. Easy cleaning, easy changing screen, nice surface processing and simple structure make it easy to use. We have 220V single phase and 380 three phase or customized voltage to meet different application filed.

### 应用领域

Application field



450型高效振动过滤机是新型高效过滤、筛选设备，其由机体、振动体、下料斗、筛框、电控部分组成。可用于各类浆状、粉状物的过滤和筛选。过滤浆料最细可到5微米，筛选粉料最细可达500目。

450 filter includes machine body, vibrating part, discharge hopper, screen frame and electric control parts. It can be used for filtering and sieving of all kinds of pulp material and powder materials. For pulp sieving, it can reach to 500 mesh.

### 技术参数/Technical Parameter

型号 Model	功率(kw) Power	外形尺寸(mm) Dimension	筛格尺寸(mm) Screen Cloth Dimension	重量(kg) Weight
450	0.18	500X500X660	Φ448mmX135mm	40



## 螺旋输送机

Screw Conveyor

螺旋输送机是医药、食品、冶金、建材、化工、粮食以及机械加工等部门广泛应用的一种连续输送设备。从输送物料的位移方向的角度划分，螺旋输送机分为水平式和垂直式量大类型，主要用于对各种粉状、颗粒和小块状等松散物料的水平输送和垂直提升。

螺旋输送机与其它输送设备相比，具有整机截面尺寸小、密封性能好、运行平稳可靠、可中间多点装料和卸料及操作安全、维修简便等优点。

Screw conveyor is a kind of continuous conveying equipment which is widely used in medicine, food, metallurgy, building materials, chemical industry, grain and mechanical processing departments. Divided from the perspective of the direction of displacement of the conveying material, the screw conveyor is divided into horizontal type and vertical type, which is mainly used for horizontal conveying and vertical lifting of loose materials such as various powders, granules and small pieces.

Compared with other conveying equipment, the screw conveyor has the advantages of small size of the cross section, good sealing performance, stable and reliable operation, multi-point loading and unloading, safe operation, and easy maintenance.

### 技术参数/Technical Parameter

外壳直径 Pipe diameter	Φ108	Φ133	Φ159	Φ168	Φ219	Φ273	Φ325	Φ356	Φ426
螺旋直径 Spiral diameter	Φ90	Φ115	Φ140	Φ150	Φ200	Φ250	Φ300	Φ330	Φ400
螺距 Screw-pitch	90	115	140	150	200	250	300	330	350
转速 (r/min) Rotate speed	186.7	140	140	140	93.3	88	88	88	65
输送量 Capacity (m <sup>3</sup> /h)	2	3	5.5	6.5	11	20	33	44	50

以上螺旋的输送量是在物料为粉体、无腐蚀性、水平输送的条件下得到的最大理论数据，选型时需综合考虑物料种类、物料粒度、磨蚀性、粘性、倾角等因素。一般情况下，粒度越大、磨蚀性越强、倾角越大，需要的管径越大。管式的倾角不超过45度，U型槽式的倾角不超过35度。

The capacity of screw conveyor mentioned above is the maximum theoretical data calculated under the condition that the material is powder and non-abrasive, also in horizontal conveying. Factors such as material type, material size, abrasion, viscosity, and inclination should be considered in the process choosing models. In general, the larger particle size and the higher abrasion, the inclination angle will be larger, it requires larger pipe diameter. The inclination angle for tubular type screw conveyor should not exceed 45 degrees, and the inclination angle for U-shaped screw conveyor should not exceed 35 degrees.

## 无轴螺旋输送机

Shaftless Screw Conveyor



### 工作原理

Working principle

无轴螺旋输送机由驱动装置、无轴螺旋体、螺旋管、耐磨衬板、进出料口、盖板、支架等组成。物料从进料口进入螺旋管，利用螺旋体与物料的摩擦力及无轴螺旋体的轴力将物料输送到出料口排出，适合于长距离输送作业。

WS-LS type shaft less screw conveyor comprises of driving device, screw body, spiral pipe, wear-resistant liner, inlet and outlet cover, a support frame. The material are fed through tube inlet. The material is transported to outlet by friction between material and the spiral body and the axial force of the screw auger, mainly suitable for conveying operation in long distance.

### 技术参数/Technical Parameter

螺旋直径 Spiral diameter	Φ 200	Φ 260	Φ 300	Φ 360	Φ 400	Φ 440
螺距 Screw-pitch	200	260	300	360	400	440
转速 (r/min) Rotate speed	65	65	52	43	43	43
输送量 Capacity (m <sup>3</sup> /h)	3.7	8	10	14	19	31

WLS系列无轴螺旋一般使用在物料粒度大于60mm、磨琢性强、粘性、易结块、易缠绕、倾角不大于25度的场合。优点在于长度较长时不需吊挂轴承，减少了维护。以上数据是在粘性膏状物料、填充系数0.2的前提下得到的。

WLS series shaftless screw conveyor is generally used in applications where the material size is larger than 60 mm, strong abrasion, viscous, easy to agglomerate, easy to entangle, and the angle of inclination is no more than 25 degrees. The advantage is that there is no need to hang the bearings when the length is long, which avoids frequently maintenance. The above data is based on the premise of a viscous paste material with a filling factor of 0.2.

## GZV微型电磁给料机

GZV Tiny Electromagnetic Feeder

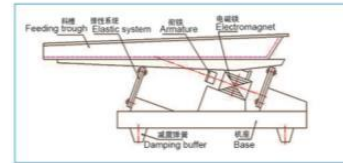

### 优势特点

Advantages and characteristics

- 设计精巧** 电磁给料机在使用过程中，可以调节激磁力来改变和控制流量，因而调节方便，流量稳定，噪音低，耗电小，无冲料现象。
- 生产过程自动化** 电磁给料机电气控制采用半波整流电器，可无级调节给料量，可用于自动控制的生产流程中，实现生产过程自动化。
- 易于保养** 无转动零部件，不需润滑，结构简单，重量轻，体积小，保养方便等特点，如采用封闭式结构，可防止粉尘外溢及环境污染。

**1.Exquisite design:** In the operation, Electromagnetic feeder, in use process, can adjust the exciting force can be adjusted by changing the current flow. The adjustment is very easy and convenient, with features of flow stability, low noise, small power consumption, no blanking and so on

**2.Production process automation:** Electric control of Electromagnetic feeder adopts half wave rectifier electric appliance, the feeding quantity can be adjusted. It can be widely used in automatic control production process to realize the production automation

**3.Easy maintenance:** No rotating parts, no lubrication, simple structure, light weight, small size, easy maintenance and other features, such as closed structure which can prevent dust spills and environmental pollution.

### 技术参数/Technical Parameter

型号 Model	输送量 (t/h) Capacity	双振幅 Double amplitude	频率 (r/min) Frequency	电压 (V) Voltage	功率 (W) Power	重量 (Kg) Weight
GZV1	0.1	1.5mm	3000	220	5	4
GZV2	0.5	1.5mm	3000	220	8	7
GZV3	1	1.5mm	3000	220	20	12
GZV4	2	1.5mm	3000	220	25	18
GZV5	4	1.5mm	3000	220	30	27
GZV6	6	1.5mm	3000	220	50	45





## GZG振动给料机

GZG vibration feeding machine



- 1 振动平稳 工作可靠
- 2 特制栅条间隙可 调可防物料堵塞
- 3 耐磨 增加产量
- 4 可选变频调速电机 便于控制给料量
- 5 耐磨件比较多
- 6 启动频率高

1. Stable vibration and running
2. Adjustable grid bar gap to avoid block
3. Wear resistant & big output
4. Optional frequency variable motor, easy to control the feeding rate
5. More wear parts
6. High running frequency

### |技术参数/Technical Parameter

型号 Model	入料粒度 Feeding Material size (mm)	处理量 Capacity (t/h)	功率 Power (KW)	振频 Frequency (HZ)	双振幅 Double amplitude (mm)	外形尺寸 (长*宽*高) (mm)
GZG-50	0-50	70-150	2X0.75	980	4-8	1400*500*258
GZG-60	0-50	100-200	2X0.75	980	4-8	1400*600*258
GZG-70	0-100	150-230	2X0.75	980	4-8	1400*700*258
GZG-90	0-100	300-700	2X1.5	980	4-8	1600*900*308
GZG-100	0-200	350-750	2X1.5	980	4-8	1600*1000*308
GZG-110	0-200	400-800	2X2.2	980	4-8	1600*1100*308
GZG-130	0-300	500-1000	2X2.2	980	4-8	1800*1300*320
GZG-150	0-300	600-1200	2X3.0	980	4-8	2000*1500*320
GZG-200	0-500	1000-2000	2X3.7	980	4-8	2500*2000*360

## SZG振动输送机

SZG Vibrating Feeder



### 应用说明

Application

SZG型振动输送机是一种重要的惯性振动输送机，该结构简单、形式与规格多样、可满足不同使用环境要求。用于各种行业，对各种小块状、颗粒状和粉状物料的中短距离输送，不仅适用于输送各种常温、普通物料，而且可以输送很多高温、有毒等非常规物料；如对承载体实行特殊加工，则在输送过程中可实现物料的筛选、干燥、加热、冷却等工艺要求。

SZG vibrating conveyor is an important vibration conveyor based on inertia. The structure is simple, the form and specifications are various, and it can meet the requirements of different applications. It is used in many industries to transport small, granular and powder materials in medium and short distances. It can not only be suitable for conveying various materials room temperature, but also transport a lot of non-conventional materials such as high temperature materials and toxic substances; If the trough used for special processing, the process such as screening, drying, heating, and cooling of the material can be achieved during the conveying process.

### |技术参数/Technical Parameter

型号 Model	处理量 Capacity (t/h)	输送距离 Conveying Capacity (m)	输送颗粒度 Max Material size (HZ)	双振幅 Double amplitude (mm)	频率 Speed (r/min)	功率 Power (kw)	外形尺寸 (长*宽*高) (mm)
1	SZG430	11	30				3000*400*200
	SZG830	17	3	60	1450	(0.6-1.1)x2	3000*800*250
	SZG1030	25		100			3000*1000*300
2	SZG440	11	30				4000*400*200
	SZG840	17	4	60	1450	(0.75-1.5)x2	4000*800*250
	SZG1040	25		100			4000*1000*300
3	SZG450	9	30				5000*400*200
	SZG850	15	5	60	1450	(1.1-1.9)x2	5000*800*250
	SZG1050	23		100			5000*1000*300
4	SZG460	9	30				6000*400*200
	SZG860	13	6	60	960	(1.1-2.2)x2	6000*800*250
	SZG1060	23		100			6000*1000*300
5	SZG470	9	30				7000*400*200
	SZG870	13	7	60	960	(1.5-3.0)x2	7000*800*250
	SZG1070	20		100			7000*1000*300



## ZLD振动料斗

ZLD Bin Activator

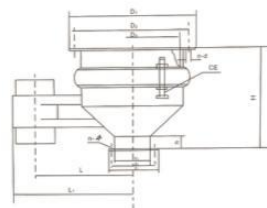

振动料斗是一种新型的料仓破拱给料装置，它装在料仓底部，具有给料机的全部性能，有破拱、均匀给料、截流、调流四种作用。该系列振动给料斗破拱性能好，对于料仓内的各种粉状及粒状物料都能实现破拱和连续均匀排料，可消除不同粒度、不同比重的混合物料在进入料仓时的偏析现象。其具有结构简单、重量轻、工作可靠、运转平稳、噪声小、动力消耗少、操作容易、易损件少、使用寿命长、维修工作量和生产率的调节范围大等优点。适合于圆形、方形、钢制或混凝土的任何料仓，可以实现完全密封输送，粉尘不外扬，不污染环境。

The Bin Activator designed by us consists of a conical shape discharge zone that is connected to storage silo or hopper through a set of steel hangers. The gap between the hopper and discharge zone is sealed with the help of a special flexible rubber sleeve. The material is made to flow normally through the opening provided at the discharge point with the help of one Unbalance Vibrator motor that is fixed on one side.

### 技术参数/Technical Parameter

型号 Model	出料量 Capacity (t/h)	粒度 (mm)	L	L <sub>1</sub>	D <sub>1</sub>	D <sub>2</sub>	D <sub>3</sub>	H	N-φ	n-φ	d <sub>1</sub>	d <sub>2</sub>	C E	h	振 频 (HZ)	功 率 (KW)
ZLD40	60	60	330	410	φ 490	φ 458	φ 400	375	16-φ 18	8-φ 11	φ 215	φ 150	4-φ 24	50	50	0.15
ZLD60	80	80	430	535	φ 726	φ 869	φ 600	560	20-φ 20	8-φ 11	φ 268	φ 200	4-φ 28	70	50	0.25
ZLD90	120	100	600	745	φ 1036	φ 975	φ 900	735	20-φ 22	8-φ 11	φ 330	φ 250	4-φ 34	100	50	0.4
ZLD120	150	120	760	920	φ 1359	φ 1279	φ 1200	920	24-φ 22	12-φ 11	φ 430	φ 300	4-φ 39	100	50	0.4
ZLD150	200	140	940	1100	φ 1662	φ 1581	φ 1500	1110	24-φ 22	12-φ 11	φ 500	φ 350	4-φ 41	150	50	0.75
ZLD180	300	160	1107	1285	φ 1965	φ 1883	φ 1800	1200	32-φ 24	16-φ 13	φ 590	φ 400	4-φ 45	150	50	2
ZLD200	400	170	1200	1385	φ 2220	φ 2100	φ 2000	1050	32-φ 24	16-φ 13	φ 600	φ 425	4-φ 50	200	50	2
ZLD240	500	180	1407	1585	φ 2620	φ 2510	φ 2400	1600	32-φ 24	16-φ 13	φ 620	φ 450	4-φ 55	200	50	2



## 弹簧上料机

Spring feeding machine

### 优势特点

Advantages and characteristics

弹簧上料机主要用于输送粉末状、颗粒状、球状及其它输送物料。由于其管子的柔性较好且可以弯曲，所以适用于不同生产布局的要求。本设备主要由进口口，出口口，弹簧，PPR软管，电机以及料仓组成。弹簧可分为扁弹簧和圆弹簧。由于圆弹簧的强度和韧性较好，故使用量较大，但在同等条件下，扁弹簧有较大的产量。

耐高低温，防粘性佳，可加挡板，提升角度大，容易清洗，维修简单，具有高强度耐酸碱、盐水等特点，适用于各种环境下的输送。

The spring loading machine is mainly used for conveying powdery, granular, spherical and other conveying materials. Due to its good flexibility and bendability, it is suitable for different production layout requirements. This equipment is mainly composed of feed inlet, discharge spring, PPR hose, motor and silo. Springs can be divided into flat springs and round springs. Since the strength and toughness of the round spring are better, the use amount is larger, but under the same conditions, the flat spring has a larger output.

It is resistant to high and low temperature, good anti-adhesion, can be added to the baffle plate, has a large lifting angle, is easy to clean, simple in maintenance, has high strength, acid and alkali resistance, salt water and other characteristics, and is suitable for transportation under various

### 技术参数/Technical Parameter

型号 Model	产量(kg/h) Capacity	转速(r/min) Rotate speed	直径(mm) Dia.of pipe	输送距离(m) Conveying length	功率(kw) Power	电压(v) Voltage
SF700	700	910	φ76	3, 5, 8 10, 20	1.5/2.2 3.0	220/240/380 415/440/460
SF1000	1000	910	φ89	3, 5, 8 10, 20	1.5/2.2 3.0	220/240/380 415/440/460



## 板簧输送机 Vibratory Conveyor



### 优势特点

Advantages and characteristics

板簧输送机由振源-振动电机或激振器、承载体、减振支承、承载基础及相关配套附件组成。根据现场使用环境及输送物料特性要求，输送机承载体可采用不同材料分别加工成U形槽和管状等机构形式，并可按有无密封要求制作成敞开型或封闭型，以满足不同工艺流程；由于设备承载体是金属制件及润滑点远离物料，因此，该机不仅可以输送各种常温、普通物料，而且可以输送很多高温、普通物料，而且可以输送很多高温、有毒等非常规物料；如对承载体施行特殊加工，则在输送过程中可实现物料的筛选、干燥、加温、冷却等工艺要求。

Vibrating conveyor commonly consists of vibrating source-vibrating motor, vibration generator supporting body, damping bearing, load-supporting base, related accessories kit, and so on. According to on-the-scene using environment and speciality requirement of the material transported, the supporting body of the conveyor can be made in the structure of U-groove and tubular shape. It can also be made in open-type and enclosed type according to sealing requirement to fit different technological process. Because the supporting body is made of metal and the lubricating points are far from material, not only all kinds of normal temperature and common material, but also many high temperature and poison-contained conventional material can be conveyed. If making additional work on the supporting body, other technological requirements can be realized during transportation, such as filtration, dryness, warming-up and cooling of the material.

### 技术参数/Technical Parameter

型号 Model	输送距离 Distance(M)	槽宽 Groove(mm)	振幅 Amplitude(mm)	功率 Power(Kw)
ZSJ1000	13	1000	6-12	1.1x2



## DZC垂直振动提升机 DZC Spiral Elevator



### 优势特点

Advantages and characteristics

本机占地面积小，容易清理，结构简单，合理，便于维修，动力消耗小，无噪音，适合于易碎物料。封闭式提升机防止了粉尘和有害气体对工作环境的污染。

本机对一切粉状，块状和短纤维状的固体物料都可以提升。广泛运用于化工，橡胶，塑料，医药，轻工，冶金，建材，机械，矿山，粮食等行业。除具有从下向上提升物料外，还可以作用于物料的干燥冷却。

The machine has a small footprint, easy to clean, simple structure, reasonable, easy to maintain, small power consumption, no noise, suitable for fragile materials. The enclosed hoist prevents dust and harmful gases from polluting the working environment.

The machine can be upgraded for all powder, block and short fibrous solid materials. Widely used in chemical, rubber, plastics, medicine, light industry, metallurgy, building materials, machinery, mining, food and other industries. In addition to lifting the material from the bottom up, it can also act on the dry cooling of the material.

### 技术参数/Technical Parameter

型号 Model	公称直径(mm) Spiral Diameter	输送高度(m) Lifting height	电机转速(r/min) Rotate speed	双振幅(mm) Double amplitude	功率(kw) Power
DZC500	500	≤6.0	960	6-8	2X0.75
DZC600	600	≤8.0	960	6-8	2X1.5
DZC800	800	≤8.0	960	6-8	2X2.2
DZC1000	1000	≤8.0	960	6-8	2X3.0
DZC1200	1200	≤8.0	960	6-8	2X4.5
DZC1500	1500	≤8.0	960	6-8	2X5.5

## 无尘投料站 Dust-free feeding station



无尘投料站适用于制药、化工、食品、电池材料等行业中、小袋物料的拆包、投放、筛分和卸料。拆包时由于集尘风机的作用，可以避免物料粉尘到处飞扬。当物料解袋并倒入下一道工序时，只需人工直接拆包投入到该系统，物料通过振动筛（安全筛网），可将大块物料和异物拦截，从而保证符合要求的颗粒排出。

风机功率0.75KW 振动电机功率0.8KW

The dust-free feeding station is suitable for unpacking, throwing, screening and unloading of small bag materials in the pharmaceutical, chemical, food, battery materials and other industries. Due to the function of the dust collecting fan during unpacking, material dust can be prevented from flying everywhere. When the material is unpacked and poured into the next process, it is only required to directly unpack and put it into the system. The material passes through the vibrating screen (safety screen), which can block large materials and foreign objects, thus ensuring the discharge of particles that meet the requirements.

Fan motor power 0.75KW Vibrating motor power 0.8KW



## 脉冲除尘器 Pulse dust collector

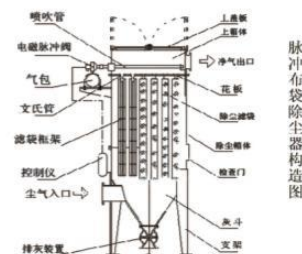

除尘器的工作原理如下：含尘气体由灰斗（或下部敞开式法兰）进入过滤室，较粗颗粒直接落入灰斗或灰仓，含尘气体经滤袋过滤，粉尘阻留于袋表，净气经袋口到净气室，由风机排入大气。当滤袋表面的粉尘不断增加，导致设备阻力上升到设定值时，时间继电器（或微差压控制器）输出信号，程控仪开始工作，逐个开启脉冲阀，使压缩空气通过喷口对滤袋进行喷吹清灰，使滤袋突然膨胀，在反向气流的作用下，附于袋表的粉尘迅速脱离滤袋落入灰斗（或灰仓），粉尘由卸灰阀排出。全部滤袋喷吹清灰结束后，除尘器恢复正常工作。

The working principle of the dust collector is as follows: the dust-containing air enters the filter chamber, and the coarser particles directly fall into the dust collector bottom to ash silo. The dust-containing air is filtered through the filter bag, and the dust is retained in the bag. The clean air passes through the bag and discharged into the atmosphere by the fan. When the dust on the surface of the filter bag increases continuously, causing the resistance of the dust collector rise to the set value. The time relay (or the differential pressure controller) send a signal, and the programmable controller starts to work. The pulse valve is opened one by one to make the compressed air pass through the nozzle then to the filter bag. The spray cleaning is carried out to make the filter bag suddenly expand. Under the action of the reverse air flow, the dust attached on the bag surface quickly leaves the filter bag and falls into the dust collector bottom. Finally the dust is discharged by the valve at bottom of dust collector. After all the filter bags are sprayed and cleaned, the dust collector returns to normal operation.

### 技术参数/Technical Parameter

型号 Model	处理风量(m <sup>3</sup> /h) Air volume	滤袋数量 Filter quantity	耗气量 (m <sup>3</sup> /min) Air consumption	脉冲阀数量 Number of solenoid valves	风机用电动机功率 Fan motor power (kw)	过滤面积 Filter area(m <sup>2</sup> )
HMC-32	1500-2880	32	0.1	4	1.5	24
HMC-48	2100-4320	48	0.14	6	3	36
HMC-64	2900-5760	64	0.2	8	3.7	48
HMC-80	4000-7200	80	0.24	10	5.5	60
HMC-96	5200-8640	96	0.29	12	7.5	72
HMC-112	6000-10080	112	0.34	14	11	84





## Z型斗提

Z Type Bucket Elevator

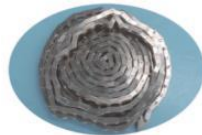

可选择项:  
多点下料  
给料机  
料位控制器  
速度控制

Option:  
Multi-discharge outlet  
Vibrating feeder  
Level controller  
Speed controller

### 优势特点

Advantages and characteristics

料斗材质符合GMP标准, 可以做成PP, ABS, SUS304, SUS316L材质, 可以在高温和低温中使用。斗式提升机可以完美的实现连续或间歇式输送以及可以配套其他设备。斗式提升机容易组装和拆卸, 料斗清洗方便。

The bucket is made of GMP grade PP, ABS, SUS304, SUS316L material, which can tolerate the high and low temperature. The bucket elevator can supply many solutions not only for single discharge but also for multi-discharge. This machine is easy to assemble, operate and clean.

### 应用领域

Application field

此设备广泛应用于食品, 化工, 农业, 医药等行业, 尤其适用于易碎料的输送, 例如, 薯片, 饼干, 花生, 杏仁, 开心果, 爆米花, 动物饲料等。

This machine is widely used in food, chemical agriculture and chemicals industry especially for fragile material such as potato chips, cookies, peanuts, american almonds, pistachio, candy, popcorn, animal feed etc

### 技术参数/Technical Parameter

料斗容积Bucket Volume	1.8L	3.8L	6.5L
料斗材质Bucket Material	PP或者不锈钢/PP or stainless steel		
下料口数量No.s of discharge port	1/single	一个或多个/Single or Multi-discharge port	
箱体材质Machine Body Material	碳钢或者不锈钢/Mild or stainless steel		
处理量Capacity	4-6M <sup>3</sup> /H	6.5-8M <sup>3</sup> /H	5.5-12M <sup>3</sup> /H
电压Voltage	220V/240V/380V/415V/440V		
功率Power	0.75-1.5KW	1.5-2.2KW	2.2-3.0KW



## TD斗式提升机

TD Bucket Elevator

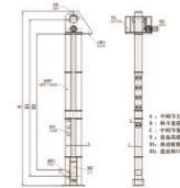

### 优势特点

Advantages and characteristics

斗式提升机具有输送量大, 提升高度高, 运行平稳可靠, 寿命长显著优点, 本提升机适于输送粉状, 粒状及小块状的无磨损性小的物料, 如: 煤、水泥、石块、砂、粘土、矿石等, 由于提升机的牵引机构是环形链条, 因此允许输送温度较高的材料(物料温度不超过250℃)。一般输送高度最高可达到40米, TG型最高可达到80米。

TD bucket elevator is kinds of fixed conveying equipment. Mainly for vertical conveying powder, particle and tiny lump continuously, with a wide application in the industry of animal feed, flour, rice, oil, starch and grain, port and wharf, for the elevating of bulk material.

Characteristics: huge capacity, stale, low room requirement, big elevating height and etc.

### 技术参数/Technical Parameter

斗提机型号 Model	TD400				TD500				TD630			
料斗型式 Hopper	Q	H	Zd	Sd	Q	H	Zd	Sd	Q	H	Zd	Sd
输送量(m <sup>3</sup> /h) Capacity	40	76	68	110	63	116	96	154	-	142	148	238
料斗容积(L) Hopper capacity	3.1	5.6	5.9	9.4	4.84	9.0	9.3	14.9	-	14	14.6	23.5
料斗运行速度(m/s) Elevating Speed	1.8				1.8				2.0			

表中料斗容积为料斗盛水时容积, 与实际填充量相近, 故输送量计算时为考虑填充系数φ, 具体选型时应根据物料度, 求得φ修正值, 以此值修正中所给输送量。

Note: The parameter is just for reference, we can provide the suitable model by the material to elevate.

## 真空上料机 Vacuum feeder



AR



### 主要用途

Mainly application

真空上料机是国内最为先进、理想的粉状物料、粒状物料、粉粒混合物的真空输送设备。能自动地将各种物料输送到包装机、注塑机、粉碎机、振动筛等设备的料斗中，也能直接把混合的物料输送到混合机（如V型混合机、二维混合机、三维混合机等）中，减轻了工人的劳动强度，解决了加料时粉尘外溢等问题。真空上料机由真空泵（无油、无水），不锈钢吸料嘴、输送软管、PE过滤器（或316不锈钢过滤器），压缩空气反吹装置、气动放料门装置、真空料斗和料位自动控制装置等组成，整套系统设置合理，外观精美，符合GMP标准，是食品行业和制药行业理想的上料设备。

Vacuum feeding machine is the most advanced and ideal vacuum conveying equipment for powder, granular, powdery material, powder mixture. It can automatically transfer all kinds of materials to the hoppers of packaging machine, injection molding machine, grinder and other equipment. It can also convey material which are ready to be mixed to the mixer (such as type V two dimensional mixer, mixer, mixing machine, three-dimensional mixer), reducing the labor intensity of workers and solving the problem of dust when feeding. Vacuum feeding machine has a vacuum pump (no oil, no water), stainless steel suction nozzle, hose, PE filter (or 316 stainless steel filter), compressed air, push device, pneumatic discharge device, wherein the vacuum hopper and the material automatic control device. The whole system is reasonable, beautiful appearance, meet the standard of GMP. It is the ideal feeding equipment for food and pharmaceutical industry.

### 技术参数/Technical Parameter

型号 Model	ZSK-1	ZSK-2	ZSK-3	ZSK-4	ZSK-5	ZSK-6	ZSK-7
功率 Power	1.5kw	2.2kw	3.0kw	5.5kw (单级)	5.5kw (两级)	7.5kw (单级)	7.5kw (两级)
输送量 Capacity	200kg/h	500kg/h	1000kg/h	2000kg/h	3000kg/h	4000kg/h	5000kg/h

注：输送量按物料比重1.3计算。

Remark: production rate is measured by material bulk density of 1.3t/m<sup>3</sup>

## 螺带混合机 Ribbon mixer



### 主要用途

Mainly application

螺带混合机由安装于搅拌轴上的内外径螺旋带动桶体内物料，使搅拌器在桶体内最大范围翻动物料。搅拌器结构上，螺旋设计成内外、左右互为反螺旋，搅拌器工作时内螺旋带动靠近轴心处物料做轴心旋转，轴向由内至两侧推动，外螺旋带动靠近桶壁物料做轴心旋转，轴向由两侧至内推动，于是造成物料在桶体内对流循环、剪切渗透，完成物料在较短时间内快速均匀混合。

该机是一种新型高效、高精度的混合设备，广泛适用于制药、食品、化工、及其它工业对各种粉粒体，尤其有粘性或有凝聚性的粉粒体以及糊状物料的高均匀度混合。

The ribbon mixer is driven by the inner and outer diameter spirals installed on the stirring shaft to drive the material in the barrel so that the stirrer can turn the animal material in the maximum range of the barrel.

The structure of the stirrer, the spiral design is inside and outside, and the left and right are anti-spiral. When the stirrer is working, the spiral drives the material near the axis to do the axis rotation, the axial direction is pushed from the inside to the sides, and the outer spiral drives the material near the barrel wall. The axis rotates, and the axial direction is pushed from both sides to the inside, thus causing the material to convectively circulate, shear and infiltrate in the barrel, and complete the rapid and uniform mixing of the materials in a short time.

### 技术参数/Technical Parameter

型号 Model	200	500	1000	1500	2000	3000
一次混合(kg) Batch capacity	80-100	200-250	400-500	600-700	800-1000	1200-1500
电机功率(kw) Power	3	5.5	7.5	11	15	18.5
主轴转速(r/min) Axis speed	65	60	42	32	32	32
设备重量(kg) Weight	450	800	1200	1500	1800	2000





## V 型混合机

V Shape Mixer



### 优势特点

Advantages and characteristics

V型混合机由两个不同或相同高度的V型壳体组成，通过机械传动，使壳体内的物料前后移动、交叉旋转、360度旋转，最终达到均匀混合。采用手动进料和闭式蝶阀排出，避免粉尘外溢。

内外壳镜面抛光，符合GMP标准。舱内没有死角，物料不会积聚，内部可以加强制搅拌棒，混合高效，时间短，运行平稳无噪音。混合均匀度可达99%，可与真空供料系统配合使用，形成无尘工作状态。本机可配备定时装置，可设定搅拌时间实现自动停机

V型搅拌机广泛应用于制药、营养、化工、食品等行业，用于干粉和颗粒的混合。

V shape mixer consists of two V-shells of different or same altitudes, and through mechanical transmission, the materials in these shells are made to move back and forth, crossed over and rotate 360 degree to achieving ultimate uniform mixing. It adopts manual feed and closed disc valve discharge, which can avoid dust spilling.

Mirror polished of inner and outer shell to meet GMP standard. No blind angle in the V-shells, no accumulation of materials, high speed I-bar, efficient and short mixing time, Running steady without noise. Mixing uniformity can reach 99%. It can work with vacuum feeding system to create dust-free working condition. This machine can be equipped with a timing device, it can set mixing time to realize.

Industrial V shape dry powder mixer are commonly used in pharmaceutical, chemical, food and related industries to mix dried powder and granules.

### 技术参数/Technical Parameter

型号 Model	DZV-500	DZV-1000	DZV-1500	DZV-2000	DZV-2500	DZV-3000	DZV-4000
容积 Total volume (m³)	0.5	1.0	1.5	2.0	2.5	3.0	4.0
输送量 Working volume (kg/batch)	100	250	400	600	800	1200	1500
混合时间 Mixing Time (min)	6-12	6-15	8-20	8-20	8-20	8-20	10-30
转速 Drum rotate speed (r/min)	12	12	12	12	12	12	10
功率 Motor Power (kw)	2.2	4	4	5.5	7.5	11	15
重量 Weight (kg)	550	900	1200	1400	1800	2100	2800

## 双锥混合机

Double cone mixer

1. 本公司生产的双锥粉末混合机与V型混合机功能相似，适用于制药、化工、食品、饲料等行业。
2. 本产品对粉体和颗粒的混合效果显著，流动性较好，各项指标均达到国外同类产品的标准，桶体采用不锈钢制造，内外抛光，外形美观，操作方便。

1. Our Double Cone Powder Mixer With similar functions to those of V type mixer, this machine is applicable for pharmaceutical, chemical, food stuff, feed etc.

2. It has remarkable effect in mixing powders and particles with relatively good fluidity. With the each Index reaching the standard of same kind of foreign product, its barrel is made of stainless steel, which is polished both inside and outside, featuring beautiful appearance and easy operation.



### 工作原理

Working principle

当混合机旋转时，原料在桶内混合产生不同的势能，从而使得物料交替搅拌，固定螺旋刀片旋转搅拌，解决了传统双锥混合器对流小的问题，获得了较好的均匀性。

when the mixer revolution, the raw material in barrel combination with different potential energy. The raw material spread mixing alternately, Fixed helical blades shearing and shunting on powders. Solve the low convection of traditional double cone mixer and get better uniformity.

### 技术参数/Technical Parameter

型号 Model	DZM-180	DZM-300	DZM-500	DZM-1000	DZM-1500	DZM-2000	DZM-2500	DZM-3000	DZM-4000
容积 Total volume (m³)	0.18	0.3	0.5	1.0	1.5	2.0	2.5	3.0	4.0
输送量 Working volume (kg/batch)	40	60	100	200	300	400	500	600	800
混合时间 Mixing Time (min)	4-8	6-10	6-10	6-10	6-10	6-10	6-10	6-10	6-10
机筒转速 Rotate speed (r/min)	12	12	12	12	10	10	10	8	6
电机功率 Motor power (kg)	1.1	1.5	2.2	4	5.5	7.5	11	15	18.5
重量 Weight (kg)	280	310	550	810	980	1500	2150	2500	3200
机器运行整个高度 Max. Rotary height (mm)	1850	1850	1950	2460	2540	3590	3650	3700	3730
机器尺寸 Overall dimensions (mm)	1400x700 x1600	1680x750 x1850	1910x800 x1940	2765x1500 x2370	2960x1500 x2480	3160x1900 x3500	3386x1900 x3560	4450x2200 x3600	4750x2500 x3680

## 三维混合机

Three-dimensional mixer

该机适用于制药, 化工, 食品, 轻工, 电子, 矿山, 冶金, 国防工业和各种研究机构的粉状和颗粒状物料的高均匀混合。

This machine is suitable for high homogeneity mixing of powdered and granular materials in pharmaceutical, chemical, food, light industry, electronics, mining and metallurgy, defense industry and various research institutes.



### 优势特点

Advantages and characteristics

该机具有运行稳定, 噪音低, 负荷系数大, 搅拌时间短等优点。该机由底座, 传动系统, 电气控制系统和多向运输单元组成。由于混合桶的多向运动, 料筒内物料的交叉混合点较大, 混合效果较高, 均匀度可达99.9%以上, 最大加载系数可达0.9 (0.4-0.6是普通混合器的加载系数)。混合时间短, 效率高。三维混合器混合桶设计独特。机筒内壁经过精细抛光处理, 无死角, 无污染物, 卸料方便, 清洗方便, 操作方便。

The machine has the advantages of stable operation, low noise, large loading factor and short mixing time. The machine consists of a base, a transmission system, an electrical control system and a multi-directional transport unit. Due to the multi-directional movement of the mixing barrel, the cross-mixing point of the material in the barrel is larger, the mixing effect is higher, the uniformity is over 99.9%, and the maximum loading coefficient is up to 0.9 (0.4-0.6 is the loading factor of the common mixer). The mixing time is short and the efficiency is high. The 3D mixer mixing barrel is special designed. The inner wall of the barrel is finely polished, no dead angle, no contaminants, convenient for unloading, convenient for cleaning and easy to operate.

### 技术参数/Technical Parameter

型号 Model	DZTD-1	DZTD-2	DZTD-3	DZTD-4	DZTD-5	DZTD-6	DZTD-7	DZTD-8	DZTD-9	DZTD-10
料筒容量(L) Barrel volume	10	20	50	100	200	400	600	800	1000	1500
最大装载容量(L) Max. Loading volume	8	16	40	80	160	320	480	640	800	1100
最大装载重量(kg) Max. Loading weight	5	10	25	50	100	200	300	400	500	750
转速 (r/min) Main axis rotate speed	0-15	0-15	0-12	0-12	0-12	0-10	0-10	0-10	0-8	0-8
功率 (KW) Power	0.37	0.37	1.1	1.5	2.2	4	5.5	7.5	7.5	11
重量 (kg) Weigh	10	150	200	300	400	500	600	800	1200	1500
尺寸(L*W*H)mm Machine size	600*1000*700	700*1000*1000	1000*1400*1200	1200*1700*1500	1400*1800*1600	1800*2100*1950	1900*2300*2600	2200*2400*2700	2250*2600*2800	2500*2800*3200

## 双螺旋锥形混合机

Double screw cone mixer



### 优势特点

Advantages and characteristics

非对称双螺旋锥形混合机是一种新型高效、高精度的混和设备。该机采用一套电机及摆线针减速机组成公转和自转, 利用长短搅拌螺杆回转运动和两螺杆自转运动相结合的原理, 使比重配比悬殊的物料达到理想的混合度, 混和时间短, 效果好。广泛用于制药、食品、化工、农药、饲料、石油、冶金矿山、建材工业, 涂料等行业的各种粉体的混合。

The asymmetric double screw cone mixer is a new type of high-efficiency and high-precision mixing equipment. The machine adopts one set motor and cycloid reducer to make revolution and rotation, and uses the principle of long and short agitator screw rotation and two-screw rotation movement to achieve the ideal mixing degree and mixing time for materials with a large proportion of specific gravity. It is widely used in pharmaceutical, food, chemical, pesticide, feed, petroleum, metallurgy and mining, building materials industry, paint and other industries powder mixing.

### 技术参数/Technical Parameter

型号 Model	产量 Capacity (kg/h)	混合容量 Total Volume (m³)	装载率 Loading coefficient	密度 loosen density	功率 Power (kw)	混合时间 Mixing time (min)	尺寸 Overall dimensions (mm)	重量 Weight (kg)
DZDS-200	95	0.2	0.6	0.8	2.2	6-10	φ890x1850	600
DZDS-500	200	0.5	0.6	0.8	2.2	6-10	φ1160x2250	800
DZDS-1000	450	1	0.6	0.8	4	8-10	φ1450x2700	1200
DZDS-2000	900	2	0.6	0.8	5.5	8-10	φ1850x3450	1600
DZDS-4000	1800	4	0.6	0.8	11	8-10	φ2260x4210	2500
DZDS-8000	3600	8	0.6	0.8	18.5	8-10	φ2250x5000	4200
DZDS-10000	4000	10	0.6	0.8	18.5	8-10	φ3050x5810	5000
DZDS-15000	6000	15	0.6	0.8	22	8-10	φ3576x6310	6200





## 万能粉碎机 Universal Crusher



### 主要用途 Mainly application

该机利用活动齿盘和固定齿盘的高速相对运动,使被粉碎物经齿冲击、摩擦及物料彼此间冲击等综合作用获得粉碎。本机结构简单、坚固、运转平稳、粉碎效果良好,被粉碎物可直接由主机磨腔中排出,粒度大小通过更换不同孔径的网筛获得,该机为全不锈钢材质。机壳内壁全部经机加工,表面平滑,内壁无粗糙、无积粉现象,使药品、食品、化工等生产更能符合国家标准,达到GMP要求。

It makes use of the high-speed relative movement of the movable fluted disc and the fixed fluted disc to crush the materials through the comprehensive effect of striking and friction of the fluted disc as well as the mutual striking of the materials. Besides, CWUP series crusher has simple structure, stable operation and good crushing effect, the crushed materials can be discharged directly from the grinding chamber of the host machine, and the desired granule size can be obtained by installing screens with different apertures. The whole machine material we adopt is stainless steel. The inner surface of the enclosure becomes smooth through processing, thus changing the powder residual phenomenon due to the coarse inner surface. As a result, the production of medicine, food and chemical products can better conform to the state standard and the GMP requirements.

### 技术参数/Technical Parameter

型号 Model	产量(kg/h) Capacity	转速(r/min) Rotate speed	进料粒度 Feeding size(mm)	粉碎粒度(mm) Final material size	功率(kw) Power	重量(kg) Weight	外形尺寸(mm) Dimensions
DZUP20	20-150	4500	≤6	12-120	4	280	590X650X1350
DZUP30	30-300	3800	≤10	12-120	5.5	350	650X800X1500
DZUP40	40-500	3400	≤12	12-120	7.5	480	800X950X1700
DZUP60	60-600	2400	≤15	12-120	22	650	950X1050X1900
DZUP80	80-1000	2200	≤15	12-120	37	1050	2500X1500X2100



## 超微粉碎机 Ultra-fine grinder



### 优势特点 Advantages and characteristics

本机由主机、辅机、电控箱三个部分组成,超微粉碎机有很多优点:比如通过气流筛选,没有筛网,最终物料粒度均匀。在粉碎作业时主机不发热,可粉碎各种热敏性物料。其综合性能已达到国际先进水平,该机广泛运用于食品、化工、制药、饲料、烟草、碳酸钙、植物纤维、染料、涂料、农药等低硬度物料的超细粉碎。

This machine is composed of three parts: Main machine, auxiliary machine, and electric control box. It has a variety of properties, such as air-selection type, no screen, uniform size, etc., and the production process is continuous. The machine does not heat up during the crushing operation and can crush various heat-sensitive materials. Its comprehensive performance has reached the international advanced level. The machine is widely used in food, chemical, pharmaceutical, feed, tobacco, calcium carbonate, plant fiber, dyes, paints, pesticides and other low hardness materials of ultra-fine grinding.

### 技术参数/Technical Parameter

型号 Model	产量 Production Capacity (kg/h)	原料大小 Feeding Size (mm)	出料大小 Output Size (mesh)	总功率 Total Power (kw)	主轴转速 Rotate Speed (r/min)	机器尺寸 Overall Size (mm)	重量 Weight (kg)
DZUF-15	20-80	<10	80-320	13.7	~5800	4500x1250x2700	1000
DZUF-20	50-100	<10	80-320	18.37	~4200	6000x1250x2900	1200
DZUF-30	100-200	<10	80-320	42.5	~3800	7100x1300x3650	1800
DZUF-60	200-500	<12	80-320	76.75	~3200	8000x2300x4500	2500
DZUF-80	300-800	<12	80-320	96	~2800	8500x2500x4600	3000
DZUF-100	400-1200	<12	80-320	138	~2000	10000x2800x5000	4000



**粗碎机**  
Coarse crusher



**工作原理**  
Working principle

该粗碎机为卧式粉碎结构，全不锈钢结构。物料通过料斗送入粉碎室，通过固定刀和旋转刀的切割和冲击破碎，在旋转离心力的作用下自动流出。本机按“GMP”标准设计，全不锈钢制造，结构简单，清洗方便，噪音低，是粗粉碎的理想设备。

This coarse crusher has horizontal crushing structure with whole stainless steel construction. The material is fed into the crushing chamber through a hopper, crushed by cutting and impact of both fixed and rotating knives, and flows of the exit automatically under the effect of rotating centrifugal force. Designed according to "GMP" standard and wholly made of stainless steel, this machine has simple structure, convenient cleaning and low noise, being the ideal equipment for coarse crushing.

**技术参数/Technical Parameter**

型号 Model	产量(kg/h) Capacity	进料粒度 Feeding size (mm)	粉碎粒度(mm) Final material size	转速(r/min) Rotate speed	功率(kw) Power	重量(kg) Weight
DZCC200	80-200	≤100	0.5-20	500	4	200
DZCC300	100-500	≤100	0.5-20	500	7.5	300
DZCC400	200-800	≤100	0.5-20	500	11	380
DZCC500	500-100	≤100	0.5-20	500	22	500



**高效粉碎机**  
High efficiency crusher



**优势特点**  
Advantages and characteristics

本机广泛适用于制药、食品、化工等行业的物料粉碎。  
本机结构简单，粉碎室拆装与清洗方便，具有操作稳定、移动方便、噪音低、粉碎效果好等优点。  
本机是一台高速运转的机器。物料被高速刀片剪切破碎成粉末，该机器还可根据不同物料选用各种形状及尺寸不同的刀片，粒度大小通过更换筛网或调整速度获得。

This machine is widely used for material crushing in pharmaceutical, food, chemical and other industries.

The machine is simple in structure, easy to disassemble and clean the crushing chamber, and has the advantages of stable operation, convenient movement, low noise, and good crushing effect.

This machine is a high-speed operation machine. The powdered material is crushed by high-speed blade shearing. The machine can also use different types of blades with different shapes and sizes according to different materials. The size can be obtained by changing the screen or adjusting the speed.

**技术参数/Technical Parameter**

型号 Model	产量 Capacity (kg/h)	成品细度 Final material size (mesh)	电机功率 Motor power (kw)	转速 Speed (r/min)	重量 Weight (kg)	机器尺寸 Overall Size (mm)
DZHP-1	10-100	10-120	4	1000-2400	150	1050x600x1600
DZHP-2	50-300	10-120	7.5	1000-2400	250	1760x760x1080
DZHP-3	100-500	10-120	11	1000-2400	320	1800x930x1100



## 部分客户现场展示 Applications



## 生产现场展示 Applications



## 生产现场展示 Applications

