



PACKAGING SOLUTIONS
FOR CHICKEN MEAT



WHO WE ARE

The company, based in northern Italy, commenced manufacturing packaging machines in

1973

almost **50 years of packaging experience!**

This small company expanded in a few years, to become a true leader in the field, **now the FIRST thermoforming producer in Italy!**

Since then, Coligroup has provided more innovative and reliable solutions year after year in the packaging industry.



Premises: 15,000m²

7 buildings

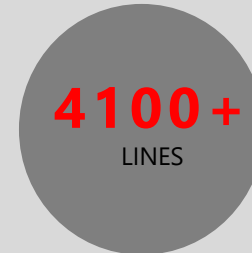



WHAT WE DO?

INTEGRATED PACKAGING SOLUTIONS
with automatic robotic loading system,
printers, labelers and control vision systems.

PACKAGING TECHNOLOGIES
Blister, MAP, Vacuum, SKIN and
Shrink

AFTER-SALES SUPPORT and production
management

EXPERTS CONSULTANCY
packaging trials and packaging material
tests.



TOP SEAL



MAP

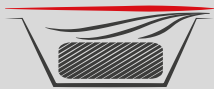

**GAS
FLUSH**



SKIN

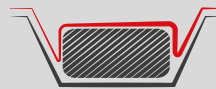

**SKIN
PROTRUDIN
G**



**FLAT SKIN
PROTRUDIN
G**

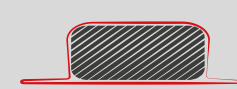

**FLAT SKIN
SUPER PROTRUDING**



SOME OF OUR REFERENCES



Smithfield.
Good food. Responsibly.®

HJF



**direct
meats**

THERA 100



THERMOFORMING MACHINES

THERA 250



THERA 450



THERA 500



THERA 650



MACHINERY RANGE

TRAYSEALING MACHINES





LABELING UNITS

PRINTING SOLUTIONS

CARTONING MACHINE

DOSING SYSTEM

REJECTION SYSTEM

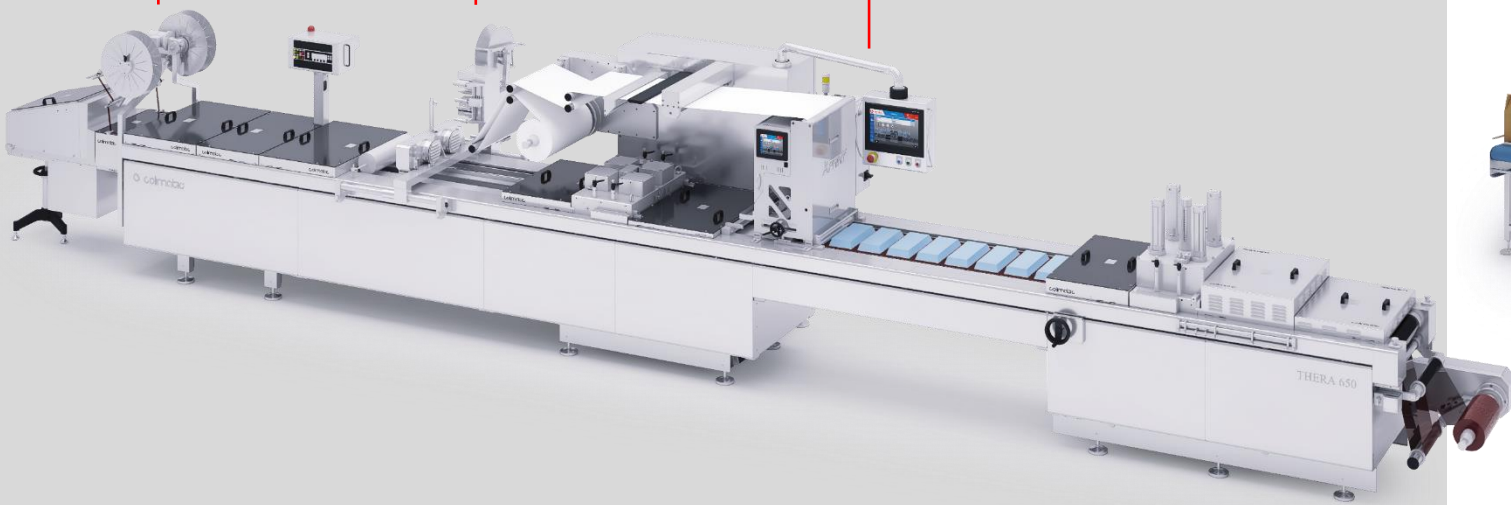

AUTOMATIC PICK & PLACE SYSTEM

AUTOMATIC SLICER

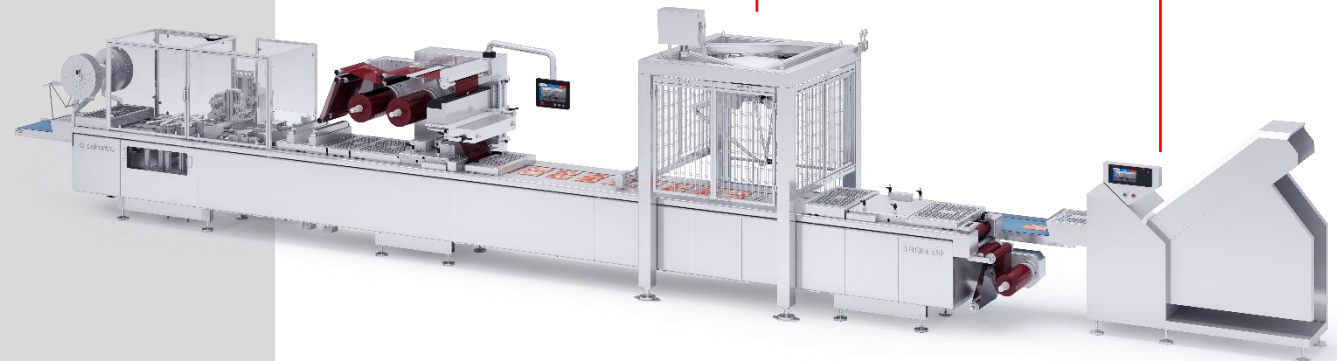

**INTEGRATED
PACKAGING SOLUTIONS**

PACKAGING TECHNOLOGIES



MAP VACUUM + GAS



[▶ Video Meat - MAP](#)

SHRINK



[▶ Video Meat - Shrink](#)

SKIN



[▶ Video Meat - Skin](#)

VACUUM



[▶ Video Meat - Vacuum](#)

SUSTAINABLE PACKAGING

WEBSKIN



WEBMAP



COOK-IN



Examples of DIFFERENT PACKAGES

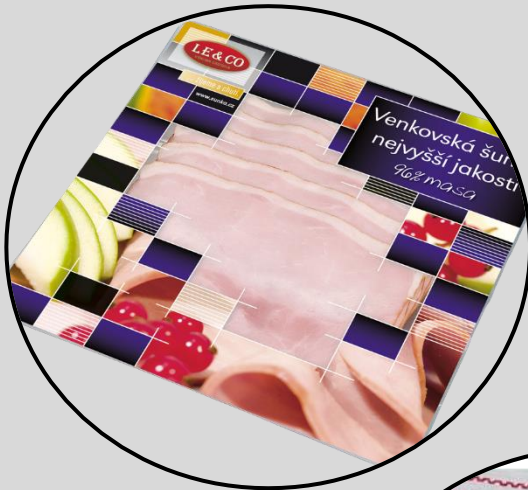

TOP SEAL

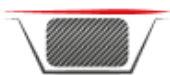

VACUUM

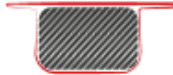

MAP



SKIN TECHNOLOGY



SKIN PROTRUDING



SHRINK



EASY PEEL



GAS FLUSH



DATA MANAGEMENT



Flat Board Skin SUPERPROTRUSION



Examples of DIFFERENT PACKAGES



SKIN TECHNOLOGY – Special Application



This packaging technology produces a vacuum pack that protects the product and **fits around it like a second Skin.**

The thermoforming line creates a rigid bottom support to be sealed with top film to produce vacuum pack.

- Attractive pack
- Maximum shelf-life
- Easy peel
- Vertical or space-reducing display

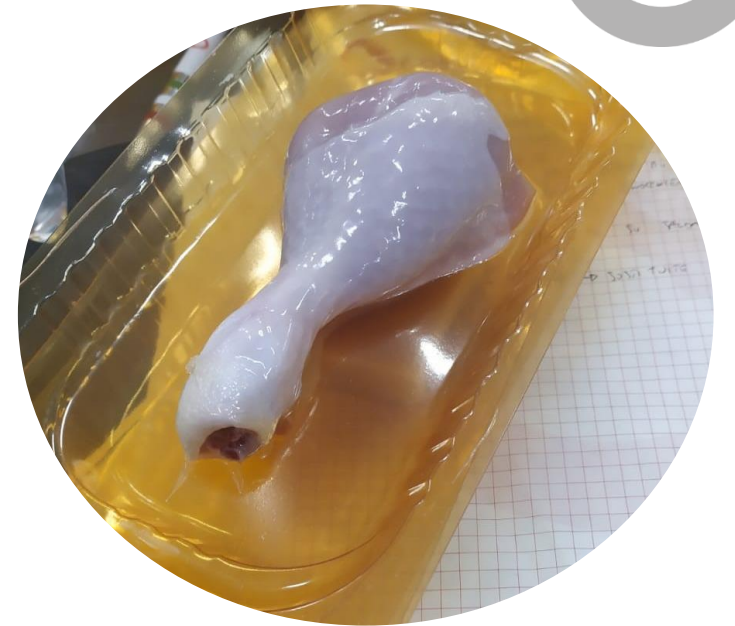

- No liquid leakage
- Specially for fresh meat, processed meat, fish, poultry, ready meals and cheese



SKIN PACKAGES ON PAPER BASED



COLIGROUP special application to realize MAP or SKIN packs with a **HI-BARRIER** protection in an eco-friendly **RECYCLABLE** paper package. Combining THERMOFORMABLE paper and SKIN film, **this is a new packaging concept on the market.**

ATTRACTIVE

RECYCLABLE

THERMOFORMABLE



SKIN PACKAGES – WEB SKIN



80% RECYCLING



- **Environmentally** Friendly
- **Attractive** packaging
- **Top** shelf -life
- Easy to open (**easy peel**)
- Carboard **from reels** (to pre-cut trays)
- Hygiene, **sustainability & innovation!**

FLAT CARDBOARD COMPOSITION

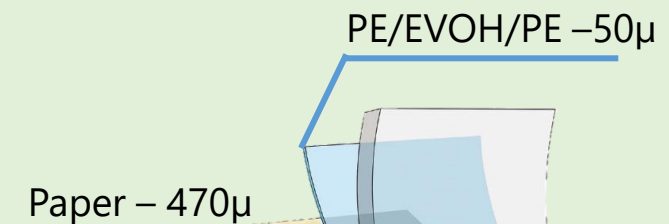

400gr/mq2 Paper +
49gr/mq2 PE/EVOH/PE
= 449gr/mq2

Total thickness 520µ

SKIN PACKAGES – WEB SKIN



Special cutting station: developed for the biomedical sector. This allows a perfect cut of the package **reducing to zero** the possibility of release of **contamination** with cardboard fibers.

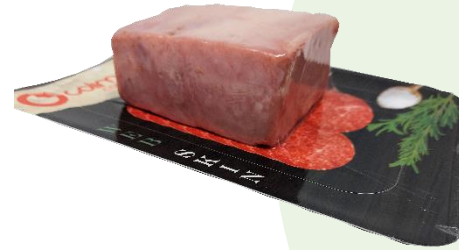

Special **Skin system**
Up to **50mm**
protrusion
on cardboard



Cardboard base with a special **registration system**. Realized through a revolutionary algorithm: forming, sealing, cutting & printing operations are **perfectly synchronized!**

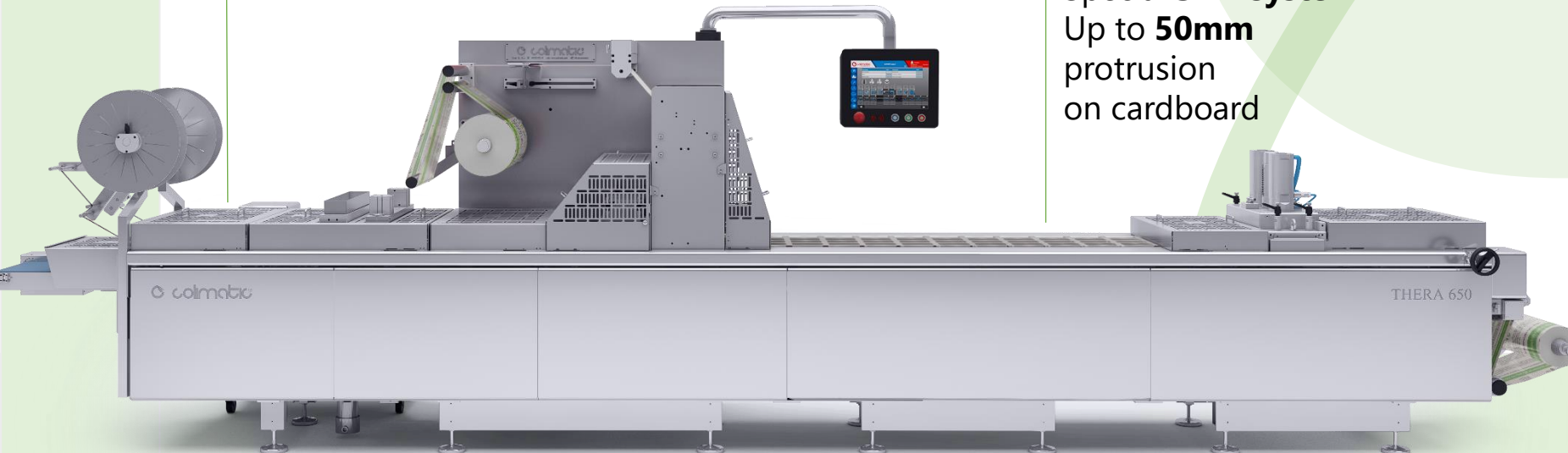

SHRINK TECHNOLOGY

– Special application

Thermoforming line mod. **THERA SHRINK**

Shrinking film from 100 my – **LESS PLASTIC!**

With the shrink packaging process, products are packed under vacuum with special **shrinking material** and afterwards put on heat. Through the heating mechanism of hot air or hot water, the material shrinks back and **fit around the product shape**.

- **Maximum shelf-life**
- **Attractive pack**
- **Use of minimum thickness material (cost saving and eco-friendly)**



Perfect results thanks to the upper film tensioning solution in the sealing chamber

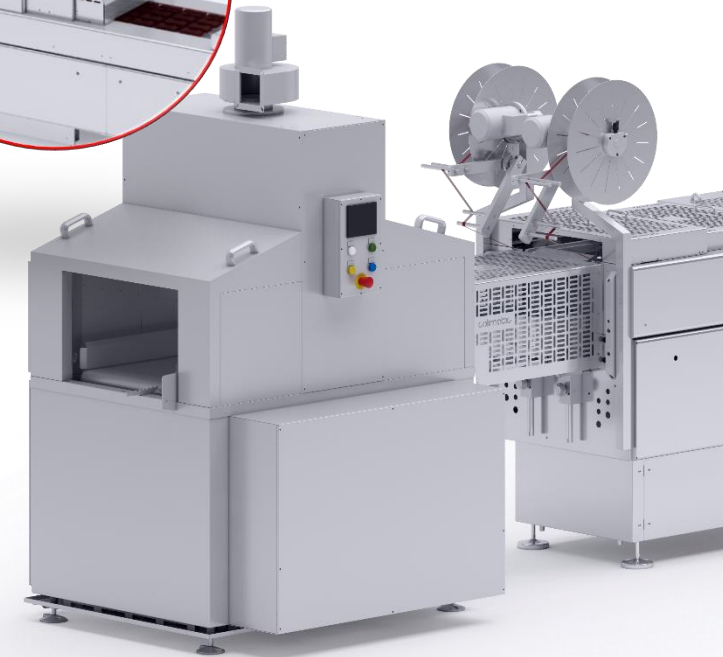
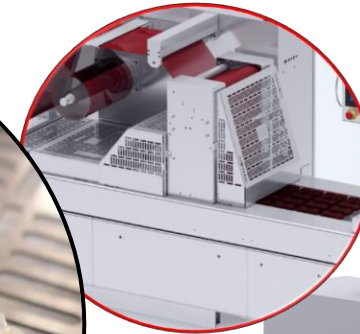

PACKAGES IN PREFORMED TRAYS



TDF 500
Semi-
automatic



TDF 1000E

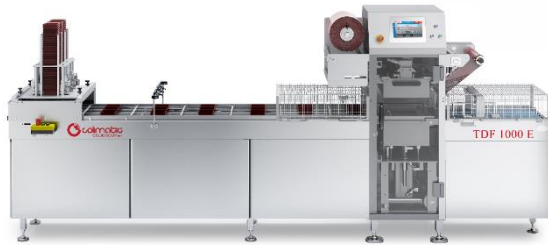

TDF 1650 – 1900
High speed solution

Tray-sealers packaging lines **SERIES TDF**



- **MAP Packaging**
- **SKIN Packaging**

LISA[®] Line Integrated System Assistant



Innovative DPM software for the management of lines integrated in the production flow. Its functions allow to maintain the efficiency of the lines at the maximum level.

DPM Data Process Management

Machine operating status
continuous monitoring

WSM Warehouse Spare parts
Management)

Spare parts warehouse
management

PRD Predictive Diagnosis

Timely **preventive**
maintenance

TLS Teleservice

Remote assistance

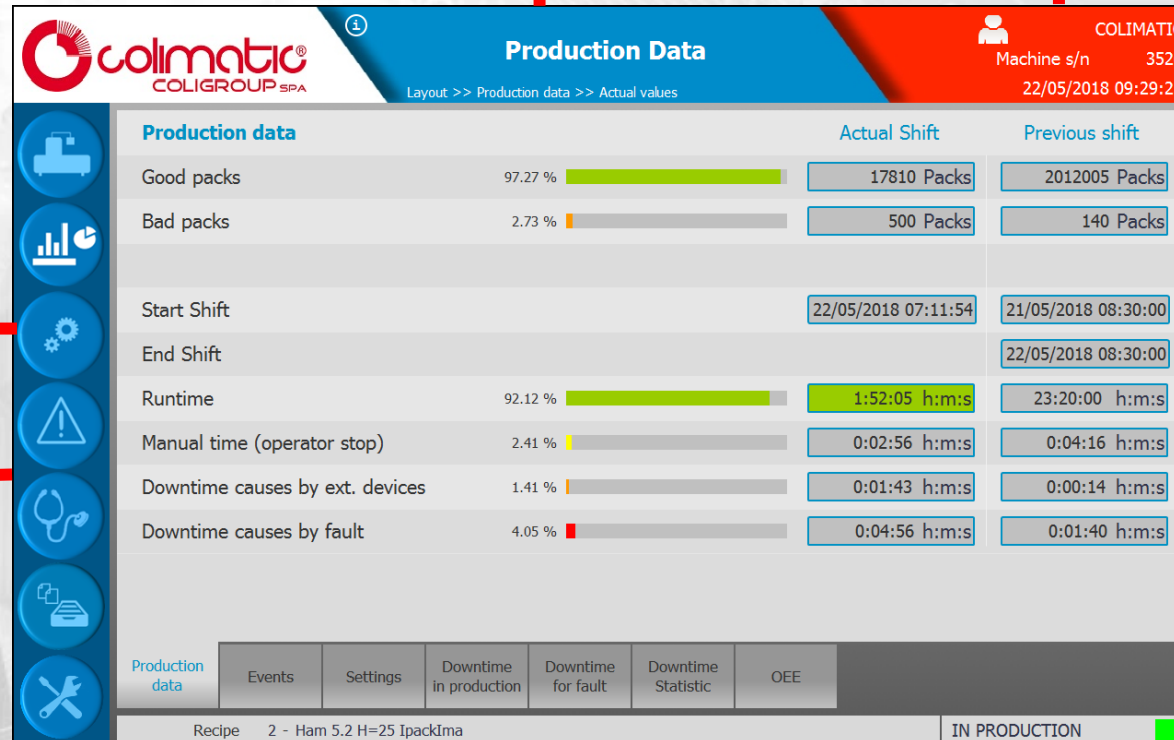

ASC Automatic Set up Control

Work Order acquisition and
related process parameters setup

INC Integrated Connectivity

Video tutorial, Software
updates

HIGH SPEED
PRODUCTIVITY
& FLEXIBILITY



COST SAVING ON
CONSUMABLES



CUSTOMER ORIENTED



CONSULTANCY



OUR ADDED VALUES



RELIABILITY



HYGIENE



USER FRIENDLY



CUSTOMIZATION



CUSTOMIZATION & CONSULTANCY



PROTOTYPES MOULDS

Feasibility studies based on customers' products and technical expectations: Pilot moulds & packaging materials testing

MOULDS CUSTOMIZATION

Custom design moulds configuration

COMPREHENSIVE PACKAGING OPTIONS

Vacuum; MAP; Shrink, SKIN, Top forming & Reclosable packaging

YOUR LOGO EMBOSSED

With **customized** characters (data or logo) **embossed** on the bottom of the packs



FLEXIBILITY ON PACKAGING MATERIALS

Wide range of films with different properties and variable thickness **from 30 up to 1000 micron** depending on the application customers need.

Different **options** such as double preheating stations, plug assist and integral cutting stations should be provided in case of very thick material.

A variety of factors, e.g. type of product, forming depth, after-packing process, moisture vapor barrier, oxygen barrier, must be considered in the choice of the proper packaging material.





SPEED & HIGH CAPACITY

PRODUCTIVITY

Production capacity up to **22 cycles/minute**
(Depending on product and equipment)

DIE SET CHANGEOVER

Forming and sealing hinged chambers for the **fastest**
die configuration change-over (**15 minutes!**)

PNEUMATIC REEL HOLDER

Reel holders with **pneumatic** expansion lock system.
This high-value device allows a fast and easy reel change,
thus reducing costly downtimes



COST SAVINGS

Special systems for vacuum and gas injections.

Only 10mm lateral scraps and only on bottom film, with a consequent **COST SAVINGS** on packaging material

No Scraps on top film!

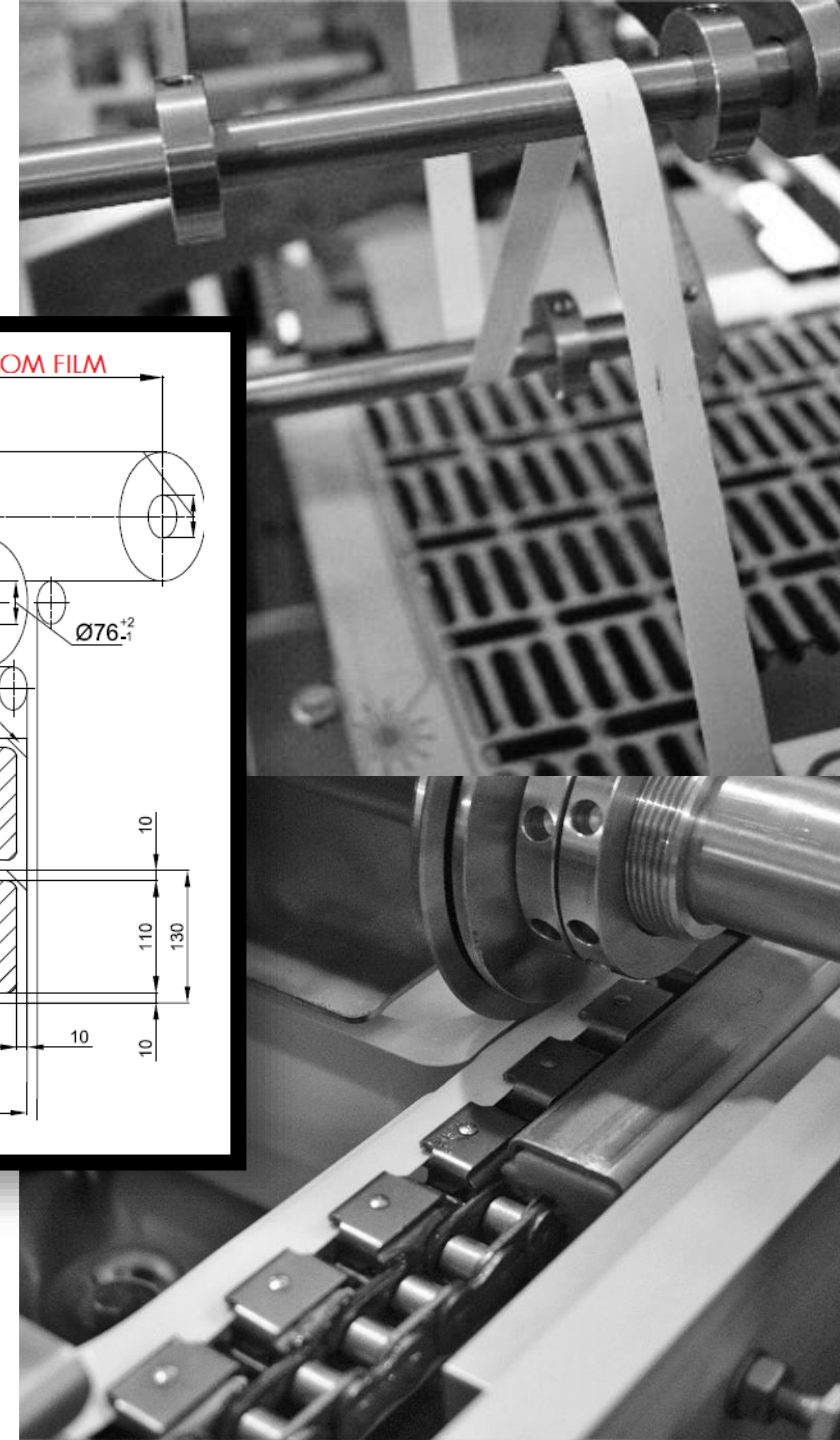
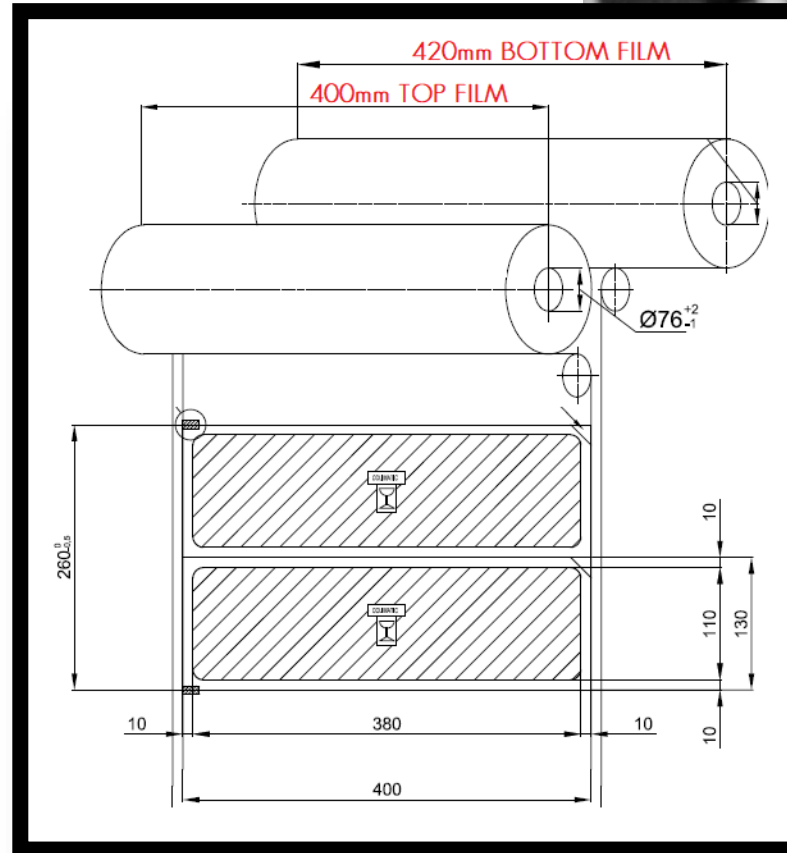



RELIABILITY



Allen-Bradley

by ROCKWELL AUTOMATION



COMPONENTS TESTING BEFORE DELIVERY

Each single component of our machines undergoes **long pre-delivery testing**

FIRST CLASS COMPONENTS

Top quality components from the most important suppliers on the market.

This is to guarantee the **highest quality** on our machines, and to let our customers free to find necessary spare parts **independently** on the market.



HYGIENE

SLANTED SURFACES

Sloped surfaces to complete washdown and draining of liquids and contaminants

VALVES

Special cabinet closed and separated in hermetic box

IP69K PANEL

HMI special hermetic closable protection

MOTORS & ENGINES PROTECTIONS

Safety covers to **protect** external motors

DURALITI & ANODIZATION

Available for special application **deep anodization** and Duraliti treatment

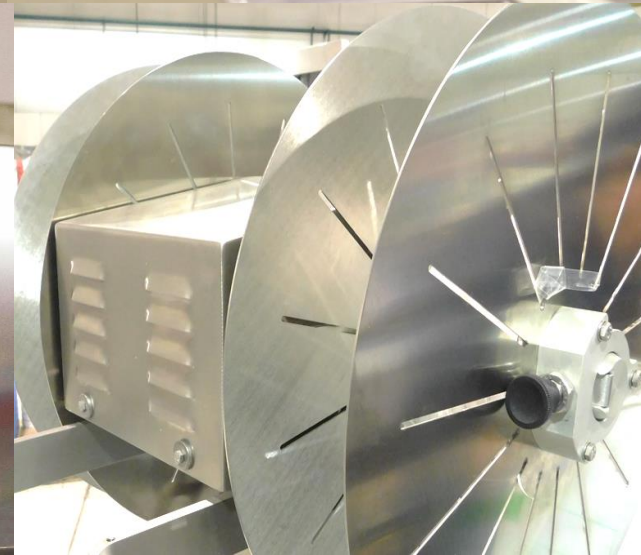
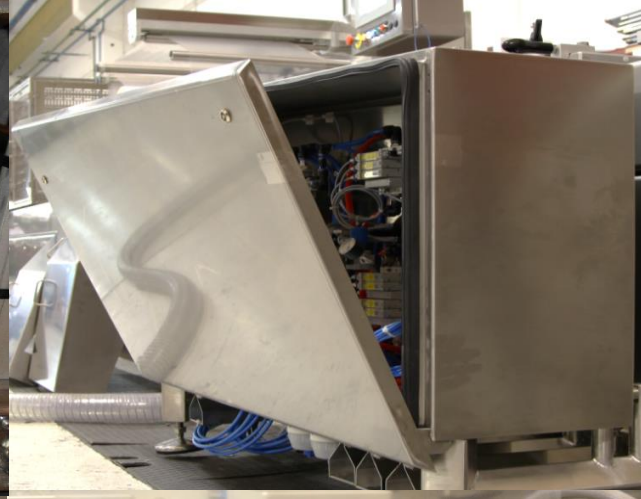
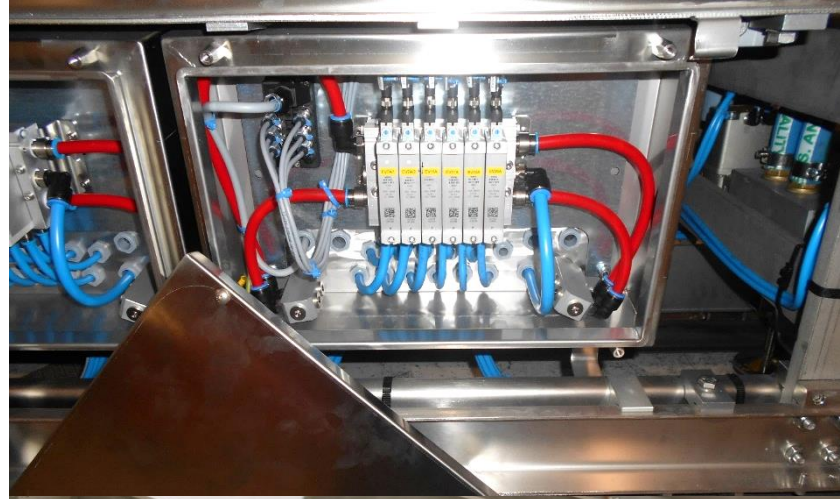



AFTER-SALES SERVICES

FAST REACTION TIMES

Local support 24/24 – 7/7

REMOTE TELE-ASSISTANCE

Our team of experts are able to access the machine control via remote service.

PREVENTIVE MAINTENANCE & SPARE PARTS

It is used to help prevent faults in advance, and to reduce unplanned downtime. Comprehensive warehouse with wide range of spare parts allow us to be prompt in case of emergency.

PERSONNEL TRAINING

Training courses on mechanics, pneumatics and electrics. We offer user training courses worldwide for our customers' operators and service personnel.

DEDICATED SHOWROOM & FAT AREA

In order to give all our customers, the opportunity to **TEST** our machinery with **THEIR OWN PRODUCTS**, while appreciating our unique technical solutions!





SMALL
ENOUGH TO LISTEN
BIG ENOUGH
TO SERVE!

THANK YOU FOR
YOUR ATTENTION



Please contact us for more details and information
backoffice@colimatic.com
www.colimatic.com

COLIGROUP SPA
Via del Lavoro Artigiano, 9
25032 Chiari (BS) - ITALY
Phone: +39 0307000761