

**Wernick**  
HIRE

**GreenSpace**

Wernick 0800 51 51 51  
HIRE [www.wernick.co.uk](http://www.wernick.co.uk)

GreenSpace ECO accommodation

Britain's leading provider of modular and portable buildings

## Why Wernick?

- ✓ 28 Hire depots nationwide
- ✓ Service excellence
- ✓ Full turnkey solutions
- ✓ Expert advice
- ✓ Registered supplier with the Considerate Constructors Scheme
- ✓ Comprehensive product range
- ✓ Industry leading product and service quality

**20  
40** NET  
ZERO

## Our Commitment

**“** *The challenges being presented by climate change should not be underestimated and it is essential we act now to reduce global emissions. Our Carbon Management Plan clearly sets out the steps we are going to take to reduce our emissions to achieve net zero by 2040. This is the beginning of a challenging but exciting journey and marks the next chapter in the Wernick Group's 90 year history.* **”**

Jonathan Wernick,  
Group Chief Executive Officer

# What is GreenSpace?

The GreenSpace range available from Wernick Hire offers high quality temporary accommodation with additional eco benefits.



**REDUCED  
CARBON  
FOOTPRINT**



**COST  
SAVINGS**



**IMPROVED  
SOUND  
INSULATION**



**IMPROVED  
WORKING  
CONDITIONS**

By combining a number of energy saving features (detailed overleaf), the units can help to reduce your collective carbon footprint and your energy bills. In addition to lowering your project's environmental impact, GreenSpace's features also ensure simple maintenance and user comfort.

Each product in the range has been Energy Performance Asset Rated, indicating the energy efficiency of the building fabric, heating, cooling, lighting and ventilation systems.

Wernick Hire supply the range of GreenSpace products to numerous sectors, including construction, education, healthcare and commercial. The range is available in a choice of sizes and configurations - applications include: site canteens, meeting rooms, offices, changing rooms, toilets and storage.

# Key features of the GreenSpace range



**Windows**  
Double glazed windows that improve U-Values



**Heating**  
Thermostat / timer controlled heating system



**Effective door insulation**  
Heavy duty door closers to retain heat

**Sustainable materials**  
Timber sourced from sustainable sources



**LED lighting**  
Passive infra-red (PIR) sensors to operate lighting

**Secure protection**  
Window shutters and insulated external doors



**Water supply**  
Dual flush cisterns and non-concussive push taps to reduce water consumption

**Insulation**  
Increased levels of insulation that improve U-Values

Can typically achieve an EPC\* rating of



# GreenSpace 9.6m Eco range

**GreenSpace 9.6m Eco units can be fitted out to meet just about every possible requirement, including office space, meeting rooms, canteens and changing facilities.**

Besides being packed with energy saving features, these versatile units are robust and secure enough to withstand the rigours of busy working environments and construction sites.



## Key features:

- Dimensions: 9.6m x 3.0m
- PIR operated LED lighting (3 x PIR)
- 2 x panel heaters with thermostats and timers
- 4 x UPVC windows
- 2 x 1200 x 1500 notice boards to office / canteen units
- Painted single colour externally
- Heavy duty door closers to external doors
- 4 x twin sockets
- Linking brackets / staircase brackets externally
- Canteen units c/w sink, worktop and 5 ltr over-sink water heater
- Drying rooms
- Wash basins to have non-concussive taps, canteen sinks standard taps
- Standard urinals to WCs
- Hat and coat hook rail
- Low level lifting points

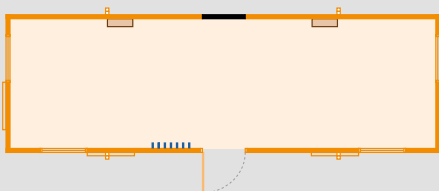

**Open plan office**  
EPC Certification A

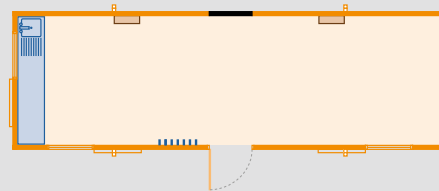

**Open plan canteen**  
EPC Certification: A

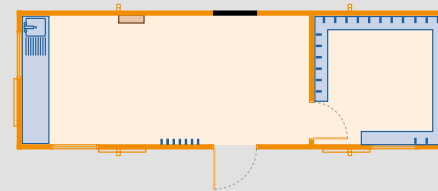

**Canteen / drying room 70/30**  
EPC Certification A

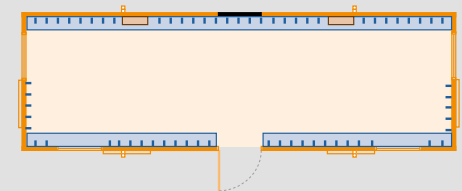

**Open plan drying room**  
EPC Certification A

# GreenSpace 9.6m Eco range

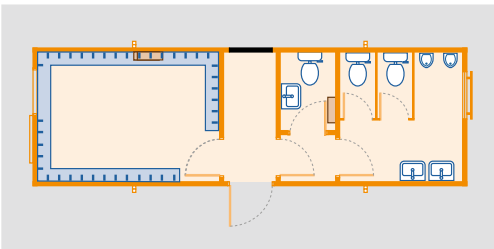

**Drying room / 2 + 1 toilets**  
EPC Certification A

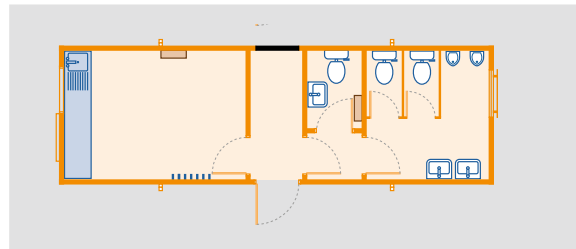

**Canteen / 2 + 1 toilets**  
EPC Certification A

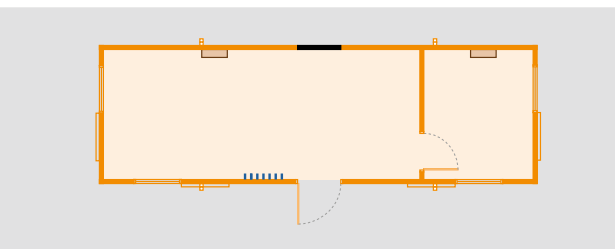

**Office / meeting room 70/30**  
EPC Certification A

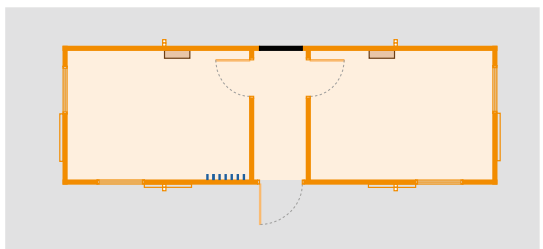

**Office / corridor / office**  
EPC Certification: A

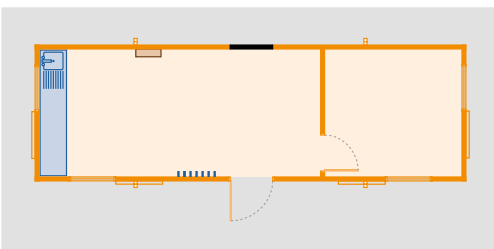

**Canteen / office 60/40**  
EPC Certification A

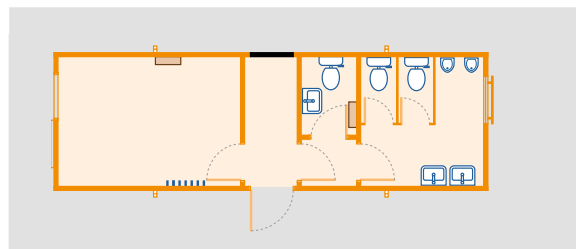

**Office reception / 2 + 1 toilets**  
EPC Certification B

# GreenSpace toilets & showers

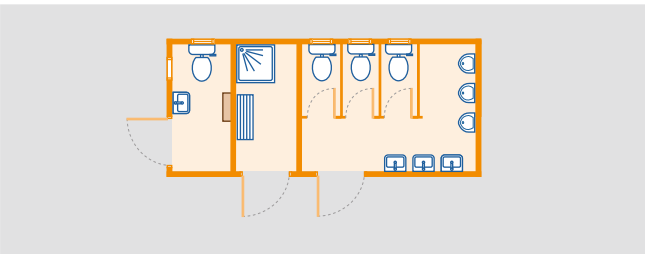

**4.8m x 2.75m 3+1 toilets + shower**  
EPC Certification A

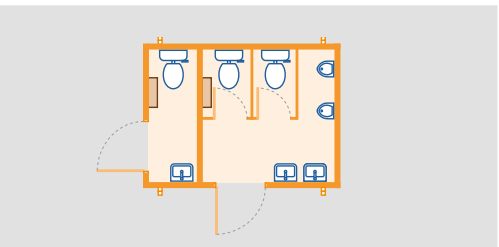

**3.6m x 2.75m 2 + 1 toilets**  
EPC Certification A

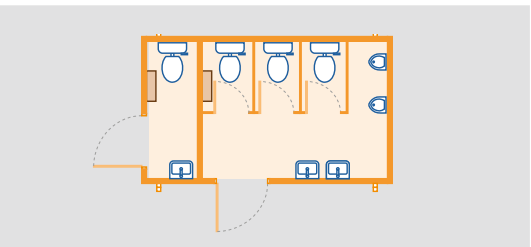

**4.8m x 2.75m 3+1 toilets**  
EPC Certification A

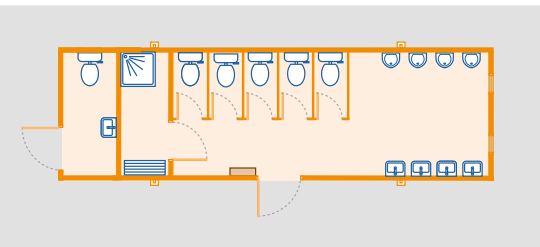

**9.6m x 3m 5+1 toilets + showers**  
EPC Certification A

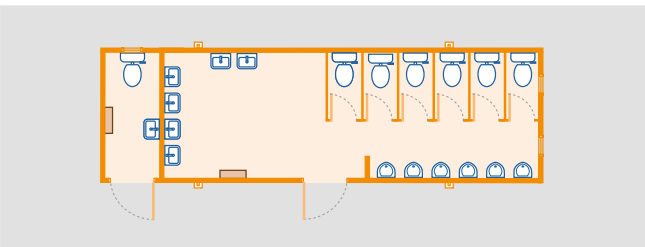

**9.6m Wx 3m 6+1 toilets**  
EPC Certification A

# GreenSpace 9.6m Lite range



Like our GreenSpace 9.6m units, the GreenSpace Lite is robust, spacious and eco-friendly. A few key differences make these units a more cost-effective solution for reducing energy on site.

Units can be configured for almost any need. Offices, meeting rooms, toilets, showers, canteens, kitchens and more can all be combined in the best way you see fit.

- Dimensions: 9.6m x 3.0m
- Stackable & linkable
- Made of robust steel
- Available in 9.6m (32') length
- Smaller toilets are also available

Feature	GreenSpace Lite	GreenSpace ECO
High levels of insulation in walls, floor and ceiling	No	Yes
Double glazed windows	Yes	Yes
PIR controlled LED lighting	Yes	Yes
Timed / thermostat controlled heating	Yes	Yes
Door closers to external doors	Yes	Yes
Non-concussive taps	Yes	Yes
Dual flush cisterns	Yes	Yes





# GreenSpace 9.6m Lite fire rated

Our Greenspace Lite units are also available as a fire rated product. These units are designed to be compliant with the Joint Code of Practice on the Protection from Fire of Construction Sites and Buildings Undergoing Renovation; offering a fire rating of 30 minutes to the external walls and roof for both insulation and integrity.

Independently tested  
by the Warrington Fire  
Research Centre.

Fire Certification exceeds  
BS476 requirements

Certified  
Fire Rating of



## Key features:

- Dimensions: 9.6m x 3.0m
- Compliant with Joint Code of Practice
- Manufactured in-house to ISO9001 and ISO14001 standards
- 3 storey capability
- Quick installation
- Totally flexible layout
- Air conditioning throughout
- Roof and wall cavities insulated with non-combustible glass-wool fibre
- Fully galvanised external wall panels
- Vinyl wall covering laminated to 12.5mm plasterboard lining, offering Class 0 spread of flame
- Extra duty seam welded anti-static flooring, manufactured to Class 1 spread of flame
- Treated ceilings offering Class 0 spread of flame
- Zinc rich fibre applied to all external mid steel surfaced and weld areas
- Coating of semi-gloss fast enamel spray applied to roof for extra protection



# AVflex GreenSpace flexible & secure



Can typically achieve  
an EPC\* rating of



**AVflex GreenSpace provides an energy saving building which is not only flexible in its design, but also packed with robust anti-vandal features.**

High security protection is provided by heavy-duty security shutters and doors fitted with insurance approved deadlocks.

AVflex eliminates the need for traditional linking corridors between adjoining units which reduces the overall on-site footprint.

The internal layout of AVflex can be tailored to suit individual site needs. The buildings can be open plan or partitioned to create individual offices, staff areas or meeting rooms.

The internal fixtures and fittings include double sockets, three compartment IT trunking, LED lighting and panel heaters as standard.

Welfare and ablution facilities including toilets, showers and drying facilities can also be provided.

The units can be finished in client bespoke livery schemes and supplied with a number of additional options including furniture, comfort cooling and showers.

## Key features:

- Corrugated steel anti-vandal exterior shell
- 4 storey capability
- Standard bay lengths 9.6m or 7.2m
- Vinyl faced plasterboard white internal walls
- Dado trunking as standard in offices and meeting rooms

\*Comparison is based on a single unit layout, calculated in a consistent specific location and orientation, in accordance with the NCM at the time of calculation. EPC ratings away from that specific location and orientation are different and reliant on a range of variable factors.



# AVflex GreenSpace saving energy

With the increasing demand for all types of accommodation to be more environmentally friendly, Wernick Hire's GreenSpace Eco units aim to reduce the collective carbon footprint and energy bills of our clients' businesses by combining a number of energy saving features.

## Our Eco units typically include the following:

- Double glazed windows that improve U-Values
- High levels of insulation in floors, walls and ceilings that improve U-Values
- Passive infra-red (PIR) sensors to operate LED lighting
- Thermostat / timer controlled heating system
- Dual flush cisterns
- Heavy duty door closers to retain heat
- Non-concussive push taps to reduce water consumption
- Timber sourced from sustainable sources
- Insulated window shutters and external doors
- Low wattage LED lighting

Can typically achieve an EPC\* rating of

A



# PMflex GreenSpace Premier modular buildings

**PMflex GreenSpace is a high quality modular system equipped with innovative features which improve efficiency of installation.**



PMflex buildings can be designed to cater for almost any purpose with a variety of internal configurations available including open plan offices, meeting rooms, toilets, showers, drying rooms, kitchens and storage areas.

Our experienced in-house design team will guide you in selecting a building to perfectly match your requirements.

This product can be supplied to comply with current building regulations and typically can achieve an EPC rating of 'A' as standard depending on layout.

Access can be provided by internal stair-pods or external staircases depending on client preference.



## Key features:

- Manufactured in-house
- 5 storey capability
- Quick installation
- Totally flexible layout
- 2.4m internal ceiling height
- Dado trunking fitted as standard
- Double glazed uPVC windows
- High insulation levels
- LED lighting
- Non concussive taps and dual flush cisterns
- Building modules come in standard lengths of 9.6m and 12.0m

**Can typically achieve  
an EPC\* rating of**



# FMflex GreenSpace

## Fire rated modular buildings

**FMflex is a fire rated high quality modular system. Based on Wernick Hire's premium modular product, PMflex, FMflex is also full of energy saving features, and is designed to make delivering and installing your buildings as efficient as possible.**

FMflex is designed to be compliant with the Joint Code of Practice on the Protection from Fire of Construction Sites and Buildings Undergoing Renovation, offering a fire rating of 30 minutes to the external walls and roof for both insulation and integrity.

Can typically achieve  
an EPC\* rating of



### The FMflex offers these key benefits in addition to the features of the PMflex:

- Achieves a 30 minute fire rating
- Compliant with Joint Code of Practice
- Manufactured in-house to ISO9001 and ISO14001 standards
- Internal fire rated window shutters
- High levels of insulation in floor, walls and ceiling
- 3 storey capability
- Building modules are available in size 9.6m x 2.9m



Call us today on 0800 970 0231 | 13



## GreenSpace self-contained welfare units

Mobile and static welfare units are available in the GreenSpace range. They fully comply with health and safety site welfare directives and are completely independent from mains services.

Compact, yet extremely well equipped, our range of welfare units provide security, convenience and comfort for site operatives.

### Key features:

- Theft and vandal resistant
- Generator auto-timed control
- Air blown heating system
- Super silenced diesel generator
- Microwave and kettle
- Wrist to elbow sink
- Fresh and waste water containers
- 12 Volt LED light c/w PIR sensor
- Plug and USB sockets
- Carbon monoxide detector and smoke alarm
- Up to 60% reduced fuel costs
- Up to 80% reduced fuel costs with Fusion Pulse

# Mobile & static units

1. Canteen space with kitchen facilities
2. Toilet with forearm wash basin with full-flush Eco 12v toilet system
3. Generator area
4. Drying area
5. Office

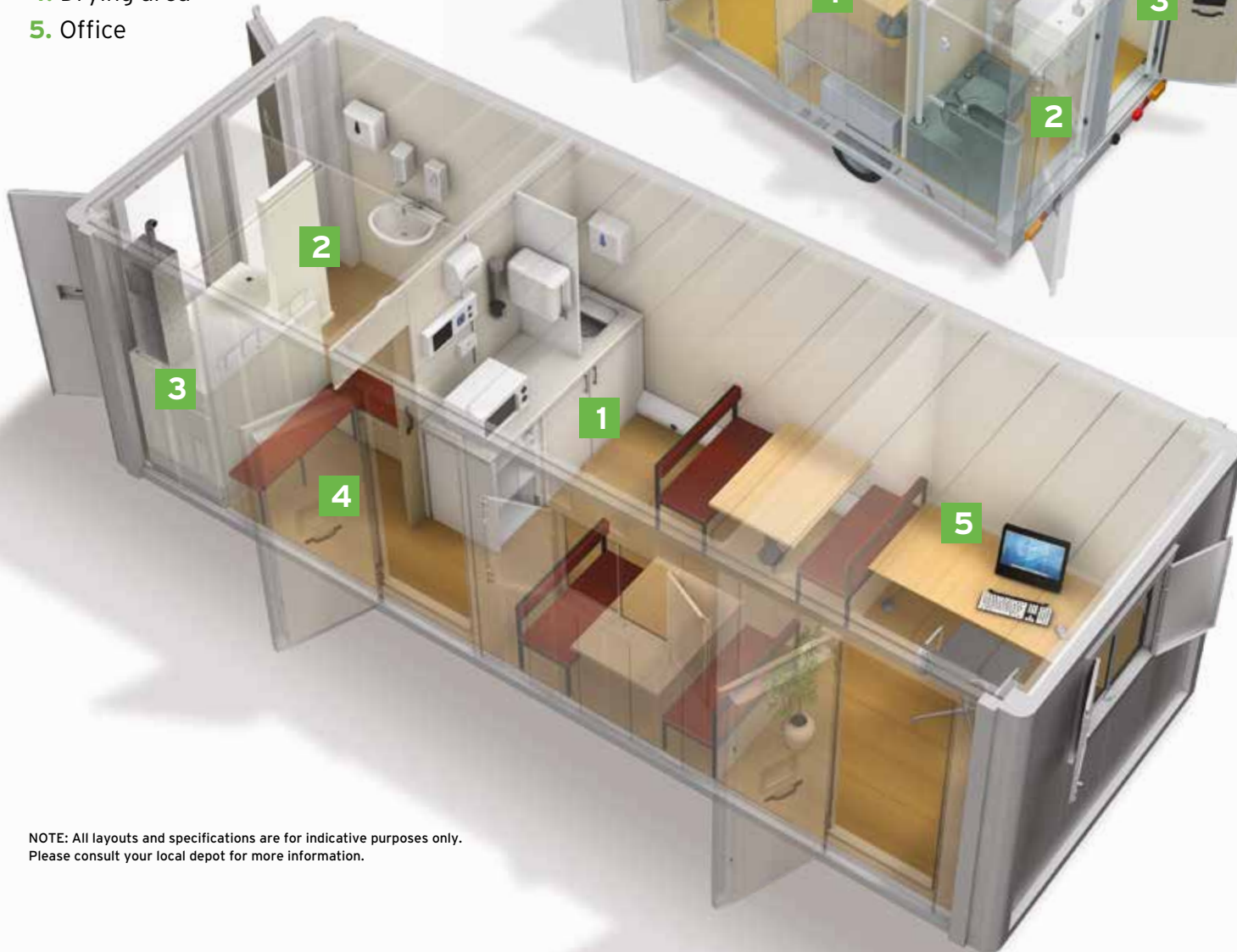

## Mobile welfare units:

3.6m (12') GreenSpace mobile unit  
6 person  
Chemical toilet  
Available as Eco Fusion or  
Eco Fusion Pulse

5.0m (16') GreenSpace mobile unit  
8 person  
Canteen  
Separate office  
Chemical toilet  
Available as Eco Fusion Pulse

## Static welfare units:

7.6m (25') GreenSpace static unit  
8 person  
Canteen  
Separate office  
Separate drying room  
Chemical toilet  
Available as Eco Fusion or  
Eco Fusion Pulse

7.6m (25') GreenSpace + static unit  
8 person  
Canteen  
Separate office  
Separate drying room  
Full flush toilet  
Available as Eco Fusion or  
Eco Fusion Pulse

8.4m (28') GreenSpace static unit  
8 person  
Canteen  
Separate office  
Separate drying room  
Full flush toilet  
Available as Eco Fusion

NOTE: All layouts and specifications are for indicative purposes only.  
Please consult your local depot for more information.



# Fusion Pulse technology

In addition to our standard GreenSpace welfare units, we also offer a range of Fusion Pulse products (see previous page for product range).

These units utilise the latest in energy storage technology to reduce carbon emissions, noise pollution and wasted power; all while saving you money. The units are powered by an onboard 12V battery enabling the LED lights, heating, hot water and inverter sockets to be run without the need of the onboard generator.

The generator is only required to charge the onboard battery and run the hot water, kettle and microwave. The generator is fitted with an auto stop timer to save over running and unnecessary wastage.

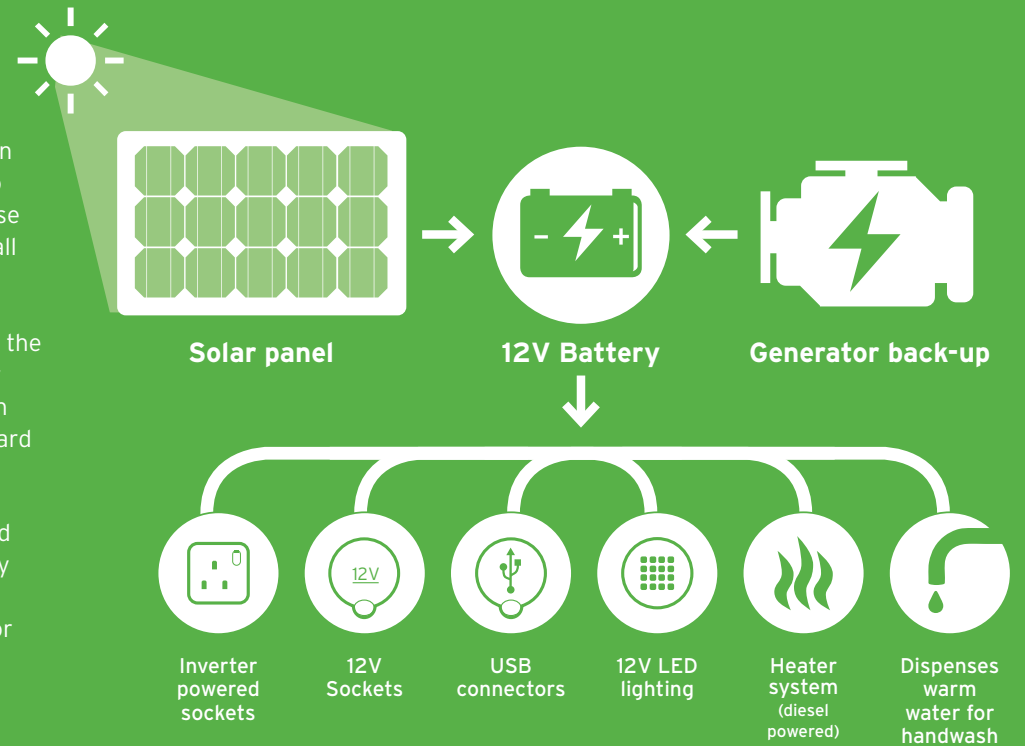

**REDUCED**  
GENERATOR SERVICING  
BY UP TO 80%



**LOW**  
NOISE  
POLLUTION



**CO<sub>2</sub> EMISSION**  
**SAVINGS**  
UP TO 80%



**LONGER**  
GENERATOR  
**LIFE**



**REDUCED**  
FUEL COSTS  
UP TO 80%



**REDUCED**  
BREAKDOWN  
**COSTS**



# The Wernick turnkey service

With our comprehensive turnkey service, Wernick Group can take full responsibility for delivering your classrooms from enquiry to completion.

**Our full turnkey service includes:**



## Site visits

We will visit the proposed site to assess suitability and consider access in order to advise on the best solution for you.



## Design and project planning

Once the suitability of the site is confirmed, your Account Manager will put forward a design proposal to meet your requirements. Once the final design is approved, delivery and install logistics will be arranged.



## Site clearance and groundwork

We can undertake complete site clearance and ground works on your behalf prior to the installation of your building. This can include the removal of existing buildings, ground preparation, foundations, drainage and landscaping.



## Transport

Buildings are delivered to site with specialist vehicles utilising an appropriate crane. Our staff are qualified to plan and supervise the lifting operations on your behalf, as well as to advise on road closures.



## Installation

Modular buildings are assembled on site by our experienced team of installers. All the work is carried out under the direction of our appointed and qualified Contracts Managers. Electrical testing and certification is also provided, as well as temporary power if required.



## Your finished building

Customer satisfaction from beginning to end is our number one priority. Your building will be personally handed over by a member of our contracts team.



Call us today on 0800 970 0231 | 17



# Considerate Constructors Supplier

**Wernick is proud to be a member of the Considerate Constructors Supplier Scheme.**

Considerate Constructors is dedicated to improving the image of the construction industry, by encouraging best practice on all construction sites.

The nationwide scheme is a hallmark of excellence for sites, suppliers and contractors.

All of Wernick Hire's nationwide depots are registered with the Considerate Constructors Registered Supplier Scheme.



# Considerate Constructors - we can help you achieve 'best practice'

**Choosing our temporary accommodation for your on-site needs could help you towards reaching CCS accreditation for your construction project.**

To be a Considerate Constructor site, you have to follow the Code of Practice. Here are just a few ways in which Wernick Hire can help you maximise your score on the CCS audit:

- The GreenSpace range of welfare units supplies a host of energy saving features to reduce your on-site carbon footprint
- Spacious cabins offer comfortable facilities for all site operatives
- AVflex anti-vandal units provide secure welfare options
- High quality units can be branded in corporate colours, helping you create an attractive site for operatives and visitors alike
- Suitable facilities for both male and female operatives
- Smoking / vaping shelters available for hire



# Wernick®

## HIRE

Accommodating people

# 0800 51 55 55

**Wernick Hire Limited Head Office**  
Molineux House, Russell Gardens, Wickford, Essex, SS11 8QG

**[www.wernick.co.uk](http://www.wernick.co.uk)**



Part of the Wernick® Group of Companies.  
The information supplied in this literature is for guidance only.  
A detailed specification is supplied with our design quotation



modular & portable  
building association

