

HALL 7

7.16

Loading Bay
h=4.85m
w=4.80m

T.3

7.1

Loading Bay
h=7.45m
w=6.50m

7.8

HALL 3

HALL 6

Loading Bay
h=4.80m
w=5.00m

6.4

Loading Bay
h=8.00m
w=6.80m

Loading Bay
h=7.90m
w=7.30m

HALL 5

5.28

Loading Bay
h=6.85m
w=5.2m

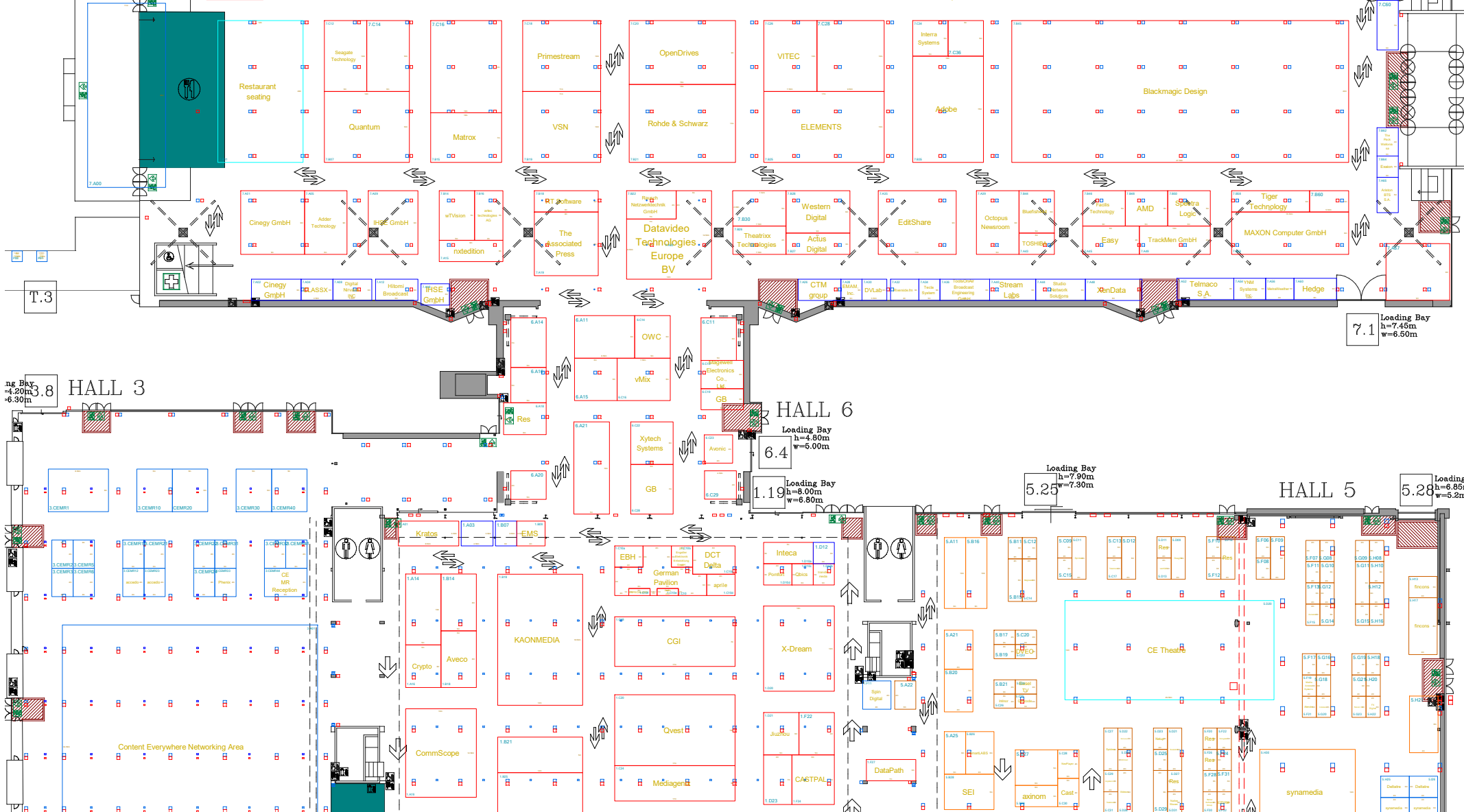

R