



Parkmatic

MORE PARKING IN LESS SPACE

**AUTOMATED & MECHANICAL
PARKING SYSTEMS**

About Parkmatic



We Listen. We Respond. We Deliver.

Parkmatic designs, manufactures, installs, and services both automated and mechanical parking systems. We believe our clients can have the best of all worlds – creative design, cost efficiency, and exceptional client service.

One Stop Service.

- Factory Direct Pricing on Automated and Mechanical Parking Systems
- Full-service Consultation and Design: prime design management, function design, structural design.
- Studies: supply/demand analysis and site alternatives
- Parking Management Services
- Parking Access and Revenue Control Systems
- Sustainable/ Green Design



What is Automated Parking?



- **Automated parking** is a system that identifies, moves, stores, and retrieves cars. Thus providing a fast and safe parking experience.
- Automated parking systems allow for immediate double or triple parking capacity in a very small footprint
- The increased capacity results mainly from:
 - Lower ceiling height requirements
 - Dense door to door and bumper to bumper parking
 - Eliminating the need for concrete slabs, ramps, aisles, and stairs that are found in conventional parking garages.



History of Automated Parking



- Automated parking began in the early 1920's
- The first generation of automated parking started as a rotary design

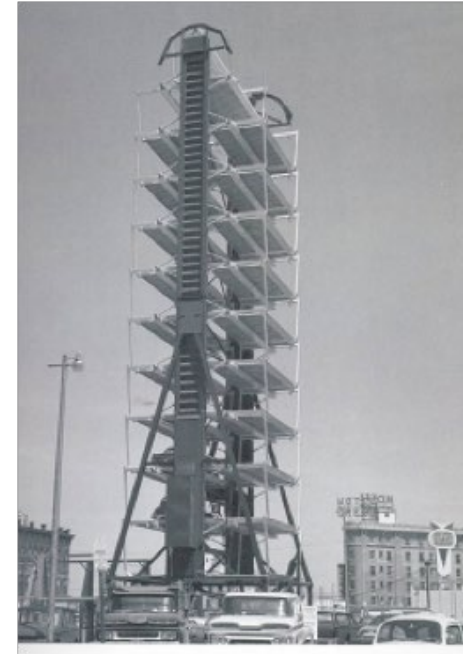
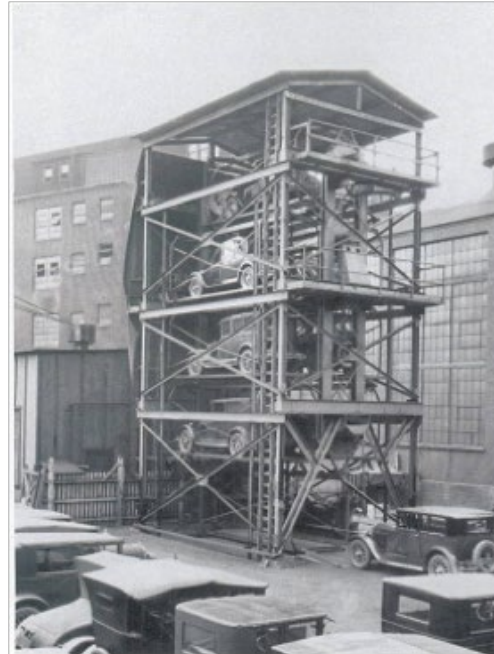

More Parking in Less Space



- Automated parking allows for more area for retail, office space, or residential usage.
- Automated parking also allows parking where previously there would have been no room to build a conventional ramped parking garage.
- Parkmatic parking systems can be designed to fit above or below ground, or a combination of both, allowing for flexible usage of land space.
- If you're building Green, you can use the additional space for more landscaping to achieve additional LEED credits.

Case Study

In a Conventional style garage, where each level may park **71 vehicles** on 2,650ft²/2,440m², each vehicle would normally use ~370 ft².

With a Parkmatic system, the same area will be able to park **144 vehicles** and each vehicle would only use ~182ft².



Benefits of Automated Parking



Environmentally Friendly

Less pollution, no exhaust fumes driving up and down aisles and ramps looking for a spot. Vehicle-generated pollution can be significantly reduced by reducing miles of travel in the garage. In a typical 600 space conventional garage with twice daily turnover up to 300 miles of travel are eliminated every day. Automated parking garages are so much better for the environment in fact that there is an opportunity for additional LEED points when developing an automated garage versus a standard ramp garage.

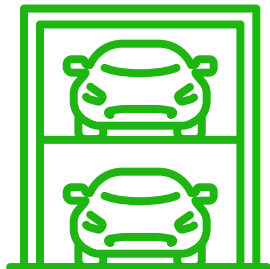

Land Savings

One of the most notable benefits of automated parking is the sheer amount of land that can be saved by developing an automated garage versus a standard garage. Automated parking garages use 30-70% less land than needed for a conventional garage with the same capacity. That means two to three times or more of parking spaces can be accommodated in the same volume of space. It also means land acquisition costs are decreased substantially.



Benefits of Automated Parking

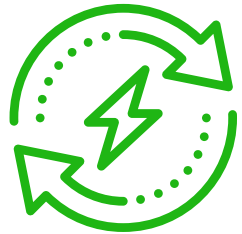

Low Maintenance Operation

Operation costs are low since automated car parking requires less energy to run. Usually 1kw per cycle time. Reduced lighting & HVAC

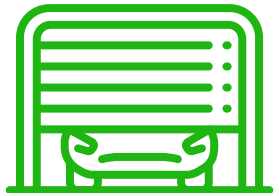

Security

Since no one enters the garage other than vehicles, it virtually eliminates vandalism, dents, scratches, or theft. There is also no personal danger of having to walk down dark aisles while looking for your car.



Lower Construction Costs

Less excavation costs and reduced floor slabs. The elimination of ramps, passenger elevators, and staircases.



Benefits of Automated Parking



Increased Rentable Areas

Automated parking uses half the space of conventional ramped parking garages, thus increasing revenue by having more commercial or retail space.

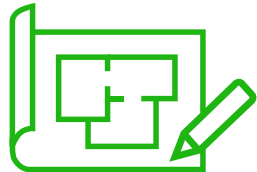

Visual Appeal

No eye sore having to look at all the cars parked outside. The outdoor space saved by automated car parking can then be put to good use with gardens and landscaping or additional buildings if required.



Quality of Life

Most important, Parkmatic systems saves everyone time, and there is no price you can put on time.



SELF PARKING

ATTENDED



CAROUSEL

Carousel L Series (Sedans)

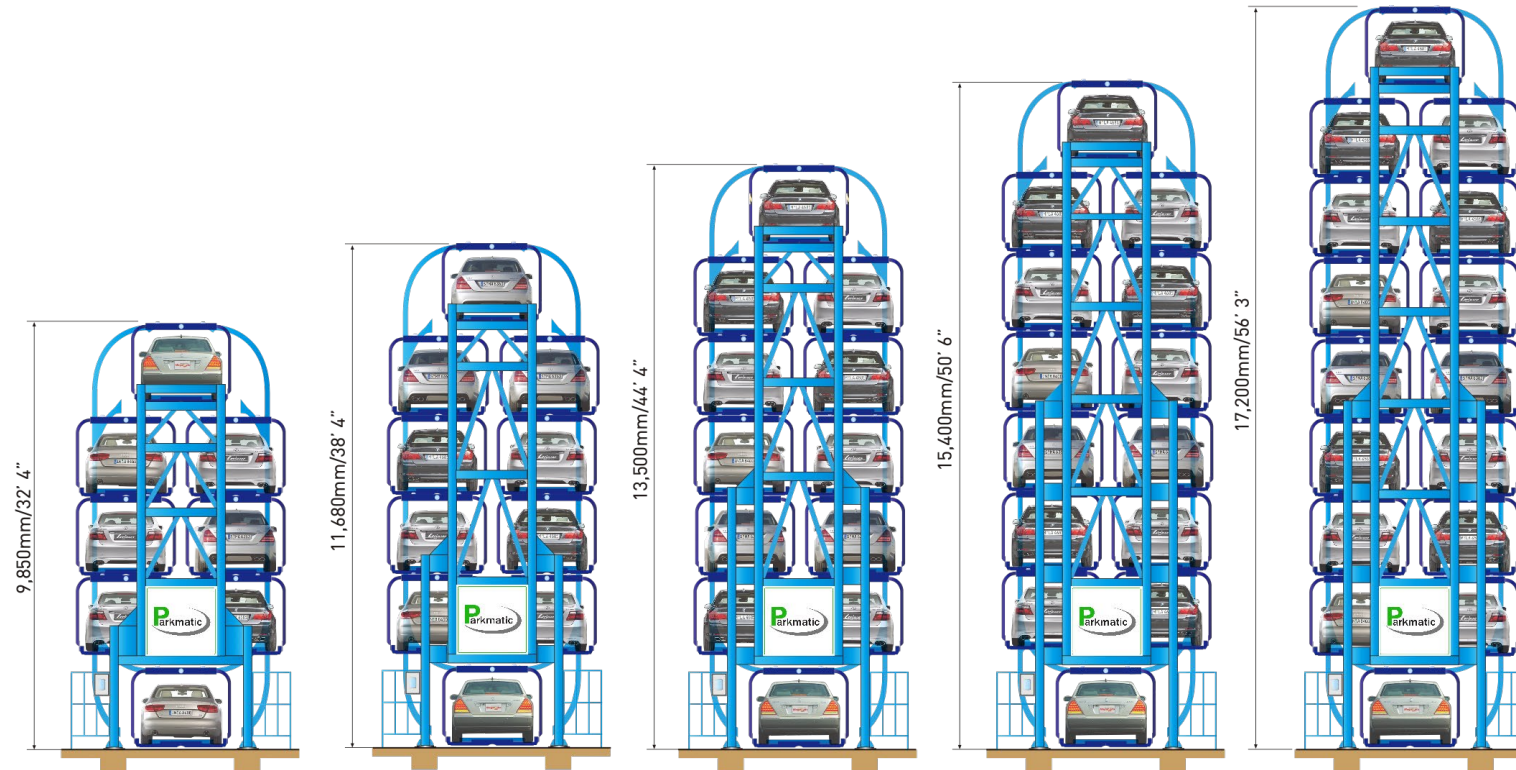

SM8L

SM10L

SM12L

SM14L

SM16L

Carousel SU Series (Sedans and SUVs)

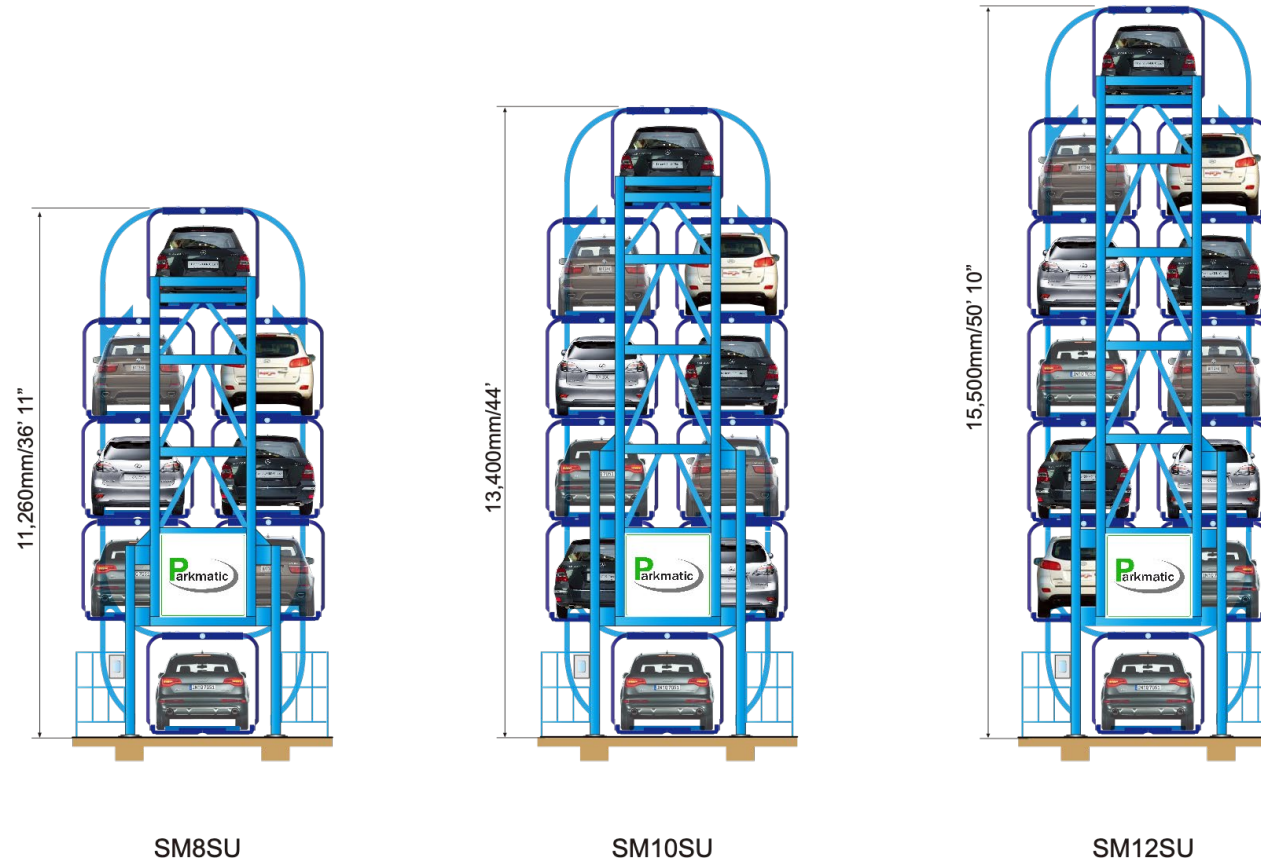

Sample Layouts

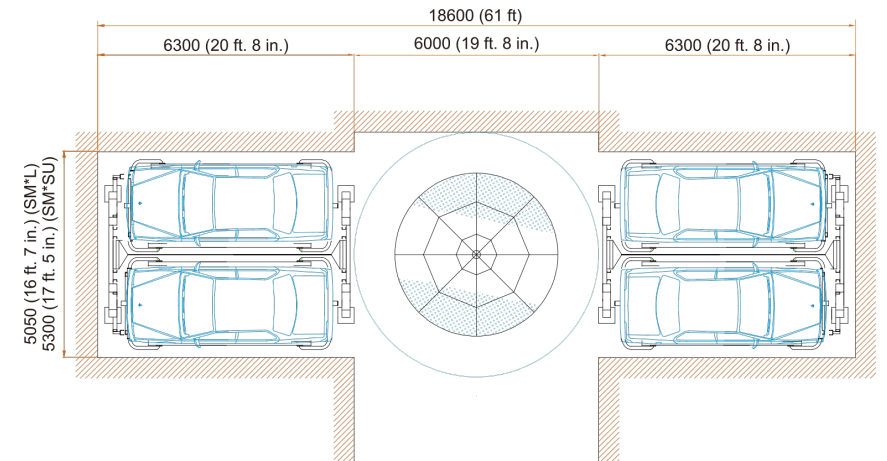
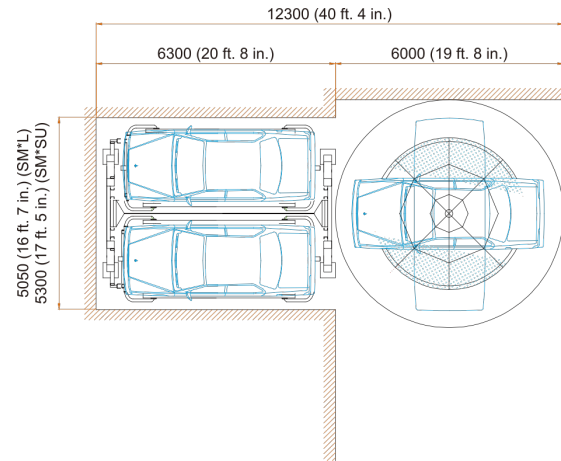
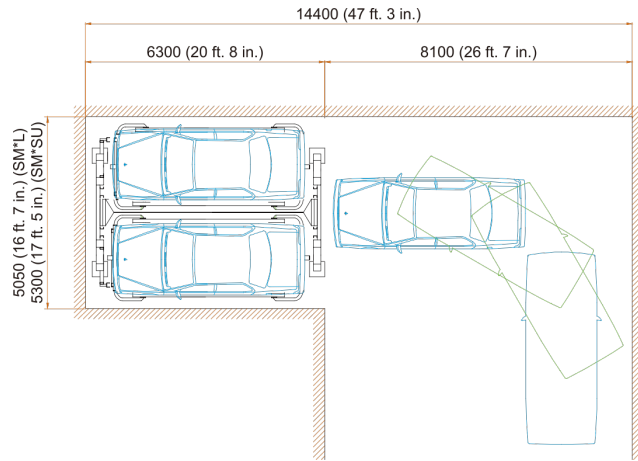

EV Charging

- **Dual Type Adaptor Charging**

The charger consists of 2 carbon brushes which connects the power for the transfer and switch line for continuous charging. The curved conductor rail with radius design moves horizontally and vertically.

- **Charging Station**

The charger operates in contact with the conductor rail to power the current to the vehicle. The carbon brush line is designed to a height that is not exposed for additional safety. Additionally, the adaptor is available to connect separately, and with other products.

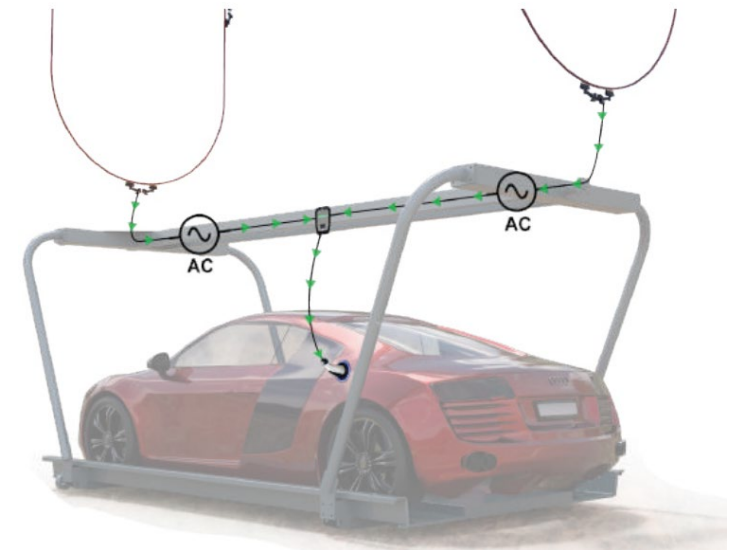

Projects

Ford Dealership
College Station, TX
1 Unit | 10 Vehicles

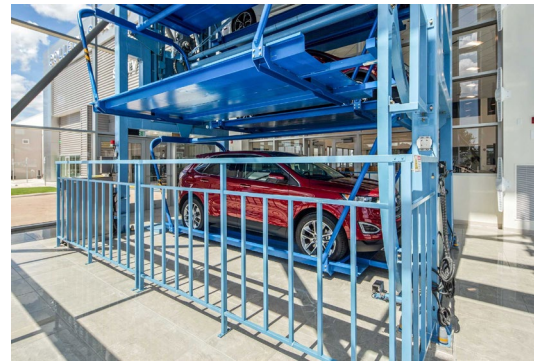

Projects

Nissan USA Headquarters

Farmington Hills, MI

3 Units | 10 Vehicles | Sedans and SUVs



Projects

Public Parking

Brooklyn, NY

3 Units | 8, 10, 12 Vehicles





PUZZLE

Puzzle

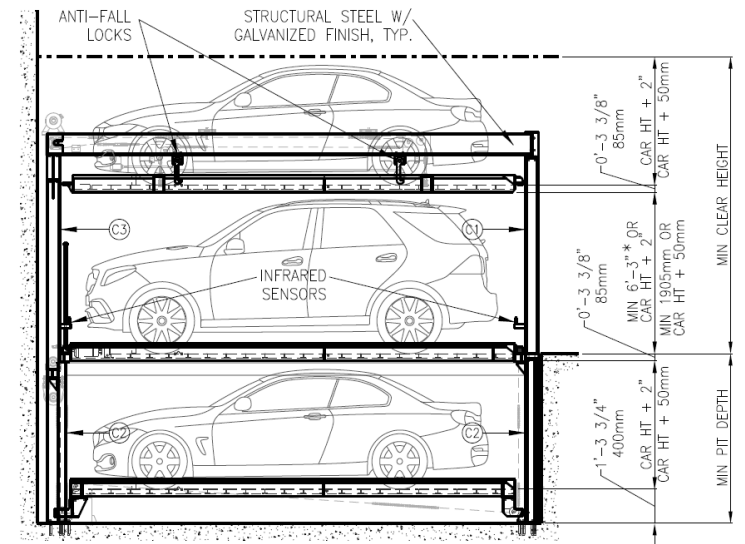
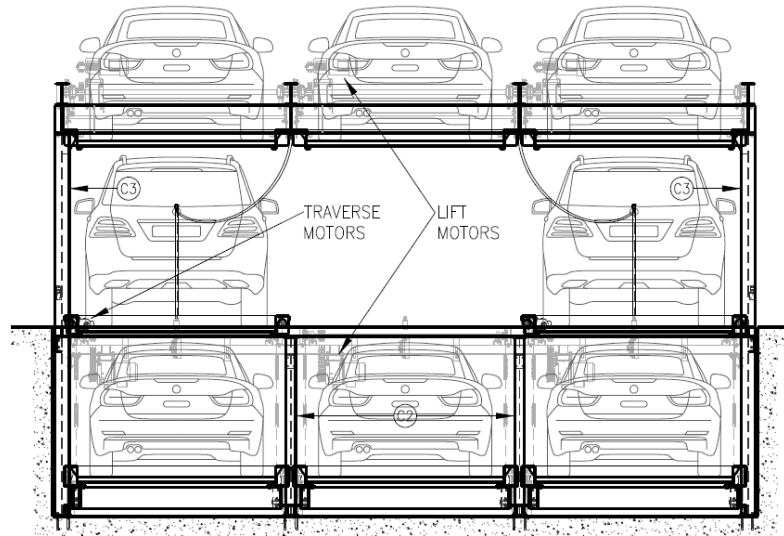
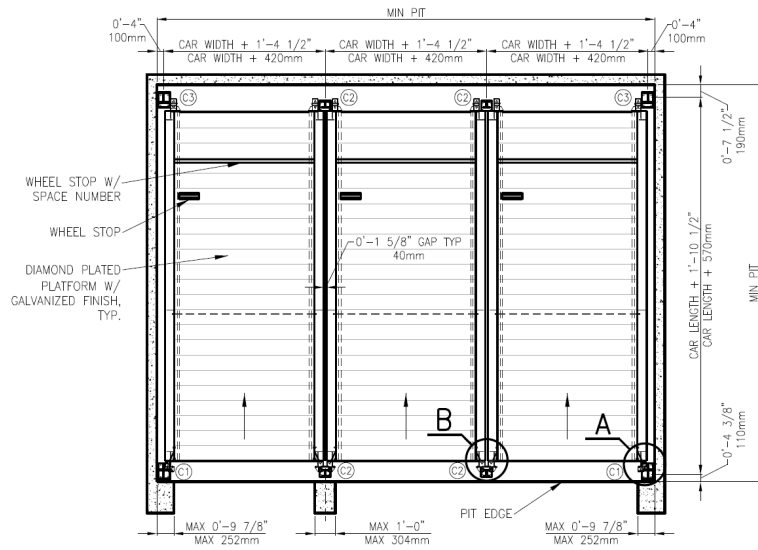

Projects

Residential Parking

Astoria, NY

14 spaces





TOWER

Projects

Hospital Parking

Seoul, Korea

140 spaces





RACK & RAIL

Projects

Office Parking

Annapolis, Maryland

18 spaces



Projects

Retail Parking
Singapore
140 spaces



SELF PARKING

ATTENDED



DOUBLE STACKER

Double Stackers

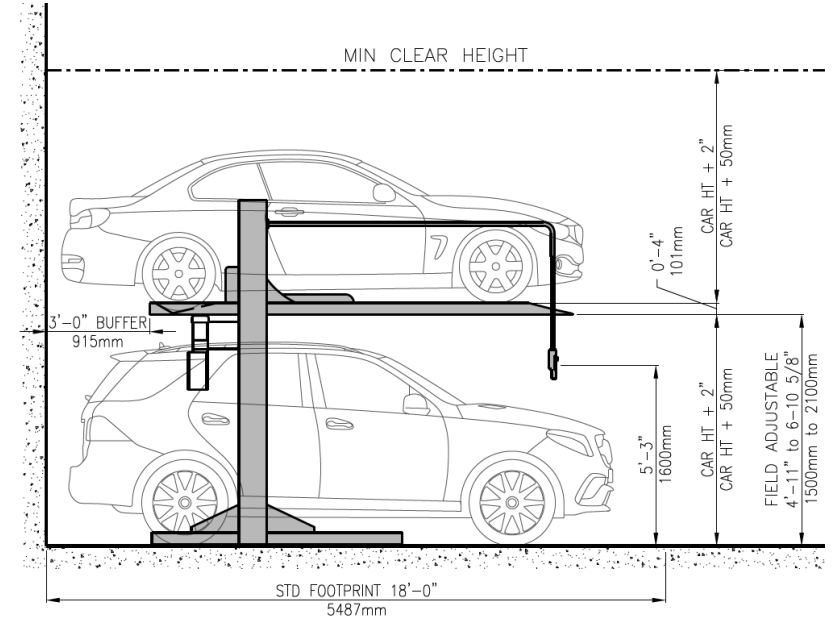
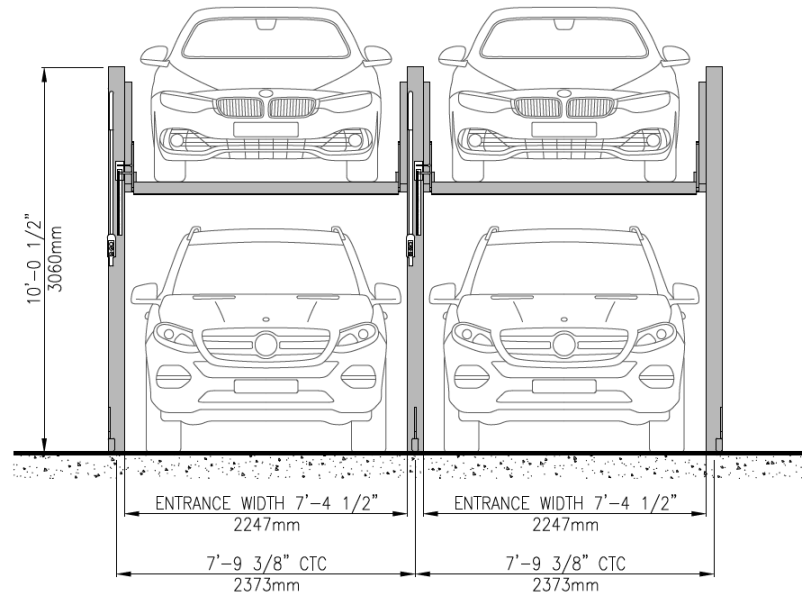
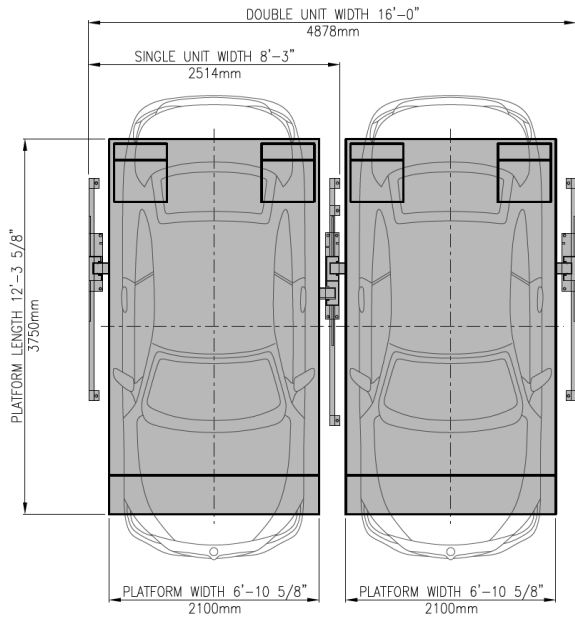

Projects

New Car Storage Facility

New York

422 Double Stackers





TRIPLE STACKER

Stackers

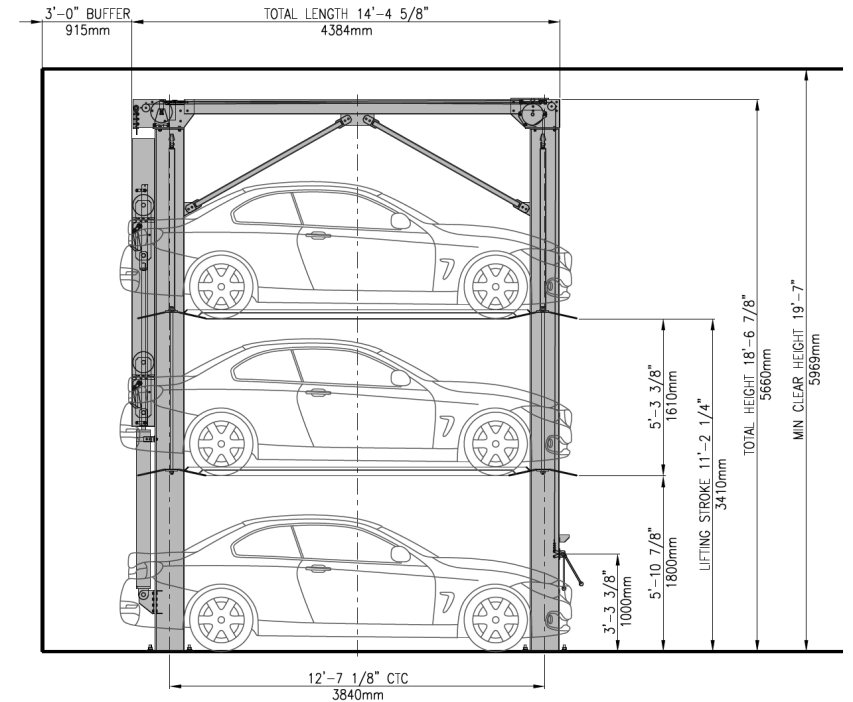
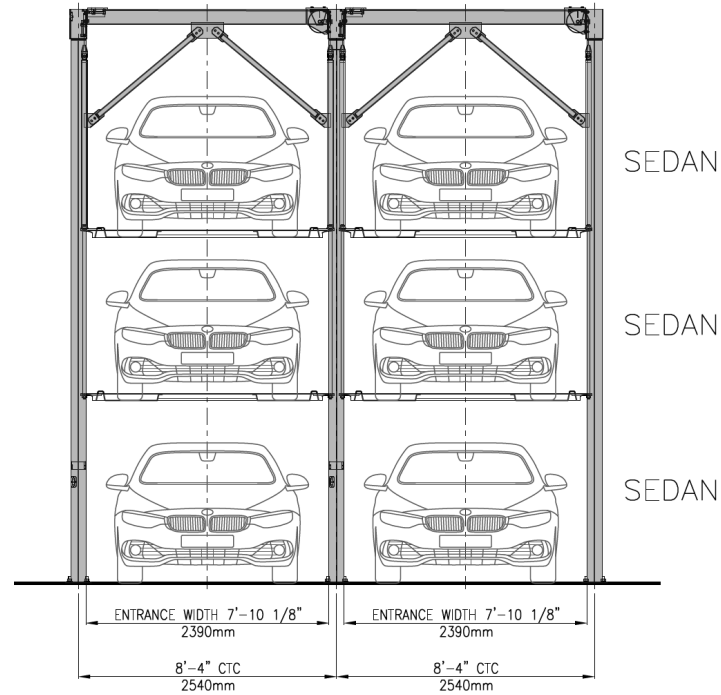
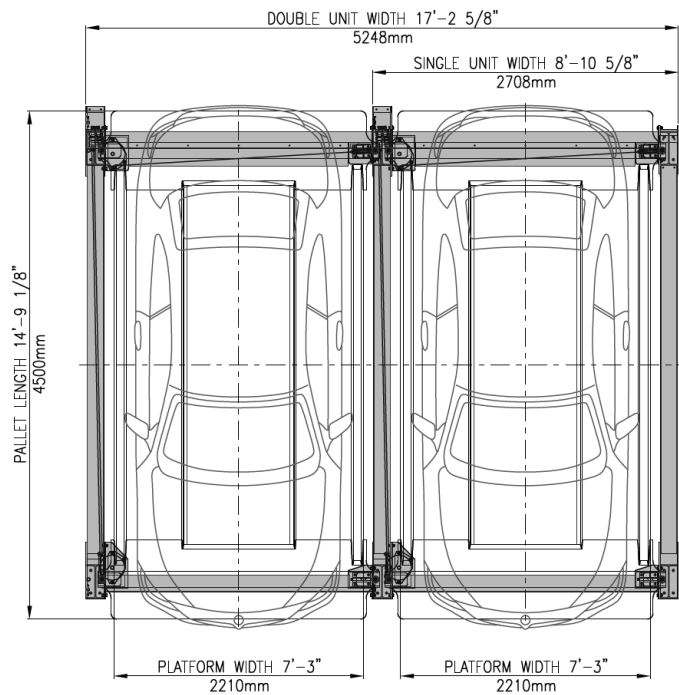

Projects

Car Storage
Scottsdale, AZ
21 spaces





QUAD STACKER

Quad Stackers

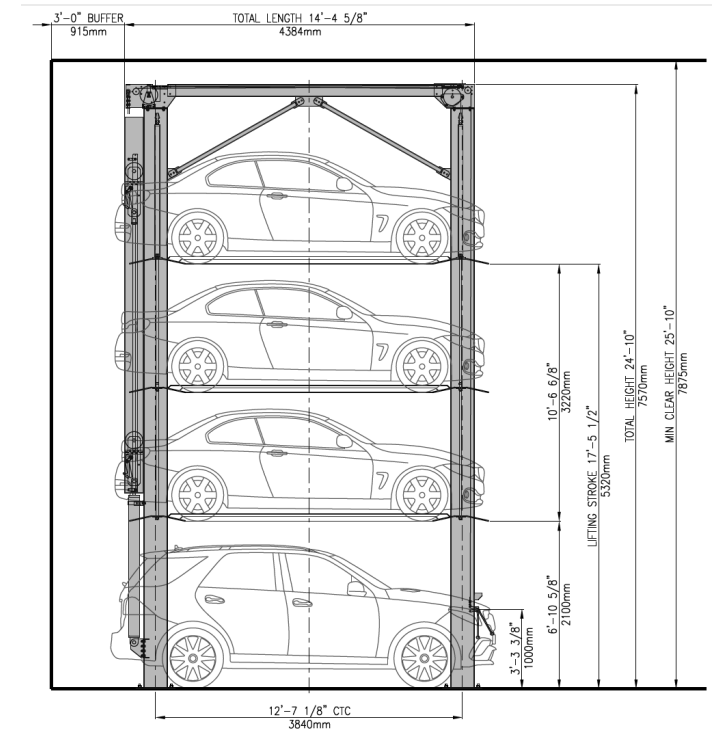
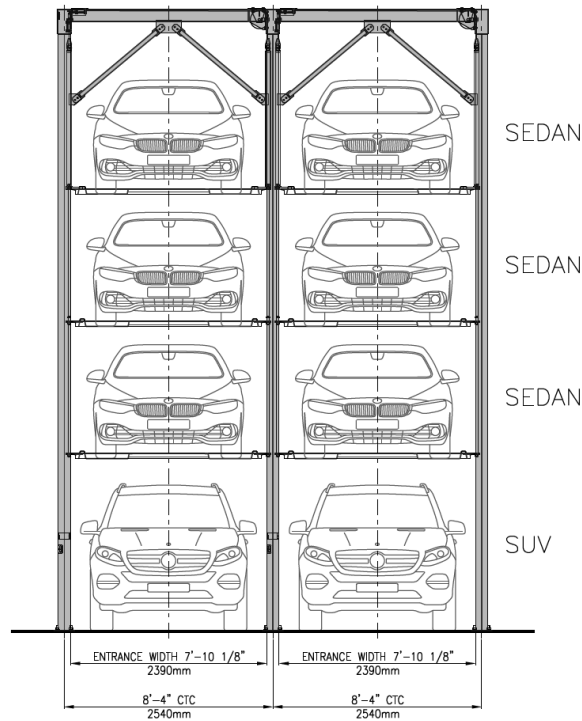
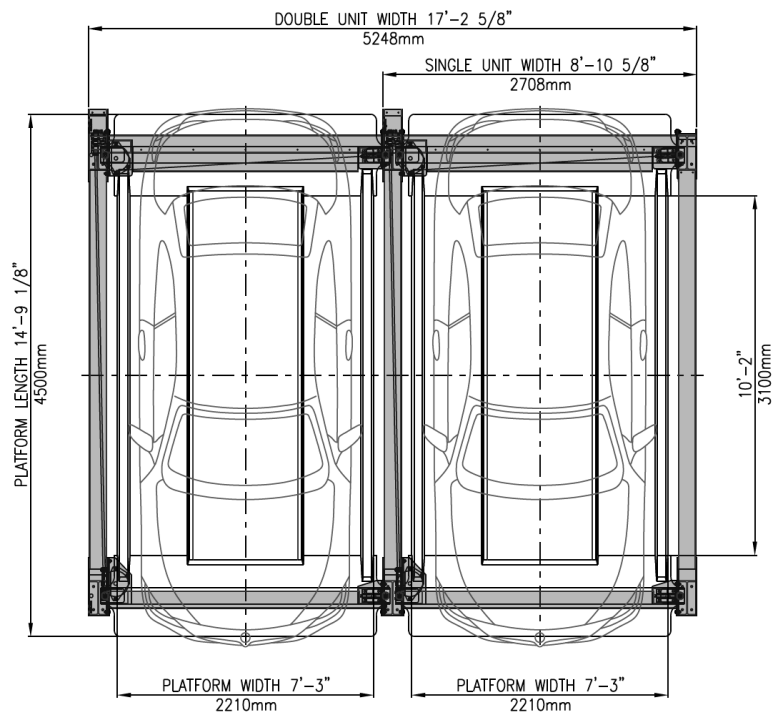

Projects

Public Parking
New York
60 spaces



Mobile Parking Solution

Parkmatic offers a unique mobile experience to make parking easier to manage, track, and monitor. Accessible anytime, anywhere, on any device.



MOBILE SELF-SERVICE
Self-park and retrieval services

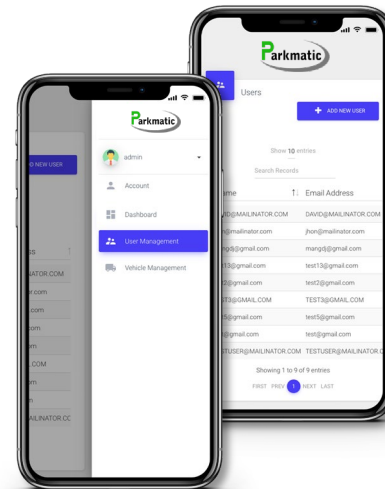

USER MANAGEMENT
Manage users – types, tiers, payments

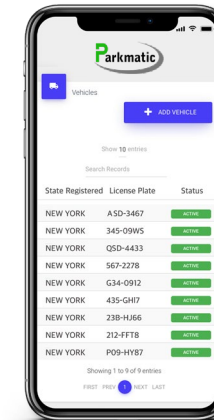

VEHICLE MANAGEMENT
Track and manage relevant vehicle information





PARKMATIC FACTORY

Our Factory

- **Land Area**
46,000 Sq Meters – 495,000 Sq Feet
- **Factory**
19,645 Sq Meters – 211,000 Sq Feet
- **Production Capability**
20,000 Pallets per year





PRICING & MAINTENANCE

PARKMATIC – VEHICLE STORAGE SOLUTIONS

Parkmatic Ireland

Tom Crean Business Centre,
Kerry Technology Park, Tralee,
Co. Kerry, Ireland, V92 XF68

WWW.PARKMATIC.IE

Parkmatic United Kingdom

Nascot Road, Watford,
United Kingdom
WD17 4YE

WWW.PARKMATIC.CO.UK

Tel: +353 87 1926 666

Email: info@parkmatic.co.uk

M O R E P A R K I N G I N L E S S S P A C E