

HRC, IFE, IFE Manufacturing and London Produce Show 2024 Site Rules

As part of the CDM 2015 Health and Safety Regulations all staff (exhibitors or contractors) who wish to access the hall during build up or break down must read and understand the Site Rules for HRC, IFE and IFE Manufacturing 2024.

ACCESS - Authorised access to the halls will only be allowed for personnel who have read and understood these site rules.

TRAFFIC RULES - The maximum speed limit for vehicles within the exhibition hall is **always 5mph and pedestrians have right of way**. However, all contractors and exhibitors must be vigilant and aware that forklifts will be operating during build-up and breakdown.

EMERGENCY GANGWAYS - Emergency gangways will be clearly identified and must be kept clear of all building material, waste and exhibits in order to allow forklift movement and emergency access/egress at all times.

PERSONAL PROTECTIVE REQUIREMENTS (PPE) - Contractors & exhibitors are required to wear suitable protective clothing relevant to their job. This includes protection for eyes, ears, hands, and feet. **Anyone wearing open toed shoes will not be able to access the halls**. Protective footwear should be worn at all times. High visibility jackets **must** be worn in all locations where vehicles are operating (i.e., loading bays/ lorry ways).

HOT WORK RULES - A hot working permit must be obtained from the venue, prior to commencement of hot work e.g., ox -acetylene, cutting/welding, arc welding, gas/ oil blowlamps, grinders, tar boilers, soldering or cutting of LEV metal pipes etc.

WORKING AT HEIGHT RULES - Appropriate management and safe methods of working at height are required at all times, checks on suitable equipment will be made onsite.

LATE WORKING RULES - Exhibitors and contractors should plan to ensure that working outside the published hours is not necessary. All staff must be made aware of and adhere to the current Working Time Regulations.

ACCIDENTS AND 'NEAR MISSES' – Any incident that occurs onsite must be reported to the Health & Safety Officer, Floor Manager or the Organisers Office.

SMOKING - Smoking (including e-cigarettes) is not allowed in the halls at any time. Smoking is only permitted in designated smoking areas.

Contact Numbers:

Organisers Office: TBC

First Aid/Medical Emergency: 0207 069 4444

Security Emergency: 0207 069 4444

Locations:

Organisers Office First Aid

Toilets Seating

Drinking Water Café

See below the Welfare Locations Site Plan

Welfare Locations Site Plan

Emergency gangways must be kept clear at all times

Traffic Office

Lorry Way

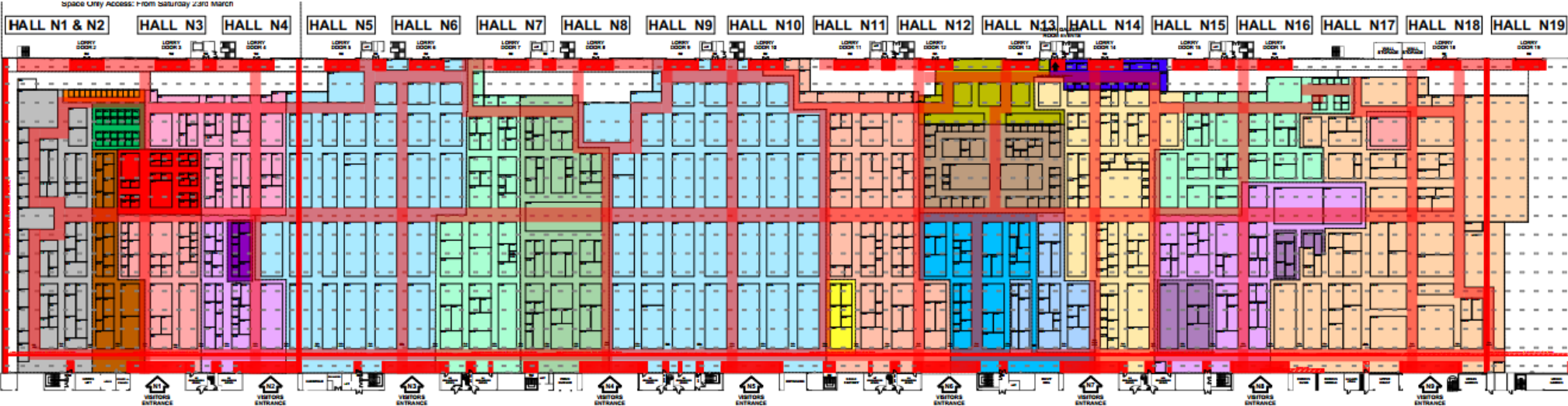

Custom House
DLR & Elizabeth Line

BOULEVARD

Toilets, Café, and Seating

Prince Regent
DLR Line

IFE/IFEM N4 Organisers
Office



First Aid & Toilets are
located down the stairs
by N4/S4 from level 0 on

HRC N10
Organise