



**FORTiS Holder
for Samsung XCover Pro
& KLIK FAST Range**

COMPANY OVERVIEW

Peter Jones (ILG) Limited is a leading manufacturer and supplier of innovative carry and protection products, combining quality, durable leather and modern plastic moulded components.



Group employees: 75



55 years' experience



Global exporter



Owner of KLIK FAST
Device Carrying System



UK-based manufacturer



£6.4 million group net sales

ISO CERTIFICATIONS



INTERNAL RESOURCES

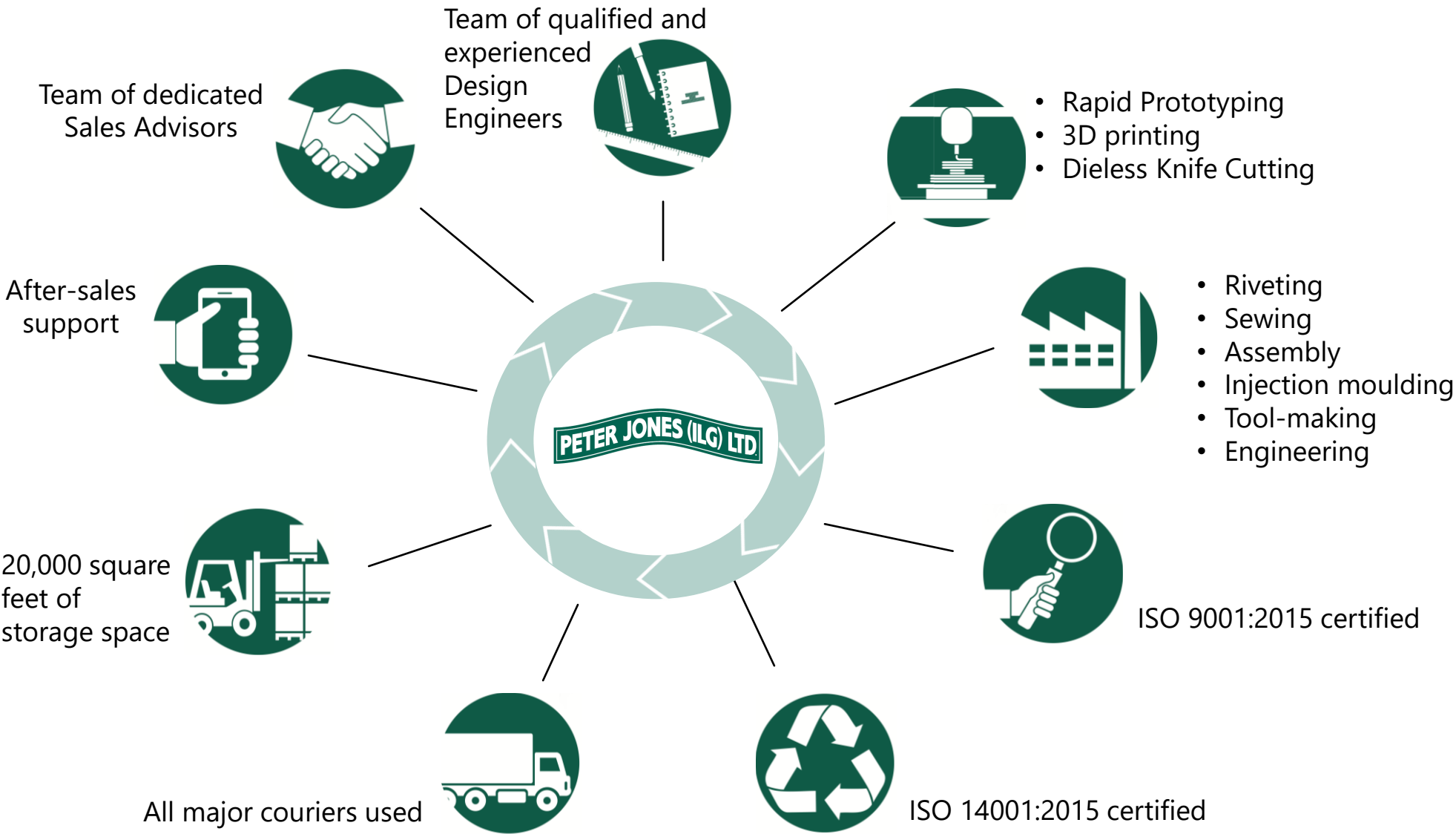

OUR PRODUCTS

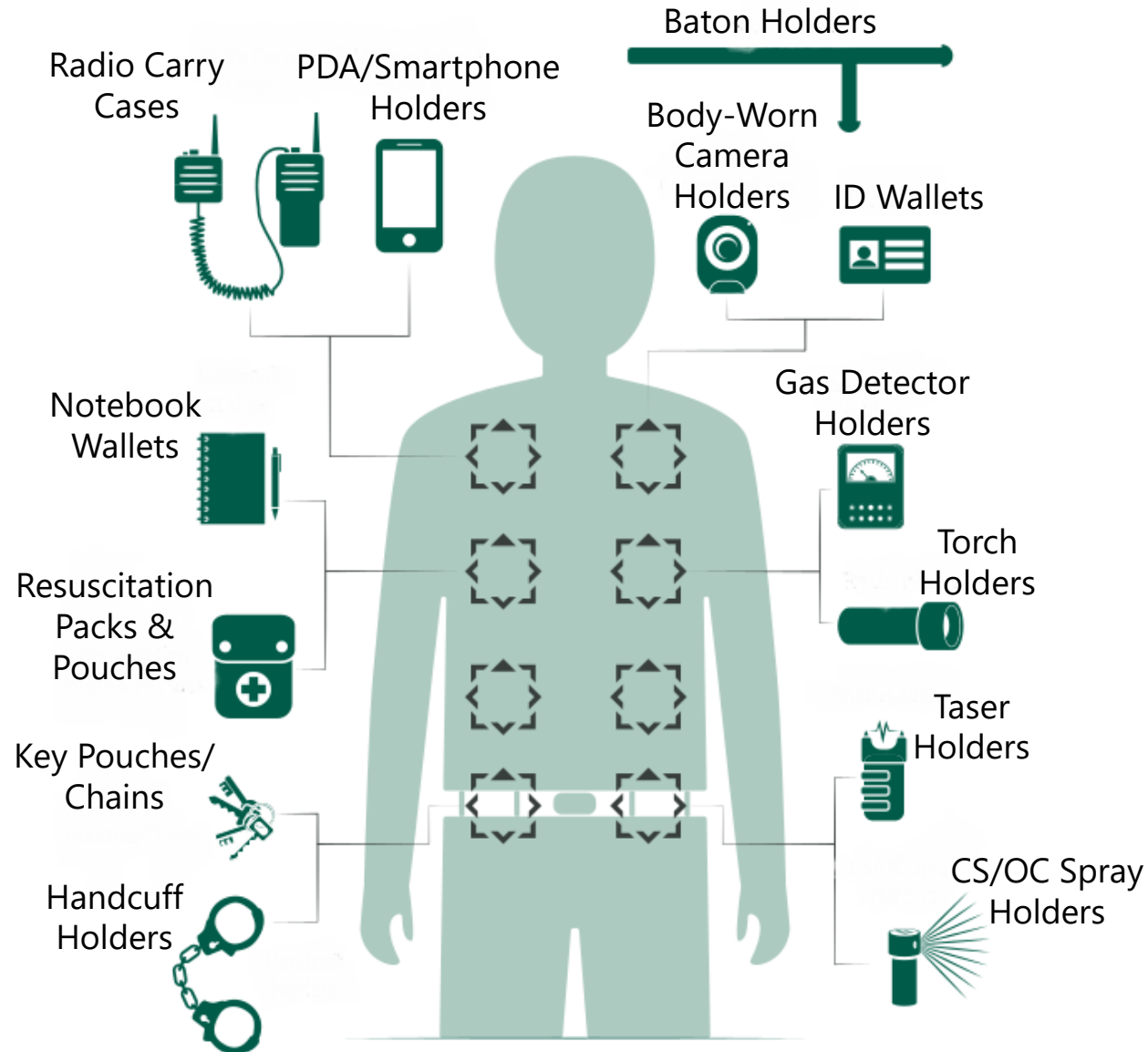

We specialise in the design and manufacture of carrying solutions for portable and wearable devices. Many of our products consist of cases/pouches/holders made from high quality, durable leather or a combination of leather and plastic moulded components.

These attach independently to belts, waistbands, garment pockets etc. or they can be attached using our innovative KLICK FAST Mounting System. This system enables devices to be carried anywhere on the body, vehicle dashboards, lockers and bicycle handlebars.

KLICK FAST IN ACTION

A KLICK FAST Connector, attached to a device or holder, slides and locks easily into any KLICK FAST Dock located anywhere on the body, vehicle dashboards, lockers and bicycle handlebars. Once docked, the device can be rotated to any of seven ratcheted positions. It undocks quickly by rotating it to its inverted position and sliding it free of the Dock.

Please click on the KLICK FAST logo to view the KLICK FAST in action.



FORTiS HOLDER FOR SAMSUNG XCOVER PRO ESN DEVICE

**FORTiS Holder for Samsung XCover Pro with
KLICK FAST Connector**
Product Code: **SXCOVERPROESN02KFNOD**

**NEW
PRODUCT**

The device is securely retained in the holder by a "claw" at each corner.

The FORTiS Holder does not obstruct the screen and allows full access to all device features.



**All images are for illustrative purposes only*

FORTiS HOLDER FOR SAMSUNG XCOVER PRO – KCLICK FAST CONNECTOR

A KCLICK FAST Connector attached to the rear of the FORTiS Holder allows the XCover Pro and FORTiS Holder to be mounted to any KCLICK FAST Dock attached to clothing and other surfaces.

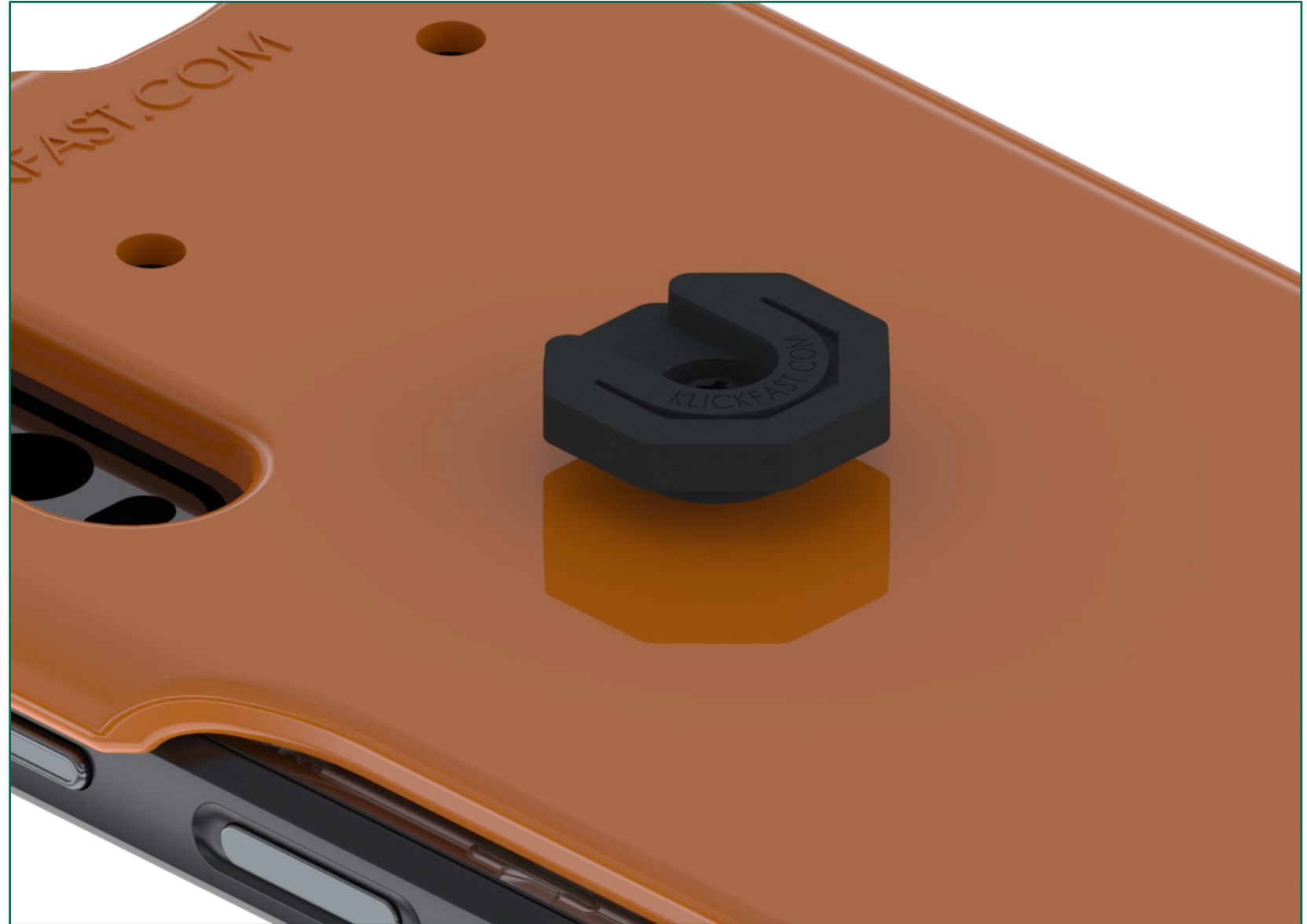

**All images are for illustrative purposes only*

FORTiS HOLDER FOR SAMSUNG XCOVER PRO – PUSH-TO-TALK (PTT) APERTURE

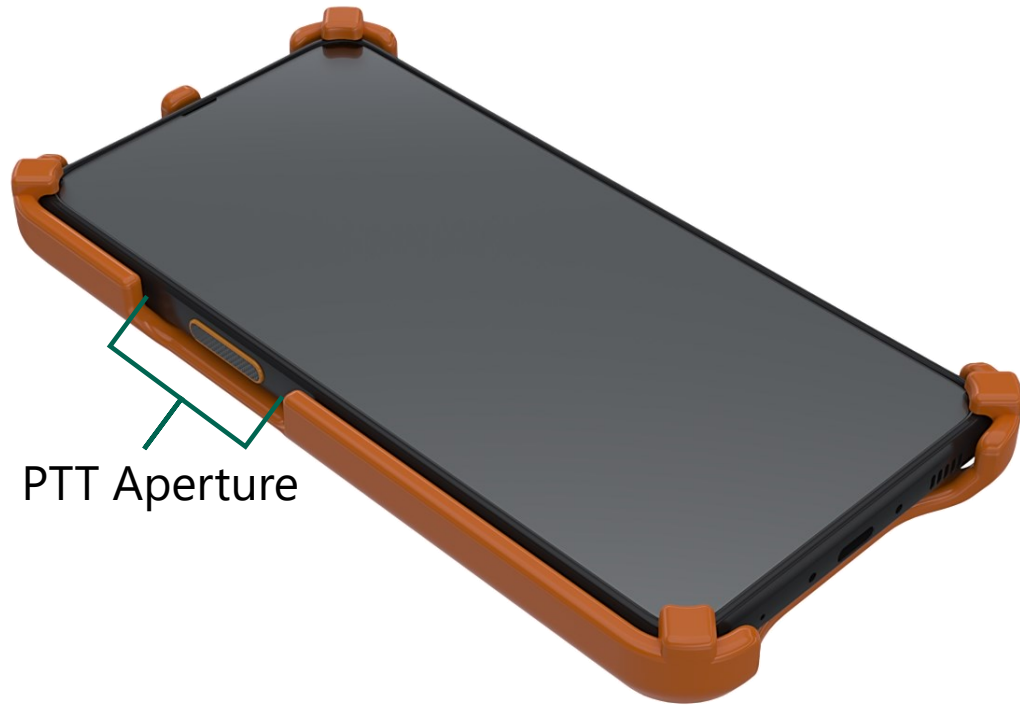

The Push-To-Talk (PTT) aperture ensures the PTT button is protected from accidental use, whilst it also assists the user in locating the button when needed.

Consideration has been given to users wearing gloves by incorporating a large enough aperture that gives tactile feedback on the PTT button location.

**All images are for illustrative purposes only*

FORTiS HOLDER FOR SAMSUNG XCOVER PRO – VOLUME CONTROL RIB GUARD

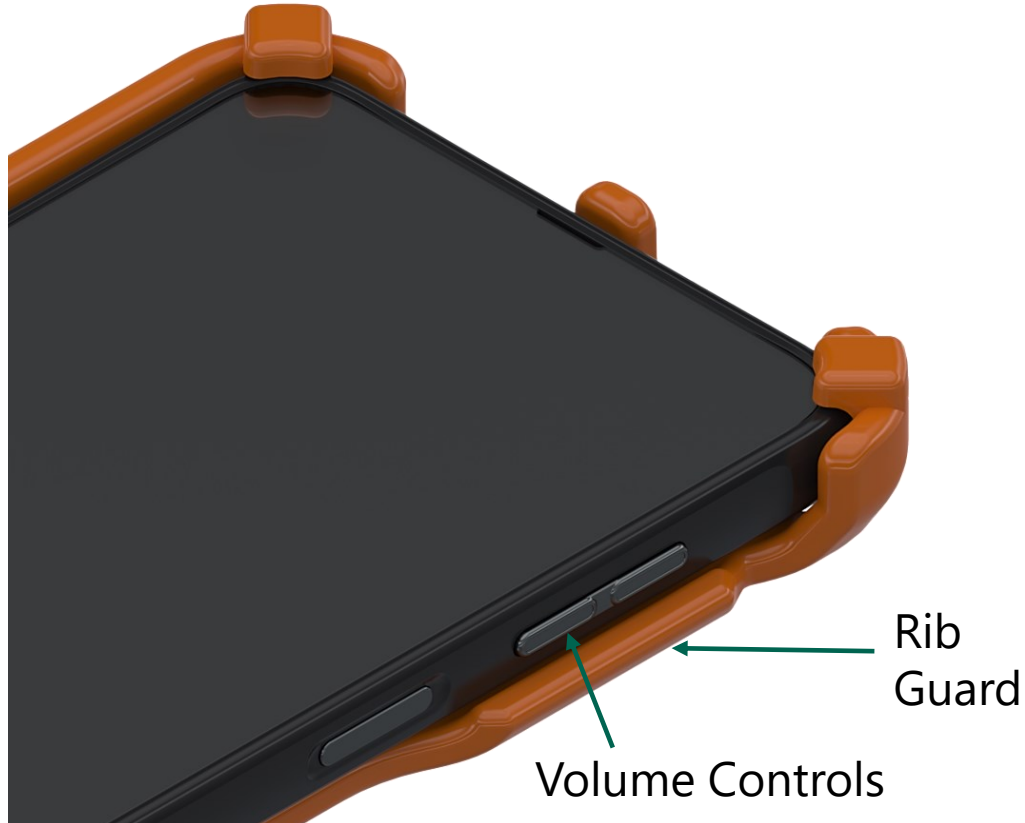

A rib guard incorporated at the side of the FORTiS Holder prevents the volume controls from being accidentally pressed.

The size of the guard has been designed to allow users wearing gloves to operate the controls.

**All images are for illustrative purposes only*

FORTiS HOLDER FOR SAMSUNG XCOVER PRO – EMERGENCY BUTTON APERTURE

A central “claw” has been incorporated at the top of the FORTiS Holder to form an aperture around the emergency button. This prevents accidental activation of the emergency button, and also helps users locate the button when needed.



**All images are for illustrative purposes only*

FORTiS HOLDER FOR SAMSUNG XCOVER PRO – ADDITIONAL FEATURES



USB Port

The FORTiS Holder gives full access to the USB port, whilst all speakers and microphone holes remain uncovered to allow full operational use.

**All images are for illustrative purposes only*

The FORTiS Holder allows full, unhindered use of the rear and front cameras.



Camera Aperture

KLICK FAST SEW-ON DOCKS

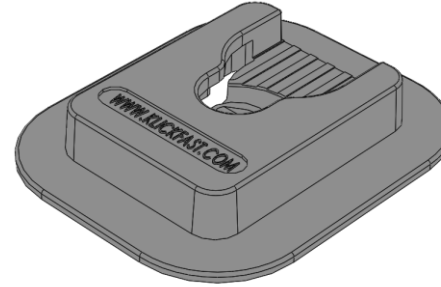

DOCK06

Sew-On Dock

These docks can be sewn onto garments at the manufacturing stage to create a permanent fixing.

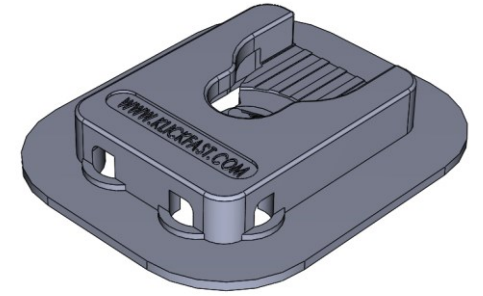

DOCK06EVO2

Sew-On Dock with Slots for Lanyard Attachments

These docks can be sewn onto garments at the manufacturing stage to create a permanent fixing.

KLICK FAST SEW-ON DOCKS - COLOUR OPTIONS



Both DOCK06 / DOCK06EV02 can be supplied in a variety of colours to match users' clothing.

KLICK FAST CROCODILE GARMENT CLIP

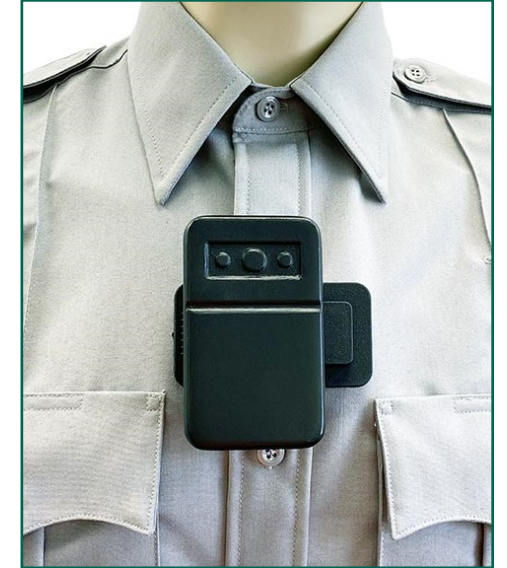

NEW DOCK

DOCKCROCCLIP

KLICK FAST CROCODILE GARMENT CLIP

The KLICK FAST Crocodile Garment Clip featuring a KLICK FAST Dock at the front can be attached to shirt epaulettes, shirt plackets, pockets, belts, trouser pockets, jacket zip openings and skirt/trouser waistbands. It is an easy and quick way to attach a KLICK FAST Dock to garments for secure, hands-free carrying of KLICK FAST-enabled portable devices. The KLICK FAST Crocodile Garment Clip features:

- A small footprint - enabling it to be as discreet as possible beneath the device and allowing it to fit small as well as large pockets;
- A slim profile - keeping the attached device as close as possible to the body;
- A textured, non-slip surface on its upper front and rear to enable fingers to gain a firm grip when squeezing the clip open.

ANTI-TILT ATTACHMENT FOR KLIK FAST CROCODILE GARMENT CLIP



NEW DOCK



Device angled downwards without Anti-Tilt Attachment fitted to the Crocodile Garment Clip



Device angled straight ahead with Anti-Tilt Attachment fitted to the rear of the Crocodile Garment Clip and inserted in a shirt pocket

DOCKCROCLAT

KLIK FAST CROCODILE GARMENT CLIP ASSEMBLED WITH ANTI-TILT ATTACHMENT

In some circumstances, ill- or loose-fitting pockets or garments may cause a device attached to the KLIK FAST Crocodile Garment Clip to tilt downwards. Our optional Anti-Tilt Attachment, when fitted to the KLIK FAST Crocodile Garment Clip, corrects the angle of the device. The Anti-Tilt Attachment can be removed from the Crocodile Garment Clip and re-attached, as required.

The Anti-Tilt Attachment (**ATILTCROCLP**) can be supplied separately as an optional accessory to fit the KLIK FAST Crocodile Garment Clip (**DOCKCROCKCLIP**) or it can be supplied at the same time as the Crocodile Garment Clip and already assembled (**DOCKCROCLAT**).

KLICK FAST MAGNETIC MOUNT (DOCKMAG)



NEW
PRODUCT

KLICK FAST Magnetic Mount

The back plate slips behind a garment or in a pocket, then the front plate featuring a KLIK FAST Dock is placed on top, over the outer garment. 8 high-strength magnets will hold the mount firmly in place. The mount features:

- A low profile - keeping the attached device as close as possible to the body;
- A small footprint - enabling it to be as discreet as possible beneath the device;
- In-built spacing between both mouldings - allowing fingers to slot in and easily detach the front and back plates from each other;
- A lightweight design;
- Two assembly-free, single mouldings that can be supplied with or without high-strength magnets (magnets are supplied already fitted);
- A choice of either a KLIK FAST Dock located at the top of the mount or in the centre, depending on the position of your device's KLIK FAST Connector (Upper dock suitable for devices with a KLIK FAST Connector in an upper position; central dock suitable for devices with a KLIK FAST Connector positioned centrally).

KLICK FAST MAGNETIC MOUNT (DOCKMAG) - CONTINUED



DOCKMAG01

KLICK FAST Magnetic Mount with Upper Dock (Excluding Magnets)

Front and back mouldings supplied only. To be used with magnets 20mm width x 5mm height

DOCKMAG02

KLICK FAST Magnetic Mount with Upper Dock and Fitted Magnets



DOCKMAG05

KLICK FAST Magnetic Mount with Central Dock (Excluding Magnets)

Front and back mouldings supplied only. To be used with magnets 20mm width x 5mm height

DOCKMAG06

KLICK FAST Magnetic Mount with Central Dock and Fitted Magnets

MORE KLIK FAST DOCK OPTIONS



DOCK08

'Screw-To-Fit' Dock

Allows retro-fitting to existing clothing using four screws.



DOCKMV

UPDATED DESIGN

MOLLE Dock

Allows secure and easy attachment to any MOLLE loop system using webbing straps and two press studs. The improved design features a longer support platform for devices, a higher docking position, press studs that are flush with the moulding and rounded edges on the webbing slots to reduce wear and tear on the material.



DOCKEPAULETTE

Epaulette Dock

Allows the device to be hung from epaulettes. The Dock loops over the epaulette and hooks onto a button or stud to secure it in place.



DOCKCLAMP

Anti-Tilt Dock with Spring Clamp

Fastens securely to shirt/suit pockets via a spring clip. An Anti-tilt block keeps a camera looking forward.

MORE KLICK FAST DOCK OPTIONS (CONTINUED)



DOCKRSMTAG

Tag Mounting Dock with 41mm Tongue Width

Fits onto existing shirt or clothing loops. Can be supplied in various widths.



DOCKRUCKSACK

Rucksack Mount Dock

Allows attachment of a device to rucksack straps. Clips anywhere on the padded straps.



DOCK05

Screw-On Dock

Can be attached to various items including Ram-Mount fittings via 4 recessed mounting holes. (Ram-Mounts are not supplied).



DOCKHBARMOUNT

Bicycle Mounted Dock

Adjustable to suit handlebars from 2 – 3 cm in diameter. A rubber protection sleeve cushions a device from vibrations and protects the handlebars.



DOCK10

Storage Dock

Storage dock can be attached by screws or the supplied adhesive pad.

MORE KLICK FAST DOCK OPTIONS (CONTINUED)

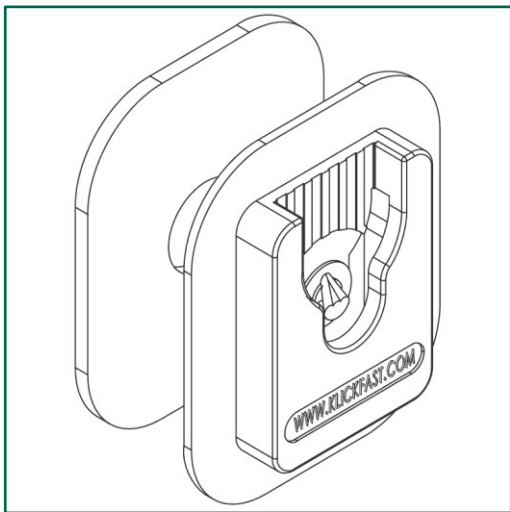

DOCK04

Stick-On Dock

Allows mounting to walls and to car dashboards via a self-adhesive pad.

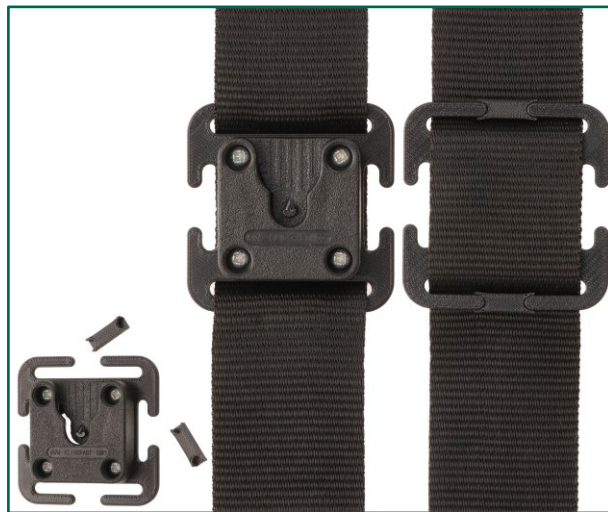

DOCKHARNESS

Harness Dock

Supplied with two repositionable 'keepers' to allow attachment to either 25mm (1") or 50mm (2") wide webbing straps.



DOCKBUTTONM/ DOCKBUTTONF

Button Dock

Designed for use on button-down shirts and particularly useful for carrying devices that need to be located right in the centre of the chest, e.g., body-worn video cameras. The "S"-shaped design attaches to a shirt placket by means of two shirt buttons. Its slim profile ensures the attached device is carried as close as possible to the body. A version is available for both male shirts (**DOCKBUTTONM**) that have buttons on the right and female shirts (**DOCKBUTTONF**) that have buttons on the left.

KLICK FAST HELMET RAIL MOUNT



DOCKHELMETPIC

Dock for Picatinny Rail Adapter

Attaches to Picatinny Rail Adapter which can be supplied separately if not already included on the helmet rail.



PICRAILADAPTER

Picatinny Rail Adapter Kit

For attaching to helmet rail.



The **DOCKHELMETPIC** kit (parts A and B) attaches to the Picatinny Rail Adapter Kit (**PICRAILADAPTER**) (parts C, D and E) before the whole assembly is mounted onto the helmet rail. Slide the assembly on to the helmet rail from the front.

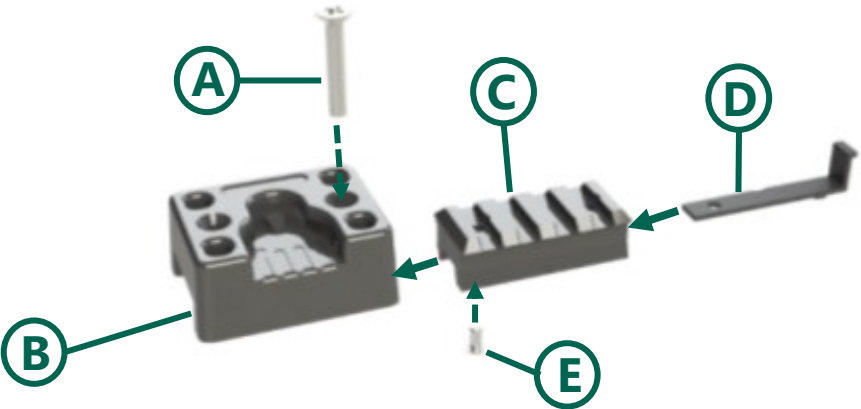

KLICK FAST HARNESS OPTIONS



SSHLDER999ADJKF

Chest Harness with Height-Adjustable KLICK FAST Dock

Webbing Harness with KLICK FAST Dock for chest area mounting of a device. Can be worn over the left or right shoulder. The KLICK FAST Dock can be vertically adjusted to the preferred position. Waist straps have a tripoint quick side-release buckle for easy fastening/detaching. Size-adjustable. Larger size harness also available.



SSHLDER17KF

Four-Point Chest Harness with Central KLICK FAST Dock & Quick-Release Buckles

Four-point webbing harness with a KLICK FAST Dock centrally located on the chest for mounting devices such as body-worn video cameras. Straps slip over the shoulders and around the waist and fasten to two quick-release buckles attached either side of the central leather pad. Size-adjustable.

KLICK FAST HARNESS OPTIONS (CONTINUED)



SSHLDER4KF

Four-Point Chest Harness with Central KLIK FAST Dock & Spring Hook Fastenings

Four-point webbing harness with KLIK FAST Dock centrally located on the chest for mounting devices such as body-worn video cameras. Straps slip over the arms and shoulders and can be quickly fastened by connecting two flat spring hooks to the D-rings attached to the central leather pad. Larger harness size and an Intrinsically Safe version also available. Size-adjustable.



SSHLDER18KF

Shoulder Harness with KLIK FAST Dock Under Left Shoulder

Shoulder harness with KLIK FAST Dock mounted on a comfortable, leather strap just below the left shoulder. Suitable for high mounting of devices such as two-way radios, body-worn video cameras and portable gas detection monitors. A length-adjustable, elasticated strap fits over the right shoulder to secure the harness. Can be worn covertly under jackets or over outerwear.

KLICK FAST HARNESS OPTIONS (CONTINUED)



SSHLDER15*

Sam Browne Harness with Height-Adjustable KLIK FAST Dock

Webbing strap worn diagonally over the left or right shoulder with KLIK FAST Dock for chest/shoulder area mounting of devices. The KLIK FAST Dock can be vertically adjusted to the preferred position. The harness attaches to a utility belt (not included) via a KLIK FAST Belt Dock fitted at the rear and at the front. Size-adjustable.

**Belt not included but can be supplied separately, if required.*

KLICK FAST HARNESS OPTIONS (CONTINUED)

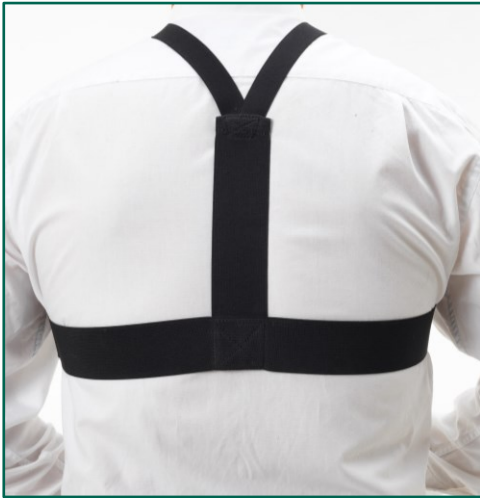

SSHLDER21KF

Four-Point Chest Harness with Central KLICK FAST Dock & Elasticated Straps

Four-point elasticated harness with KLICK FAST Dock centrally located on the chest for mounting devices such as body-worn video cameras.

Straps slip over the shoulders and around the ribs and fasten via a quick-release buckle attached to the left side of the central, nylon fabric pad. All-round elasticated straps allow more give and, together with the tri-glide buckles on each strap, offer complete adjustability to comfortably fit thick outerwear as well as a wide range of body shapes and sizes.

NEW
HARNESS



CLICK FAST DOCKING OPTIONS FOR BELTS

Belt Docks



DOCK01

Dock to suit 32mm belt width.



DOCK02

Dock to suit 38mm belt width.



DOCK03

Dock to suit 50mm belt width.



DOCK07

Dock to suit 60mm belt width.

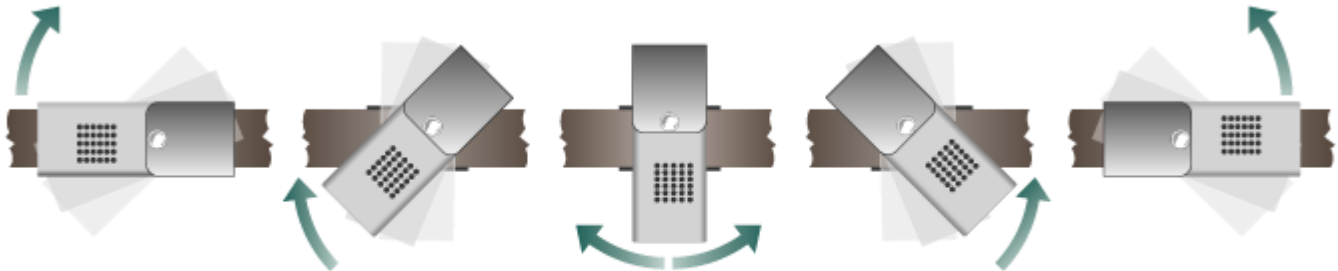

Seven position ratchet

KLICK FAST DOCKING OPTIONS FOR BELTS (CONTINUED)

Leather Belt Loop Docks



DOCK05BL

Dock on a 50mm leather belt loop that sits at belt level.



DOCK05BLDROP

Dock on a 50mm leather belt loop that sits 50mm below belt level.



DOCK05BLEXLDROP

Dock on a 50mm leather belt loop that sits 100mm below belt level.

KLICK FAST DOCKING OPTIONS FOR BELTS (CONTINUED)



DOCK05BC

KLICK FAST Dock with Leather-Covered Belt Clip

Allows fitting to belts and waistbands.



DOCK11

Clip-On Dock

Allows quick, easy installation and removal of a KLIK FAST Dock to/ from garment pockets, waistbands and belts. Device and Dock can be detached/re-attached instantly without undocking/ docking. Converts a KLIK FAST to a belt clip.



**NEW
PRODUCT**

DOCK05BVELCRO

Leather Belt Loop with KLIK FAST Dock & Velcro Fastening

Attaches to belts quickly and easily without having to take off the belt. It fits belts up to 60mm in width. Any device or device holder fitted with a KLIK FAST Connector can then be carried securely and hands-free on the belt.

CONTACT US



sales@peterjonesilg.co.uk



Peter Jones (ILG)
Limited
Lower Monk Street
Abergavenny
Monmouthshire
NP7 5LU, U.K.



+44 (0)1873 852742



www.peterjonesilg.co.uk

For all our latest news, follow us on:



Office Hours: Mon – Thurs: 9am – 5pm (closed 12.30pm – 1.30pm for lunch) Fri: 9am – 12.30pm