

# HILTON BRIGHTON METROPOLE

## THE FACTS



Set in the heart of one of the most iconic and vibrant seafronts in the UK, Hilton Brighton Metropole is a truly impressive conference & events venue. Perfectly capturing the character of Brighton whilst still retaining original Victorian architectural features. Whether you are holding a small meeting or planning a large scale event, Hilton Brighton Metropole can deliver a truly memorable experience with endless possibilities for all of your ideas. The only limits are your imagination.

### AT A GLANCE

- 340 guest rooms
- 33 meeting rooms
- Versatile event space for up to 3,000 delegates
- In-house audiovisual company
- Waterhouse Bar & Terrace
- 1890 At The Met Restaurant
- LivingWell Health Club – 24 hours, 7 days a week
- Indoor swimming pool, 6 treatment rooms and hairdresser
- On-site car park with 200 spaces
- 40-minute drive from London Gatwick Airport
- Less than one hour from central London by train

## OUR ROOMS

### DOUBLE FAMILY GUEST ROOMS

All of our rooms are designed to provide a restful stay. A Double Family Guest room offers a comfortable double bed and a single bed, with cots and rollaway beds available on request. Stay connected with Wi-Fi access and unwind with a selection of digital TV channels or a newspaper on the easy chair.

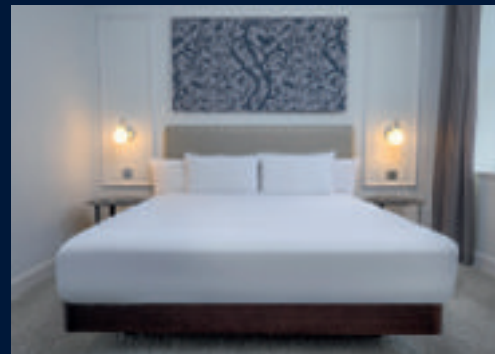

### KING SUITE WITH SEA VIEW

Our stylish King Sea View suite features a separate living room, large bathroom and stunning sea views. Bask in all the extra space and let yourself feel at home.



### SEA VIEW GUEST ROOMS

Take comfort to the next level in our spacious King Sea View rooms featuring large windows with sea views overlooking the English Channel.

King Sea View with Balcony rooms benefit from the same amenities as our King Sea View rooms but offer a private balcony to admire the coastal panorama.

## OUR FACILITIES

### LIVINGWELL HEALTH CLUB AND SWIMMING POOL



Personalised fitness for a balanced lifestyle while on the road. Featuring Precor® cardio and strength training equipment, LivingWell Health Club takes a personalised approach to help you feel your best during your stay. After a workout, why not swim a few laps in the indoor pool and then relax in the sauna and whirlpool.

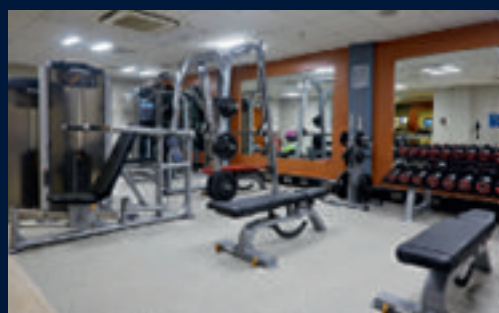

### 1890 AT THE MET RESTAURANT

This magnificent restaurant offers an air of timeless grandeur with ornate ceilings and expansive windows showcasing the spectacular sea views. Feast on the celebrated Breakfast at Hilton or join us for our famous Sunday Jazz Lunch featuring live jazz in this glamorous setting.

### WATERHOUSE BAR & TERRACE

The Waterhouse Bar & Terrace is the perfect place for business people and families alike. The terrace is filled with parasols, outdoor seating and is a great place to people-watch with its unrivalled sea views. Guests can dine on our delicious, locally-sourced menu, or delight in our Afternoon Tea.





## HERE ON BUSINESS

### MEETINGS & EVENTS

As well as being the perfect setting to make your event an experience, Brighton Metropole also offers the Hilton facilities and hospitality to make everything run as smoothly as possible. Our experienced team are on hand to help you plan and organise a successful and memorable event.

- 35 meeting rooms and versatile event space
- Durham Suite can accommodate a fully operational dodgem track
- 3,000 capacity when Oxford, Cambridge and Durham Suites are combined
- Oxford Suite holds up to 1,000 delegates theatre and banquet style
- Street level access for loading
- Sussex Lounge delegate registration and welcome area
- Various break-out rooms
- Hilton Meeting Centre with inspiring sea views
- PSAV, our on-site audiovisual company, helps make your event production suitable for the occasion
- Wi-Fi access throughout





## UNIQUE EVENT VENUES

- **Clarence Suite** – Beautiful converted chapel dating back to 1819, with ornate Victorian features and wedding licence, it is the perfect setting for your big day and for social events of up to 200 guests
- **Ambassador Suite** – With its domed ornate ceiling and wedding licence, this venue is ideal for intimate ceremonies or social affairs of up to 120 guests
- **Chartwell Suite** – Situated on the 7<sup>th</sup> Floor with floor to ceiling windows and 180° panoramic sea views reaching as far as Worthing and Eastbourne on a clear day. Wonderful for intimate weddings, private dinners for up to 70 guests and boardroom meetings
- **Churchill Suite** – Where Sir Winston Churchill dined in 1947, this venue is suitable for private drinks receptions, dining or boardroom meetings of up to 30 guests

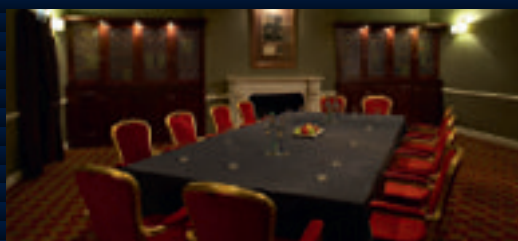

### FLOORPLAN

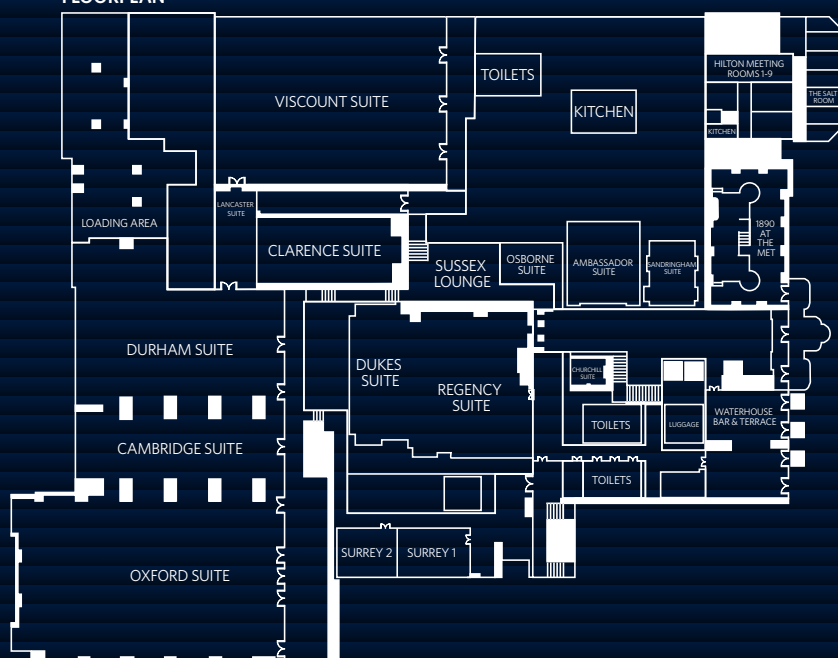

**HILTON BRIGHTON METROPOLE**  
Kings Road, Brighton, East Sussex, BN1 2FU,  
United Kingdom  
T: +44 (0)1273 775 432  
[enquiries.brightonmet@hilton.com](mailto:enquiries.brightonmet@hilton.com)  
[brightonmet.hilton.com](http://brightonmet.hilton.com)

	Area (ft <sup>2</sup> )	Classroom	Theatre	Banquet	Reception	Conference	U-Shape	H-Square
Oxford	12,833	26	500	1,000	800	1,000	—	—
Cambridge	4,244	10	100	250	150	400	50	50
Durham	7,233	26	200	700	550	700	—	—
Viscount	9,636	9	200	220	600	800	—	—
Clarence	2,804	30	100	200	200	300	50	50
Regency	5,279	13	220	450	300	800	50	60
Dukes	1,968	13	80	150	100	300	50	40
Ambassador	1,936	70	150	120	150	50	40	40
Churchill	538	—	40	30	—	25	—	—
Chartwell	1,145	13	30	70	60	60	35	40



AMERICAS • EUROPE • MIDDLE EAST • AFRICA • ASIA • AUSTRALASIA