

# Bali Nusa Dua

CONVENTION CENTER

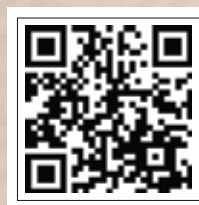

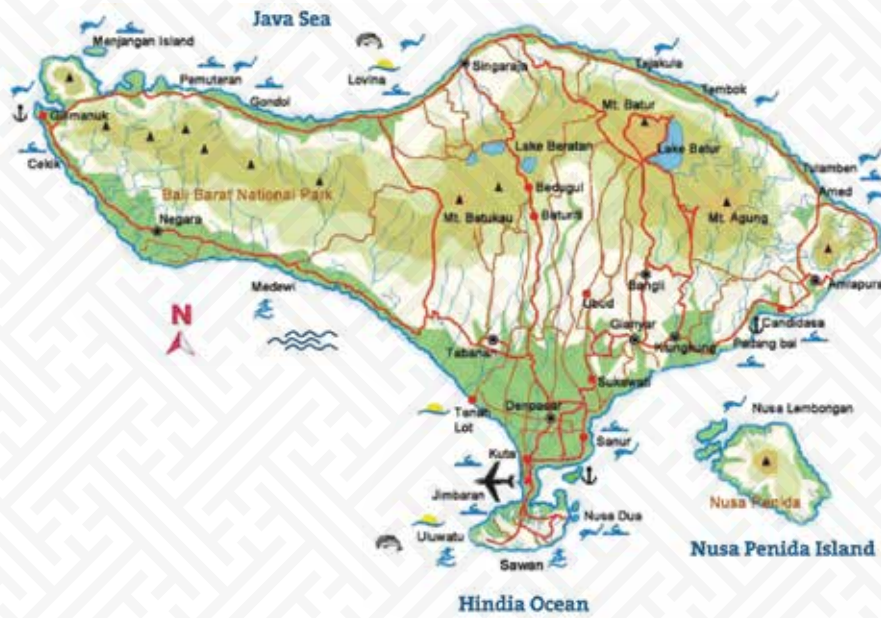



## A WORLD OF ITS OWN

Bali has developed into a world of its own. It captures not only what is special about Indonesia, but embodies a unique spirit that can only be found on the island. Indeed, there is a great deal to experience in Bali that cannot be found in any other place.

As one of the most magnificent islands in Indonesia - offering countless natural beauties of its famous sandy beaches, rice terraces and volcanoes. The uniqueness of its Hindu culture is ubiquitous in day-to-day life; it is echoed in the temples and palaces, the arts and crafts centers, the ceremonies, the festivals, the traditional dances and the distinctive tune of the gamelan.

With more than 60 international and domestic airlines operating at the Ngurah Rai Bali International Airport, this beautiful island is just a flight away from anywhere in the world.



### Flight Times from Bali

Denpasar-Singapore:	2 Hours 30 Minutes
Denpasar-Kuala Lumpur:	3 Hours
Denpasar-Perth:	3 Hours 30 Minutes
Denpasar-Bangkok:	4 Hours 15 Minutes
Denpasar-Hongkong:	4 hours 45 Minutes
Denpasar-Taipei:	5 hours
Denpasar-Shanghai:	5 Hours 30 Minutes
Denpasar-Melbourne:	5 Hours 30 Minutes
Denpasar-Sydney:	5 Hours 50 Minutes
Denpasar-Osaka:	6 Hours 30 minutes
Denpasar-Seoul:	7 Hours
Denpasar-Tokyo:	7 Hours

## OUR EVENTS

Bali Nusa Dua Convention Center (BNDCC) has hosted numerous high profile events including 10<sup>th</sup> World Water Forum, The 1<sup>st</sup> High Level Meeting of Archipelagic and Island States (AIS) Forum, The 5<sup>th</sup> Ministerial Meeting of AIS Forum, World Hydropower Congress, 61<sup>st</sup> Annual Session Asian African Legal Consultative Organization, ASEAN Ministerial Meeting Series, and The 33<sup>rd</sup> International Confederation of Midwives Triennial Congress.



## Meetings & Conventions

BNDCC is an exceptional venue choice for professional events of up to 10,000 delegates with a total of 44 multi-functional rooms including Nusa Dua Hall (4,400 sq.m), Pecatu Hall (1,770 sq.m), Singaraja Hall (1,734 sq.m) and other 32 fully equipped meeting rooms for break-out session, luncheon, dinner, workshop and conference.

All these rooms come in a range of sizes and sub-divisible options which gives a great degree of flexibility.

The room capacities range from 80 to 4,800 delegates and are available with different room layouts including theatre style, boardroom, classroom and banqueting.



## Exhibitions

Clients have a choice of four pillarless halls in size from 920 sq.m to 4,400 sq.m, with ceiling heights for up to 10m, and are complete with essential services such as electricity supply, UTP data cable, audio and telephone cable.

The 6,000 sq.m lobby area is perfectly suited for smaller scale of exhibition and for outdoor exhibition is located at Taman Jepun with size of 1,500 sq.m.



## Virtual Event Solutions

BNDCC's Virtual Event Solutions reinvent your events by providing a safe space to host your virtual meetings.

We offer an end-to-end solution with our Event Services, Audio Visual and Information and Communication Technology teams to bring your event to life with the flexibility of hosting your delegates onsite while streaming live to your online delegates in a virtual format.

## OUR SERVICES

We pride ourselves on our excellent team, whose diverse range of skills, matched with our flexible facility, combine to give all the requirements you need to deliver a world-class event. BNDCC offers a broad range of services, which can be tailor-made to suit your needs.

In addition to our services, we offer solutions to reinventing your events by providing a safe space to host your virtual meetings.





## Event Services

Our experienced Event Services will assist you in planning and managing your event with a first-rate service to deliver a successful event.



## Food & Beverage

From a business luncheon of 10 to buffets for 5,000 or a gala dinner of 2,500, we will provide an exquisite dining experience. BNDCC has successfully hosted head of states gala dinner, welcome receptions for international corporate meetings, association conventions and many other social events.

BNDCC also provide outside catering service, created especially to deliver cuisine of the highest quality for any event in Bali.



## VIP Room

With exquisite and well crafted interior design, our VIP Room can facilitate specific arrangements for dignitary guests, bilateral and one-on-one meetings.



## Technical Services

Our facility is complete with state-of-the-art equipment in every room, full coverage Wi-Fi of more than 300 access points, advanced communications, IT solutions and integrated fiber optic connectivity. Our highly trained manager will assist you with your technical requirements, including AV, staging, sound, digital signage, presentation equipment and technical expertise.



## Ample Car Space, Security and Safety

BNDCC provides a large and easily accessible parking area onsite with 400 parking space for cars and buses.

With a combination of advanced technology and trained security personnel, we can provide high-level security arrangement at any event.



## Café and Lounge

Jimbaran Cafe and Seminyak Lounge are the ideal spots for delegates to unwind and explore our international cuisine between sessions. The cafe and lounge serves a choice of a la carte and buffet menus.



## Bonded Warehouse

An on-site Bonded Warehouse facility is available for fast and safe custom clearance for temporary imported exhibition goods and equipment. This service guarantees the convenient and professional import and re-export of exhibition and convention goods through our official freight forwarders.

# SPACE IN FIGURES - BNDCC 1

FUNCTION ROOM	DIMENSION			FLOOR AREA		CAPACITIES				
	METRES (L x W x H)			SQ.M	SQ. FT	THEATRE	CLASSROOM	U SHAPE	ROUND TABLE	RECEPTION
<b>GROUND FLOOR</b>										
NUSA DUA	1	20.0 x 14.0 x 9.0	280	3,014	280	140	70	140	280	
	2	19.3 x 14.0 x 9.0	270	2,906	270	130	70	130	270	
	3	27.5 x 20.0 x 9.0	550	5,920	550	270	140	270	550	
	4	27.5 x 40.0 x 9.0	1,100	11,840	1,100	550	270	440	1,100	
	5	55.0 x 40.0 x 9.0	2,200	23,680	2,200	1,100	550	880	2,200	
	Hall	55.0 x 80.0 x 9.0	4,400	47,361	4,800	2,400	1,200	2,400	4,800	
	East Lobby	14.0 x 80.0 x 7.0	1,120	12,060						
	South Lobby	12.0 x 58.0 x 7.0	700	7,535						
East & South Lobby		1,820	19,590							
TAMAN SARI	1	7.3 x 7.6 x 3.1	55	592	60	30	15	30	60	
	2	7.3 x 7.6 x 3.1	55	592	60	30	15	30	60	
ULUWATU	1	12.0 x 16.2 x 3.1	195	2,099	200	100	50	100	200	
	2	12.0 x 7.7 x 3.1	92	990	100	50	25	50	100	
	3	12.0 x 7.7 x 3.1	92	990	100	50	25	50	100	
	4	12.0 x 7.7 x 3.1	92	990	100	50	25	50	100	
	5	16.2 x 14.4 x 3.1	236	2,540	240	120	60	120	240	
	6	7.7 x 14.4 x 3.1	110	1,184	120	60	30	60	120	
	7	16.2 x 14.4 x 3.1	236	2,540	240	120	60	120	240	
Lobby		480	5,167							
JIMBARAN	Lobby 1		752	8,094				150		
	Lobby 2		440	4,736				120		
OUTDOOR SPACE	Taman Jepun		1,479	15,920				500	1,000	
<b>MEZZANINE FLOOR</b>										
KINTAMANI	1	15.7 x 16.0 x 3.0	251	2,702	260	130	65	130	260	
	2	15.7 x 16.0 x 3.0	251	2,702	260	130	65	130	260	
	3	13.1 x 16.0 x 3.0	209	2,250	210	100	50	100	210	
	4	7.7 x 9.6 x 3.0	73	786	80	40	20	40	80	
	5	13.1 x 15.5 x 3.0	202	2,174	210	100	50	100	210	
	6	15.5 x 15.6 x 3.0	241	2,594	260	130	65	130	260	
	7	15.6 x 15.6 x 3.0	241	2,594	260	130	65	130	260	
	8	6.0 x 8.0 x 3.0	48	517	48	24	12	20	48	
	Lobby 1		352	3,789						
	Lobby 2		248	2,669						
Lobby 3		224	2,411							
<b>1<sup>ST</sup> FLOOR</b>										
SINGARAJA	1	39.5 x 20.2 x 6.8	799	8,600	800	400	200	350	800	
	2	39.5 x 23.3 x 6.8	920	9,903	920	460	230	400	920	
	Hall	43.9 x 39.5 x 6.8	1,734	18,665	1,750	875	438	870	1,750	
	Lobby 1		451	4,855						
	Lobby 2		429	4,618						
Lobby 3		360	3,875							
OUTDOOR SPACE	Singaraja Terrace	10.0 x 60.0 x 3.3	600	6,458				300	600	

Note: All Meeting Room capacities may require alteration depending on individual event

# FLOOR PLANS - BNDCC 1

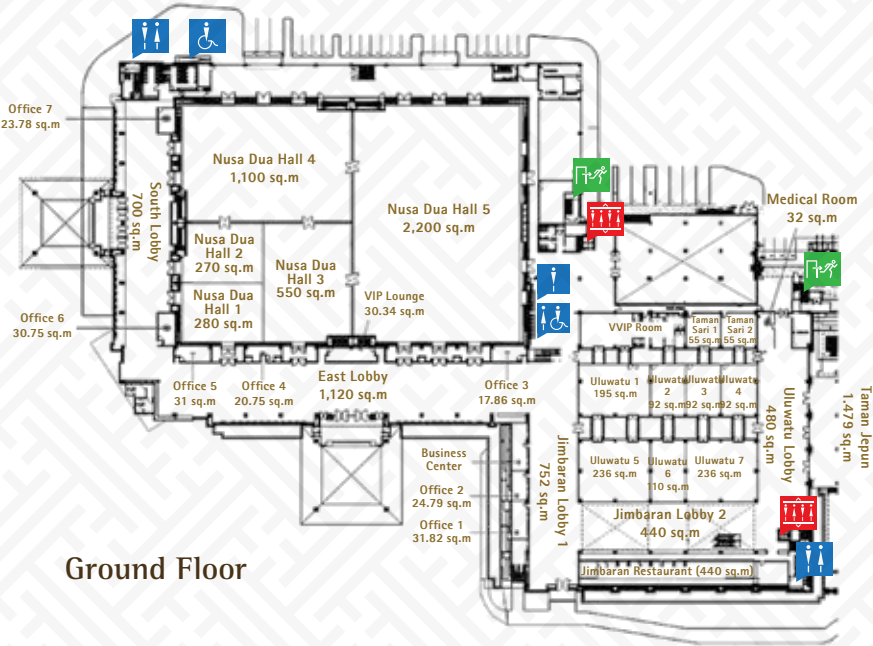

Ground Floor

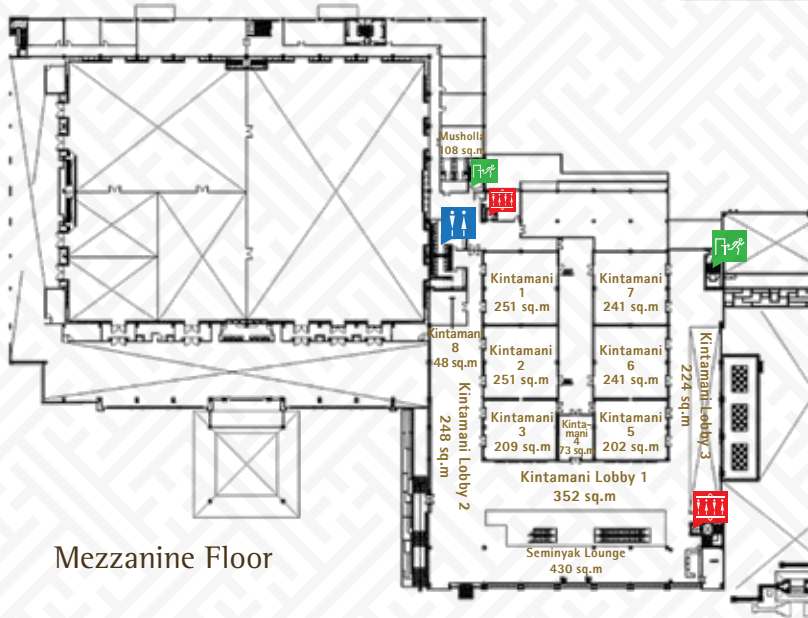

Mezzanine Floor

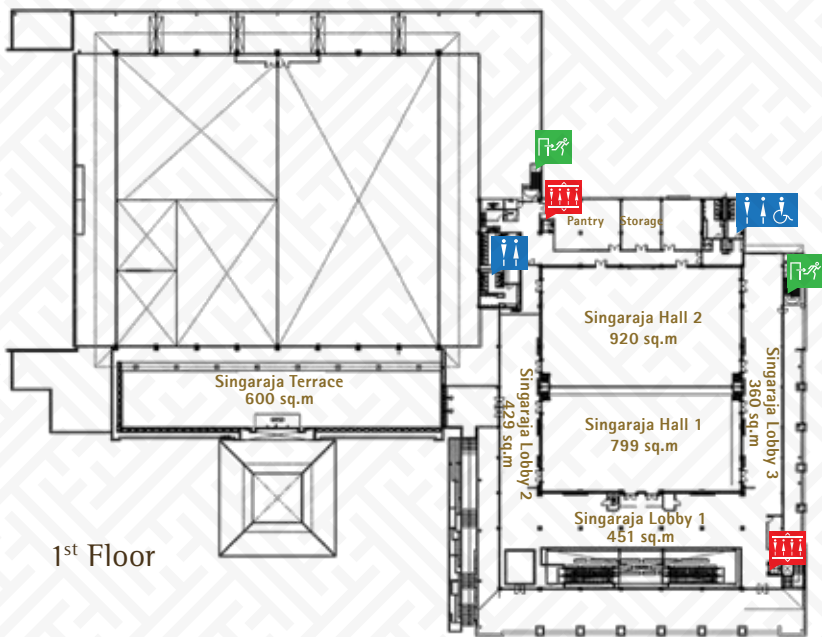

1st Floor

TOILET ELEVATOR EMERGENCY EXIT



# SPACE IN FIGURES - BNDCC 2

FUNCTION ROOM	DIMENSION			FLOOR AREA		CAPACITIES				
	METRES (L x W x H)			SQ.M	SQ. FT	THEATRE	CLASSROOM	U SHAPE	ROUND TABLE	RECEPTION
<b>GROUND FLOOR</b>										
PECATU	1	19.0 x 19.0 x 8.5		360	3,875	360	180	90	180	360
	2	19.0 x 19.0 x 8.5		360	3,875	360	180	90	180	360
	3	19.0 x 19.0 x 8.5		360	3,875	360	180	90	180	360
	5	19.0 x 19.0 x 8.5		360	3,875	360	180	90	180	360
	Hall 1,2	19.0 x 38.0 x 8.5		722	7,772	740	370	185	240	740
	Hall 3,5	19.0 x 38.0 x 8.5		722	7,772	740	370	185	240	740
	Pre-Function	38.7 x 7.3 x 8.5								
	Hall	46.6 x 38.0 x 8.5		1,770	19,052	1,800	900	450	900	1,800
Lobby			1,000	10,764						
MENGWI	1	10.8 x 7.5 x 4.0		81	872	85	43	22	40	85
	2	10.8 x 7.5 x 4.0		81	872	85	43	22	40	85
	3	10.8 x 7.5 x 4.0		81	872	85	43	22	40	85
	5	10.8 x 7.5 x 4.0		81	872	85	43	22	40	85
	6	10.8 x 7.5 x 4.0		81	872	85	43	22	40	85
	7	10.8 x 7.5 x 4.0		81	872	85	43	22	40	85
	8	10.8 x 7.5 x 4.0		81	872	85	43	22	40	85
	1,2	15.0 x 11.6 x 4.0		174	1,873	174	112	43	100	174
	3,5	15.0 x 11.6 x 4.0		174	1,873	174	112	43	100	174
	6,7	15.0 x 11.6 x 4.0		174	1,873	174	112	43	100	174
	7,8	15.0 x 11.6 x 4.0		174	1,873	174	112	43	100	174
	6,7,8	22.5 x 11.6 x 4.0		261	2,809	260	130	65	130	260
VIP Lounge	11.6 x 7.5 x 4.0		87	936						
<b>MEZZANINE FLOOR</b>										
LEGIAN	1	11.6 x 7.5 x 4.0		87	936	90	45	23	50	90
	2	11.6 x 7.5 x 4.0		87	936	90	45	23	50	90
	3	11.6 x 7.5 x 4.0		87	936	90	45	23	50	90
	5	11.6 x 7.5 x 4.0		87	936	90	45	23	50	90
	6	11.6 x 7.5 x 4.0		87	936	90	45	23	50	90
	7	11.6 x 7.5 x 4.0		87	936	90	45	23	50	90
	8	11.6 x 7.5 x 4.0		87	936	90	45	23	50	90
	9	11.6 x 7.5 x 4.0		87	936	90	45	23	50	90
	1,2	15.0 x 11.6 x 4.0		174	1,873	174	112	43	100	174
	3,5	15.0 x 11.6 x 4.0		174	1,873	174	112	43	100	174
	6,7	15.0 x 11.6 x 4.0		174	1,873	174	112	43	100	174
	8,9	15.0 x 11.6 x 4.0		174	1,873	174	112	43	100	174
	Lobby			210	2,260					
	Balcony	11.5 x 10.0 x 3.5		115	1,238					
<b>1<sup>ST</sup> FLOOR</b>										
TANJUNG BENOA	Hall	32.0 x 28.8 x 5.0		920	9,903	920	460	230	460	920
	Lobby			252	2,713					

Note: All Meeting Room capacities may require alteration depending on individual event



# FLOOR PLANS - BNDCC 2



Ground Floor

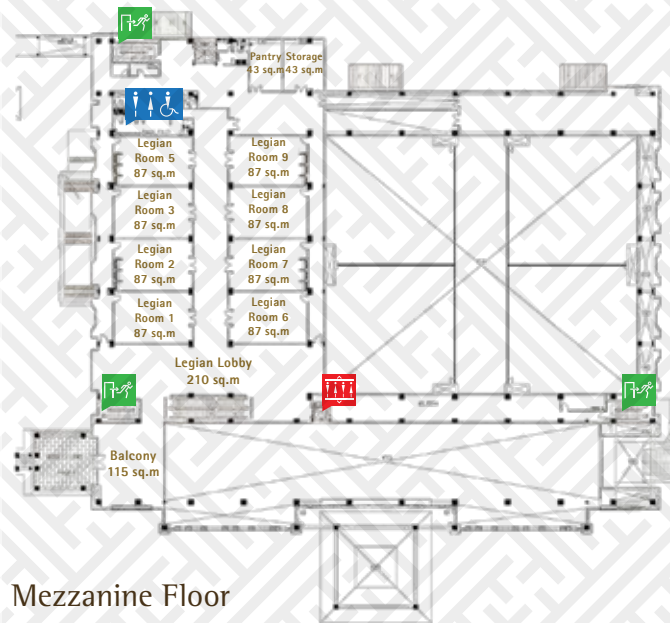

Mezzanine Floor

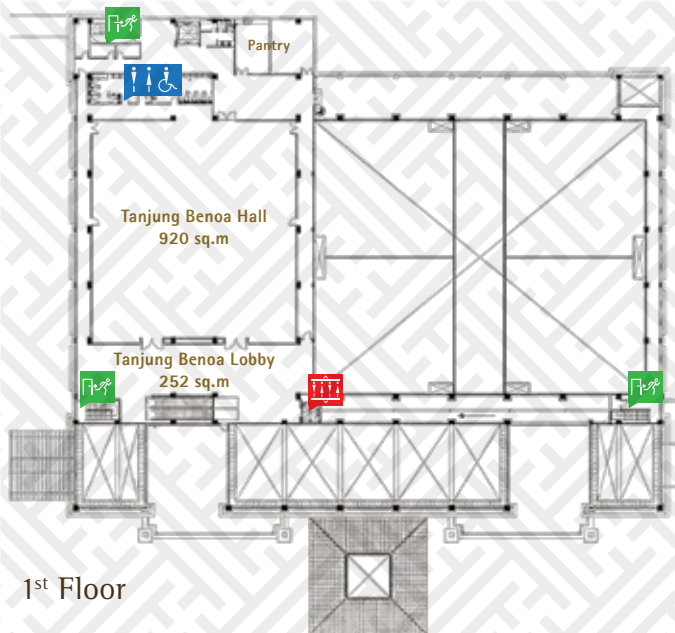

1st Floor

TOILET 
 ELEVATOR 
 EMERGENCY EXIT



GLOBAL ECONOMIC CHALLENGES AND MULTILATERAL SOLUTIONS

2014 Indonesia





# AN ON-SITE 5-STAR HOTEL

Bali Nusa Dua Hotel which has a direct access to our convention center is the ideal choice for event delegates to relax in lavish luxury and enjoy the unique combination of Balinese charm and traditional service.

## LOCATION

BNDCC is located at the very epicenter of Bali's premier luxury destination—the Nusa Dua ITDC complex, extravagantly developed by the Indonesia Tourism Development Corporation. This multi-million dollar complex hosts 19 of the world's leading 5 star hotel brands offering a combined 7,500 opulent rooms, the acclaimed Bali National Golf Club, an international hospital, a performing arts theatre, galleries, temples and an array of enticing dining options will leave guests spoilt for choice. Seamless white-sand beaches, stunning natural landscape and spectacular limestone cliffs make for a photographer's wonderland.



# HOTELS NEAR BNDCC

5 STARS HOTEL	WEBSITE	PHONE
Bali Nusa Dua Hotel	<a href="http://www.balinusaduahotel.com">www.balinusaduahotel.com</a>	+62 361 8498833
Nusa Dua Beach Hotel & Spa	<a href="http://www.nusaduahotel.com">www.nusaduahotel.com</a>	+62 361 771210
Sofitel Bali Nusa Dua Beach Resort	<a href="http://www.sofitel.com/Bali/Nusa-Dua">www.sofitel.com/Bali/Nusa-Dua</a>	+62 361 8492888
The Westin Resort Bali	<a href="http://www.westinnusaduabali.com">www.westinnusaduabali.com</a>	+62 361 771906
The Laguna Resort & Spa Bali	<a href="http://www.thelagunabali.com">www.thelagunabali.com</a>	+62 361 771327
Melia Bali	<a href="http://www.melia.com">www.melia.com</a>	+62 361 771510
Grand Hyatt Bali	<a href="http://www.bali.grand.hyatt.com">www.bali.grand.hyatt.com</a>	+62 361 771234
Amarterra Villas	<a href="http://www.amarterravilla.com">www.amarterravilla.com</a>	+62 361 776400
Inaya Putri Bali	<a href="http://www.inayaputribali.com">www.inayaputribali.com</a>	+ 62 361 774488
Club Med Bali	<a href="http://www.clubmed.co.id">www.clubmed.co.id</a>	+62 361 771521
Ayodya Resort Bali	<a href="http://www.ayodyaresortbali.com">www.ayodyaresortbali.com</a>	+62 361 771102
The St. Regis Bali Resort	<a href="http://www.stregisbali.com">www.stregisbali.com</a>	+62 361 8478111
The Mulia Hotels & Resorts	<a href="http://www.themulia.com">www.themulia.com</a>	+62 361 3027777
Hilton Bali Resort	<a href="http://www3.hilton.com">www3.hilton.com</a>	+62 361 773377
The Bale	<a href="http://www.thebale.com">www.thebale.com</a>	+62 361 775111
The Royal Santrian	<a href="http://www.theroyalsantrian.com">www.theroyalsantrian.com</a>	+62 361 778181
Conrad Bali	<a href="http://www.conradbali.com">www.conradbali.com</a>	+62 361 778788
Courtyard by Marriott	<a href="http://www.marriott.com">www.marriott.com</a>	+62 361 3003888

4 STARS HOTEL	WEBSITE	PHONE
Grand Whiz Hotel	<a href="http://www.grandwhiz.com">www.grandwhiz.com</a>	+62 361 8498020
Novotel Bali Nusa Dua	<a href="http://www.novotelnusaduabali.com">www.novotelnusaduabali.com</a>	+62 361 8480555
Sol Beach House Benoa Bali	<a href="http://www.melia.com">www.melia.com</a>	+62 361 771714
Grand Aston Bali Beach Resort	<a href="http://www.grandastonbali.com">www.grandastonbali.com</a>	+62 361 773577
Novotel Bali Benoa	<a href="http://www.novotelbalibenoa.com">www.novotelbalibenoa.com</a>	+62 361 772239
Mercure Nusa Dua	<a href="http://www.mercurebalinusadua.com">www.mercurebalinusadua.com</a>	+62 361 8467000

3 STARS HOTEL	WEBSITE	PHONE
Hotel Santika Siligita Nusa Dua	<a href="http://www.santika.com">www.santika.com</a>	+62 361 8465777
The Benoa Beach Front Villa & Spa	<a href="http://www.thebenoavillas.com">www.thebenoavillas.com</a>	+62 361 771634
Goodway Hotel & Resort	<a href="http://www.goodwaybali.net">www.goodwaybali.net</a>	+62 361 773808
Swiss Belhotel Segara Nusa Dua	<a href="http://www.swissbelhotel.com">www.swissbelhotel.com</a>	+62 361 8468288



# ENVIRONMENTALLY FRIENDLY PRACTICES

BNDCC not only features beautiful 'Green' surroundings with natural light and maximized ventilation, but has also established strategies for controlling air quality. This includes prohibiting smoking in all building area which has resulted in enhanced air quality at our venue.

We take pride in our commitment to incorporate sustainable practices in all our business operations. Our environmentally friendly practices include:

## A. Green Surroundings:

- 45,000 sqm greenery landscape
- Diversity of tropical species plants
- Conserving native plant office activities

## B. Energy Saving:

- Strategic layout to incorporate natural light into the building
- Double skin façade for enhanced passive cooling
- 24°AC temperature - will be adjusted due to weather conditions
- LED lighting system
- Elevator for delegates with disability

## C. Eco Friendly Food Management:

- Use of fresh, local and seasonal ingredients
- Overstock food donated to the local foundations

## D. Save Water:

- Automatic infrared sensor touchless faucet
- Graywater for watering garden plants
- Reverse Osmosis water treatment system
- Use of water dispenser and pouring water for delegates, no plastic bottles

## E. Waste Management:

- Garden waste recycled into compost
- Selected organic waste donated to local farm for livestock feed
- Selected organic waste turns into eco enzyme
- Reduce the use of papers and plastics especially in food & beverage serving; in events & internal office activities
- Digital signages on each rooms to replace printed paper signage
- Separate dustbins for paper waste (paper and box materials), organic waste (food, leaf, flower) and inorganic waste (can, plastic)
- Temporary storage of hazardous and toxic substances
- Disposal of hazardous and toxic substances are managed by certified hazardous waste management services



Energy efficiency strategy by:





**Bali Nusa Dua**  
CONVENTION CENTER



Kawasan Terpadu ITDC NW/1  
Nusa Dua – Bali 80363  
Indonesia

T. +62 361 77 3000 • F. +62 361 77 8880 • E. [events@baliconventioncenter.com](mailto:events@baliconventioncenter.com)

Jakarta Sales Office  
Jl. Johar No.9 Menteng  
Jakarta 10350

T. +62 21 390 3825 • F. +62 21 392 3577 • E. [info@baliconventioncenter.com](mailto:info@baliconventioncenter.com)

[www.baliconventioncenter.com](http://www.baliconventioncenter.com)