

# CGL CASE STUDY

## CGL BUSINESS CHALLENGES

Founded in 1974, CGL offers planning, design, owners' representation, maintenance, and financing for justice facilities on a global scale. In the early 2010's CGL grew rapidly as several boutique architecture firms came together under the same name. Those firms' individual local IT infrastructures continued to work in silo disparate teams rather than on a unified company network. CGL struggled with technical issues such as collaborating across multiple offices in real-time and accessing files stored on the parent company servers.

CGL believed their forward-thinking firm would benefit from a cloud hosted solution. CGL engaged Advance2000 services after learning about their AEC project cloud offerings at a Revit User Group meeting that took place in Manhattan, NY. CGL piloted Advance2000's project cloud on a recently won project. CGL selected 10 BIM specialist team members to test the new system during the pilot phase. Over a 6-month period, the project grew in scope, demands, and resources. Advance2000 rapidly scaled to meet CGL's needs. By the end of the project, a full third of CGL's employed BIM specialists were working on the Advance2000 CGL project cloud, collaborating in real-time on a file nearly four times the anticipated size. Based on the escalating project demands, CGL quickly learned how well the solution met their needs and what to expect from Advance2000 long-term. CGL's Revit users found the high-performance and output capacity of the Advance2000 project cloud solution impressive. CGL chose Advance2000 as their permanent IT solution partner.

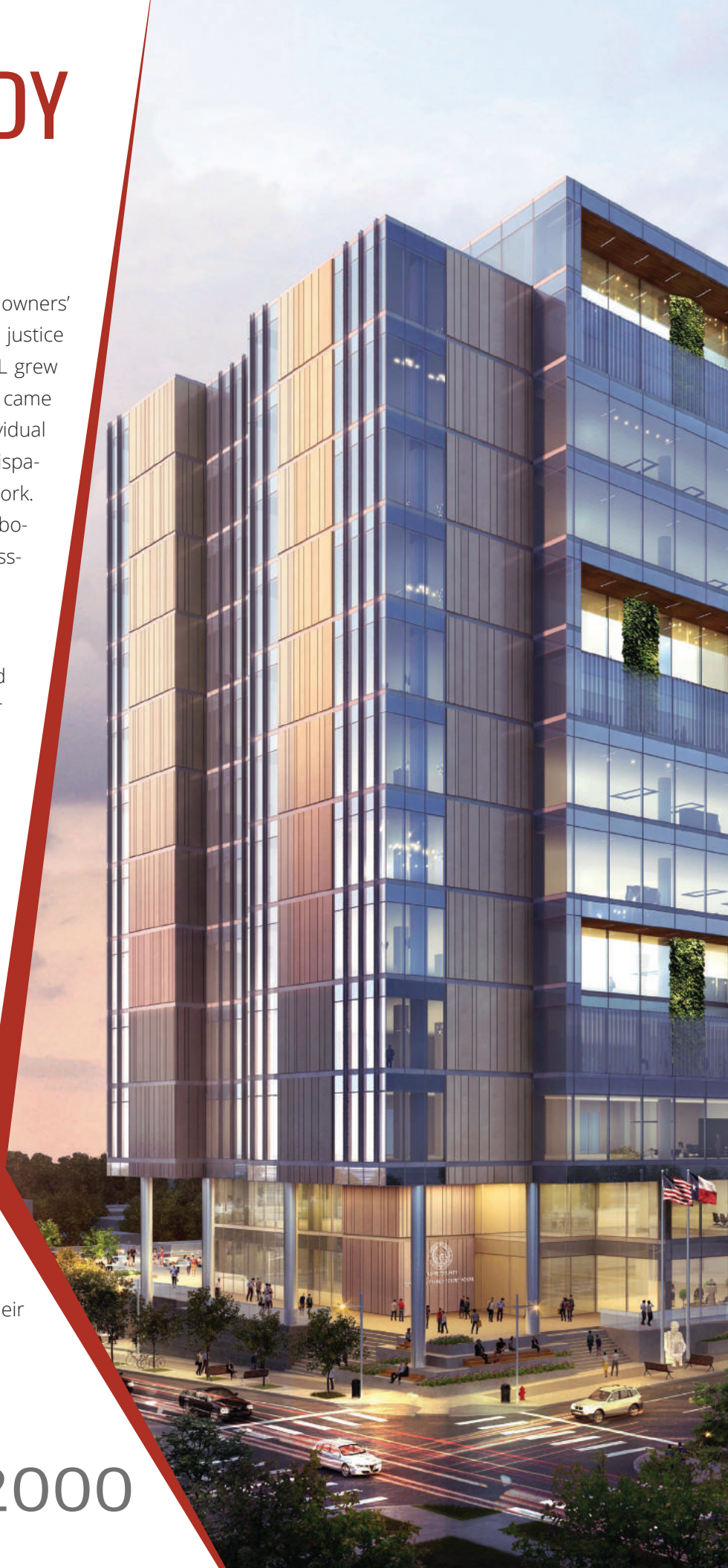

# CGL CASE STUDY



## PROJECT DEPLOYMENT EXPERIENCE

When the pilot was originally scoped, CGL chose expert Revit users who kept “open tech minds” during this experience. The tech-savvy specialists wanted to explore any possible issues that could arise on a cloud solution during a project of this size. The team identified hurdles and growing pains early which enabled both CGL BIM specialists and Advance2000 Solution Engineers to solve obstacles immediately. Even while testing an entirely new collaboration platform, the responsive collaboration between the two companies kept the project timeline on track.

Architect and BIM professional Andre Voss recalled there were “lessons learned, and the systems improved.” Our two companies were able to clearly identify needs, reach solutions, and smooth out any bumps in workflows and overall user experience. CGL experienced first hand that Advance2000 made certain their firm received the right solution to fit their needs rather than deliver a solution that CGL would have to figure out how to work in. The official roll out of the company wide infrastructure went extremely well. “I was even able to go on vacation on roll-out week without worrying,” Mr. Voss said, “and when I came back, everything was running as it should.”

**“We chose to continue our partnership with Advance2000 and increase our use and involvement due to the support and timely solutions provided to our staff.”**

-Robert Glass, AIA | Executive Vice President Director of Justice Services

## SOLUTIONS WITH ADVANCE2000

CGL utilizes Advance2000’s fully hosted virtual infrastructure, including both Advance2000 Enhanced and Designer Plus Virtual Desktops (VDIs) delivered using the VMware Horizon platform, over 6 TBs of storage, and a dedicated Firewall. CGL accesses this infrastructure both over secure, private point-to-point circuits from their main offices and over the public Internet from anywhere, including home offices and in the field. As of the time of this writing, Advance2000 had deployed 55 desktops. This was made up of 15 Enhanced Designer and 40 Q2 Designer Plus VDIs, and is in the process of implementing Advance2000 hosted VoIP telephony services (Cloud In-Touch) company wide, and migrating CGL’s email services into Office 365.

### COMPANY INFORMATION

SIZE  
250+ Employees

PORTFOLIO  
Justice Facilities

# ADVANCE2000

AGLASS@ADVANCE2000.COM | WWW.ADVANCE2000.COM/VDI-ADAM



# CGL CASE STUDY



## CGL'S FUTURE

Since signing with Advance2000 in late 2015, CGL's project pipeline has filled and surpassed their initial computing resource needs. Their Advance2000 virtual desktops enable BIM professionals to work on heavier models, collaborate more effectively in real-time, and render more efficiently. The ever growing size and scope of the projects has demanded much of CGL's desktops and graphics cards, however, a call to Advance2000 immediately grants the computing resources to scale with their workflow. CGL can now bid on all projects they desire and feel confident their infrastructure and project cloud will support them. In addition to working in the project cloud, CGL uses Advance2000 to augment parent-company Hunt's IT department. Advance2000 is currently networking Hunt's existing legacy system to CGL's virtual infrastructure and hosts their phone system.

## HAWAII WOMEN'S COMMUNITY CORRECTIONS CENTER EXPANSION

Currently CGL is hosting the Hawaii Women's Community Corrections Center expansion (56,000 SF; \$42m) on the Advance2000 project cloud, expected to be completed by 2022. As of the time of this publication, CGL has developed the space program, concept floor plans, and exterior renderings. Groundbreaking will begin soon.



## TRAVIS COUNTY CIVIL AND FAMILY COURTS FACILITY

CGL is also serving as the lead Court Designer for the Travis County Civil and Family Courts Facility in collaboration with the lead architect Gensler. This project will bring together multiple disciplines to collaborate in our project cloud in real-time as they design and deliver this 430,000 SF facility. The project stakeholders will need to finalize 25 courtrooms, a short-term child drop-off center, a state of the art law library, attorney-client conference rooms, and many more purpose-driven spaces. CGL knows Advance2000 will support the needs this project will demand.



## REASONS CGL PARTNERS WITH ADVANCE2000

Mr. Voss pointed out that every endeavor has its challenges, and so did this. "No one should go into a switch up of IT systems and expect it to be smooth. There will be roadblocks; there will be things that need to be resolved." What matters in these situations is whether the IT partner will be accountable. "By and large, Advance2000 has been very responsive, very quick, helpful, and engaged." CGL looks forward to their continued business growth focused on justice facilities, and Advance2000 is honored to support them in those efforts.

# ADVANCE2000

AGLASS@ADVANCE2000.COM | WWW.ADVANCE2000.COM/VDI-ADAM

