

NEW YORK BUILD 2024 EXPO

JOIN MY SESSION AT THE LEADING CONSTRUCTION & DESIGN SHOW FOR NEW YORK

FEB 13-14
JAVITS CENTER

ARCHITECTURE & DESIGN WORKSHOP

Vijo Cherian, AICP
Associate Principal
Perkins Eastman

The Love of Walking, and, The Defining Measure of Cities

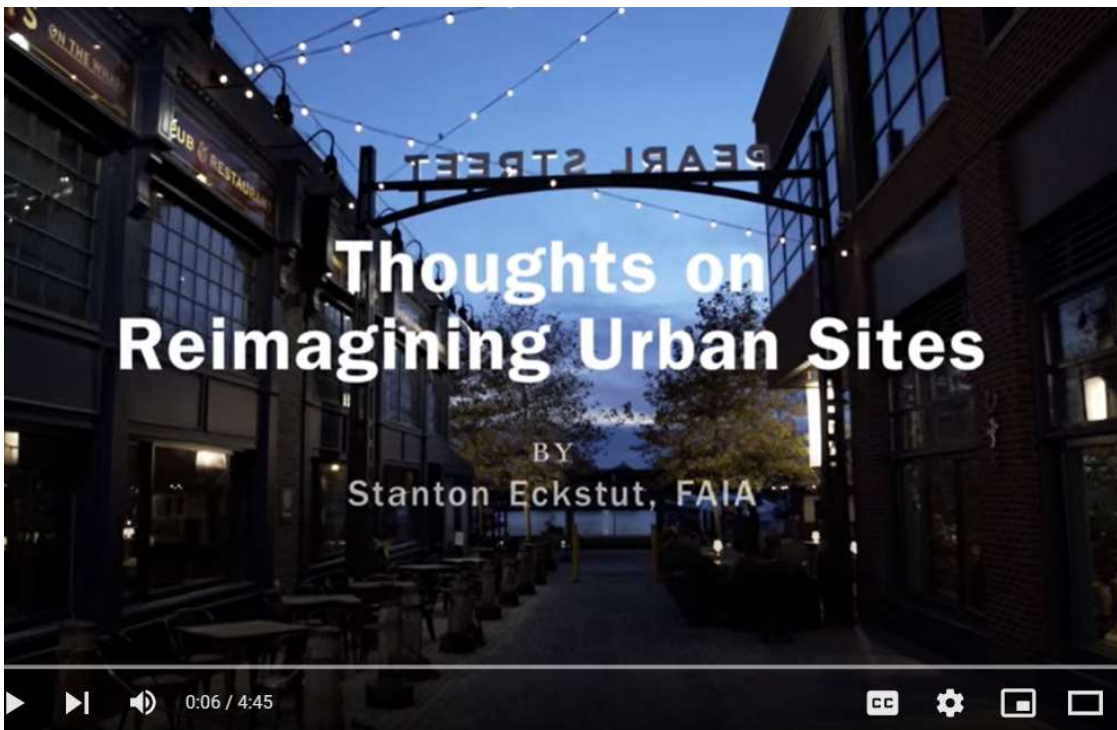

A video produced by the Pittsburgh History & Landmarks Foundation



Understanding design principles of walkable districts through recent large-scale projects at Perkins Eastman



Thoughts on Reimagining Urban Sites

BY
Stanton Eckstut, FAIA



Downsvew Hangar District



FC Cincinnati Soccer Village



Haverhill Waterfront

Walkable Districts



Fordham Landing



Historic Gas Plant District

Key Principles

- A district where people need to, and want to walk.
- Small human scale promotes more walking.
- Ground floor emphasis.
- Place for all seasons, day and night, seven days a week.
- Shared streets for more pedestrian amenities with vehicle convenience.
- Walkable architecture to emphasize the public realm.



Learning from the District Wharf

Downsview Media District

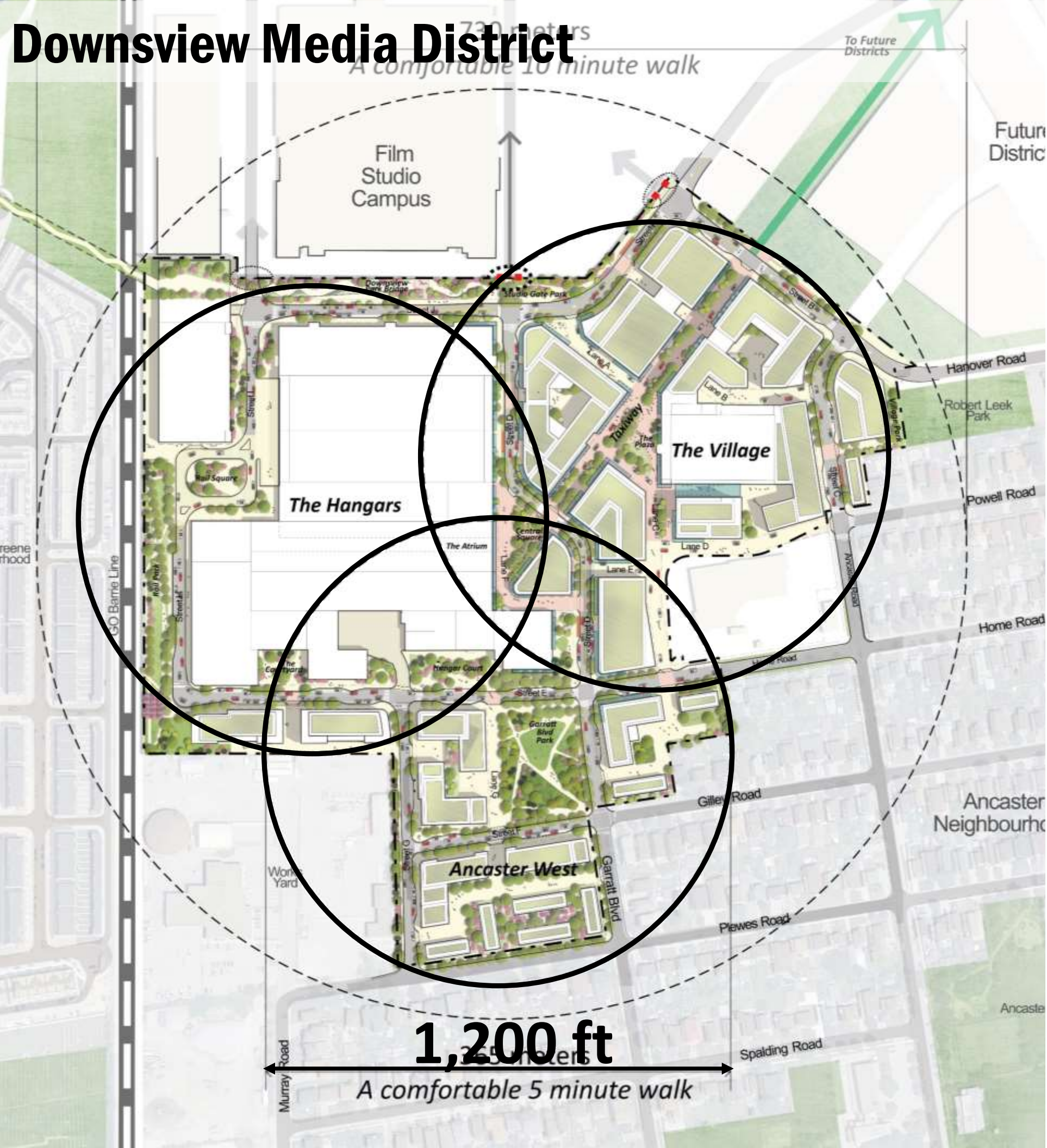

Fordham Landing North: Pedestrian Plan

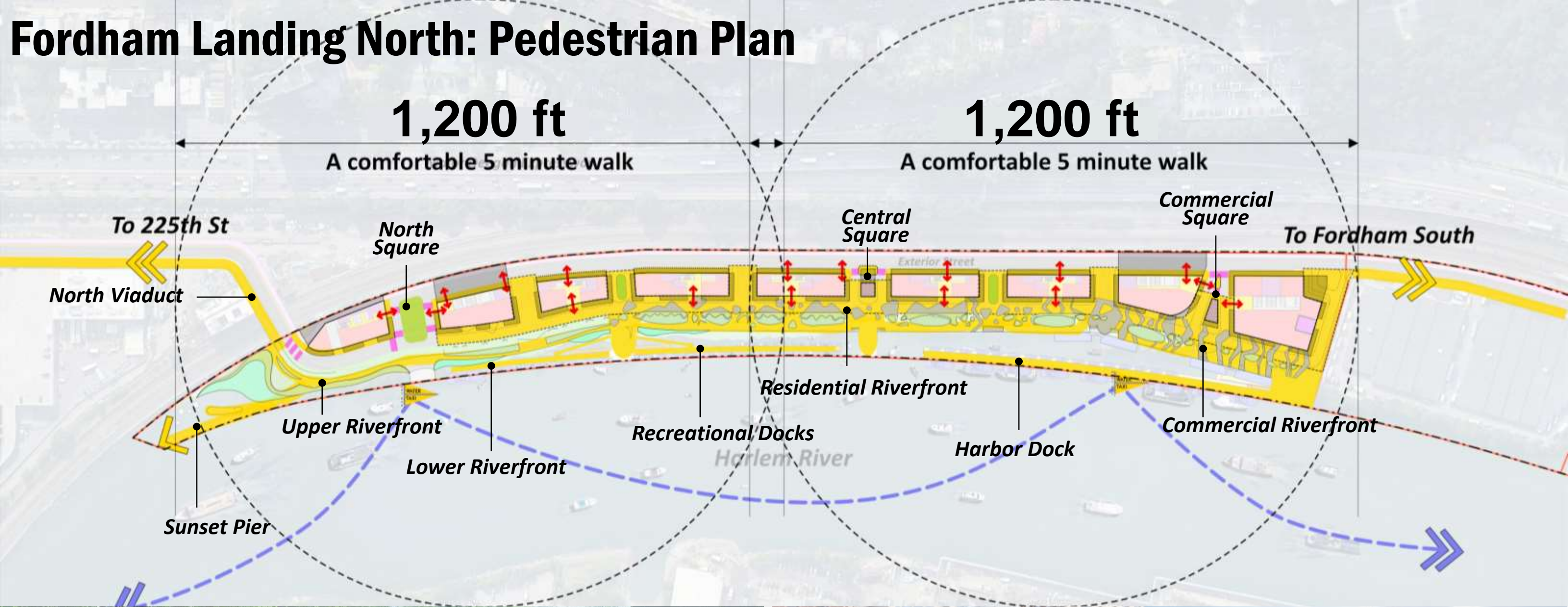

Haverhill Waterfront

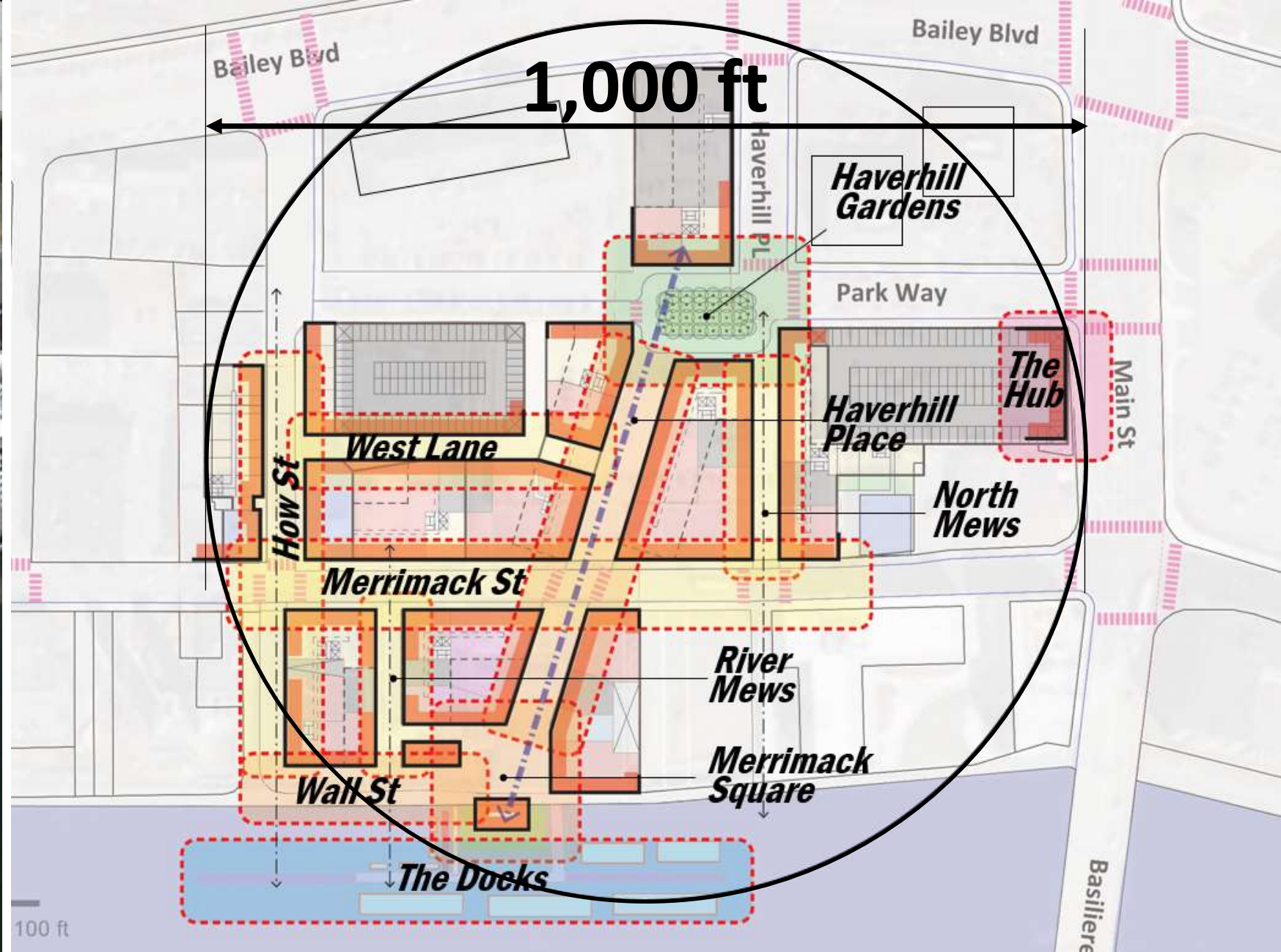

FC Cincinnati Soccer Village

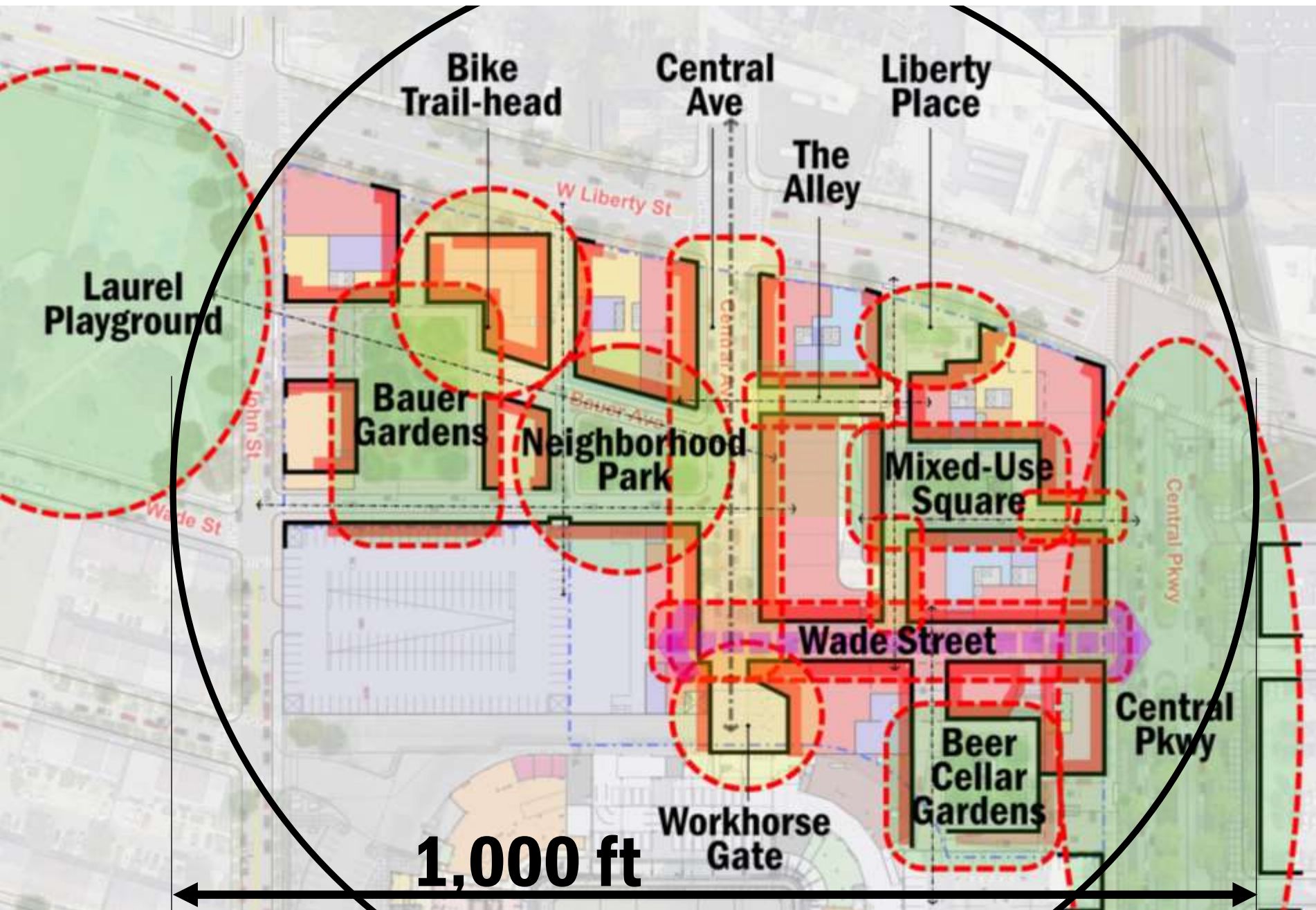

The Mixed Use Square

Central Ave

Wade St

82 ft

145 ft

Yacht Club Square, Wharf DC



Covent Garden, London

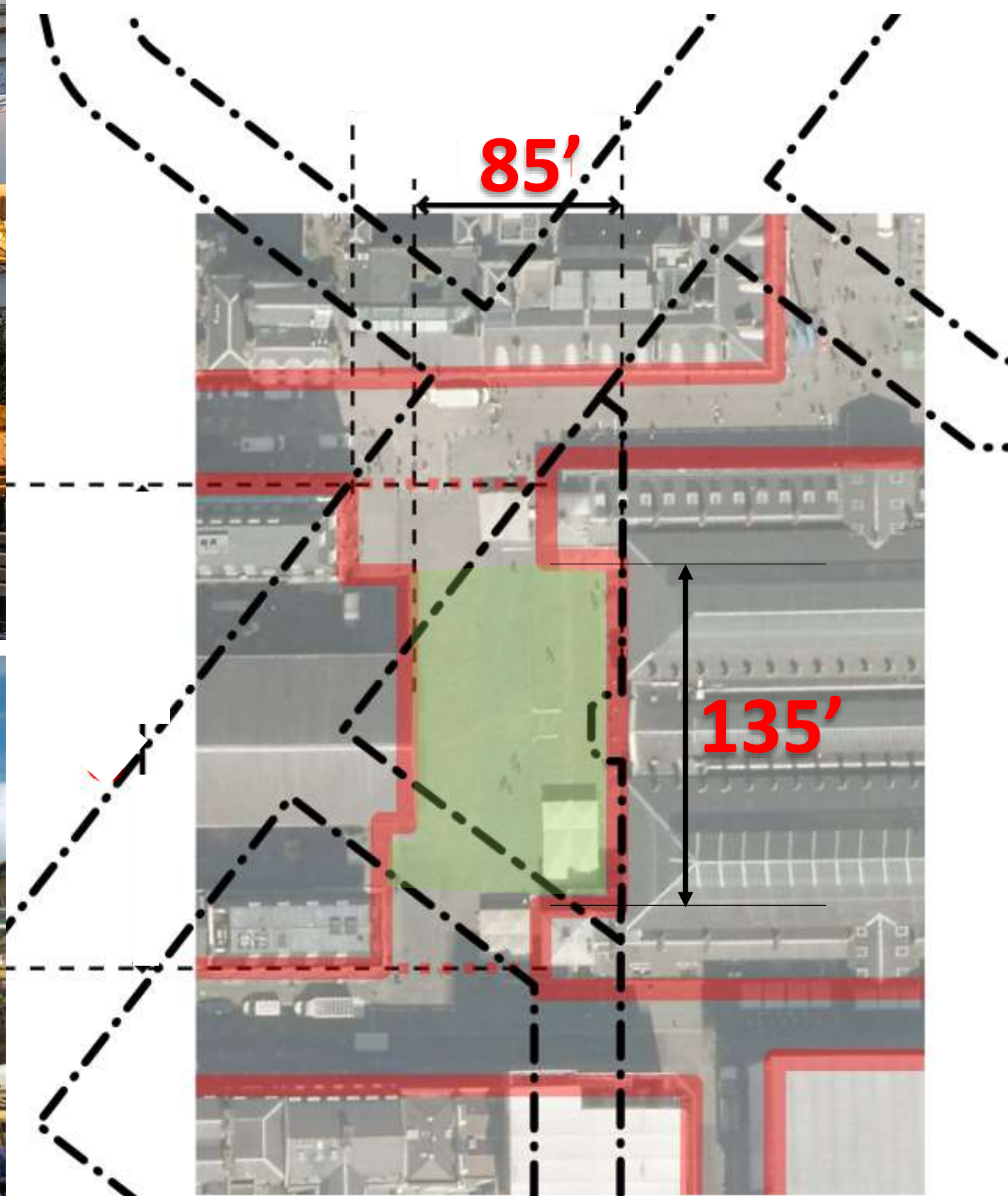

Cady's Alley



A Variety of Places

All within a 10 minute walk

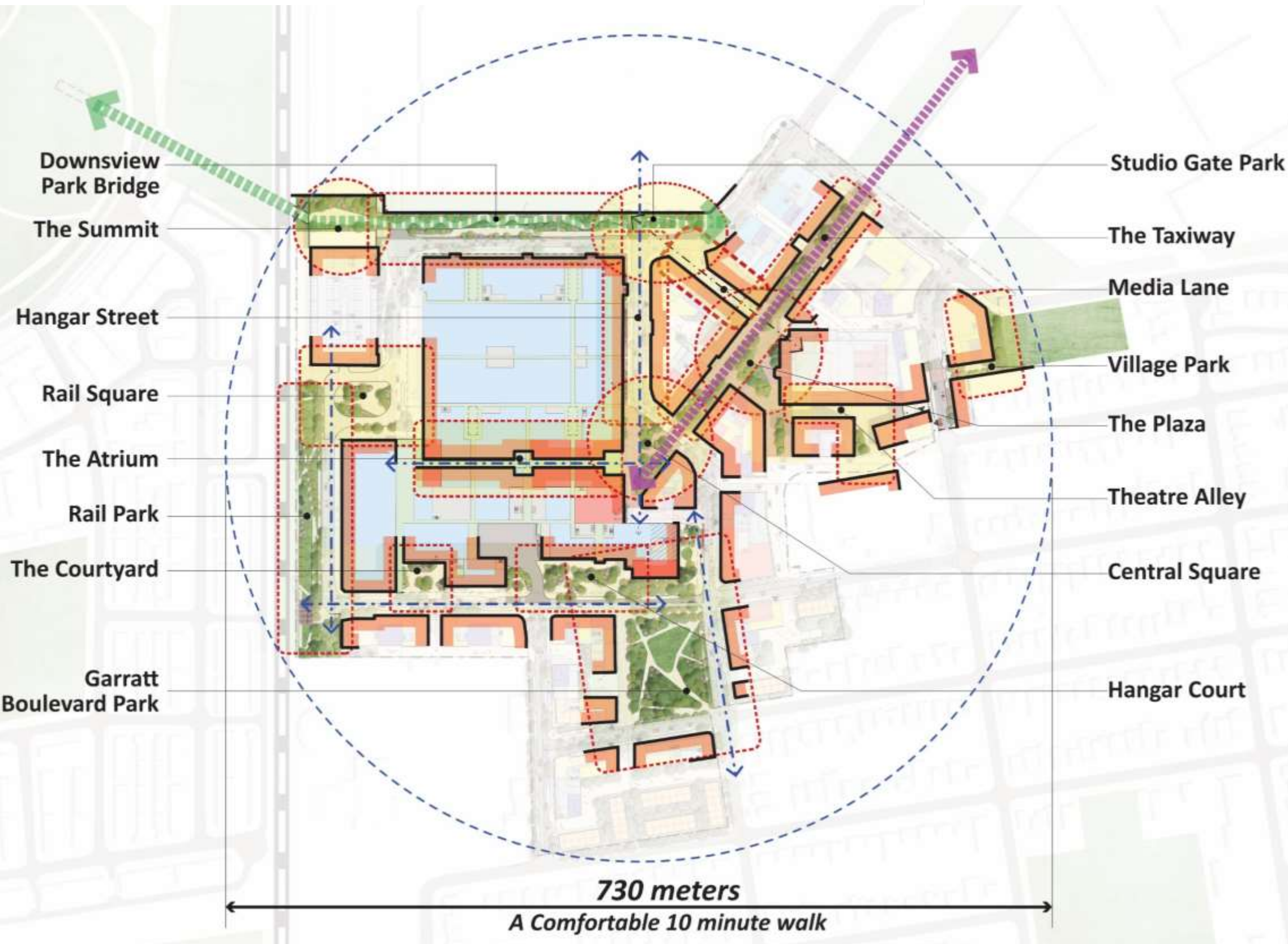

Ground Floor Emphasis

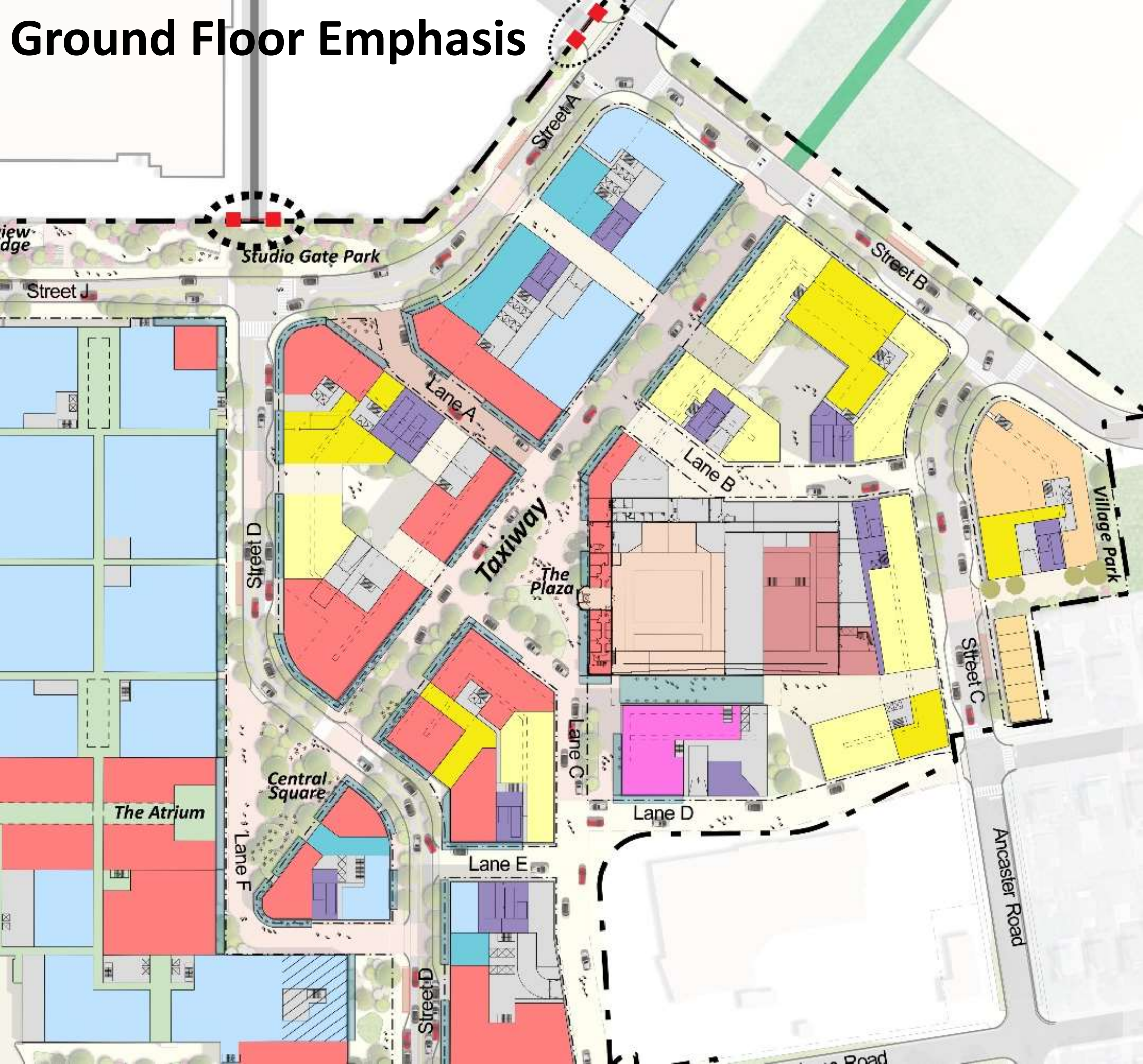

Ground Floor Emphasis



The Ground Floor Plan

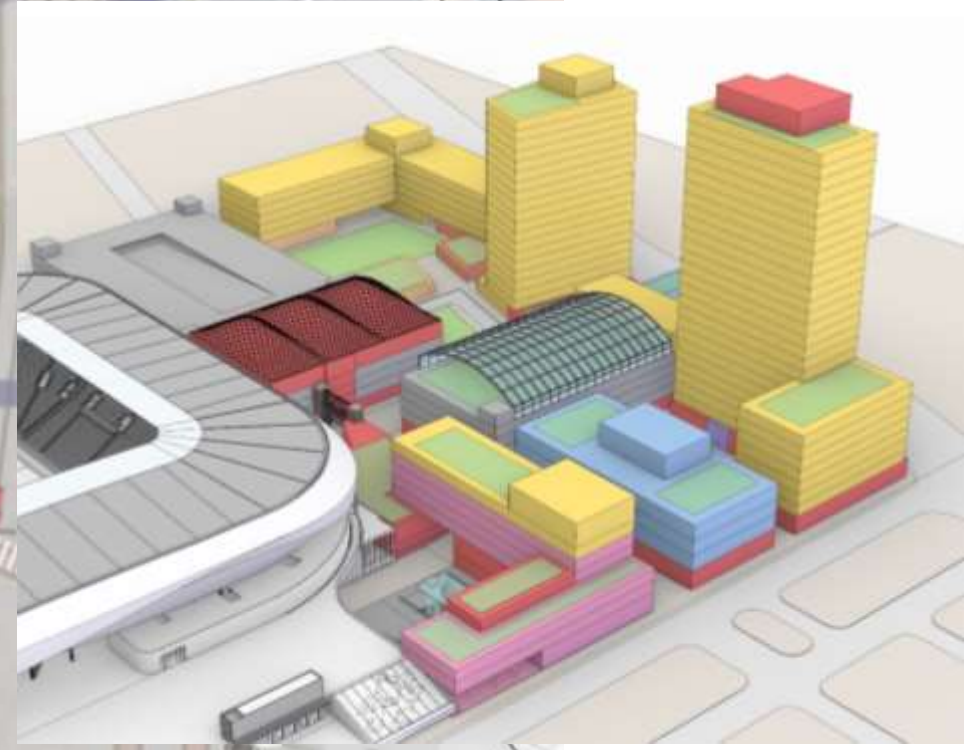
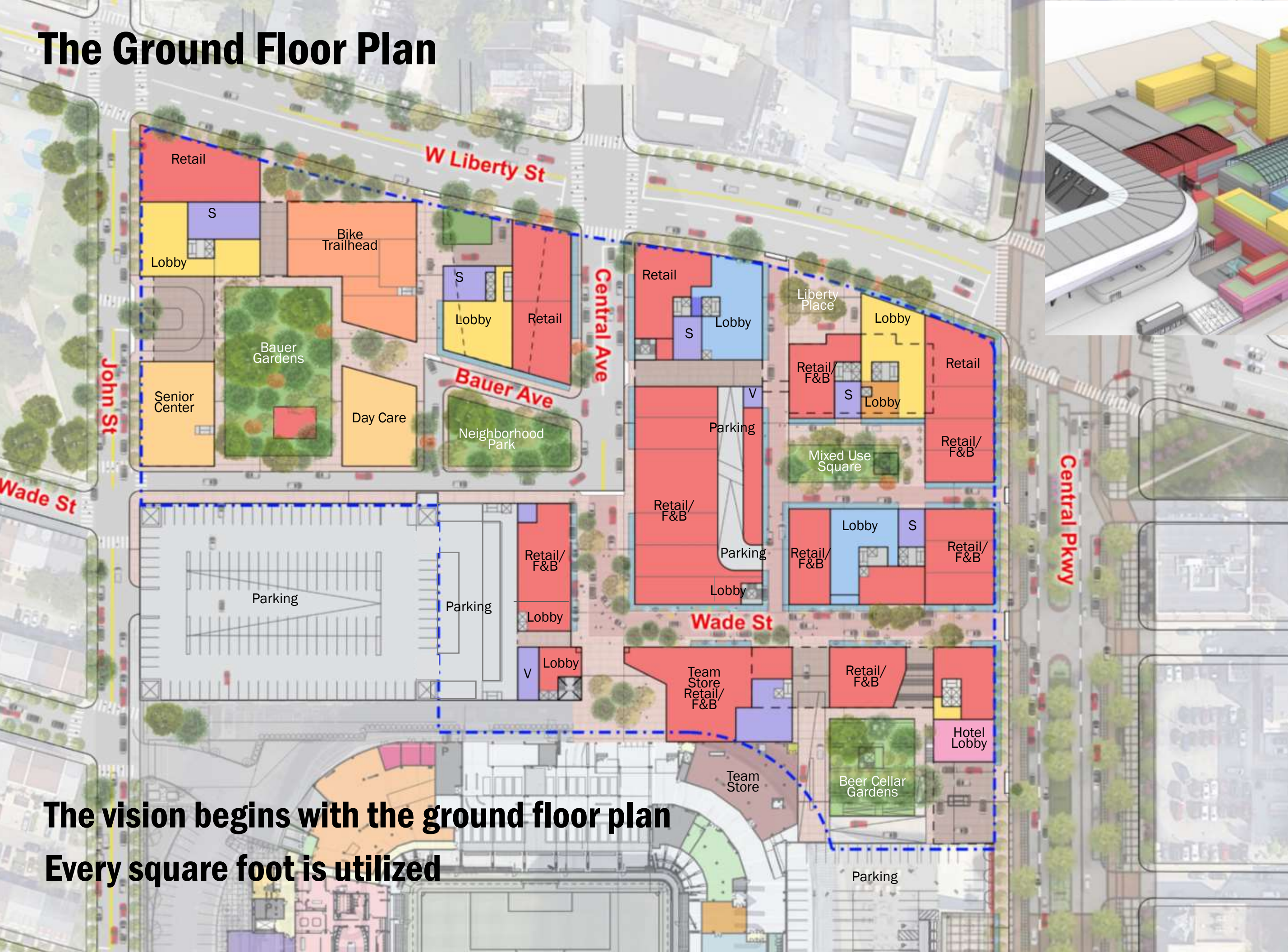

The vision begins with the ground floor plan
Every square foot is utilized

For all seasons, day and night



Canopies for weather protection

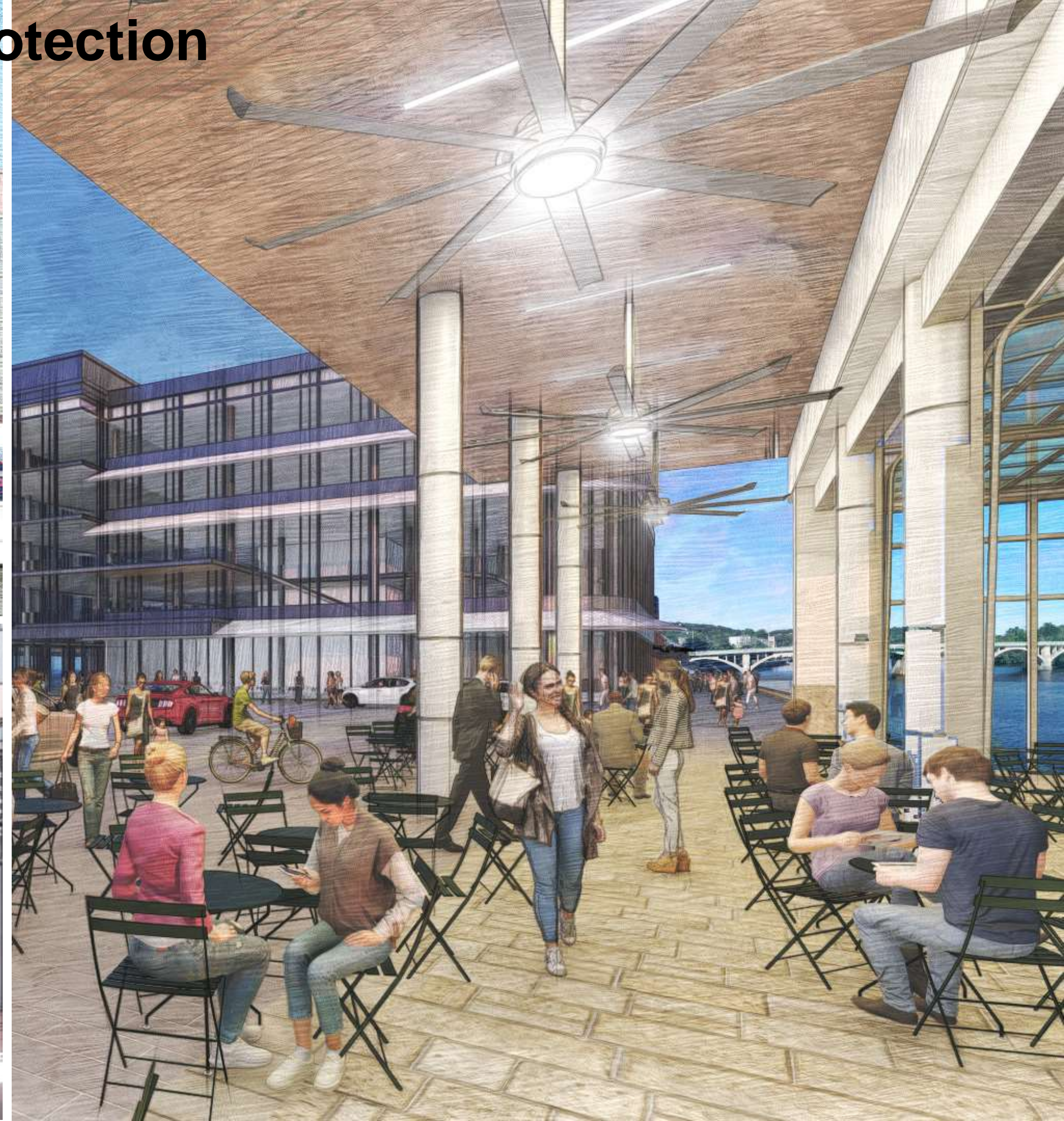

Shared Streets



Shared Streets

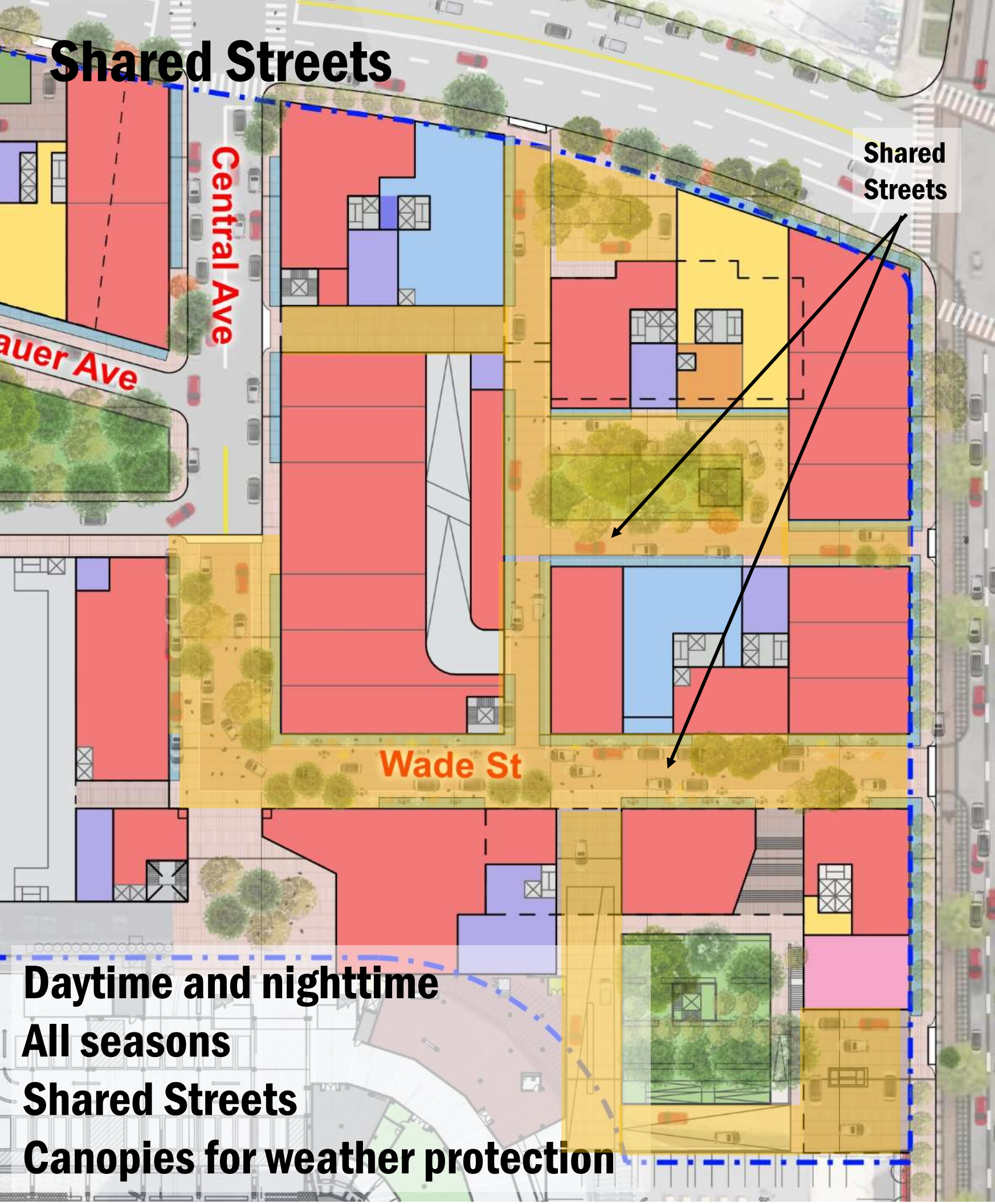

Vehicular Circulation: Normal Day

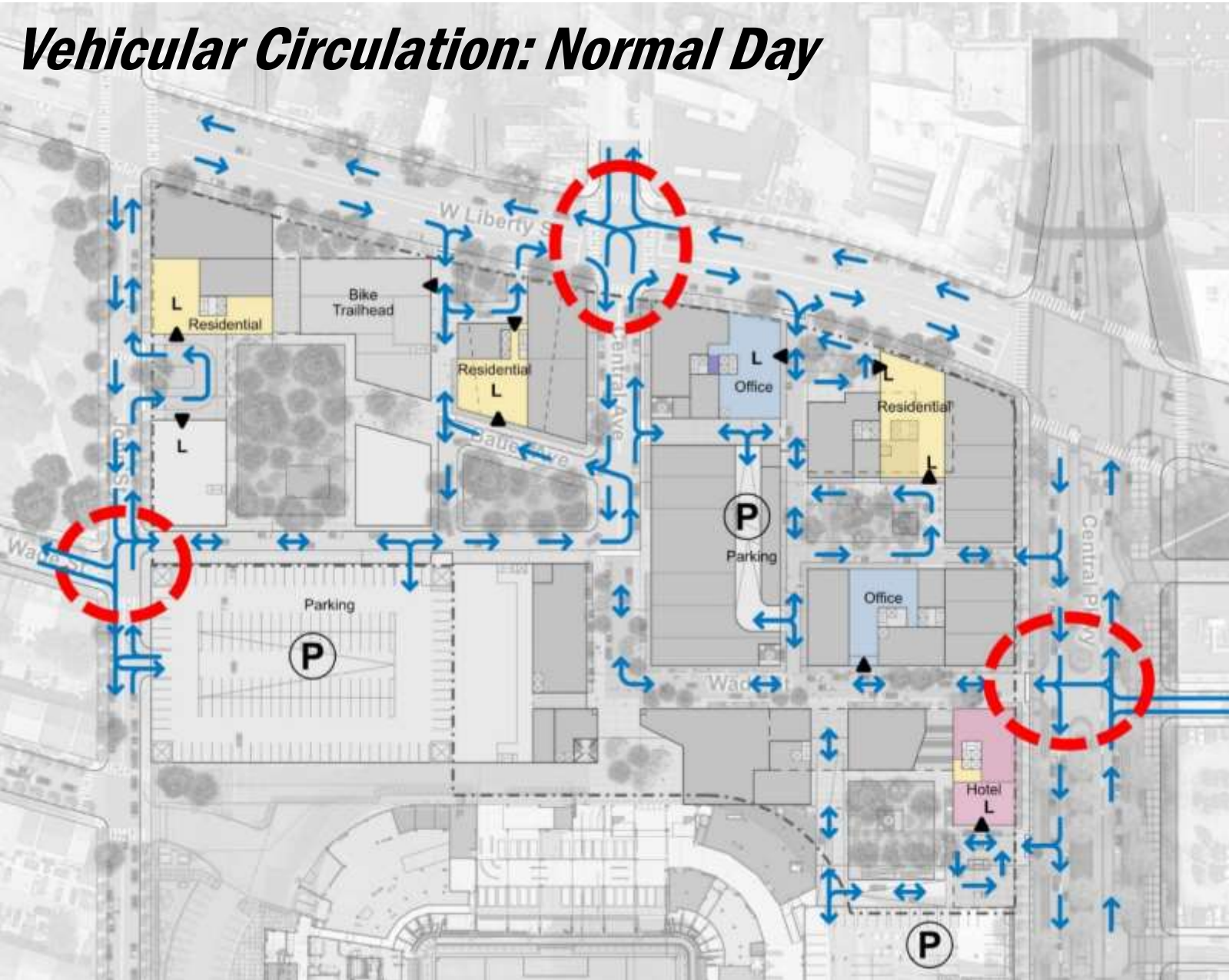

Vehicular Circulation: Game Day

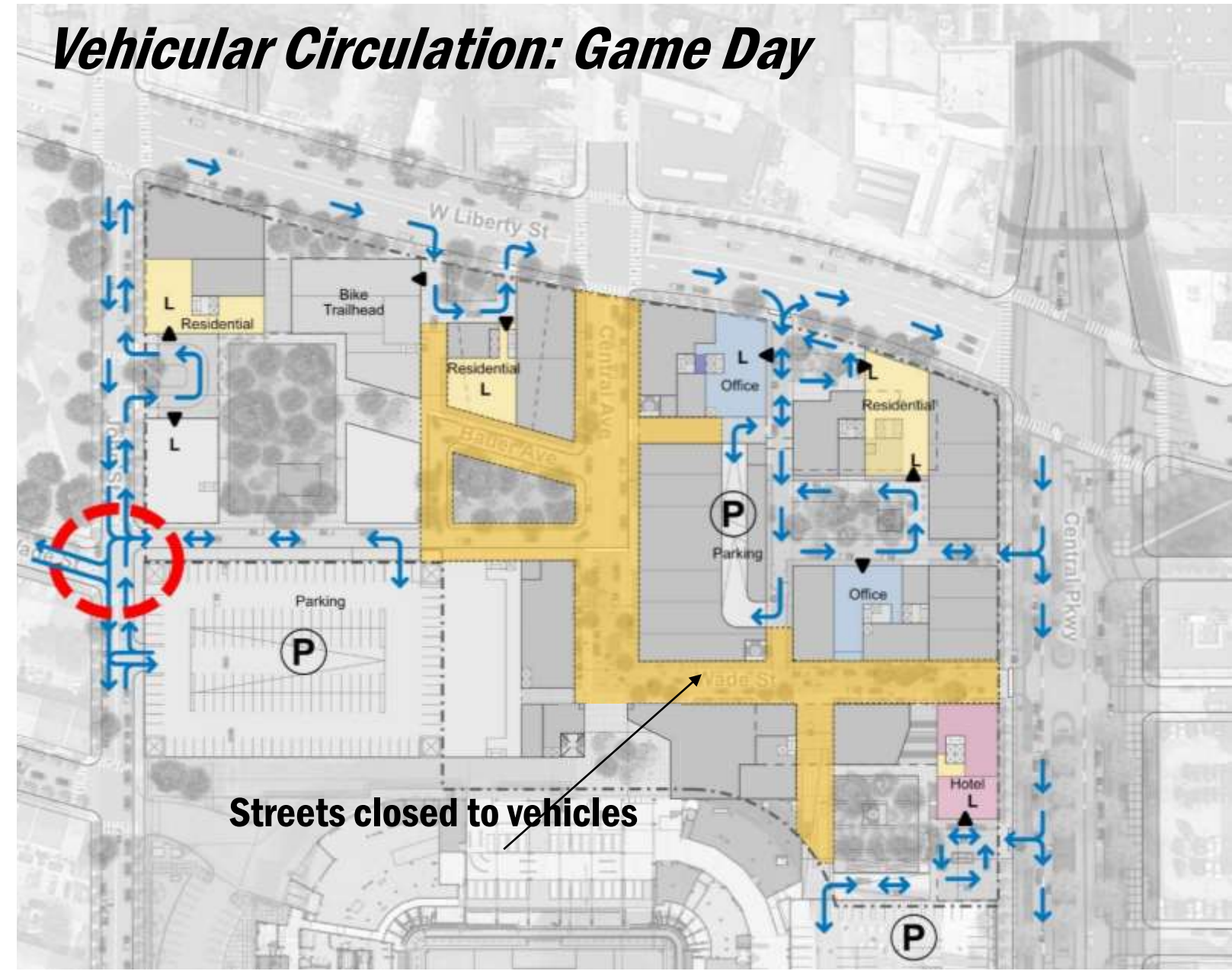

Auto Convenience

- Valet
- Uber
- On Street Parking
- Drop Offs
- Porte Cochere
- Shuttle



Walkable Architecture

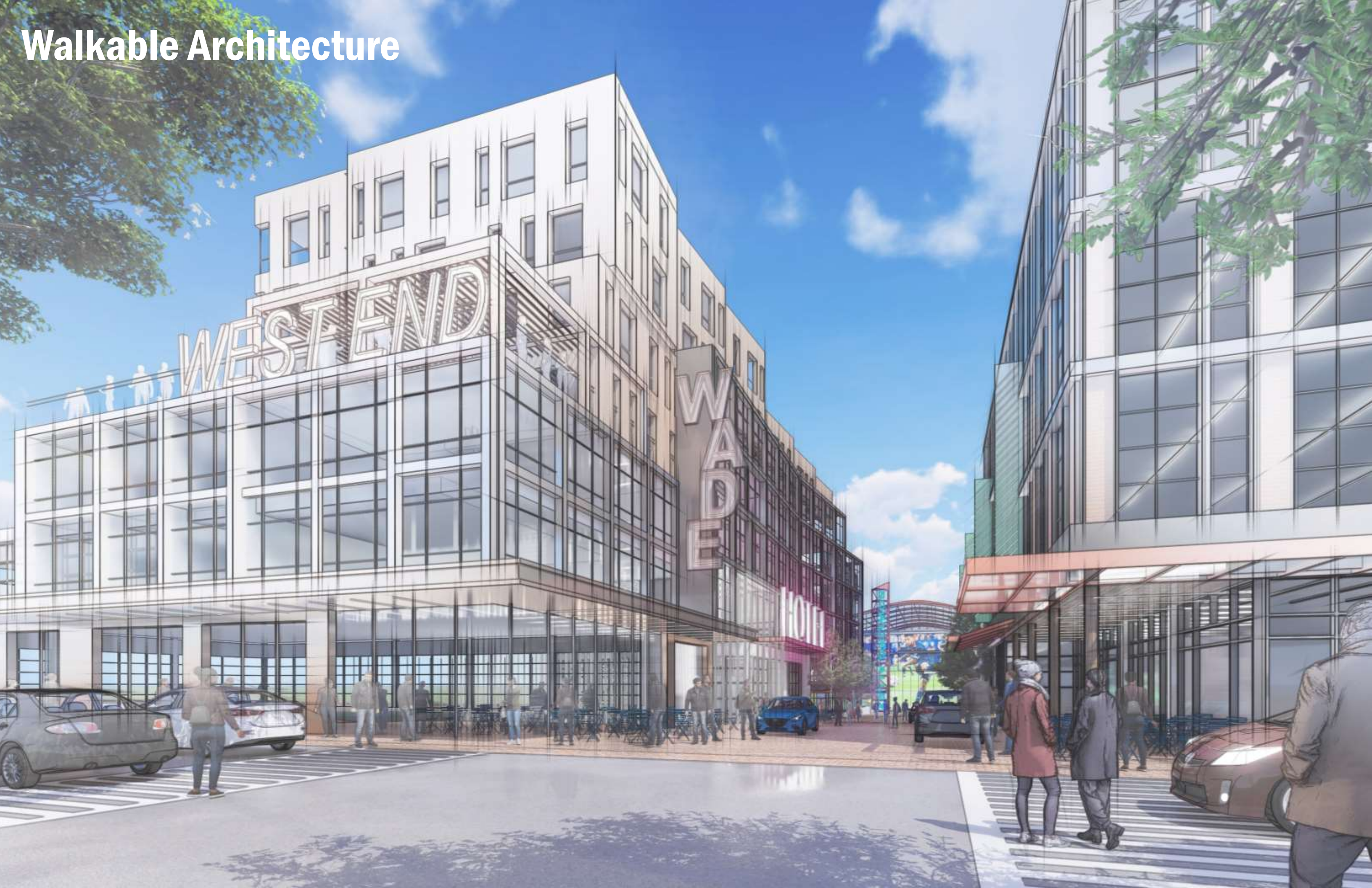

Walkable Architecture



Walkable Architecture



Walkable Architecture





Downsvew Hangar District



FC Cincinnati Soccer Village



Haverhill Waterfront

Walkable Districts



Fordham Landing



Historic Gas Plant District