

Pumping to a 'HIRE' Level

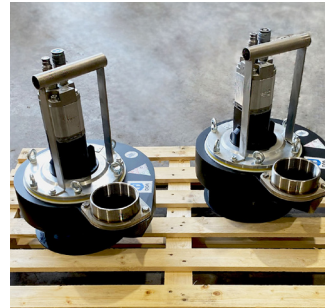

The T-T's range of contractor's pumps are preferred within the hire industry for their superior quality, reliability and durability, designed to work tirelessly when handling nuisance water in unfavourable conditions. With pumps ranging in size from 0.4kW to 110kW, corrosion resistant construction materials and options for automatic or manual dewatering, we have effective solutions for all sectors of the hire industry.

From T-T HQ in Cheshire, our knowledgeable sales team specify hire solutions from an extensive stock of pumps, accessories and spares, with same day despatch on a select number of models. Once your new equipment is delivered, you can trust in T-T to provide comprehensive after-sales support, including repairs, refurbishment, maintenance and testing in our Repairs Workshop at T-T HQ.



What are the benefits of T-T products and services?

- Specialist range of pumps designed specifically for the hire industry
- Technical and after-sales support from knowledgeable sales engineers
- Extensive stock and same day despatch availability
- Low cost, readily available spares
- Fully equipped Repairs Workshop and test facilities at T-T HQ

APPLICATION AREAS:



Visit our website to find out more information on where we will be this year.



Contents

Small Contractor Pumps	3-6
Contractor Pumps	7-8
Engine Driven Pumps	9
Diesel Driven Diaphragm Pumps	10
Hydraulic Range	11-12
Aftersales Service	13

Puddlepal™

The Puddlepal® residue pumps are designed for low-level dewatering on flat surfaces such as roofs and floors, pumping down to 1mm.

- 50mm discharge
- 0.4 – 0.75 kW output
- 304 stainless steel casing with resin impeller
- Single phase 110V, 230V, 50Hz; Three phase 400V, 50Hz
- Double mechanical seal
- Auto-reset thermal protection - non-air locking
- Motor cooled by pumped water



Puddlepal™ 316SS

The Puddlepal® Stainless Steel pumps down to 1mm on flat surfaces and is entirely constructed from stainless steel for strength and corrosion resistance.

- 50mm discharge
- 6mm solids handling
- 0.4 – 0.75 kW output
- SS316 impeller
- Single phase, 230V & 50Hz
- Double mechanical seal
- Auto-reset thermal protection - non-air locking
- Motor cooled by pumped water



Puddlepal Pricing

Puddlepal 400 2": **£286.80 NET + VAT**

Puddlepal 750 2": **£380.40 NET + VAT**

Puddlepal 316SS Pricing

Puddlepal SS 400 2": **£723.60 NET + VAT**

Puddlepal SS 750 2": **£898.80 NET + VAT**

ORDER QUANTITIES OF 5+ RECEIVE AN EXTRA 5% OFF

AVAILABLE IN 400V, PLEASE SPEAK TO OUR SALES TEAM TO LEARN MORE

ORDER QUANTITIES OF 5+ RECEIVE AN EXTRA 5% OFF

Complete Dewatering Sets

CARRIAGE INCLUDED TO MAINLAND UK ON ALL PUMPS

Palpack

The Palpack consists of a puddle pump, level sensor and control unit for automatic dewatering.

Option One - Palpack: Consists of a PuddlePal®, Watervole level sensor and Waterguard control unit for standard automatic pump start and stop at set levels.

Option Two - Palpack Pro: With a Watervole Pro and Waterguard pro, provides an additional high-level warning system along with automatic stop/start function.

WaterGuard Features

- IP66 rated weatherproof enclosure
- Single phase pump control up to 9.3 amp
- Dry run sensor
- Audible alarm with mute configuration
- LED mains healthy and pump running indication



How the Palpack works

1. Water rises and reaches a high level pin on the Watervole
2. This signals the Waterguard to start pumping
3. When water levels fall below the Watervole's low level pin, the Waterguard starts a countdown, allowing the PuddlePal to pump down to 1mm before switching the pump off
4. The cycle repeats, automatically keeping your basements, cellars, flat roofs and home dry.

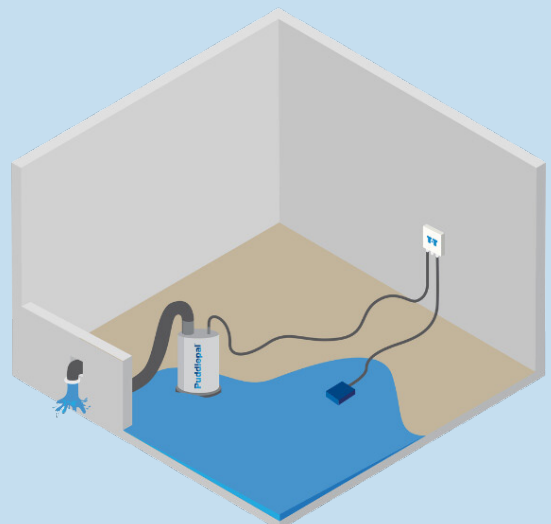

Palpack Pricing

Palpack 400:	£493.20 NET + VAT
Palpack 400 Pro:	£552.60 NET + VAT
Palpack 750:	£574.20 NET + VAT
Palpack 750 Pro:	£649.20 NET + VAT

ORDER QUANTITIES OF 5+ RECEIVE AN EXTRA 5% OFF

AVAILABLE IN 400V, PLEASE SPEAK TO OUR SALES TEAM TO LEARN MORE

Liberator™

The Liberator® 2" submersible drainage pumps are compact, light and powerful, suitable for ground water containing sand and silt, i.e. small water features and basement dewatering.

- 50mm discharge
- 7mm solids handling
- 0.4 - 1.5kW output
- 304 Stainless steel outer casing with resin impeller
- Single phase 110V, 50Hz; Single phase 230V, 50Hz;
- Auto-reset thermal protection
- Double mechanical seal
- Motor cooled by pumped water



Liberator Pricing

Liberator 400 2":	£252.60 NET + VAT
Liberator 750 2":	£365.40 NET + VAT
Liberator 1500 2":	£792.60 NET + VAT

ORDER QUANTITIES OF 5+ RECEIVE AN EXTRA 5% OFF

AVAILABLE IN 400V, PLEASE SPEAK TO OUR SALES TEAM TO LEARN MORE

Trencher™

The Trencher® 2" submersible dewatering pumps are suitable for use in small water features, cellars and basements, complete with agitator to prevent sedimentation within the pump body.

- 50mm discharge
- 7mm solids handling
- 0.4 - 1.5 kW output
- Cast iron volute, aluminium motor casing and abrasion-resistant resin vortex impeller
- Single phase 110V, 50Hz; Single phase 230V, 50Hz; Built-in agitator
- Double mechanical seal
- Auto-reset thermal protection



The Trencher 1500 is the only 110V submersible pump with a 20m max head and 7.8l/sec flow rate on the market!



Trencher Pricing

Trencher 400 2":	£205.80 NET + VAT
Trencher 750 2":	£268.20 NET + VAT
Trencher 750 3":	£285.60 NET + VAT
Trencher 1500 2":	£690.00 NET + VAT

ORDER QUANTITIES OF 5+ RECEIVE AN EXTRA 5% OFF

AVAILABLE IN 400V, PLEASE SPEAK TO OUR SALES TEAM TO LEARN MORE

Trencher Benefits

Auto-reset thermal protection

Thermal sensors within the pump body monitor temperature and automatically stop operation to prevent overheating causing damage to pumping components.

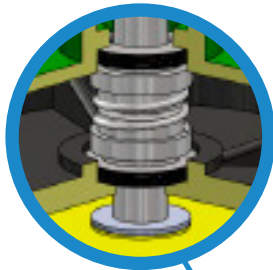

Twin mechanical seal

The Trencher's double mechanical seal improves sealing performance and longevity, preventing leaks and increasing pump reliability.

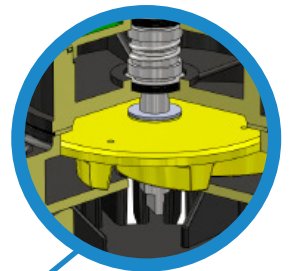
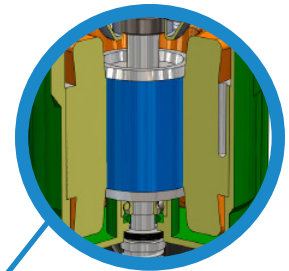

Resin vortex impeller

Highly abrasion resistant, the Trencher's resin vortex impeller minimises the risk of large solids blocking the pump by generating a vortex that helps to keep them suspended.

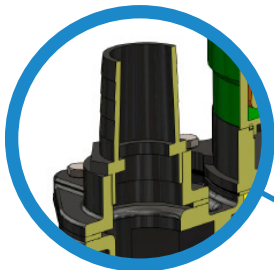

Discharge size

Trencher 750/1500 are available with either a 2" or 3" discharge.

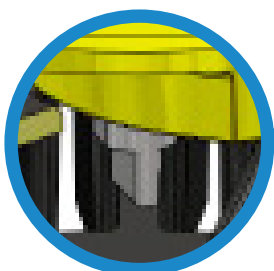

Built in agitator

An agitator built into the pump keeps solids in suspension so that they pass through the pump rather than settling.

CARRIAGE INCLUDED TO MAINLAND UK ON ALL PUMPS

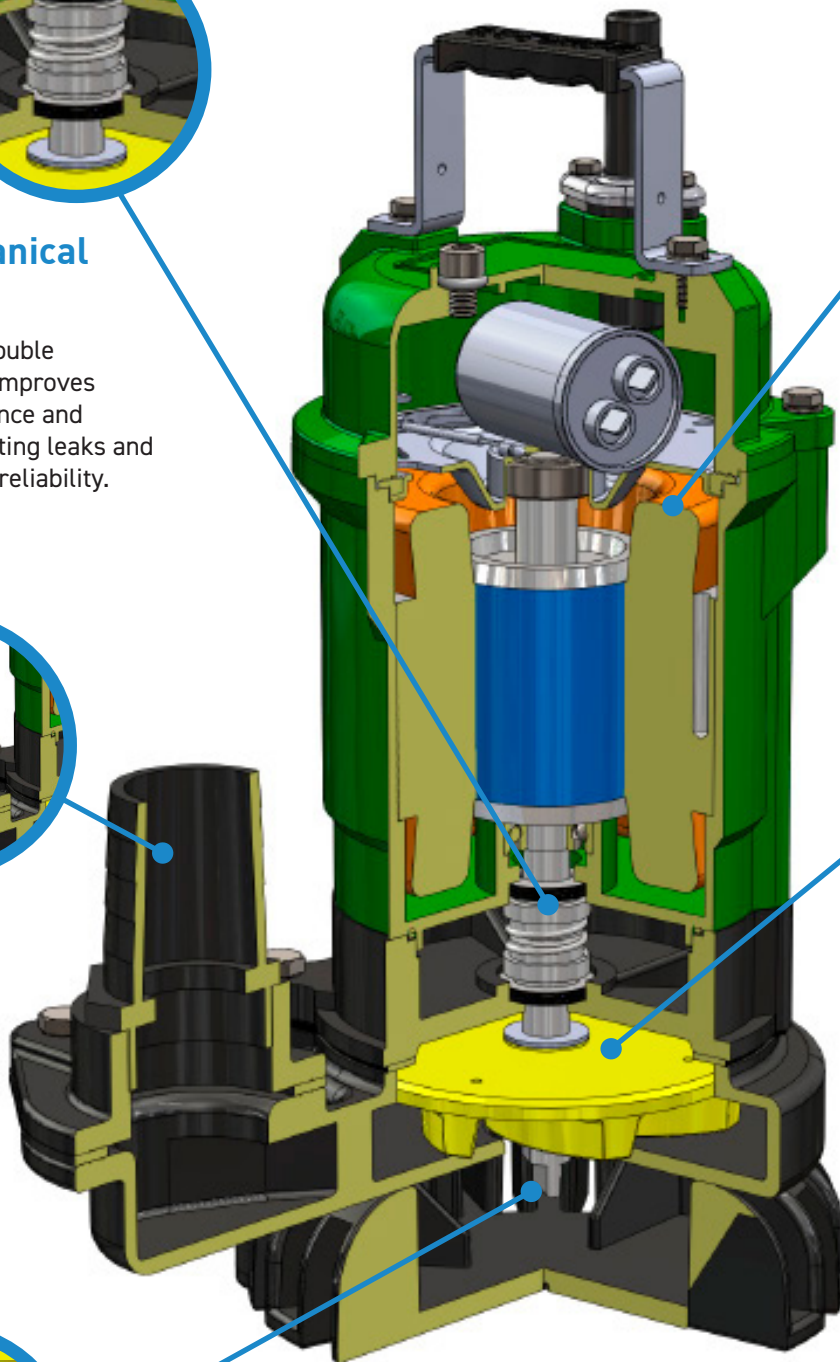



Contractors Pumps



Our Kino Titan® Range of contractor's pumps are high-performance, submersible dewatering pumps designed for drainage and dewatering in the toughest environments. Manufactured in cast iron, stainless steel and high chrome to withstand heavy slurries and abrasive liquids, the KT Range delivers exceptional durability on demanding sites.

Applications

- Mines and quarries
- Civil applications
- Construction sites
- Emergency flood response

Benefits

- **Tough** – The KT Range is made from impact and corrosion resistant materials for reliable pumping in harsh conditions.
- **Fully repairable** – Cost effective spares are readily available from T-T HQ, where engineers in our Repairs Workshop complete repairs, refurbishment, testing and maintenance.
- **Fast turnaround** – We keep a large stock of contractor's pumps at HQ ready for despatch.



THIS PUMP IS IDEAL FOR CONSTRUCTION AND BUILDING



KTS

Continual Dewatering Pump

- Max. solids handling: 19.5mm
- Max. flow rate: 46.6l/sec
- Max. head: 57m
- Max. submersion depth: 25m
- Water cooled motor



KTSE

Automatic Drainage Pump

- Max. solids handling: 19.5mm
- Max. flow rate: 46.6l/sec
- Max. head: 48.5m
- Max. submersion depth: 25m
- Built-in sensor probe protects against reverse phase and overload



KTA

Slurry Pump

- Max. solids handling: 30mm
- Max. flow rate: 108.3l/sec
- Max. head: 42m
- Max. submersion depth: 25m
- Built in agitator



KTA/S

Slurry Pump

- Max. solids handling: 20mm
- Max. flow rate: 68.3l/sec
- Max. head: 22.5m
- Max. submersion depth: 20m
- Built in agitator



KT Sand Devil

Submersible Sand Pump

- Max. solids handling: 40mm
- Max. flow rate: 166.6l/sec
- Max. head: 57m
- Max. submersion depth: 15m
- Built in agitator



KTC

Water Cooled Pump

- Max. solids handling: 15mm
- Max. flow rate: 30l/sec
- Max. head: 31m
- Max. submersion depth: 25m
- Continuous and intermittent operation



KTH

Drainage Pump

- Max. solids handling: 20mm
- Max. flow rate: 108.3l/sec
- Max. head: 177m
- Max. submersion depth: 30m
- Water cooled motor



KTH/S

Corrosion Resistant Pump

- Max. solids handling: 10mm
- Max. flow rate: 25l/sec
- Max. head: 142m
- Max. submersion depth: 20m
- Water cooled motor





Engine Driven Pumps

SCR 50-80

SCR Range engine-driven pumps are robust, powerful and light for portability, designed for handling grey water and clear water.

- 4-stroke Honda engine
- SCR 50 – 4 horsepower
- SCR 80 – 5.5 horsepower
- 5mm solids handling
- Mechanical seal
- Aluminium out casing, cast iron impeller and wear plate
- Self-priming
- Minimal maintenance required

SCR 50 Kit

What's Included?

- SCR 50 and Honda engine
- 10m x 50mm layflat hose
- 10m x 50mm suction hose



SCR 50 Pricing

SCR 50 Pump Only: **£498.00 NET + VAT**

SCR 50 Kit: **£600.00 NET + VAT**

SCR 80 Kit

What's Included?

- SCR 80 and Honda engine
- 10m x 80mm layflat hose
- 10m x 80mm suction hose



SCR 80 Pricing

SCR 80 Pump Only: **£563.40 NET + VAT**

SCR 80 Kit: **£720.00 NET + VAT**

SMD 50-80

SMD heavy-duty engine driven, diaphragm pumps are designed for transferring water containing sand, stone and mud and light chemicals from heavy-duty applications.

- 4-stroke Honda engine
- SMD 50 – 4 horsepower, 25mm solids handling
- SMD 80 – 5.5 horsepower, 35mm solids handling
- Capable of running dry without damage
- Compact pump body and gear case made in heavy-duty die-cast aluminium for lightweight portability



SMD Pricing

SMD 50 Pump: **£1,605.60 NET + VAT**

SMD 80 Pump: **£1,755.60 NET + VAT**





Diesel Driven Diaphragm Pumps

CARRIAGE INCLUDED TO MAINLAND UK ON ALL PUMPS

TTCLH Range

TTCLH low-pressure, diesel driven diaphragm pumps are suited to dewatering in emergency situations, construction sites, wastewater treatment plants and mining and quarrying applications.

- Continuous dry running
- Self-priming to depth of 7m
- Abrasion and corrosion resistant
- No seals or rotating parts in contact with pumped liquid
- Flow rate proportional to diaphragm pulses
- Mounted on trailer roller cage with pneumatic wheels
- Wetted and other parts in aluminium

TTCLH 1-3"

- HATZ 1B20 diesel engine (recoil start)
- Max. solids handling: 50mm
- Max. total head: 15m
- RPM: 2800
- DN80/PN10
- Max. 65 strokes per minute
- Wraparound, trailer aluminium weight: 68kg



TTCLH 1-4"

- HATZ 1B30 diesel engine (recoil start)
- Max. solids handling: 60mm
- Max. total head: 15m
- RPM: 3000
- DN100/PN10
- Max. 54 strokes per minute
- Wraparound, trailer aluminium weight: 112kg



TTCLH 1-3" Pricing

TTCLH 1-3": **£4,480.00 NET + VAT**

TTCLH 1-4" Pricing

TTCLH 1-4": **£6,510.00 NET + VAT**

Hydraulic Range

WP25

- 80mm vertically threaded discharge
- 20mm free passage
- Possibility to run dry without damages
- Resistance to abrasive liquid
- Aluminium pump body with a Cast iron impeller
- Hydraulic flow rates- 30L/min
38L/min



SP45

- 100mm vertically threaded discharge
- 70mm free passage
- Possibility to run dry without damages
- Resistance to abrasive liquid with the ability to pump up to a concentration of 25%.
- Stainless steel pump body with a stainless steel impeller,
- Hydraulic flow rates- 30L/min
38L/min



SP20

- 50mm vertically threaded discharge
- 30mm free passage
- Possibility to run dry without damages
- Resistance to abrasive liquid
- Aluminium pump body with a Cast iron impeller
- Hydraulic flow rates- 20L/min
30L/min



SP55

- 125mm vertically threaded discharge
- 55mm free passage
- Possibility to run dry without damages.
- Impeller has knives that can cut through suspended solids like seaweed, straw, rags, ropes, sediments and various linear fibres
- Resistance to abrasive liquid
- Stainless steel pump body with a stainless steel impeller,
- Hydraulic flow rates- 40L/min
50L/min
60L/min



SP35

- 80mm vertically threaded discharge
- 50mm free passage
- Possibility to run dry without damages
- Resistance to abrasive liquid
- Stainless steel pump body with a stainless steel impeller,
- Hydraulic flow rates- 20L/min
30L/min



SP65

- 150mm vertically threaded discharge
- 65mm free passage
- Possibility to run dry without damages.
- Impeller has knives that can cut through suspended solids like seaweed, straw, rags, ropes, sediments and various linear fibres
- Resistance to abrasive liquid stainless steel pump body with a stainless steel impeller,
- Hydraulic flow rates- 60L/min
80L/min
100L/min



WP25:	£2,573.00 NET + VAT
SP20:	£2,258.00 NET + VAT
SP35:	£3,465.00 NET + VAT
SP45:	£3,744.75 NET + VAT
SP55:	£9,923.25 NET + VAT
SP65:	£12,128.00 NET + VAT

Hydraulic Range

SP21 EX

- 50mm vertically threaded discharge
- 10mm free passage
- Possibility to run dry without damages
- Resistance to abrasive liquid
- Construction stainless steel pump body with a Cast iron impeller
- ATEX rated
- Hydraulic flow rates- 20L/min
30L/min



SP36 EX

- 80mm vertically threaded discharge
- 10mm free passage
- Possibility to run dry without damages
- Resistance to abrasive liquid
- Construction stainless steel pump body with a stainless steel impeller
- ATEX rated
- Hydraulic flow rates- 20L/min
30L/min
38L/min



HYDRAULIC FUNCTIONING GUARANTEES HIGH POWER, SAFETY AND RESISTANCE TO ABRASIVE LIQUIDS AND THE POSSIBILITY OF RUNNING DRY.

SP21 EX: £4,011.00 NET + VAT

SP36 EX: £4,841.00 NET + VAT

Self-Priming Transfer Pumps

EP Bronze

EP Bronze transfer pumps are self-priming and have a bronze construction for water, oil and grease transfer.

- Bronze body and liquid ring impeller
- Max. head: 40m
- Max. capacity: 8.3l/sec
- 12 and 24 volt options for vehicle use
- Bi-directional motor for reverse operation
- Self-priming



EP25 110V: £472.50 NET + VAT

EP25 230V: £516.00 NET + VAT

EP25 12/24V: £973.00 NET + VAT

Heavy-duty frame: £130.00 NET + VAT

ORDER QUANTITIES OF 5+ RECEIVE AN EXTRA 5% OFF

Accessories

Medium Duty Layflat Hose

Our medium-duty layflat delivery hose is lightweight, flexible, and quick to deploy, making it ideal for emergency response, flood relief, plant hire, construction, and civil industry dewatering. Its durable design ensures reliable performance in demanding conditions.



50mm hose: **£2.70 NET + VAT per metre**

80mm hose: **£4.70 NET + VAT per metre**

Stock code: HU/50LF / HU80LF

SPECIAL OFFERS!

50mm hose: **£130.00 NET + VAT per 100 metres**

80mm hose: **£225.00 NET + VAT per 100 metres**

CARRIAGE EXTRA

CARRIAGE INCLUDED WHEN ORDERED WITH MULTIPLE PUMPS

Suction and Delivery Hose

Heavy-duty ribbed hoses for fluid suction and delivery in temporary and permanent applications.

Constructed in PVC and reinforced with a rigid shock-proof white PVC helix for durability, our suction and delivery hose is suitable for drainage water, slurries, solids and powder.



50mm hose: **£6.90 NET + VAT per meter**

80mm hose: **£10.80 NET + VAT per metre**

Stock code: HU50PNR / HU/80PNR

SPECIAL OFFERS!

50mm hose: **£165.00 NET + VAT per 30 metres**

80mm hose: **£262.00 NET + VAT per 30 metres**

CARRIAGE EXTRA

CARRIAGE INCLUDED WHEN ORDERED WITH MULTIPLE PUMPS

Cable

A replacement pump power cable, 10m in length and complete with vulcanised cable gland for use with the Liberator, Trencher and PuddlePal pumps.



Cable: **£33.00 NET + VAT each***

Stock code: PHS/CABLE-2

***MINIMUM ORDER OF 5**



NOTES



A series of horizontal dotted lines spanning the width of the page, intended for writing notes.



DATA879 17/03/2026

T-T Pumps® **T-T Controls**® **T-T Flow**® **T-T Pumping** **T-T Agricultural** **T-T Service**® **T-T Hawker Electronics**
& Automation Valves Stations & Environmental® LEVEL CONTROL & MONITORING 

T-T Pumps Ltd, Onneley Works, Newcastle Road, Woore, Cheshire, CW3 9RU, United Kingdom

 ttpumps.com

 +44 (0) 1630 647200

 response@ttpumps.com

T-T Controls & Automation, T-T Flow, T-T Pumping Stations, T-T Agricultural & Environmental. T-T Hawker Electronics and T-T Service are divisions of T-T PUMPS Ltd. T-T PUMPS Ltd: Registered in England & Wales Reg. No 2320012