

## Keypad – customizable key modules for maximum flexibility

The keypad is a multifunctional CAN bus control panel that has been specially developed for individual requirements. It combines state-of-the-art technology with a robust and ergonomic design to enable intuitive and reliable control in a wide range of applications.

The three variants TF1, TF2 and TF3 with different push button designs – insert symbols, predefined symbols and through to a continuous front foil – offer maximum flexibility in design and customization.



### DC2 Display Controller

The DC2 display controller is a CAN bus operating unit for controlling HMI displays. The module also has 6 push buttons. The individual design and illumination of the symbols allows it to be integrated into any operating concept.

**DC2:**  
Length: 121mm  
Width: 57mm  
Height: 29mm

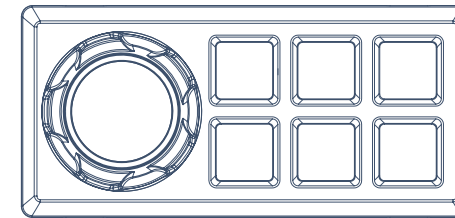

### Discover more Gessmann products!



## GESSMANN®

- Over 90 years of experience and quality
- World market leader industrial joysticks
- Steady growth worldwide

### W. Gessmann GmbH

Eppinger Street 221  
74211 Leingarten

Siemensstrasse 17  
74193 Schwaigern

Phone +49 7131 40 67-722  
sales@gessmann.com  
www.gessmann.com

W. Gessmann GmbH | Stand 03/25



## KEYPAD CAN-BUS

EN

## Keypad

*wide range of applications*

The available sizes 2x3, 2x4, 2x5 and 4x5 enable both perfect integration into existing control panels and stand-alone use. It can be flexibly adapted to different space conditions and requirements.

A special highlight is the RGB illumination of each individual push button. With up to 16 preset light settings, individual color coding can be implemented.

Because of the robust construction and high-quality materials the keypad impresses with a long service life and high resistance to environmental conditions. It is therefore perfect for use in harsh environments.

The Can-Bus interface allows the keypad to be easily integrated into any machine.

### CAN-BUS Protocols:

- CANopen CiA DS 301
- SAE J1939
- SAE J1939-76
- CANopen Safety EN50325-5

Functional safety (push button) PLd able  
(EN ISO 13849, conforms with SIL2 to DIN EN ICE 61508)



### Dimensions

#### 2x3 keys:

Length: 78mm  
Width: 57mm  
Height: 29mm



#### 2x4 keys:

Length: 100mm  
Width: 57mm  
Height: 29mm



#### 2x5 keys:

Length: 121mm  
Width: 57mm  
Height: 29mm

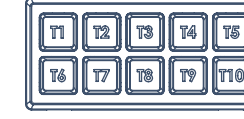

#### 4x5 keys:

Length: 121mm  
Width: 101mm  
Height: 29mm

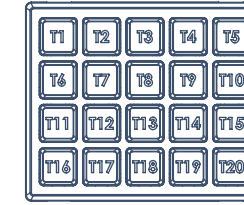

### Variant TF1

*Push buttons with insert symbols*



### Variant TF2

*Push buttons with predefined symbols*



### Variant TF3

*Push buttons with front foil*

### Perfect fit

*flexible inlay symbols*

Because of flexible design options, the insert symbols can be customized and glued in easily. This customization option makes the TF1 the perfect solution when it comes to tailor-made operating concepts.

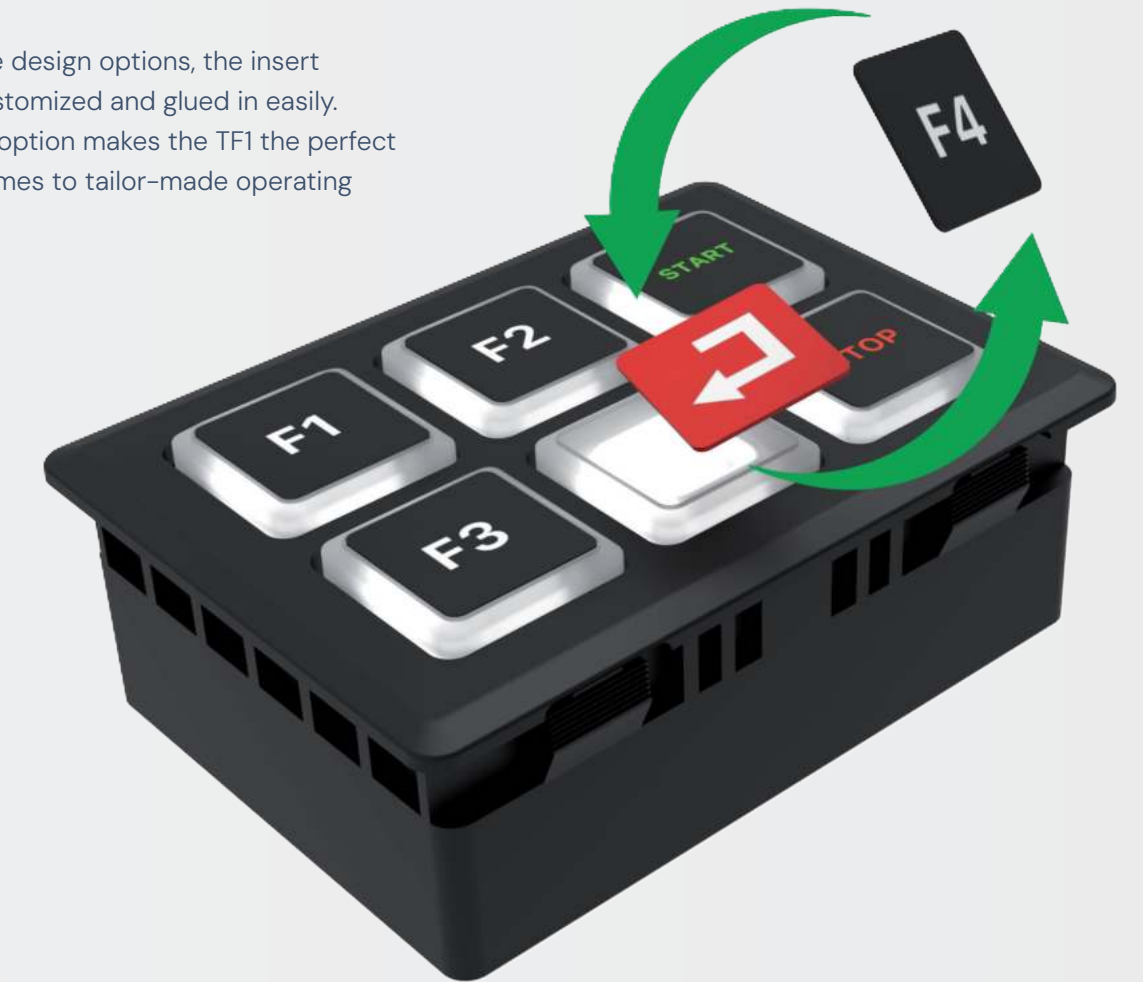

### RGB-lighting

Choose from 16 preset lighting scenarios and adapt the lighting to your requirements to create attractive lighting effects or improve orientation.

The individually adjustable lighting provides optimum user guidance and increases efficiency in every application.

