

AARDEN EQUIPMENT DEMOLITION



SHEAR • CONCRETE CRUSHER • STEEL SHEAR • SORTING GRAB • GRAPPLE • HYDRAULIC BREAKER



200+ employees



5 foreign subsidiaries



Membership of a group



50 years of experience



Exporting to 50 countries



7 business sectors

Building together the innovations of tomorrow.



Laurent DARDENNE
Managing Director
ARDEN EQUIPMENT

Dear customers and partners,

At Arden Equipment, we develop our solutions with a clear guiding principle: to design reliable, high-performance equipment tailored to the practical demands of the field, whilst preparing our product ranges for the future. Our approach is based on experience, listening to our users, and a constant commitment to improving our products and services.

Among our major developments, we are preparing a new generation of mini-excavator buckets for 2026. Their design will allow them to accommodate the main quick-coupler kits without any modifications to the bucket body, with the aim of improving our lead times and responding more quickly to your requests. In line with this approach, we are continuing to develop S-type couplers to ensure broad compatibility with existing fleets of machinery. Our dual-purpose interchangeable solution, based on the AIO automatic connection system, also illustrates this move towards greater versatility, allowing you to switch quickly from a demolition or recycling tool to handling equipment using a single machine.

We are also working to optimise our production costs, without compromising on our core requirement: to maintain the high standards of quality and durability that characterise Arden Equipment. This approach applies in particular to our ranges of sorting and demolition grapples. By developing and streamlining our product ranges, we are able to offer more competitive solutions, whilst retaining tried-and-tested mechanical components that guarantee reliability in the field.

The launch of our new website marks another significant milestone. More than just a showcase, it serves as a genuine decision-making tool: featuring equipment and spare parts configurators, simplified access to technical and sales documentation, as well as an online purchasing platform exclusively for our distributor network, enabling them to order spare parts and certain equipment directly.

As Managing Director, and drawing on my previous experience as Industrial Director, I remain firmly committed to developing sustainable solutions, supporting you in your projects and building together the innovations of tomorrow.

Laurent DARDENNE
Managing Director

Get to know our company :



UNIVERSAL SHEAR



2.5t - 70t



Universal shears are ideal on job sites where versatility is required. Thanks to their different jaw versions, they can switch from primary to secondary demolition, allowing the dismantling and recycling of reinforced concrete or steel structures.

CB: Concrete shear
BB: Concrete crusher
BV: Perimeter cutting

BF: Concrete/Scrap
CF: Scrap shear
GR: Steel shear



- Quick jaw change
- Versatile
- 360° rotation with 1 or 2 motors
- Reversed cylinder to protect the rod
- Highly resistant thanks to its 450 HB jaws
- Replaceable spare parts

OPTIONS

- Booster CU007/CU008
- Speed valve except CU230 & CU350
- Arden Jet except CU230 to CU008

DEDICATED SHEAR



14t - 100t



Dedicated shears meet a very specific need that does not require changing jaws.

There are 5 types of jaws.

CB: Concrete shear*
BB: Concrete crusher
BV: Perimeter cutting

BF: Concrete/Scrap
CF: Scrap shear

**For the CD080, available only in CB version*



- 360° rotation with 1 or 2 motors
- Reversed cylinder to protect the rod
- Highly resistant thanks to its 450 HB jaws
- Replaceable spare parts

OPTIONS

- Speed Valve (except CD080)
- Arden Jet (except CD080)

SCRAP SHEAR



9t - 50t

14t - 100t



Scrap shears are designed to cut sheet metal, metals, scrap, and cables. Their robust blades allow them to easily cut steel materials. Shears can be **mounted** directly **on the stick** or **on the boom**.



- Reversed cylinder to protect the rod
- Shrink-fitted pin
- Anti-abrasion and high-tensile steel
- Hard-facing reinforcement of the jaws in 600 HB

OPTIONS

- Centralized autonomous greasing except AS014
- Speed Valve optional on AS014
- Arden Jet optional on AS030

CONCRETE CRUSHER



13t - 80t



For secondary demolition, concrete crushers feature a large jaw opening. It offers **higher productivity** than universal or dedicated tools equipped with concrete jaws. They ensure time savings in your tasks.



- Customizable with or without rotation (depending on the model)
- Powerful with greater forces at the teeth
- Easily replaceable wear parts
- Robust with anti-abrasion steel
- Hard-facing buildup for teeth

OPTIONS

- Booster (BBH014, BBH020 & BBH031)
- Speed valve
- Closing plate
- Arden Jet

TANK SHEAR



Tank shears are dedicated tools for cutting cisterns, tanks, and flat metal sheets. Their perimeter cutting guarantees precision and efficiency. Directly equipped with a Speed valve, they offer significant time savings on job sites.



- Cutting precision thanks to its narrow blade
- High power through cylinder sizing
- Compact and reinforced frame

SORTING GRAB (BARS)

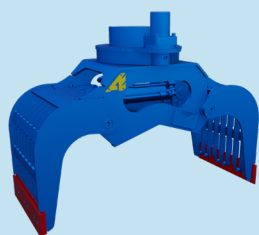

Sorting grabs with bars are ideal for demolition and sorting. A wave-shaped structural reinforcement has been directly integrated within the bars themselves, allowing not only for better shock absorption but also for stiffening the structure of the bars in place.



- Shock absorption
- Reinforced rigidity
- Secure and optimized hydraulic rotation

OPTIONS

- Arden Jet *
- Bolted side plates *
- Safety valves
- Rubber between blade and bolt-on cutting edge
- Bolt-on cutting edge with bolted teeth *
- Bolted notched teeth *

* on certain models

SORTING GRAB (PERFORATED PLATES)

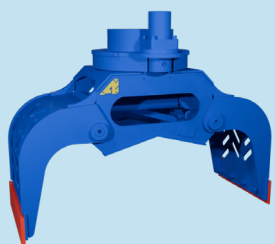

Perforated grabs are tools adapted to the handling of rubble and mixed materials. They specifically provide visibility during material handling.



- Holding and visibility
- Thick perforated plate
- Reinforcements

OPTIONS

- Arden Jet *
- Bolted side plates *
- Safety valves
- Rubber between blade and bolt-on cutting edge
- Bolt-on cutting edge with bolted teeth *
- Bolted notched teeth *

* on certain models

SPECIAL GRAB



Arden Equipment offers a multitude of grabs adapted to different job sites:

- Crossing grabs
- Block grabs
- Grabs with articulated pads
- Rock breaking grab



- Application-specific grabs
- Reinforced safety
- Cylinders with check valves

OPTIONS

- Arden Jet on certain models

HYDRAULIC BREAKER

0.5t - 100t



Arden Equipment's range of breakers is designed to meet all your needs, from small precision tasks to large demolition sites. Thanks to their robust design and resistance to the most difficult conditions, these tools ensure long-term performance and reliability.

- Powerful
- Adaptable
- Centralized autonomous greasing as standard from AB2054
- Dust protection
- Easy start

OPTIONS

- Arden Jet from AB1054
- Hammer bracket
- Additional grease cartridge
- Additional point
- Autonomous greasing from AB0854 to AB1854

HYDRAULIC MAGNET

8 - 45t



Hydraulic magnets are an optimal solution for sorting and handling ferrous materials. Several versions are available: with adapter plate, with adapter plate and teeth, or with chains. **Hydraulically powered**, they require no electrical power supply or generator on the excavator.

- Integrated hydraulic generator for increased magnetic force
- Flow regulator for longer life

OPTIONS

- Teeth
- Plate or chain

DEMOLITION JIB



NEW



Demolition jibs are devices mounted on a lifting machine (e.g., crane) and allow high-altitude positioning of an automatic connection hydraulic hitch and an Arden Equipment shear. In this example, it is the AIO601 and the CU042.

- Productivity
- Safety
- Flexibility

OPTIONS

- Jib transport support
- Jib maintenance support







AIO HITCH



12t - 40t

NEW



The **automatic connection quick hitch** is a system allowing instant connection of all your hydraulic and mechanical tools from the cab, and quick switching from one tool to another.

+

- Versatility
- Productivity gain
- Enhanced operator safety
- Environmental friendliness

OPTIONS

- Hydraulic kit
- Hose and installation kit
- Additional ½" or electrical coupler

HYDRAULIC QA HITCH



0.8t - 37t



The Quick Arden quick hitch system allows for quick change of various AE tools.

It is equipped with a safety paddle on the front axle, serving as a visual indicator for locking and unlocking.

+

- Automatic unlocking and snapping from the cab
- Safety with play compensation
- Compatible with all shovel or backhoe applications (except some models)
- Cast steel base and mechanism for greater robustness

OPTIONS

- Latching hooks
- Hydraulic circuit kit

MECHANICAL QA HITCH



0.8t - 12t



The Quick Arden quick hitch system allows for quick change of various AE tools. For QA05 and QA13-23M series 3 versions, locking is automatic from the cab, while unlocking is done using a key.

+

- Automatic snapping from the cab
- Safety with play compensation
- Compatible with all shovel or backhoe applications (except some models)
- Cast steel base and mechanism for greater robustness

OPTIONS

- Latching hooks

UA HITCH



2.6t - 53t



The Uni Arden hitch is capable of picking up buckets from different manufacturers, with different pin centers and diameters. It is one of the most compact ranges on the market.

+

- Automatic front pin holding paddle
- Safety check valve
- Resistant cast body depending on the model
- Compatible for shovel or backhoe configuration

OPTIONS

- Handling hook
- Removable original machine pin kit
- AE kit integrated into the bucket beam
- Removable pin kit for couplers
- Hydraulic circuit kit

AES HITCH



2t - 75t

NEW



The AES hitch allows you to change tools easily and quickly. It is reversible and compatible with the Nordic S-type standard.

+

- Counterbalance valve on the cylinder for maximum safety
- Automatic front pin holding paddle
- Robust welded or cast body
- Fully protected internal mechanism

OPTIONS

- Hydraulic kit

AECW HITCH



0.8t - 65t



The AECW hitch mounts on buckets with specific CW footprint. It is available in mechanical or hydraulic versions.

+

- Handling hook
- Mechanical or hydraulic version depending on the model
- Robust welded body

OPTIONS

- Pressure reduction kit for excavators with locking pressure above 60 bar
- Hydraulic kit



DISCOVER OUR NEW E-COMMERCE WEBSITE: BUILT-IN CONFIGURATOR, ORDERS AND REAL-TIME QUOTES!

The screenshot shows a web form titled 'Attachments' and 'Spare part'. It includes a 'Load-bearing weight (T)' input field, a radio button for 'I'm looking for' with options 'All product Types' and 'Only quick couplers and buckets', a 'Brand - Model' dropdown menu currently set to 'Other Machine', and a 'Product Name' input field. A 'Search' button is at the bottom right. A checkbox at the bottom left reads 'I have the product reference'.

Find the right attachments for your excavator using our configurator:

Select the **weight**, **brand** and **model** of your machine, then filter by tool type.

Compatible equipment is displayed instantly, ready to be ordered or added to your quote.

Spare parts: quick and easy to order online

Find and order your parts in just a few clicks on our website:

- **Using the configurator:** enter the **serial number** or model name of your equipment.
- **By category:** go straight to the part via the 'Spare Parts' tab.
- **From the product page:** go to the 'Spare Parts' tab.

Access all our documentation



- Product pages
- User guides
- Spare parts diagrams

Create your customer account now!

www.arden-equipment.com



REPAIR + SERVICE

The Repair + service gives your tools a **second life**. Our experts can advise you on how to repair tools that are still in working order, offering a cost-effective solution.

AFTERMARKET

+44 7946 378556

lewis.tabb@arden-equipment.com

SPARE PARTS

+44 7946 378556

lewis.tabb@arden-equipment.com

BEFORE / AFTER

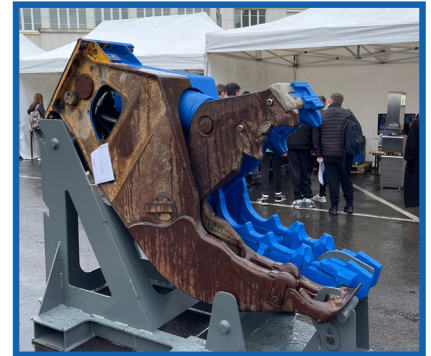

MOBILE SERVICE ENGINEERS

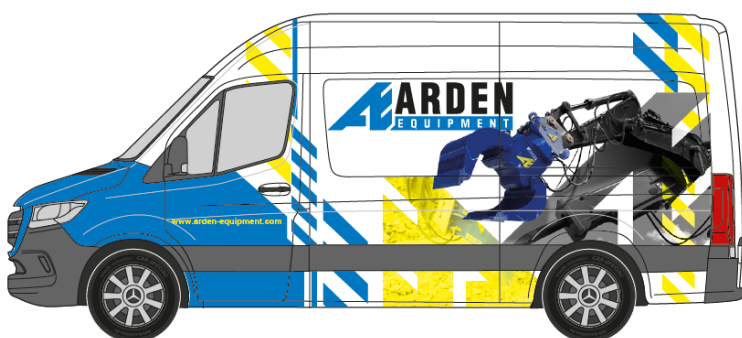

Arden Equipment provides you with a team of qualified technicians, from commissioning to repairing your tools.

Got a question, need some advice, or experiencing a fault? We're here to help.

OUR INDUSTRY BROCHURES

SEE ALL OUR INDUSTRY BROCHURES

EARTHMOVING

ARDEN
EQUIPMENT
EARTHMOVING



EARTHMOVING **DEMOLITION** **SCRAP METAL** **RECYCLING** **HANDLING** **RAILWAY** **LANDSCAPING**

BUCKET • TOOTH • CLAMSHELL • GRAB • HYDRAULIC BREAKER • LEVELLER • ASPHALT CUTTER

DEMOLITION

ARDEN
EQUIPMENT
DEMOLITION



EARTHMOVING **DEMOLITION** **SCRAP METAL** **RECYCLING** **HANDLING** **RAILWAY** **LANDSCAPING**

SHEAR • CONCRETE CRUSHER • STEEL SHEAR • SORTING GRAB • GRAPPLE • HYDRAULIC BREAKER

SCRAP RECYCLING

ARDEN
EQUIPMENT
SCRAP RECYCLING



EARTHMOVING **DEMOLITION** **SCRAP METAL** **RECYCLING** **HANDLING** **RAILWAY** **LANDSCAPING**

SHEAR • CONCRETE CRUSHER • GRAB • GRAPPLE • MAGNET • STEEL SHEAR • EXCAVATOR ARM

RAILWAY

ARDEN
EQUIPMENT
RAILWAY



EARTHMOVING **DEMOLITION** **SCRAP METAL** **RECYCLING** **HANDLING** **RAILWAY** **LANDSCAPING**

CLAMSHELL • GRAB • BALLAST TRACK REMOVER • HITCH • BUCKET

HANDLING

ARDEN
EQUIPMENT
HANDLING



EARTHMOVING **DEMOLITION** **SCRAP METAL** **RECYCLING** **HANDLING** **RAILWAY** **LANDSCAPING**

CLAMSHELL • GRAPPLE • GRAB • BUCKET • SPIDER • U-JOINT • KIT • HITCH

LANDSCAPING

ARDEN
EQUIPMENT
LANDSCAPING



EARTHMOVING **DEMOLITION** **SCRAP METAL** **RECYCLING** **HANDLING** **RAILWAY** **LANDSCAPING**

BUCKET • GRAB • BACKHOE CLAMSHELL KIT • HITCH

Find out here





ARDEN

EQUIPMENT

OUR TEAM



Richard CREIGHTON
North England, Wales & Scotland
Sales Manager
+44 7908 715631
richard.creighton@arden-equipment.com



Pat JAMES
South England, Northern Ireland &
Ireland Sales Manager
+44 7957 236793
pat.james@arden-equipment.com



Lewis TABB
UK / Ireland Technical Support
+44 7946 378556
lewis.tabb@arden-equipment.com

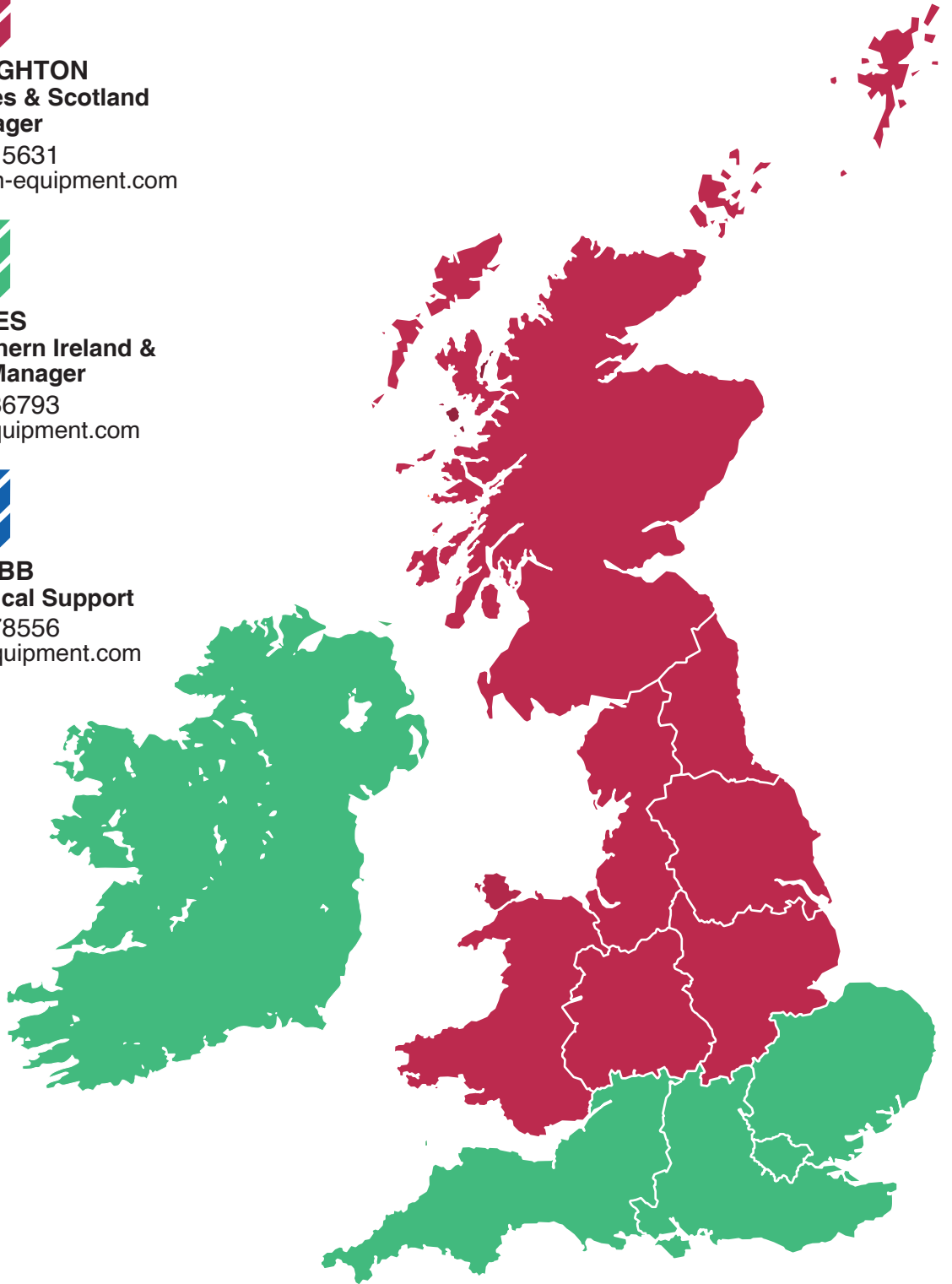

Printed by Fusion Graphic 4 Rue François Urano, 08000 Warcq - Do not throw on the public highway - Non-contractual information and subject to modification without notice



+33 (0)3 24 33 64 30
info@arden-equipment.co.uk
4B Harriott Drive, Heathcote Industrial Estate, Warwick. CV34 6TJ
www.arden-equipment.com
SIRET 380 519 686 00022 APE 4663Z R.C.S SEDAN N°TVA : FR 20 380 519 686